

RETAIL FOR LEASE

White Rose Shopping Center • 225-299 W Cocoa Beach Cswy Cocoa Beach, FL 32931



OFFERING SUMMARY

Available SF:	828 SF
Lease Rate:	\$15.00 SF/yr (\$4.89/sf NNN)
Lot Size:	1.48 Acres
Year Built:	1985
Building Size:	22,371 SF
Zoning:	CN
Market:	Brevard
Submarket:	Cocoa Beach

PROPERTY OVERVIEW

This retail center offers an excellent opportunity for business to service local clientele as well as, many visitors to this world famous beach destination.

- Highly desirable location
- Ample parking
- Easy access and highly visible
- Monument and façade signage

LOCATION OVERVIEW

This prime retail location in Cocoa Beach just west of the intersection of A1A and SR 520 Cswy., around the corner from Ron Jon Surf Shop.

SR 520 frontage - Central Brevard's main east/west artery leading from A1A to west of Interstate 95.

JEFFERY T. ROBISON, CCIM

Principal | Broker
321.722.0707 X13
jeff@teamlbr.com

J. BLAKE ROBISON

Retail Sales And Leasing Advisor
321.722.0707 X18
blake@teamlbr.com

Lightle Beckner Robison

321.722.0707 • teamlbr.com
70 W. Hibiscus Blvd.,
Melbourne, FL 32901

Information contained herein has been obtained through sources deemed reliable but cannot be guaranteed as to its accuracy. A purchaser or lessee is expected to verify all information to his/her own satisfaction. Zoning information subject to change and not warranted. Always confirm current requirements with local governing agencies.

ADDITIONAL PHOTOS

White Rose Shopping Center • 225-299 W Cocoa Beach Cswy Cocoa Beach, FL 32931



JEFFERY T. ROBISON, CCIM

Principal | Broker
321.722.0707 X13
jeff@teamlbr.com

J. BLAKE ROBISON

Retail Sales And Leasing Advisor
321.722.0707 X18
blake@teamlbr.com

Lightle Beckner Robison

321.722.0707 • teamlbr.com
70 W. Hibiscus Blvd.,
Melbourne, FL 32901

Information contained herein has been obtained through sources deemed reliable but cannot be guaranteed as to its accuracy. A purchaser or lessee is expected to verify all information to his/her own satisfaction. Zoning information subject to change and not warranted. Always confirm current requirements with local governing agencies.

AVAILABLE SPACES

White Rose Shopping Center • 225-299 W Cocoa Beach Cswy Cocoa Beach, FL 32931

LEASE TYPE | \$4.89/sf NNN

TOTAL SPACE | 828 SF

LEASE TERM | Negotiable

LEASE RATE | \$15.00 SF/yr

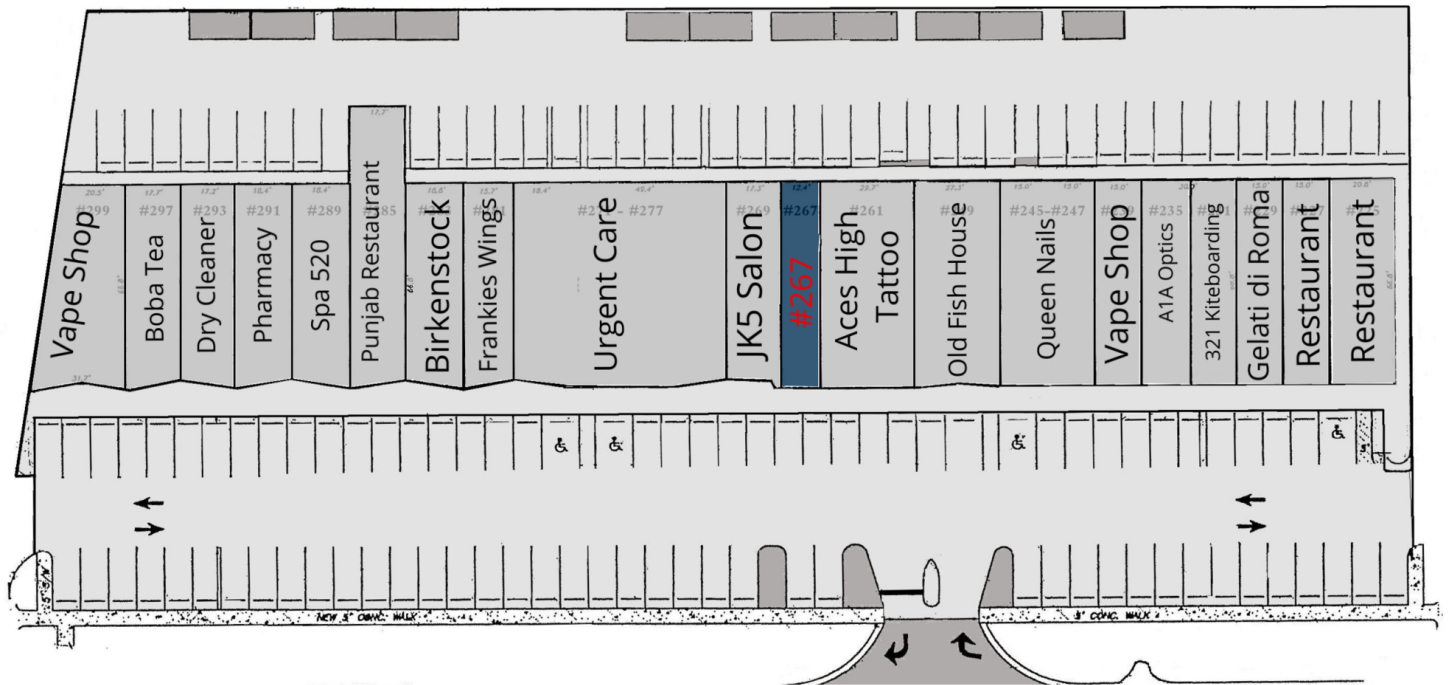

W. Cocoa Beach Cswy (SR520)

UNAVAILABLE

AVAILABLE

SUITE

SIZE

TYPE

RATE

#267

828 SF

\$4.89/sf NNN

\$15.00 SF/yr

JEFFERY T. ROBISON, CCIM

Principal | Broker
321.722.0707 X13
jeff@teamlbr.com

J. BLAKE ROBISON

Retail Sales And Leasing Advisor
321.722.0707 X18
blake@teamlbr.com

Lightle Beckner Robison

321.722.0707 • teamlbr.com
70 W. Hibiscus Blvd.,
Melbourne, FL 32901

Information contained herein has been obtained through sources deemed reliable but cannot be guaranteed as to its accuracy. A purchaser or lessee is expected to verify all information to his/her own satisfaction. Zoning information subject to change and not warranted. Always confirm current requirements with local governing agencies.

INTERIOR PHOTOS

White Rose Shopping Center • 225-299 W Cocoa Beach Cswy Cocoa Beach, FL 32931



Unit 267



Unit 267

JEFFERY T. ROBISON, CCIM

Principal | Broker
321.722.0707 X13
jeff@teamlbr.com

J. BLAKE ROBISON

Retail Sales And Leasing Advisor
321.722.0707 X18
blake@teamlbr.com

Lightle Beckner Robison

321.722.0707 • teamlbr.com
70 W. Hibiscus Blvd.,
Melbourne, FL 32901

Information contained herein has been obtained through sources deemed reliable but cannot be guaranteed as to its accuracy. A purchaser or lessee is expected to verify all information to his/her own satisfaction. Zoning information subject to change and not warranted. Always confirm current requirements with local governing agencies.

RETAIL MAP

White Rose Shopping Center • 225-299 W Cocoa Beach Cswy Cocoa Beach, FL 32931

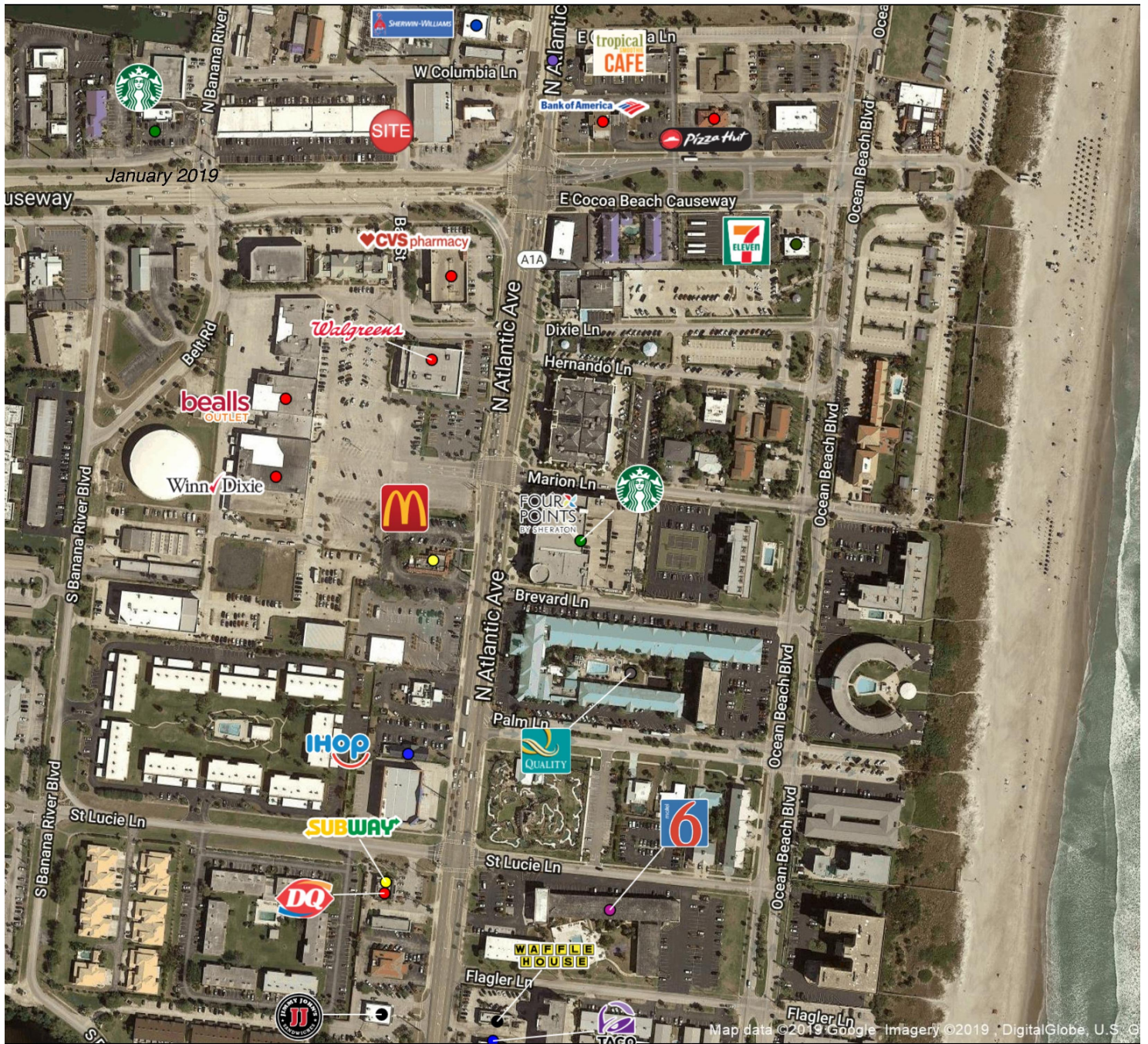

This map was produced using data from private and government sources deemed to be reliable. The information herein is provided without representation or warranty.

JEFFERY T. ROBISON, CCIM

Principal | Broker
321.722.0707 X13
jeff@teamlbr.com

J. BLAKE ROBISON

Retail Sales And Leasing Advisor
321.722.0707 X18
blake@teamlbr.com

Lightle Beckner Robison

321.722.0707 • teamlbr.com
70 W. Hibiscus Blvd.,
Melbourne, FL 32901

Information contained herein has been obtained through sources deemed reliable but cannot be guaranteed as to its accuracy. A purchaser or lessee is expected to verify all information to his/her own satisfaction. Zoning information subject to change and not warranted. Always confirm current requirements with local governing agencies.

LOCATION MAPS

White Rose Shopping Center • 225-299 W Cocoa Beach Cswy Cocoa Beach, FL 32931



JEFFERY T. ROBISON, CCIM

Principal | Broker
321.722.0707 X13
jeff@teamlbr.com

J. BLAKE ROBISON

Retail Sales And Leasing Advisor
321.722.0707 X18
blake@teamlbr.com

Lightle Beckner Robison

321.722.0707 • teamlbr.com
70 W. Hibiscus Blvd.,
Melbourne, FL 32901

Information contained herein has been obtained through sources deemed reliable but cannot be guaranteed as to its accuracy. A purchaser or lessee is expected to verify all information to his/her own satisfaction. Zoning information subject to change and not warranted. Always confirm current requirements with local governing agencies.

DEMOGRAPHICS MAP

White Rose Shopping Center • 225-299 W Cocoa Beach Cswy Cocoa Beach, FL 32931

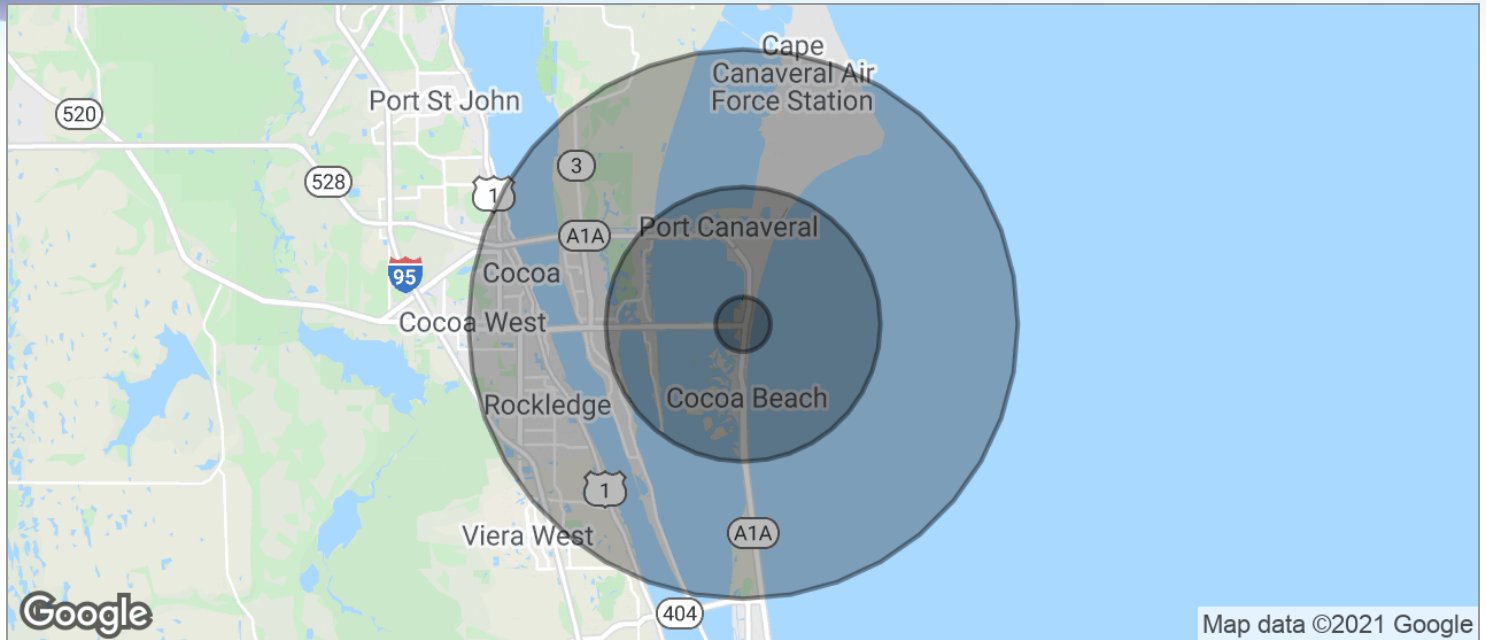

POPULATION	1 MILE	5 MILES	10 MILES
TOTAL POPULATION	2,254	29,816	108,992
MEDIAN AGE	60.0	50.1	45.9
MEDIAN AGE (MALE)	59.9	51.4	45.7
MEDIAN AGE (FEMALE)	60.4	50.3	46.3
HOUSEHOLDS & INCOME	1 MILE	5 MILES	10 MILES
TOTAL HOUSEHOLDS	1,223	14,724	47,235
# OF PERSONS PER HH	1.8	2.0	2.3
AVERAGE HH INCOME	\$71,069	\$69,065	\$70,283
AVERAGE HOUSE VALUE	\$297,437	\$285,628	\$283,279

* Demographic data derived from 2010 US Census

JEFFERY T. ROBISON, CCIM

Principal | Broker
321.722.0707 X13
jeff@teamlbr.com

J. BLAKE ROBISON

Retail Sales And Leasing Advisor
321.722.0707 X18
blake@teamlbr.com

Lightle Beckner Robison

321.722.0707 • teamlbr.com
70 W. Hibiscus Blvd.,
Melbourne, FL 32901

Information contained herein has been obtained through sources deemed reliable but cannot be guaranteed as to its accuracy. A purchaser or lessee is expected to verify all information to his/her own satisfaction. Zoning information subject to change and not warranted. Always confirm current requirements with local governing agencies.