

LOCATION MAP

VAN HORN, ROBERT AND HOUCK, GERALD K.
21PZ00001 SMALL SCALE AMENDMENT 21S.01

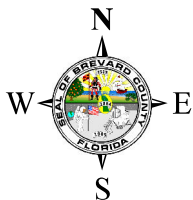



1:24,000 or 1 inch = 2,000 feet

Buffer Distance: 500 feet

This map was compiled from recorded documents and does not reflect an actual survey. The Brevard County Board of County Commissioners does not assume responsibility for errors or omissions hereon.

Produced by BoCC - GIS Date: 1/22/2021

-  Buffer
-  Subject Property

ZONING MAP

VAN HORN, ROBERT AND HOUCK, GERALD K.
21PZ00001 SMALL SCALE AMENDMENT 21S.01

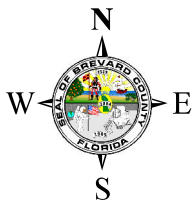
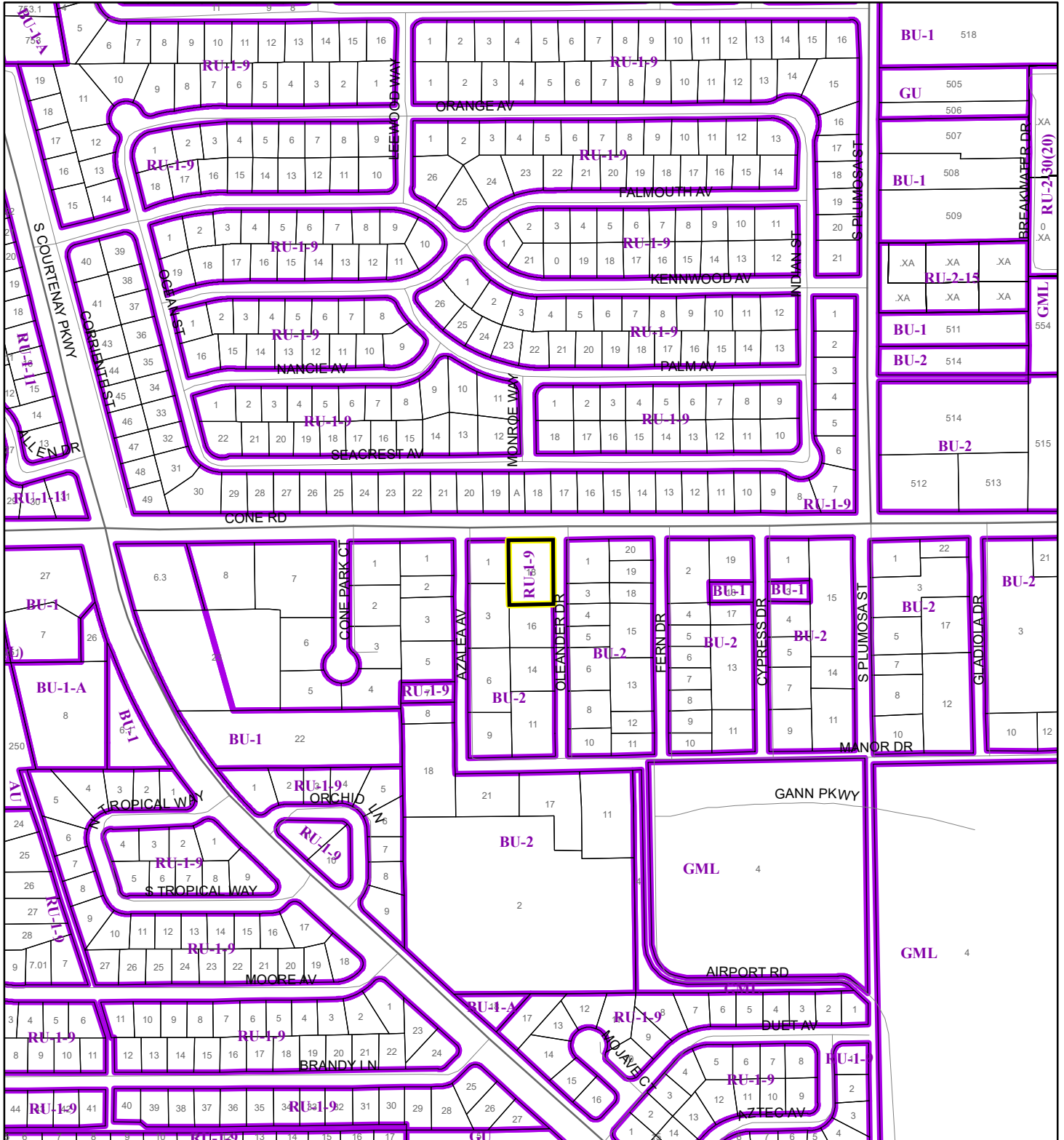

1:4,800 or 1 inch = 400 feet

This map was compiled from recorded documents and does not reflect an actual survey. The Brevard County Board of County Commissioners does not assume responsibility for errors or omissions hereon.

Produced by BoCC - GIS Date: 1/22/2021

- Subject Property
- Parcels
- Zoning

FUTURE LAND USE MAP

VAN HORN, ROBERT AND HOUCK, GERALD K.
21PZ00001 SMALL SCALE AMENDMENT 21S.01

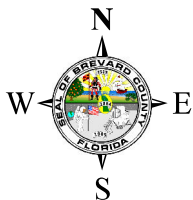
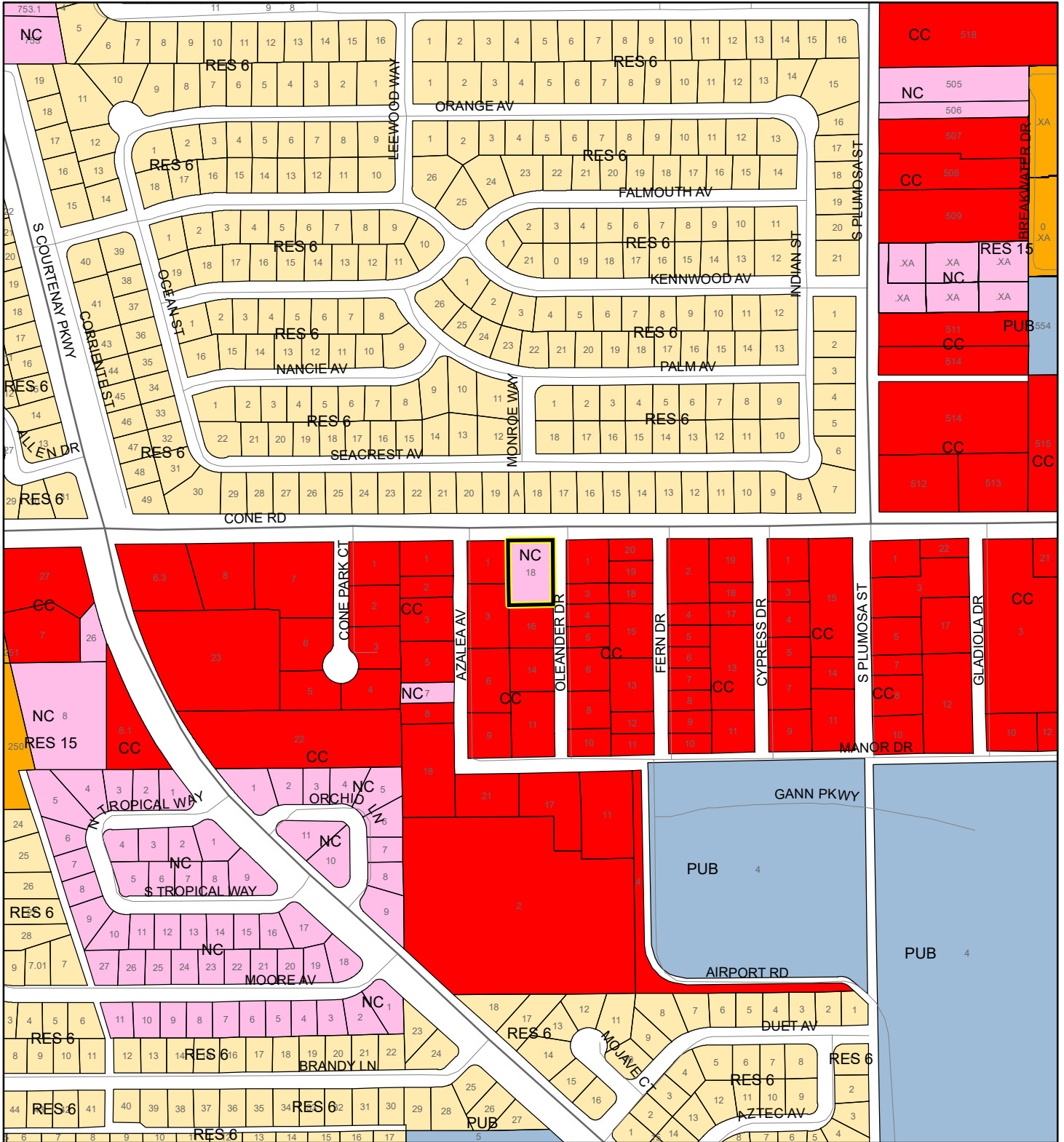

1:4,800 or 1 inch = 400 feet

- Subject Property
- Parcels

This map was compiled from recorded documents and does not reflect an actual survey. The Brevard County Board of County Commissioners does not assume responsibility for errors or omissions hereon.

Produced by BoCC - GIS Date: 1/22/2021

PROPOSED FUTURE LAND USE MAP

VAN HORN, ROBERT AND HOUCK, GERALD K.
21PZ00001 SMALL SCALE AMENDMENT 21S.01

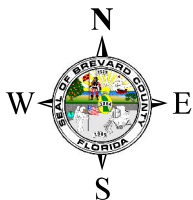
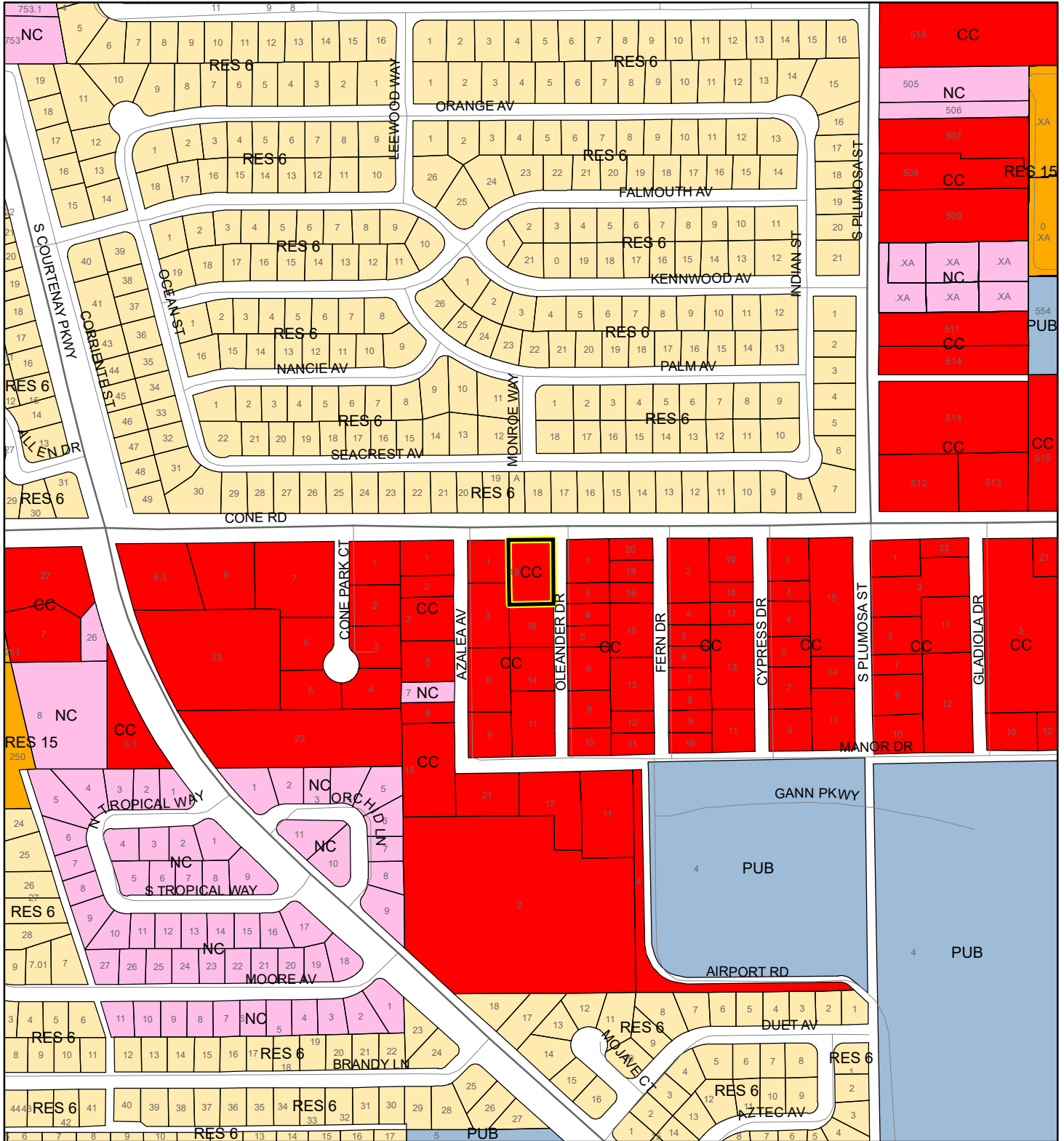

1:4,800 or 1 inch = 400 feet

- Subject Property
- Parcels

This map was compiled from recorded documents and does not reflect an actual survey. The Brevard County Board of County Commissioners does not assume responsibility for errors or omissions hereon.

Produced by BoCC - GIS Date: 1/22/2021

AERIAL MAP

VAN HORN, ROBERT AND HOUCK, GERALD K.
21PZ00001 SMALL SCALE AMENDMENT 21S.01

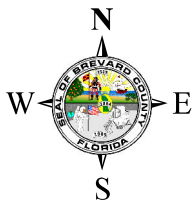

1:2,400 or 1 inch = 200 feet

PHOTO YEAR: 2020

This map was compiled from recorded documents and does not reflect an actual survey. The Brevard County Board of County Commissioners does not assume responsibility for errors or omissions hereon.

Produced by BoCC - GIS Date: 1/22/2021

 Subject Property

 Parcels

NWI WETLANDS MAP

VAN HORN, ROBERT AND HOUCK, GERALD K.
21PZ00001 SMALL SCALE AMENDMENT 21S.01

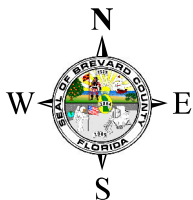
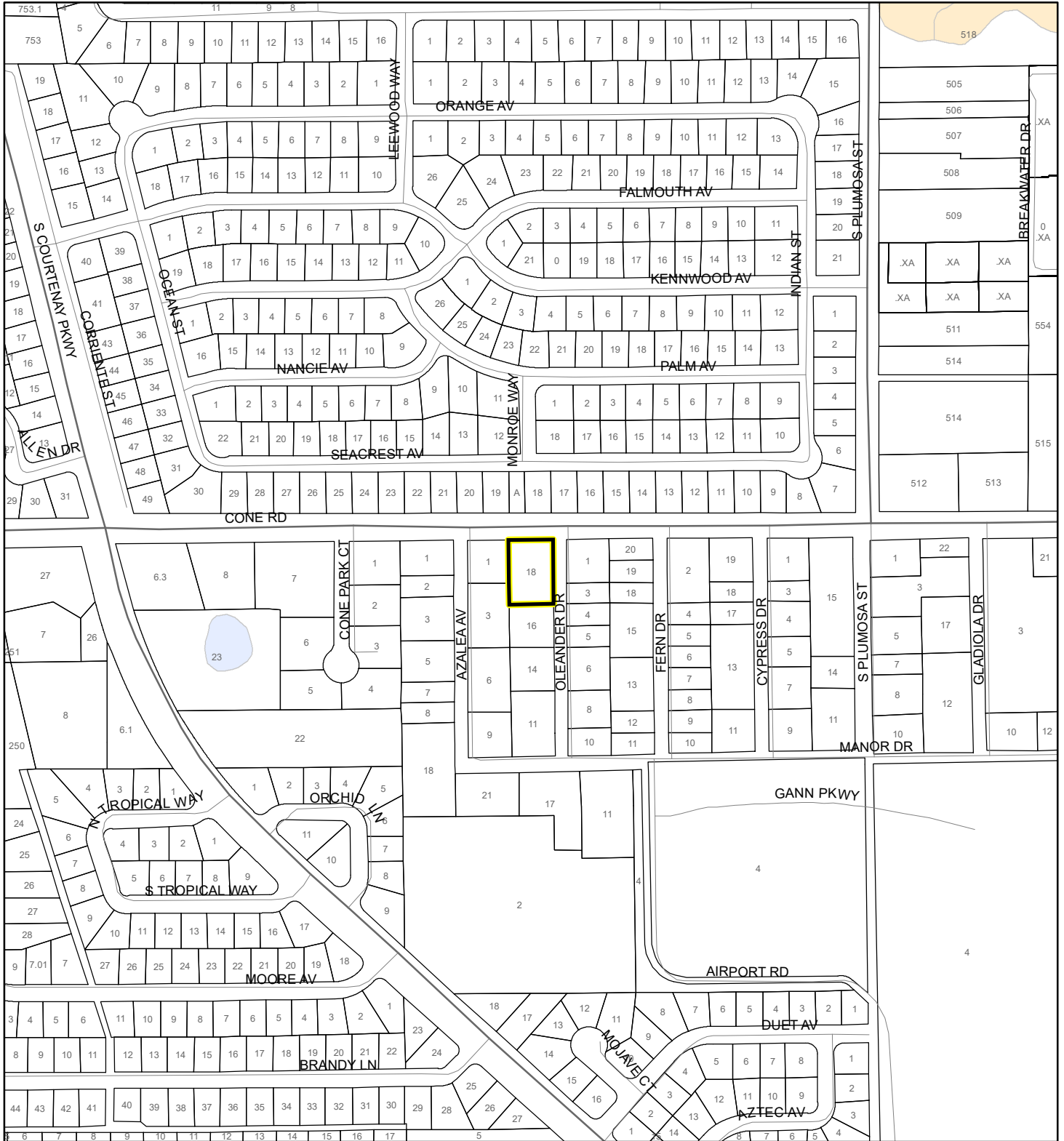











1:4,800 or 1 inch = 400 feet

This map was compiled from recorded documents and does not reflect an actual survey. The Brevard County Board of County Commissioners does not assume responsibility for errors or omissions hereon.

Produced by BoCC - GIS Date: 1/22/2021

National Wetlands Inventory (NWI)

- | | |
|--|--|
|  Estuarine and Marine Deepwater |  Freshwater Pond |
|  Estuarine and Marine Wetland |  Lake |
|  Freshwater Emergent Wetland |  Other |
|  Freshwater Forested/Shrub Wetland |  Riverine |
| |  Subject Property |
| |  Parcels |

SJRWMD FLUCCS WETLANDS - 6000 Series MAP

VAN HORN, ROBERT AND HOUCK, GERALD K.
21PZ00001 SMALL SCALE AMENDMENT 21S.01

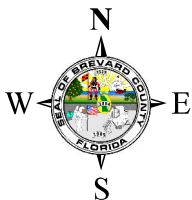
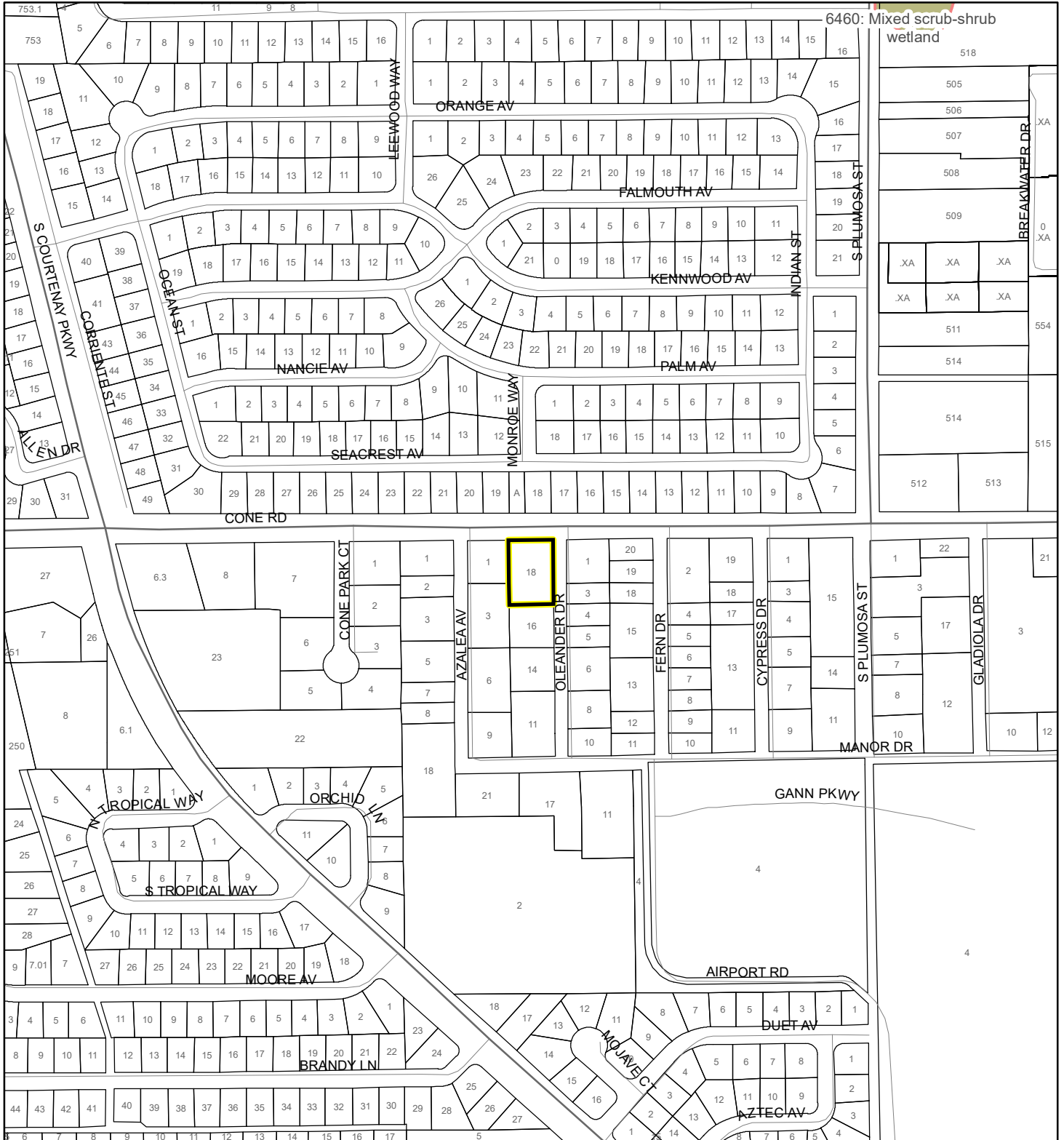

1:4,800 or 1 inch = 400 feet

This map was compiled from recorded documents and does not reflect an actual survey. The Brevard County Board of County Commissioners does not assume responsibility for errors or omissions hereon.

Produced by BoCC - GIS Date: 1/22/2021

SJRWMD FLUCCS WETLANDS

- Wetland Hardwood Forests - Series 6100
- Wetland Coniferous Forest - Series 6200
- Wetland Forested Mixed - Series 6300
- Vegetated Non-Forested Wetlands - Series 6400
- Non-Vegetated Wetland - Series 6500

Subject Property

Parcels



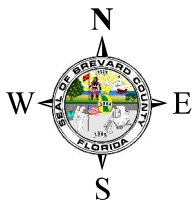
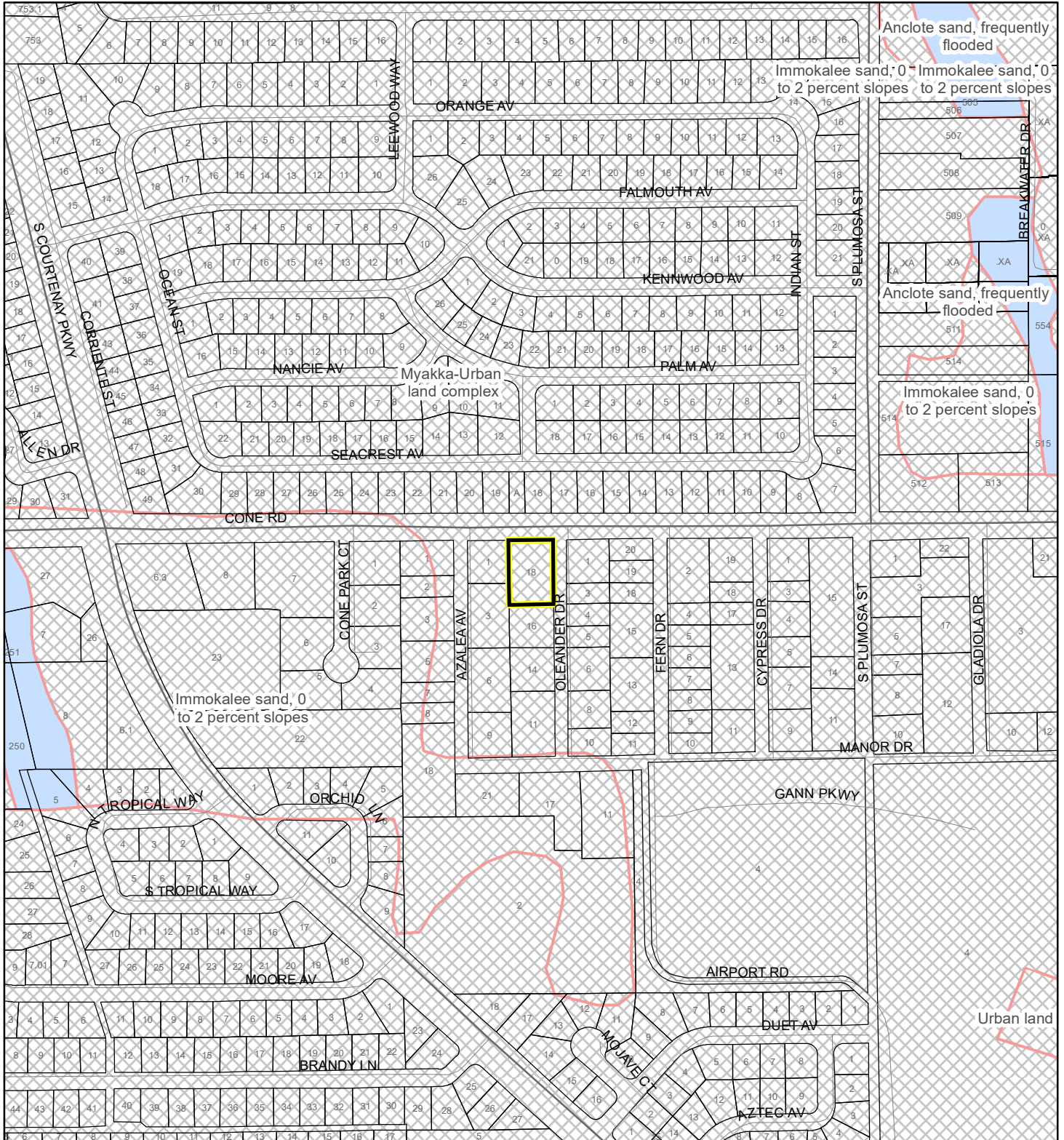

USDA SCSSS SOILS MAP

VAN HORN, ROBERT AND HOUCK, GERALD K.
21PZ0001 SMALL SCALE AMENDMENT 21S.01



1:4,800 or 1 inch = 400 feet

USDA SCSSS Soils

-  Aquifer and Hydric
-  Aquifer
-  Hydric
-  None

 Subject Property

 Parcels

This map was compiled from recorded documents and does not reflect an actual survey. The Brevard County Board of County Commissioners does not assume responsibility for errors or omissions hereon.

Produced by BoCC - GIS Date: 1/22/2021

FEMA FLOOD ZONES MAP

VAN HORN, ROBERT AND HOUCK, GERALD K.
21PZ00001 SMALL SCALE AMENDMENT 21S.01

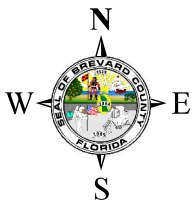
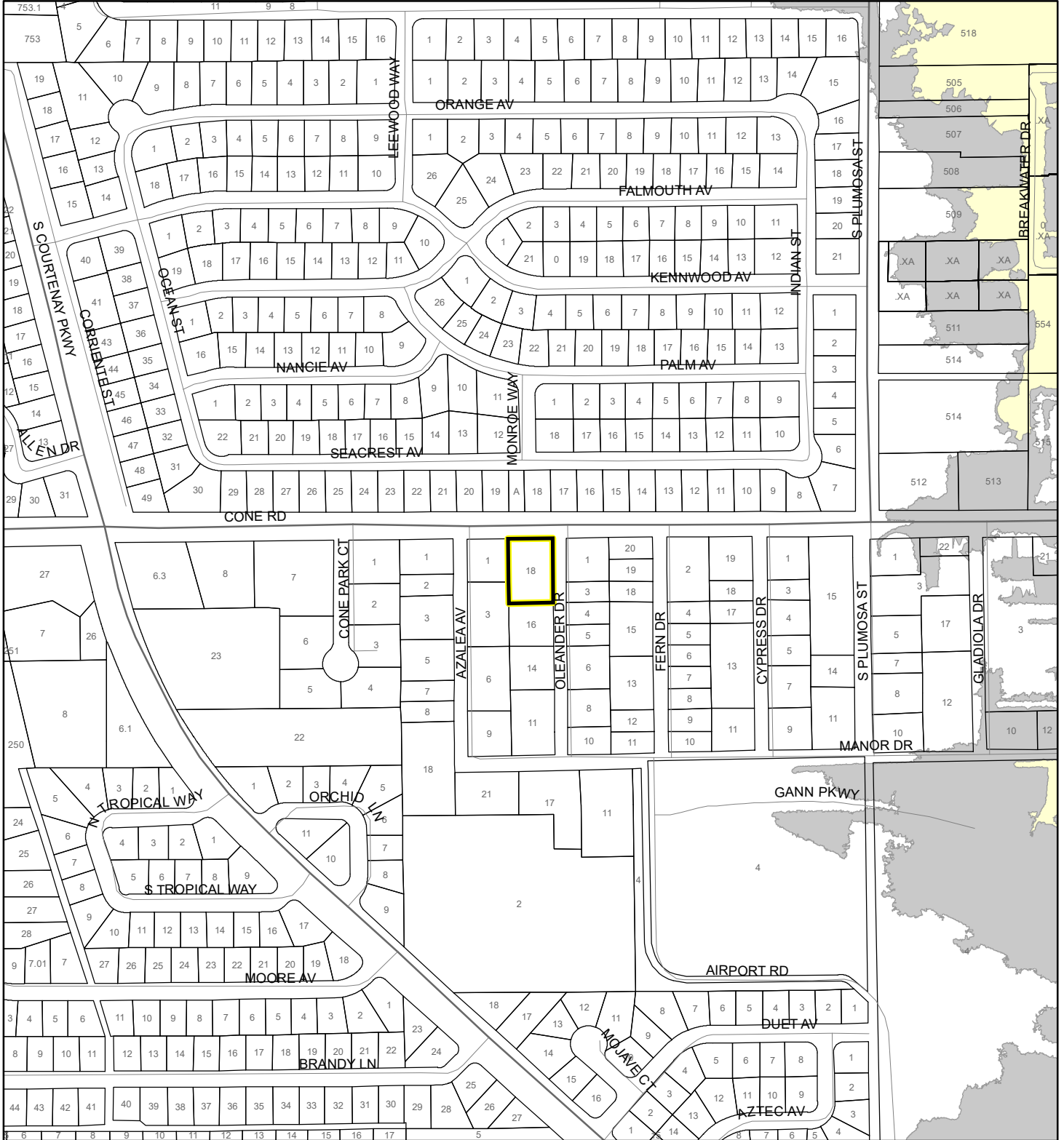

1:4,800 or 1 inch = 400 feet

This map was compiled from recorded documents and does not reflect an actual survey. The Brevard County Board of County Commissioners does not assume responsibility for errors or omissions hereon.

Produced by BoCC - GIS Date: 1/22/2021

FEMA Flood Zones

- | | | |
|---|------------|----------------------|
| A | AO | X |
| AE | Open Water | X Protected By Levee |
| AH | VE | |
| 0.2 Percent Annual Chance Flood Hazard | | |
| 0.2 Percent Annual Chance Flood Hazard Contained in Channel | | |
| Subject Property | | Parcels |

COASTAL HIGH HAZARD AREA MAP

VAN HORN, ROBERT AND HOUCK, GERALD K.
21PZ00001 SMALL SCALE AMENDMENT 21S.01

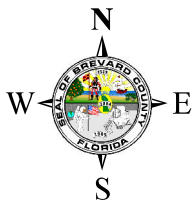
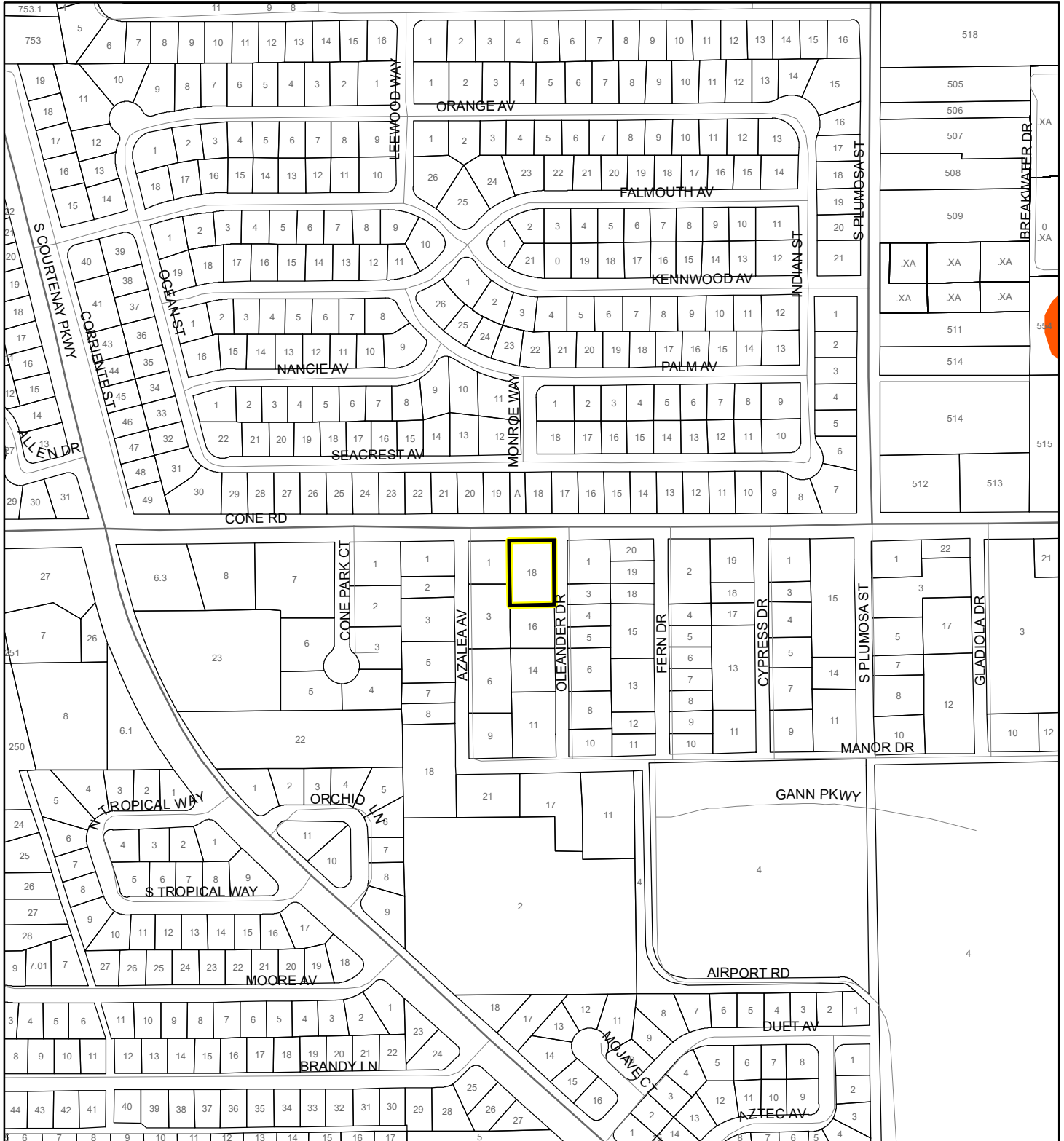

1:4,800 or 1 inch = 400 feet

This map was compiled from recorded documents and does not reflect an actual survey. The Brevard County Board of County Commissioners does not assume responsibility for errors or omissions hereon.

Produced by BoCC - GIS Date: 1/22/2021

 Subject Property

 Parcels

Coastal High Hazard Area

 SurgeZoneCat1

INDIAN RIVER LAGOON SEPTIC OVERLAY MAP

VAN HORN, ROBERT AND HOUCK, GERALD K.
21PZ00001 SMALL SCALE AMENDMENT 21S.01

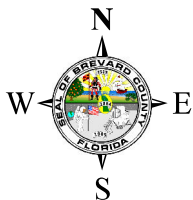
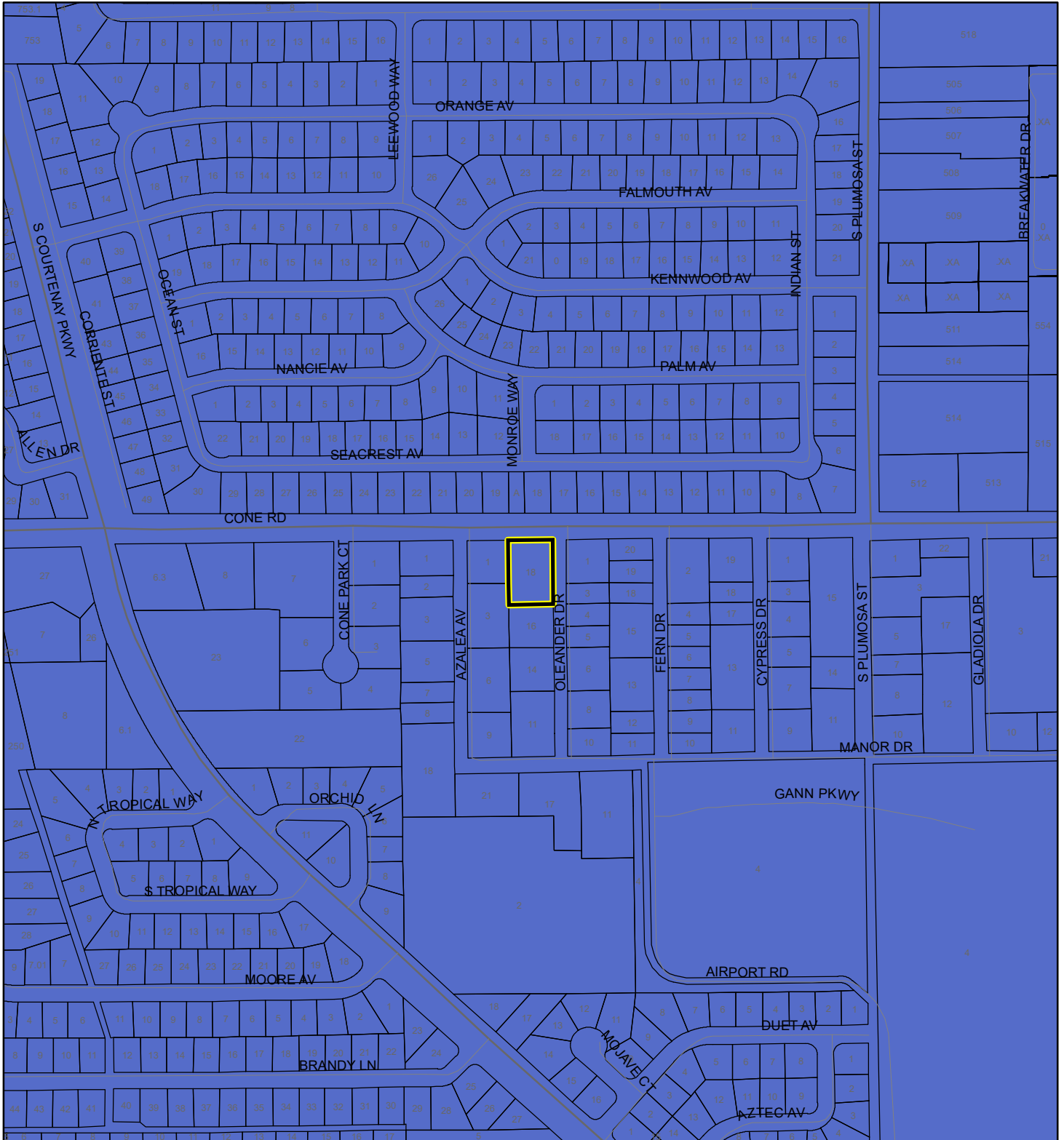

1:4,800 or 1 inch = 400 feet

This map was compiled from recorded documents and does not reflect an actual survey. The Brevard County Board of County Commissioners does not assume responsibility for errors or omissions hereon.

Produced by BoCC - GIS Date: 1/22/2021

 Subject Property

 Parcels

Septic Overlay

 40 Meters

 60 Meters

 All Distances

EAGLE NESTS MAP

VAN HORN, ROBERT AND HOUCK, GERALD K.
21PZ00001 SMALL SCALE AMENDMENT 21S.01

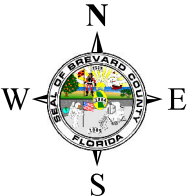
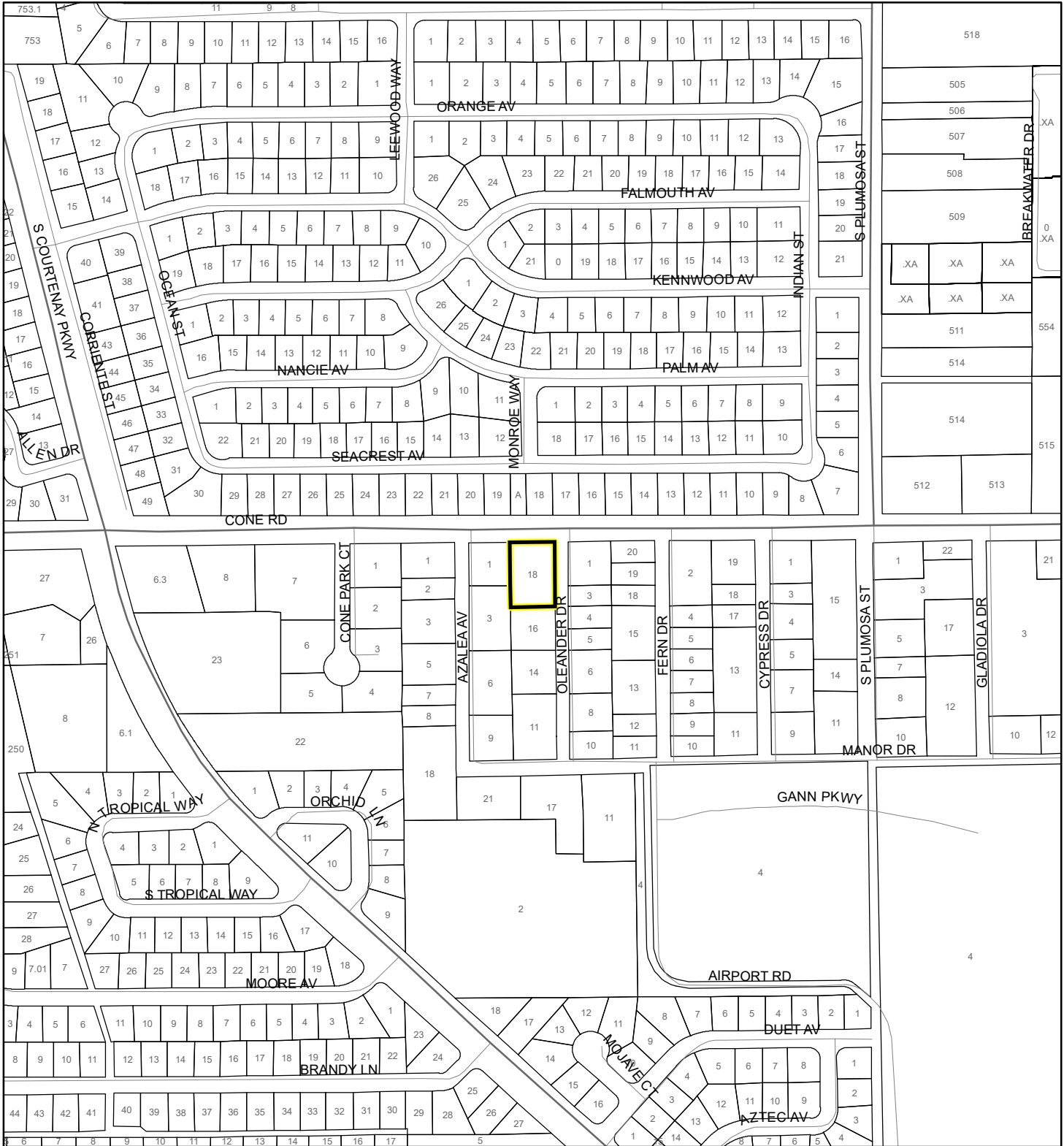

1:4,800 or 1 inch = 400 feet

 Subject Property

 Parcels

 Eagle Nests
FWS 2010

This map was compiled from recorded documents and does not reflect an actual survey. The Brevard County Board of County Commissioners does not assume responsibility for errors or omissions hereon.

Produced by BoCC - GIS Date: 1/22/2021

SCRUB JAY OCCUPANCY MAP

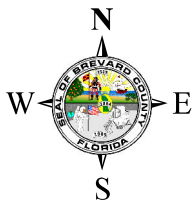
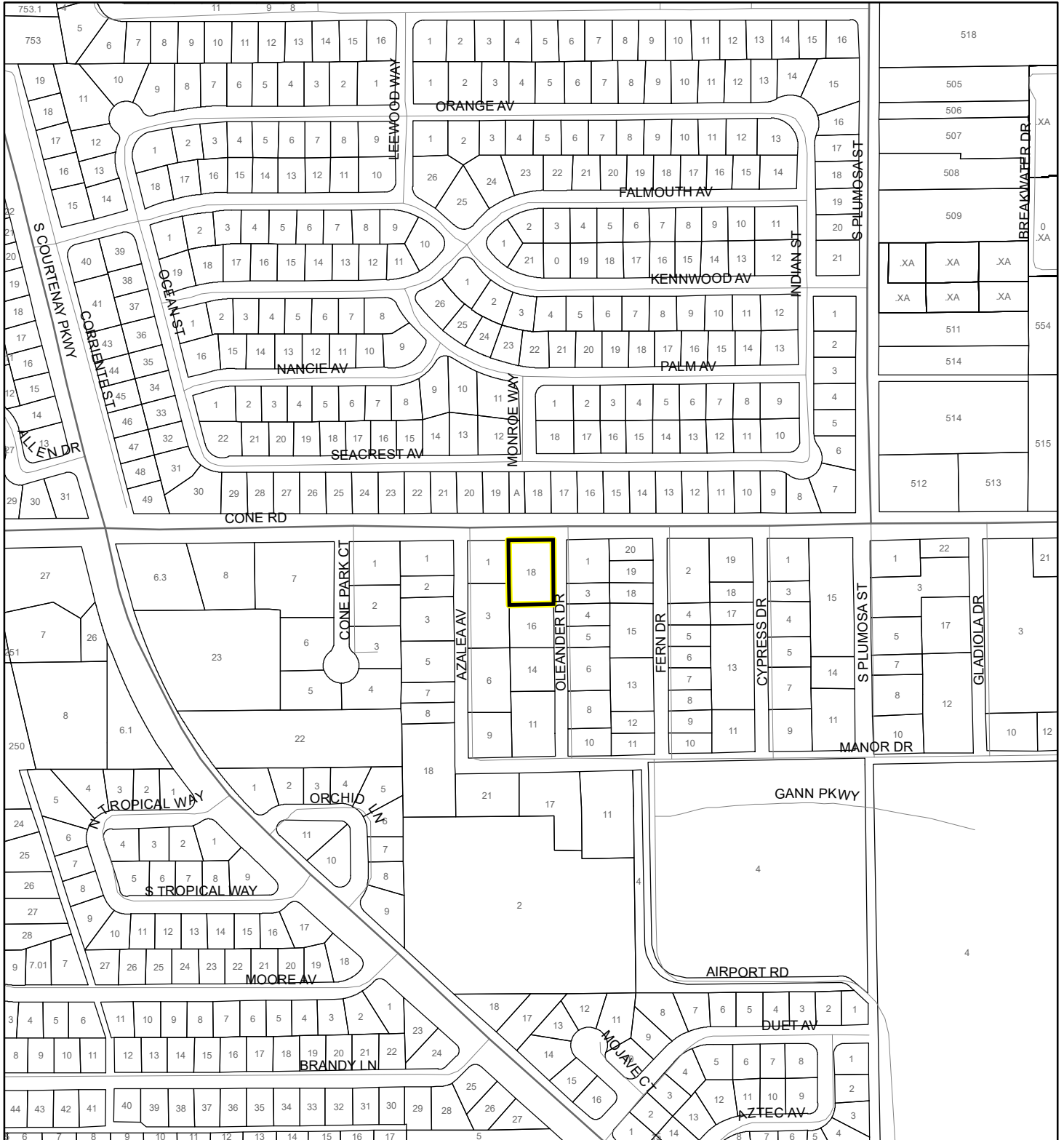

VAN HORN, ROBERT AND HOUCK, GERALD K.
21PZ00001 SMALL SCALE AMENDMENT 21S.01



1:4,800 or 1 inch = 400 feet

This map was compiled from recorded documents and does not reflect an actual survey. The Brevard County Board of County Commissioners does not assume responsibility for errors or omissions hereon.

Produced by BoCC - GIS Date: 1/22/2021

-  Subject Property
-  Parcels
-  Scrub Jay Occupancy

SJRWMD FLUCCS UPLAND FORESTS - 4000 Series MAP

VAN HORN, ROBERT AND HOUCK, GERALD K.
21PZ00001 SMALL SCALE AMENDMENT 21S.01

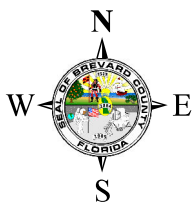
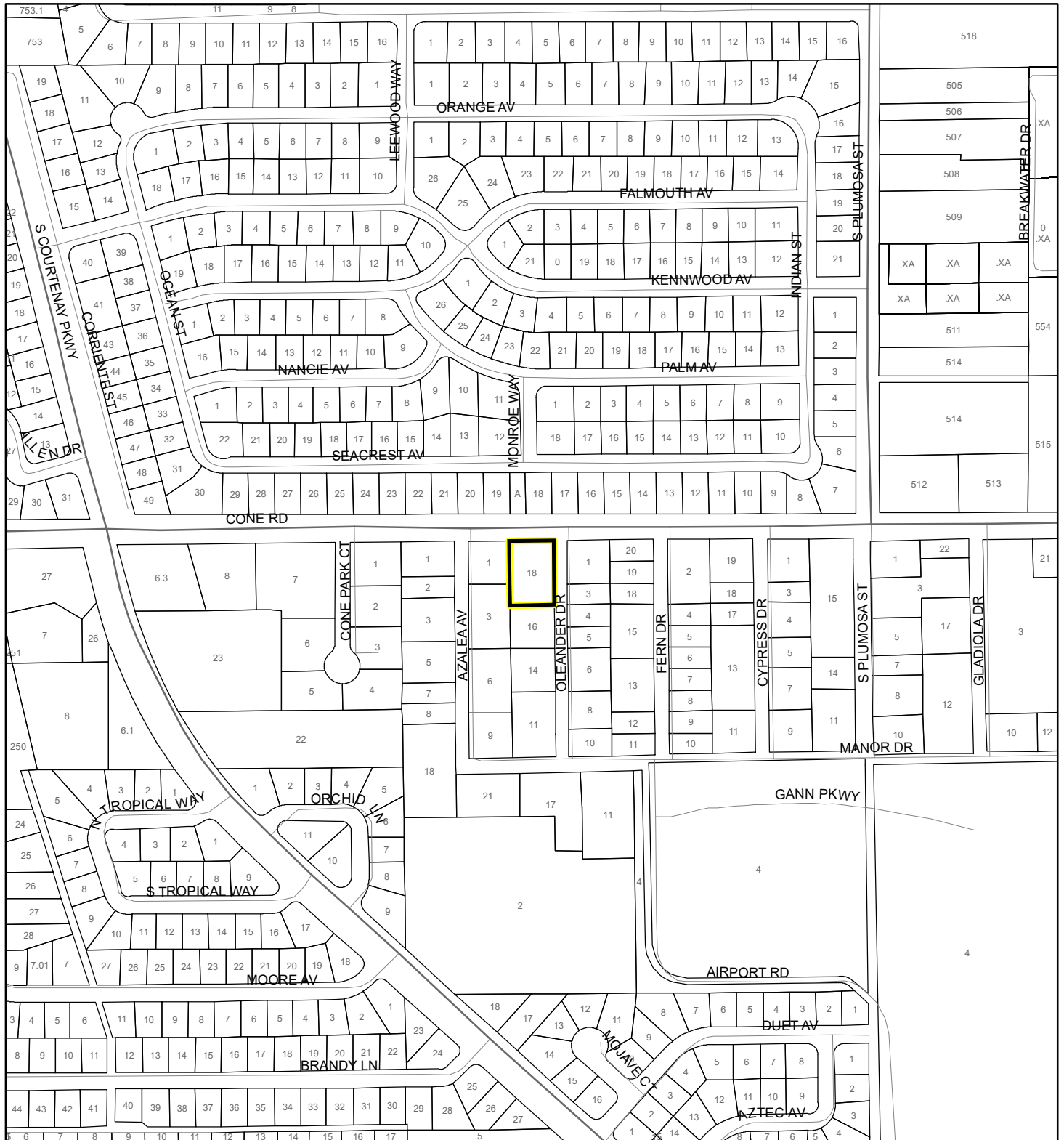

1:4,800 or 1 inch = 400 feet

This map was compiled from recorded documents and does not reflect an actual survey. The Brevard County Board of County Commissioners does not assume responsibility for errors or omissions hereon.

Produced by BoCC - GIS Date: 1/22/2021

SJRWMD FLUCCS Upland Forests

- Upland Coniferous Forest - 4100 Series
- Upland Hardwood Forest - 4200 Series
- Upland Mixed Forest - 4300 Series
- Tree Plantations - 4400 Series

Subject Property

Parcels