

LOCATION MAP

CORIS, MATTHEW WILSON AND ERIN LERAY
20PZ00042

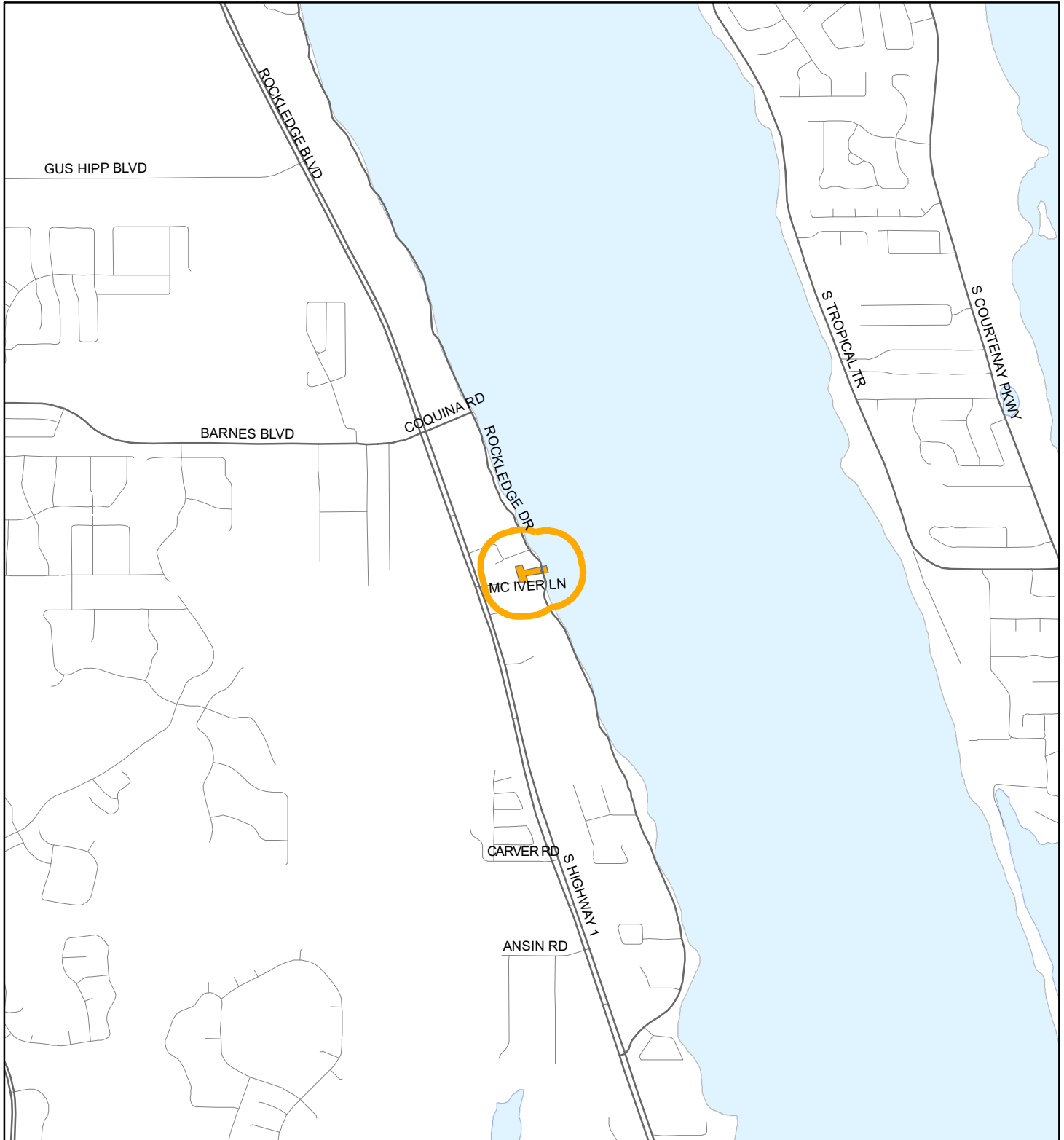



1:24,000 or 1 inch = 2,000 feet

Buffer Distance: 500 feet

This map was compiled from recorded documents and does not reflect an actual survey. The Brevard County Board of County Commissioners does not assume responsibility for errors or omissions hereon.

Produced by BoCC - GIS Date: 3/12/2020

 Buffer
 Subject Property

ZONING MAP

CORIS, MATTHEW WILSON AND ERIN LERAY

20PZ00042

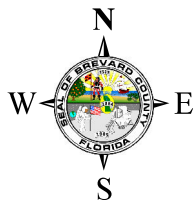
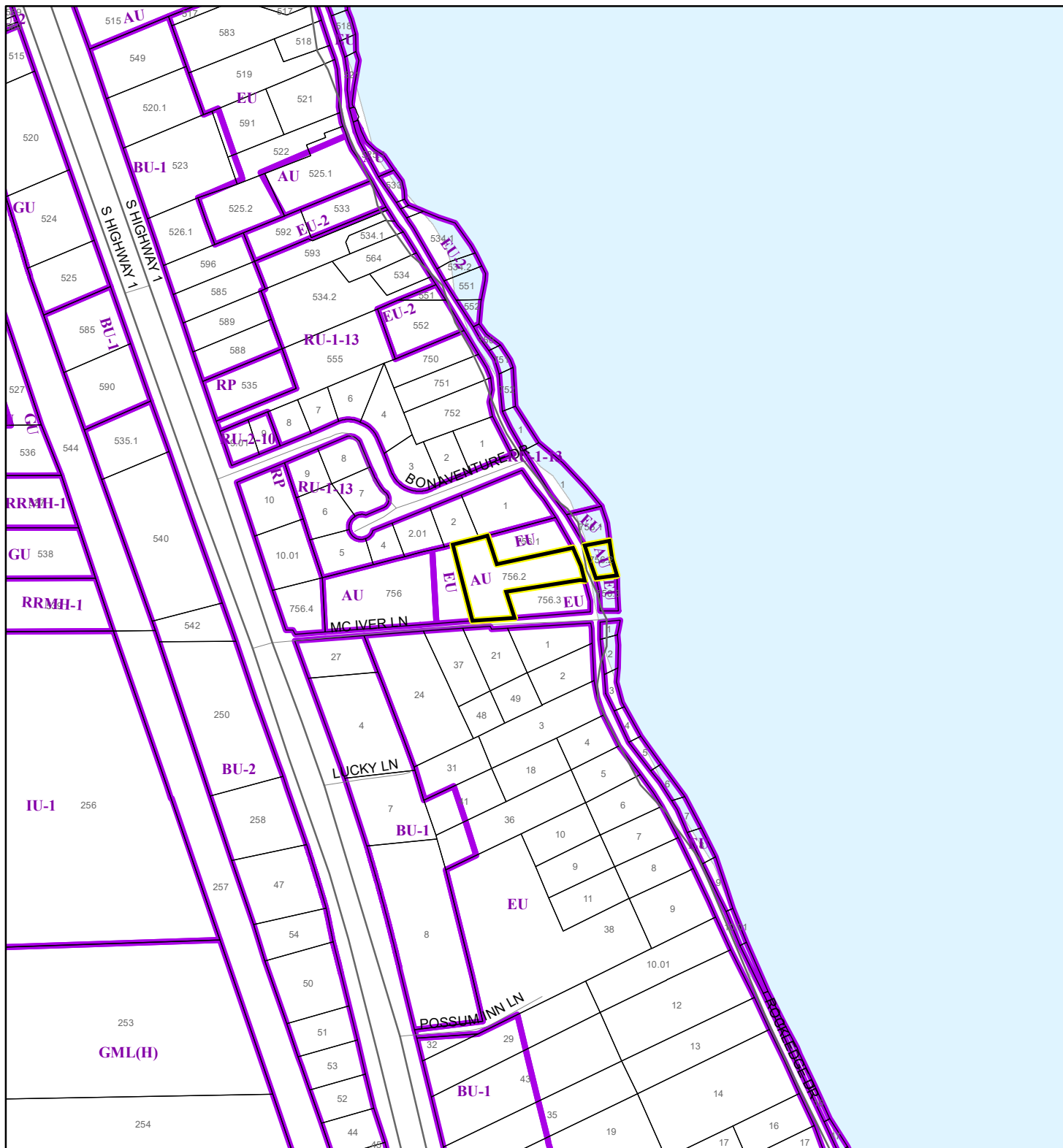

1:4,800 or 1 inch = 400 feet

This map was compiled from recorded documents and does not reflect an actual survey. The Brevard County Board of County Commissioners does not assume responsibility for errors or omissions hereon.

Produced by BoCC - GIS Date: 3/12/2020

 Subject Property

 Parcels

 Zoning

FUTURE LAND USE MAP

CORIS, MATTHEW WILSON AND ERIN LERAY

20PZ00042

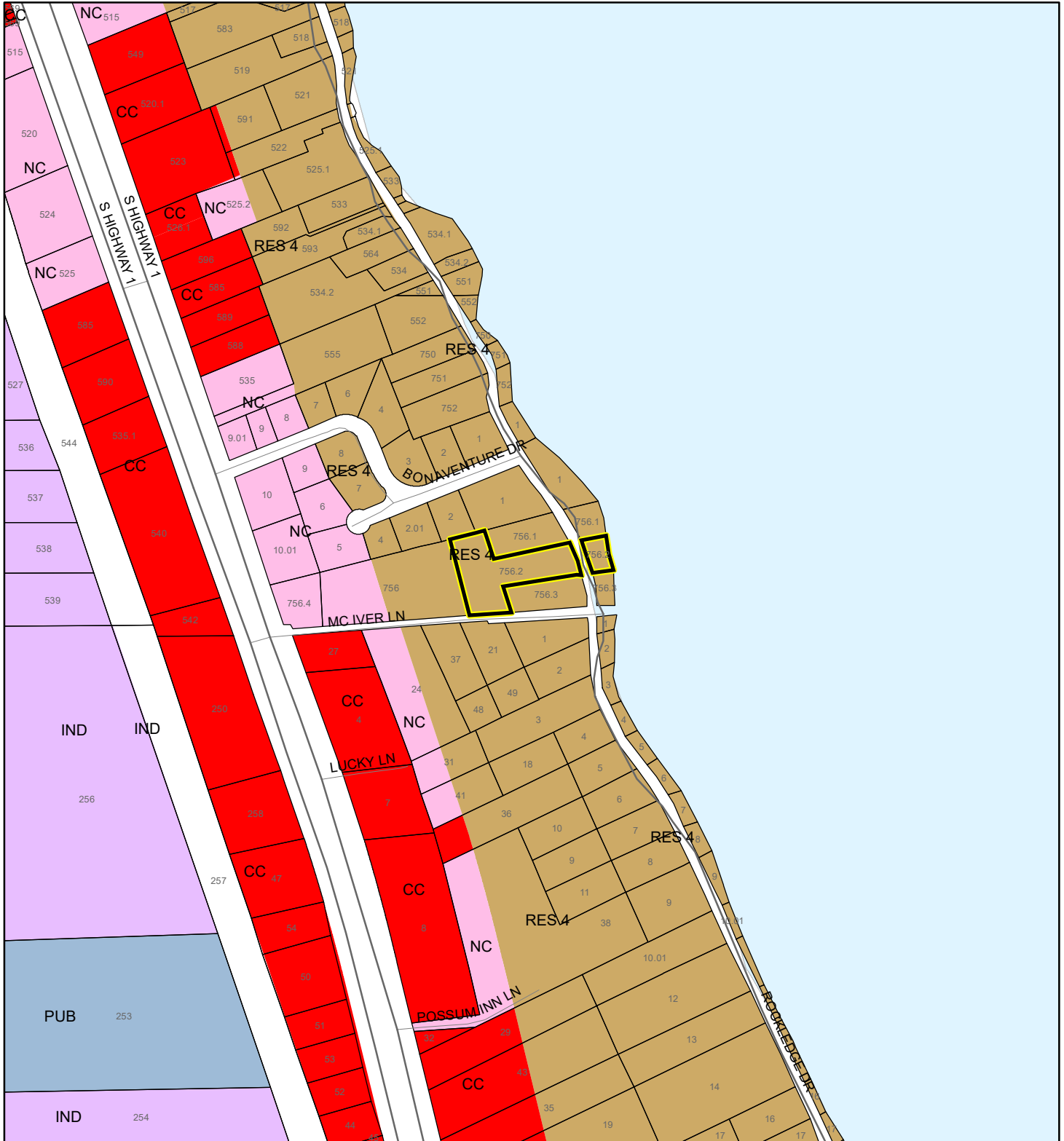

1:4,800 or 1 inch = 400 feet

Subject Property

Parcels

This map was compiled from recorded documents and does not reflect an actual survey. The Brevard County Board of County Commissioners does not assume responsibility for errors or omissions hereon.

Produced by BoCC - GIS Date: 3/12/2020

AERIAL MAP

CORIS, MATTHEW WILSON AND ERIN LERAY

20PZ00042

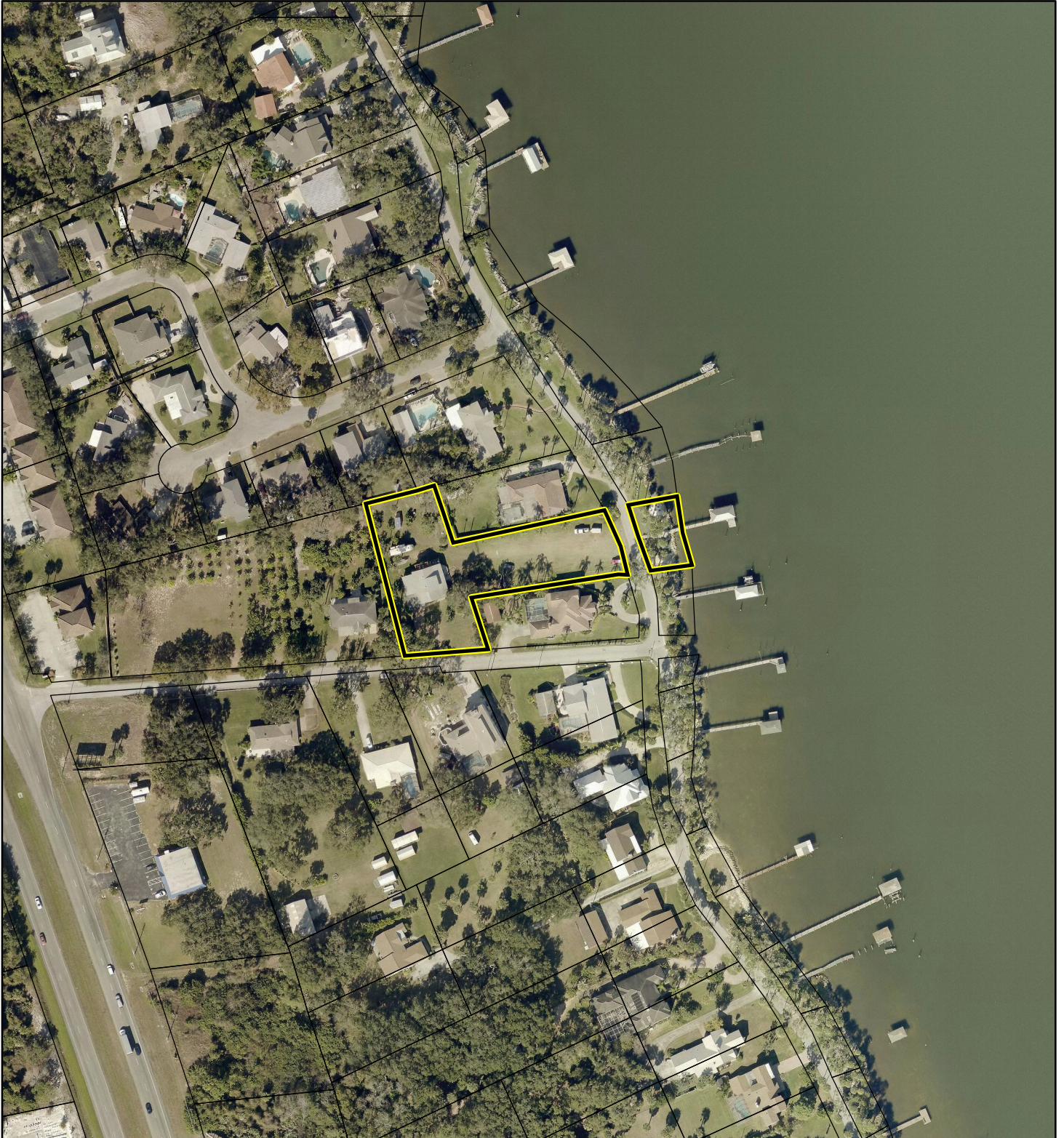

1:2,400 or 1 inch = 200 feet

PHOTO YEAR: 2019

This map was compiled from recorded documents and does not reflect an actual survey. The Brevard County Board of County Commissioners does not assume responsibility for errors or omissions hereon.

Produced by BoCC - GIS Date: 3/12/2020

 Subject Property

 Parcels

NWI WETLANDS MAP

CORIS, MATTHEW WILSON AND ERIN LERAY

20PZ00042

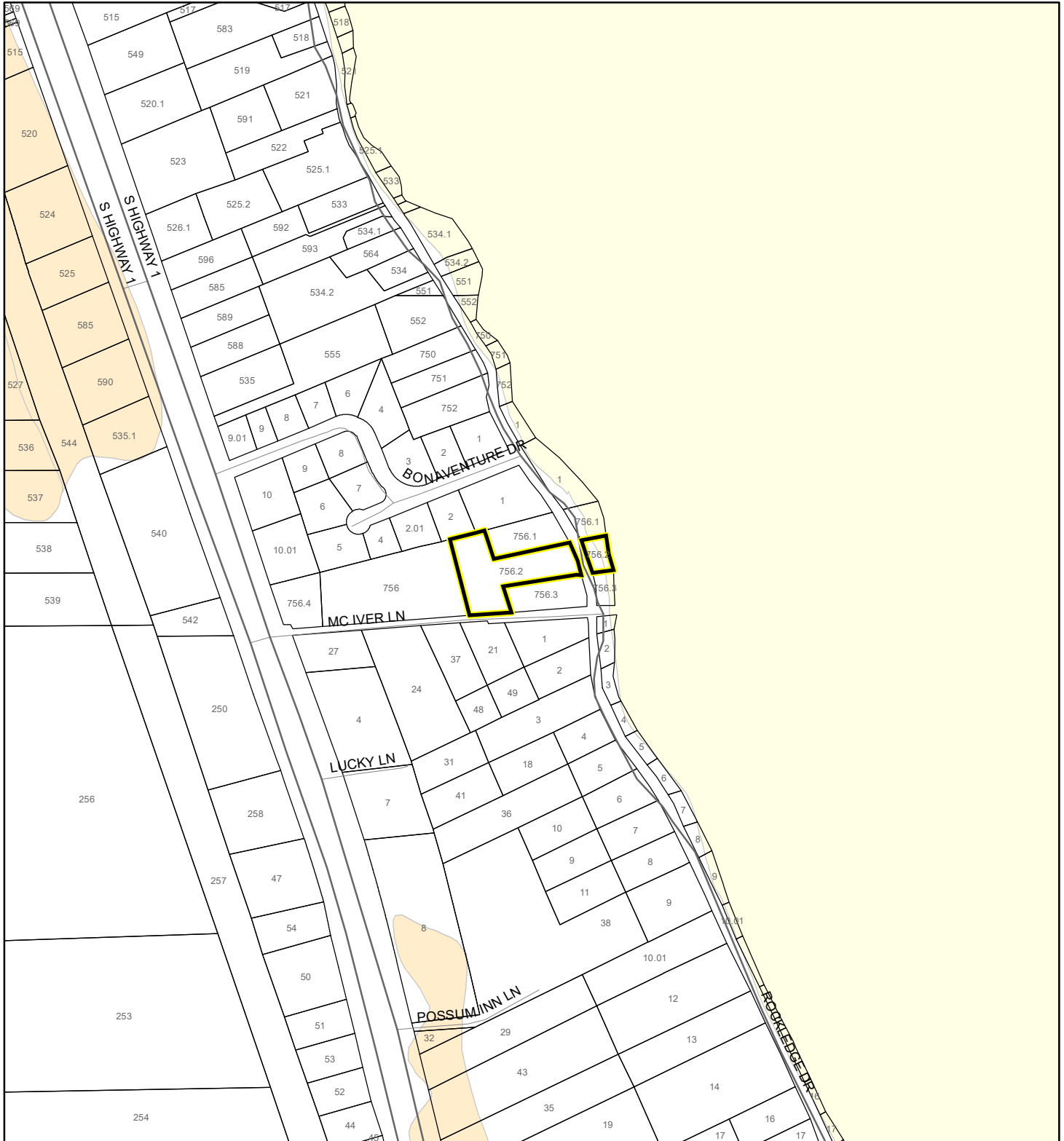









1:4,800 or 1 inch = 400 feet

This map was compiled from recorded documents and does not reflect an actual survey. The Brevard County Board of County Commissioners does not assume responsibility for errors or omissions hereon.

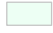
Produced by BoCC - GIS Date: 3/12/2020

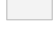
National Wetlands Inventory (NWI)

 Estuarine and Marine Deepwater	 Freshwater Pond
 Estuarine and Marine Wetland	 Lake
 Freshwater Emergent Wetland	 Other
 Freshwater Forested/Shrub Wetland	 Riverine
	 Subject Property
	 Parcels

SJRWMD FLUCCS WETLANDS - 6000 Series MAP

CORIS, MATTHEW WILSON AND ERIN LERAY

20PZ00042

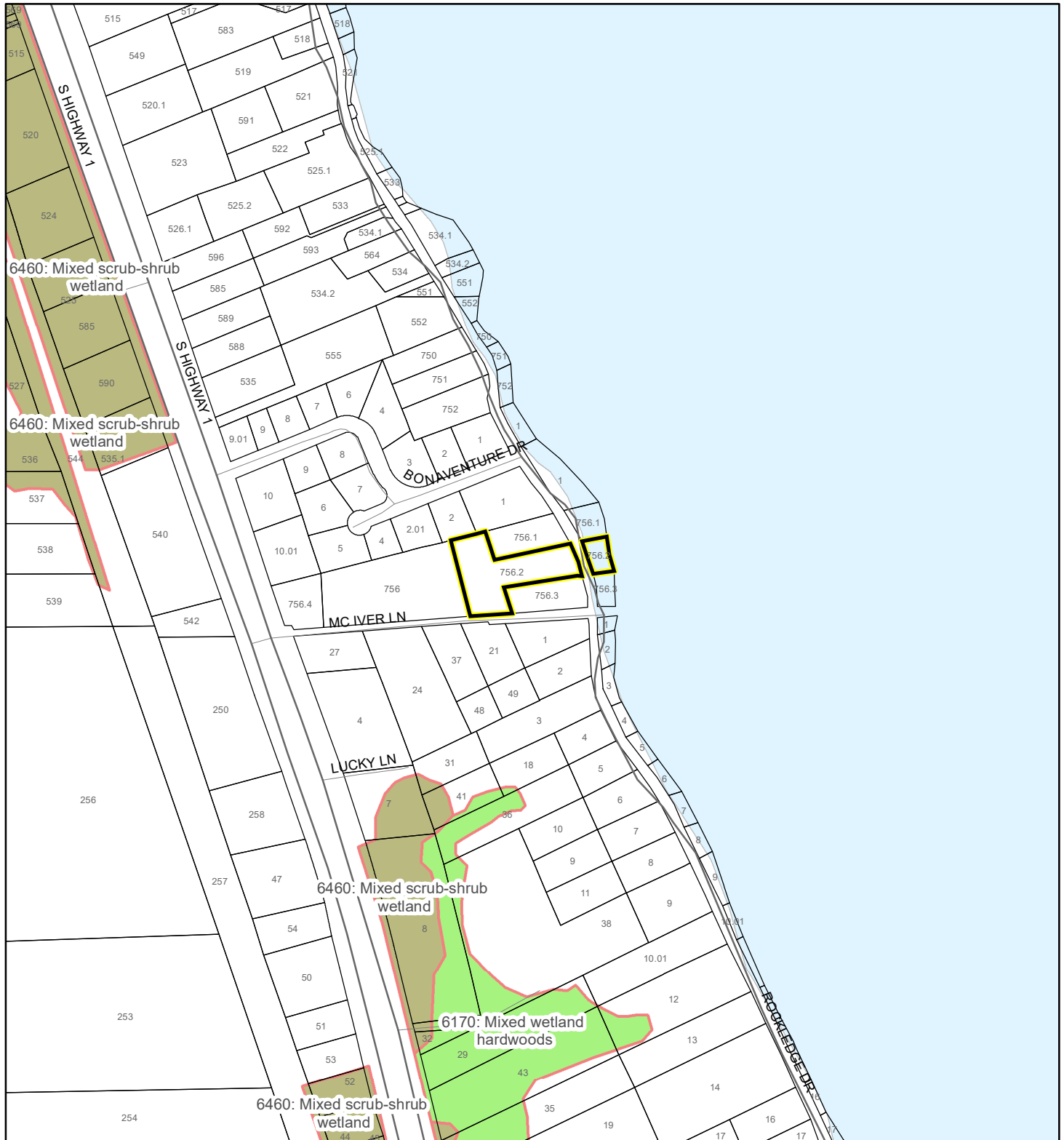

1:4,800 or 1 inch = 400 feet

This map was compiled from recorded documents and does not reflect an actual survey. The Brevard County Board of County Commissioners does not assume responsibility for errors or omissions hereon.

Produced by BoCC - GIS Date: 3/12/2020

SJRWMD FLUCCS WETLANDS

- Wetland Hardwood Forests - Series 6100
- Wetland Coniferous Forest - Series 6200
- Wetland Forested Mixed - Series 6300
- Vegetated Non-Forested Wetlands - Series 6400
- Non-Vegetated Wetland - Series 6500

Subject Property

Parcels

USDA SCSSS SOILS MAP

CORIS, MATTHEW WILSON AND ERIN LERAY

20PZ00042

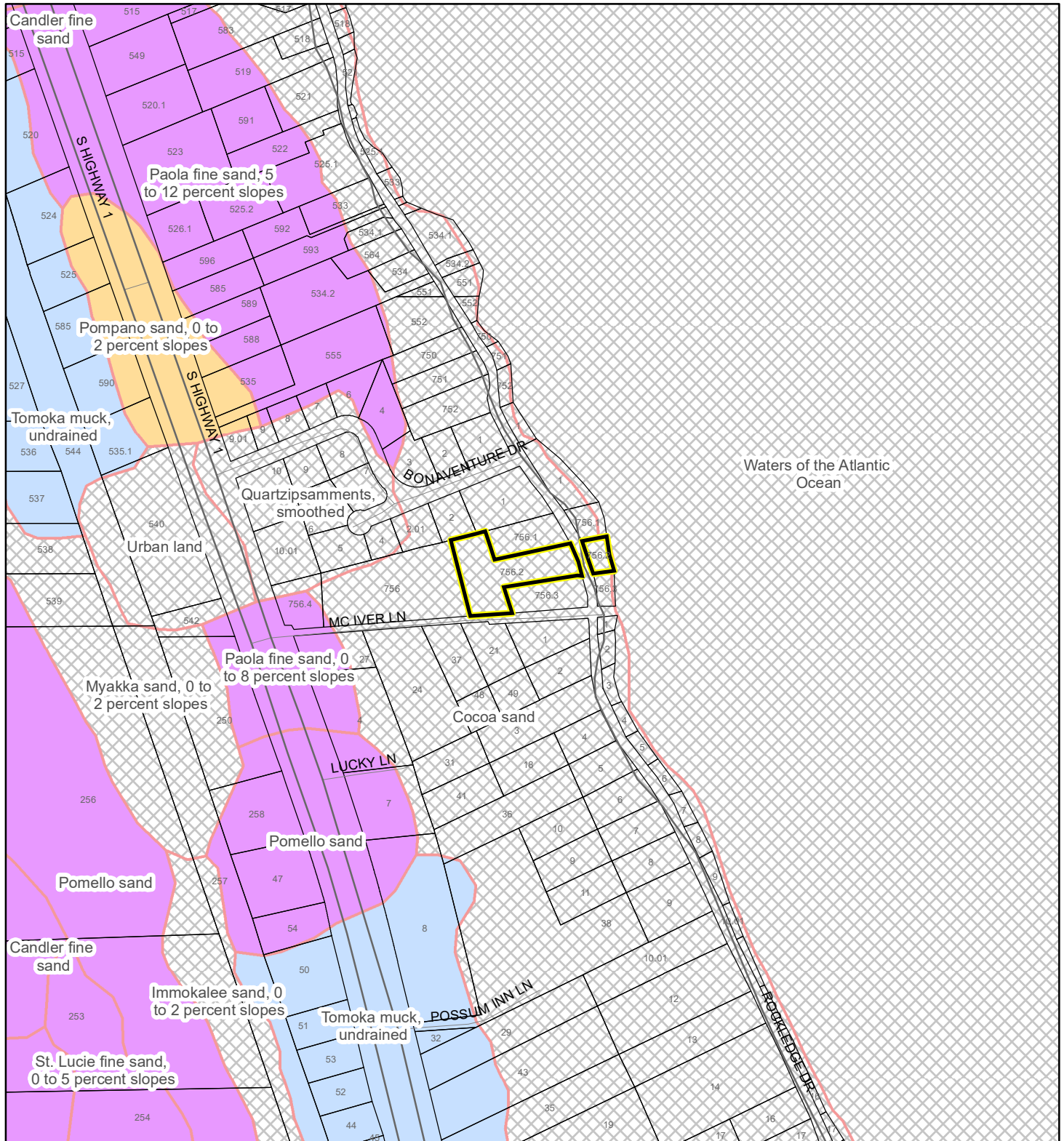

1:4,800 or 1 inch = 400 feet

This map was compiled from recorded documents and does not reflect an actual survey. The Brevard County Board of County Commissioners does not assume responsibility for errors or omissions hereon.

Produced by BoCC - GIS Date: 3/12/2020

USDA SCSSS Soils

- Aquifer and Hydric
- Aquifer
- Hydric
- None
- Subject Property
- Parcels

FEMA FLOOD ZONES MAP

CORIS, MATTHEW WILSON AND ERIN LERAY

20PZ00042

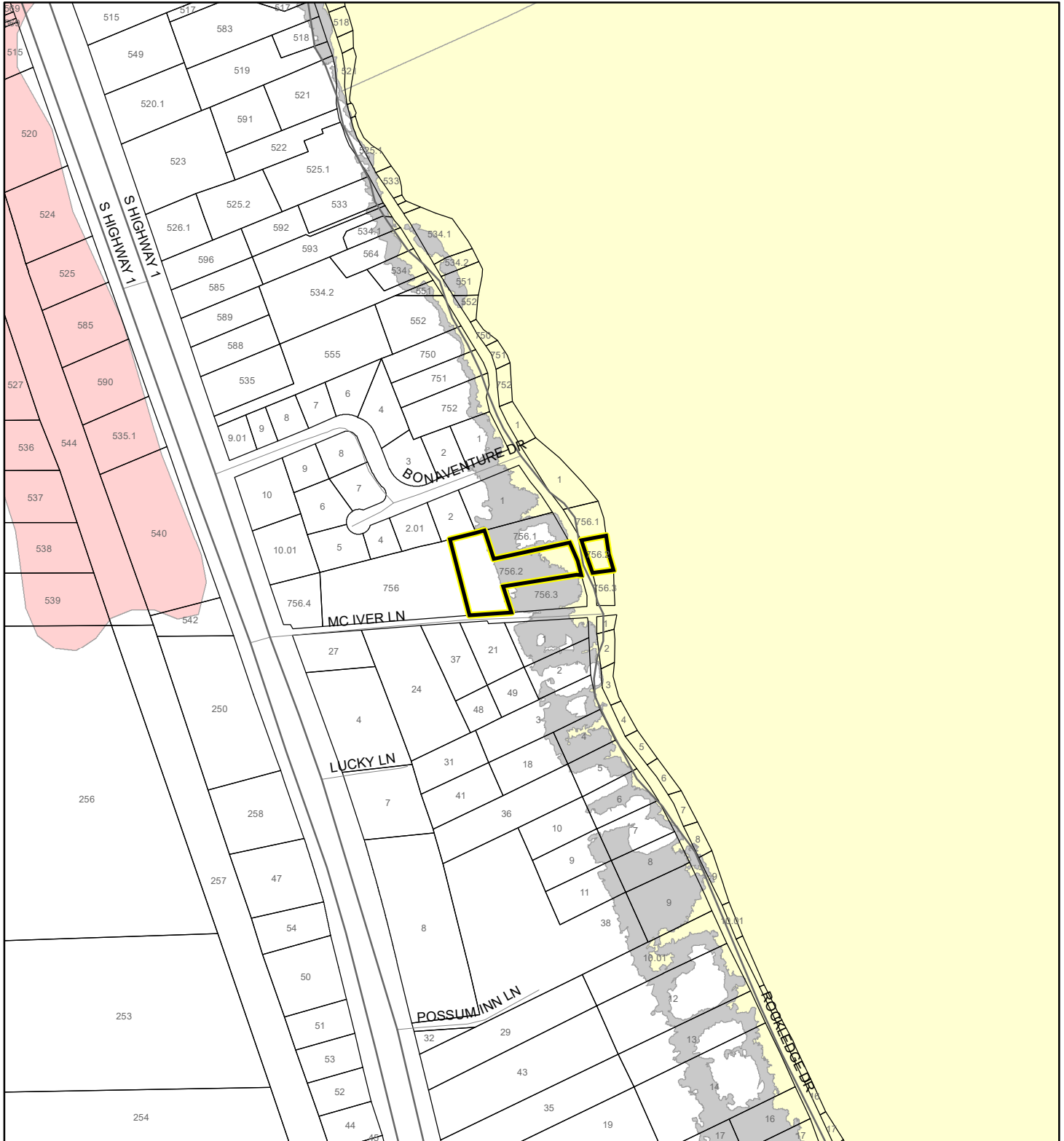

1:4,800 or 1 inch = 400 feet

This map was compiled from recorded documents and does not reflect an actual survey. The Brevard County Board of County Commissioners does not assume responsibility for errors or omissions hereon.

Produced by BoCC - GIS Date: 3/12/2020

FEMA Flood Zones

 A	 AO	 X
 AE	 Open Water	 X Protected By Levee
 AH	 VE	
 0.2 Percent Annual Chance Flood Hazard		
 0.2 Percent Annual Chance Flood Hazard Contained in Channel		
 Subject Property		 Parcels

COASTAL HIGH HAZARD AREA MAP

CORIS, MATTHEW WILSON AND ERIN LERAY

20PZ00042

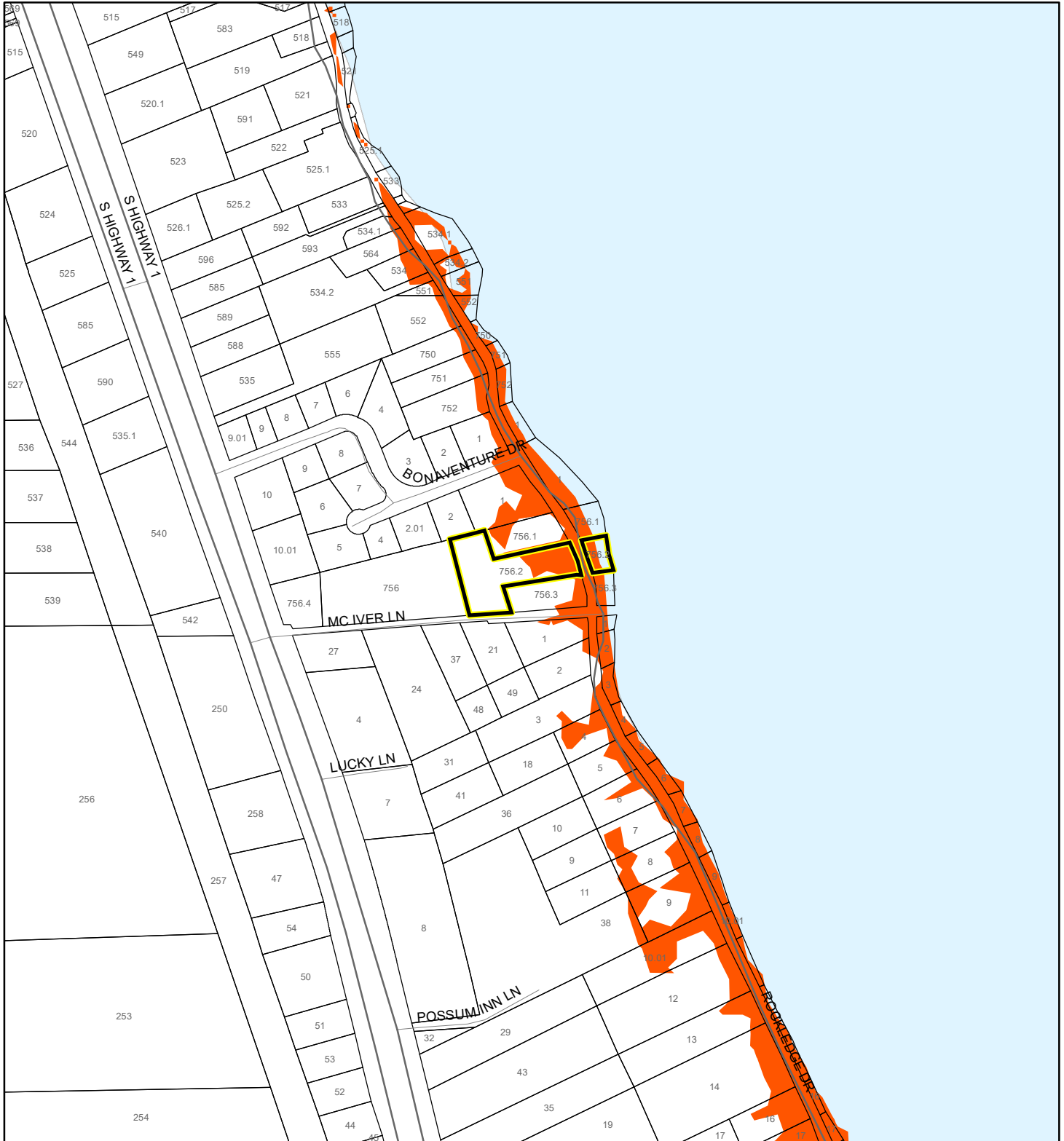

1:4,800 or 1 inch = 400 feet

This map was compiled from recorded documents and does not reflect an actual survey. The Brevard County Board of County Commissioners does not assume responsibility for errors or omissions hereon.

Produced by BoCC - GIS Date: 3/12/2020

 Subject Property

 Parcels

Coastal High Hazard Area

 SurgeZoneCat1

20PZ00042



EAGLE NESTS MAP

CORIS, MATTHEW WILSON AND ERIN LERAY

20PZ00042

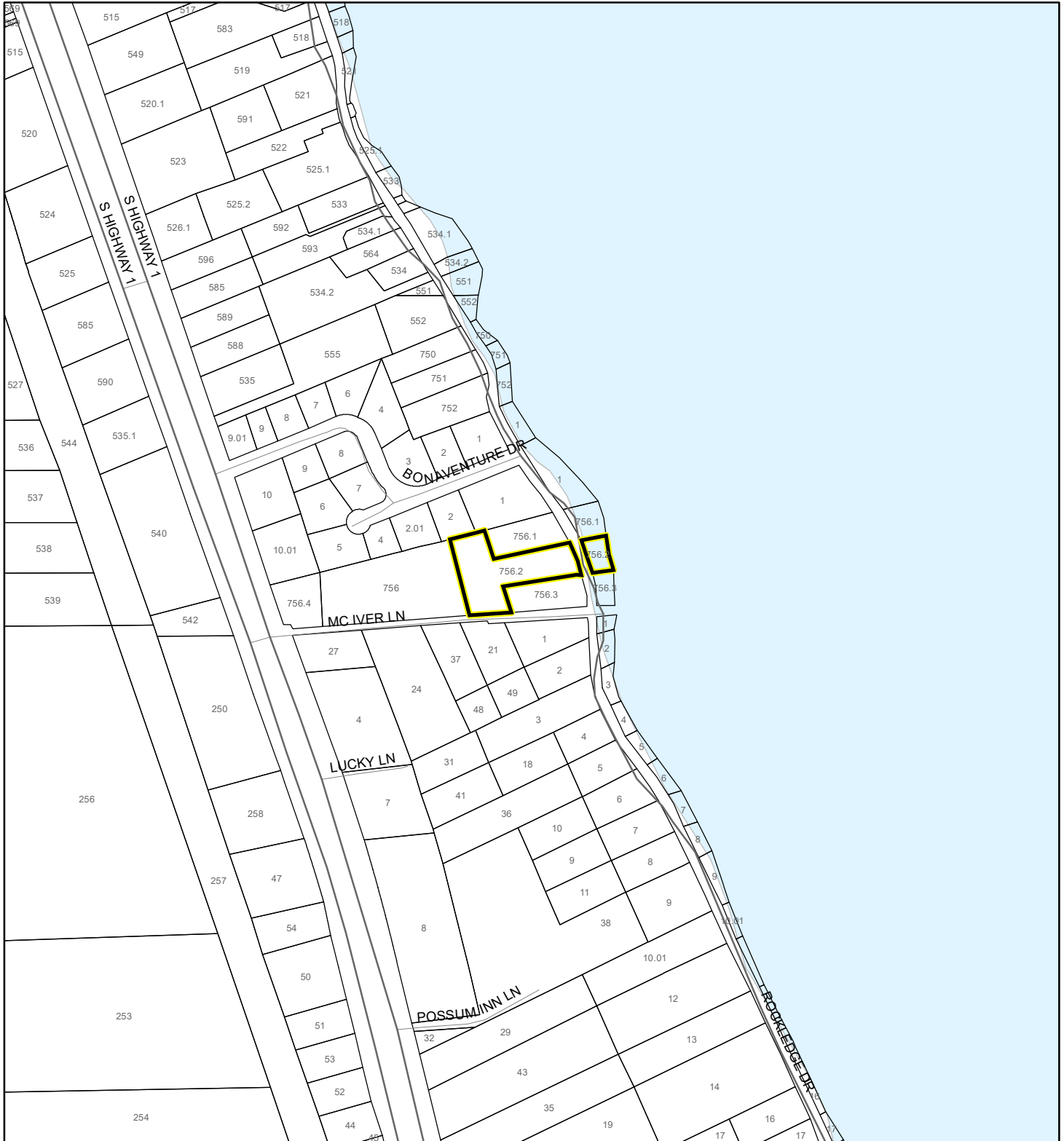

1:4,800 or 1 inch = 400 feet

This map was compiled from recorded documents and does not reflect an actual survey. The Brevard County Board of County Commissioners does not assume responsibility for errors or omissions hereon.

Produced by BoCC - GIS Date: 3/12/2020

 Subject Property

 Parcels



Eagle Nests
FWS 2010

SCRUB JAY OCCUPANCY MAP

CORIS, MATTHEW WILSON AND ERIN LERAY

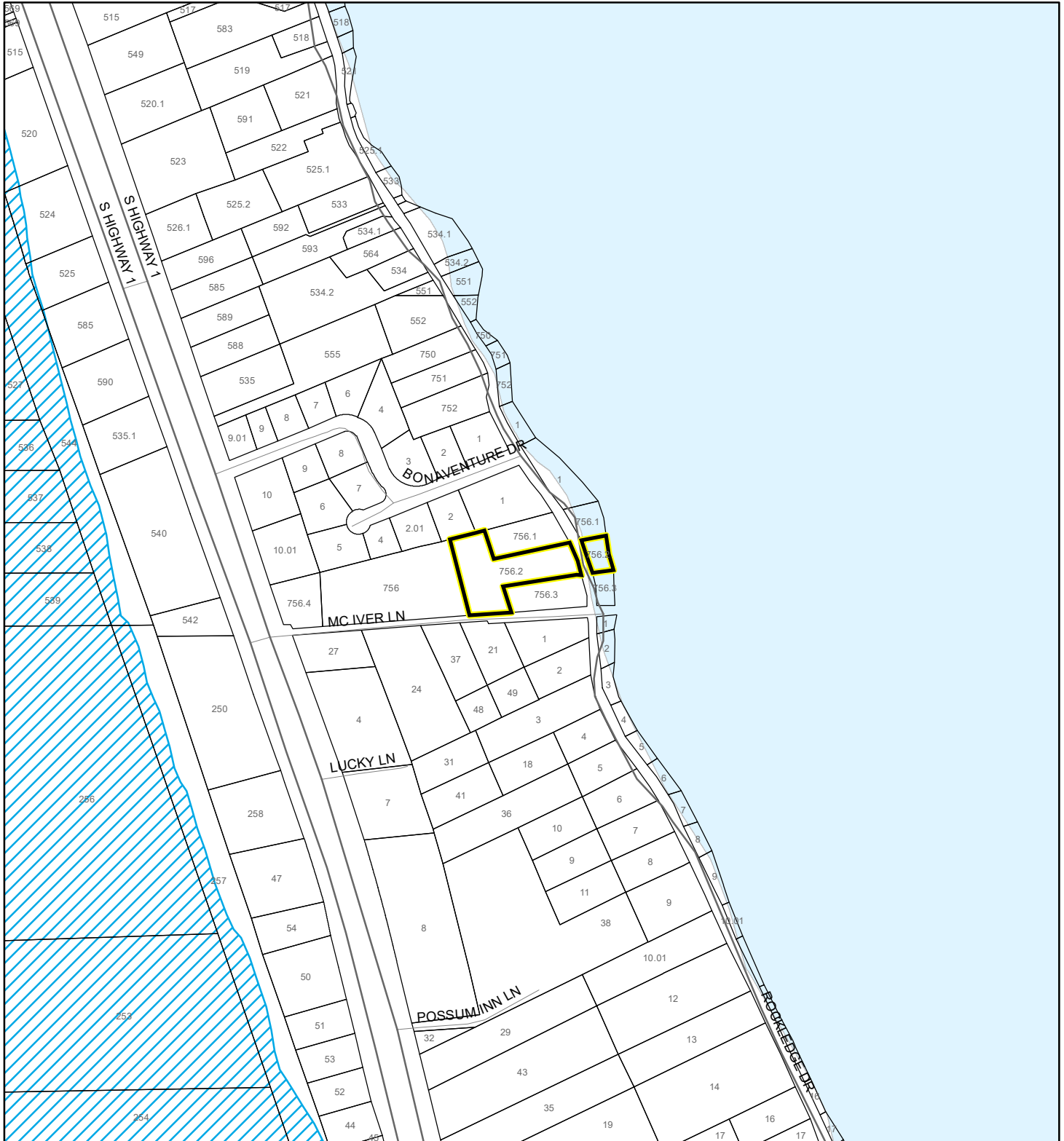

20PZ00042



1:4,800 or 1 inch = 400 feet

This map was compiled from recorded documents and does not reflect an actual survey. The Brevard County Board of County Commissioners does not assume responsibility for errors or omissions hereon.

Produced by BoCC - GIS Date: 3/12/2020

-  Subject Property
-  Parcels
-  Scrub Jay Occupancy

SJRWMD FLUCCS UPLAND FORESTS - 4000 Series MAP

CORIS, MATTHEW WILSON AND ERIN LERAY

20PZ00042

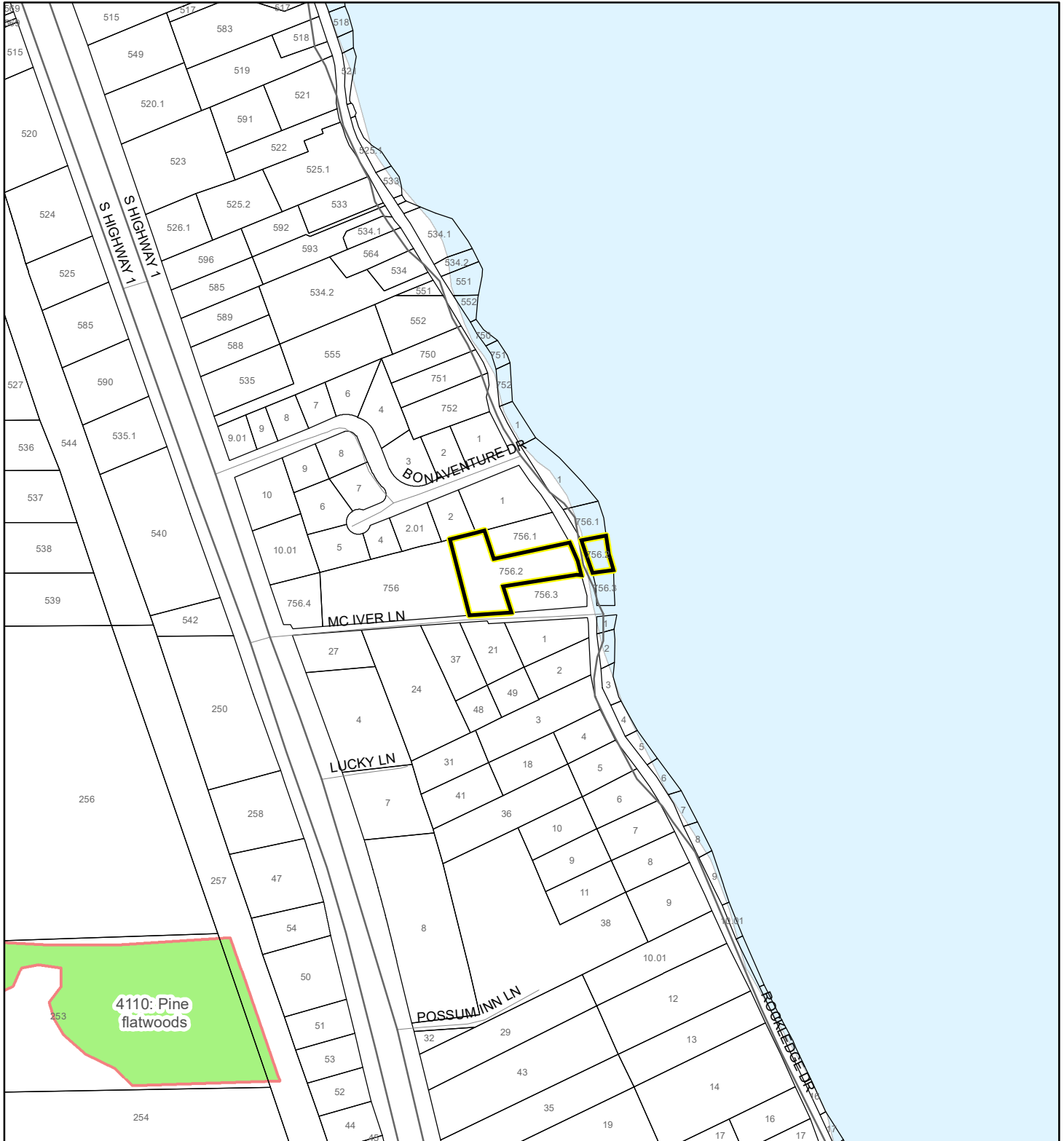

1:4,800 or 1 inch = 400 feet

This map was compiled from recorded documents and does not reflect an actual survey. The Brevard County Board of County Commissioners does not assume responsibility for errors or omissions hereon.

Produced by BoCC - GIS Date: 3/12/2020

SJRWMD FLUCCS Upland Forests

- Upland Coniferous Forest - 4100 Series
- Upland Hardwood Forest - 4200 Series
- Upland Mixed Forest - 4300 Series
- Tree Plantations - 4400 Series

Subject Property Parcels