

LOCATION MAP

Morak, Matthew & Christine
23Z00010

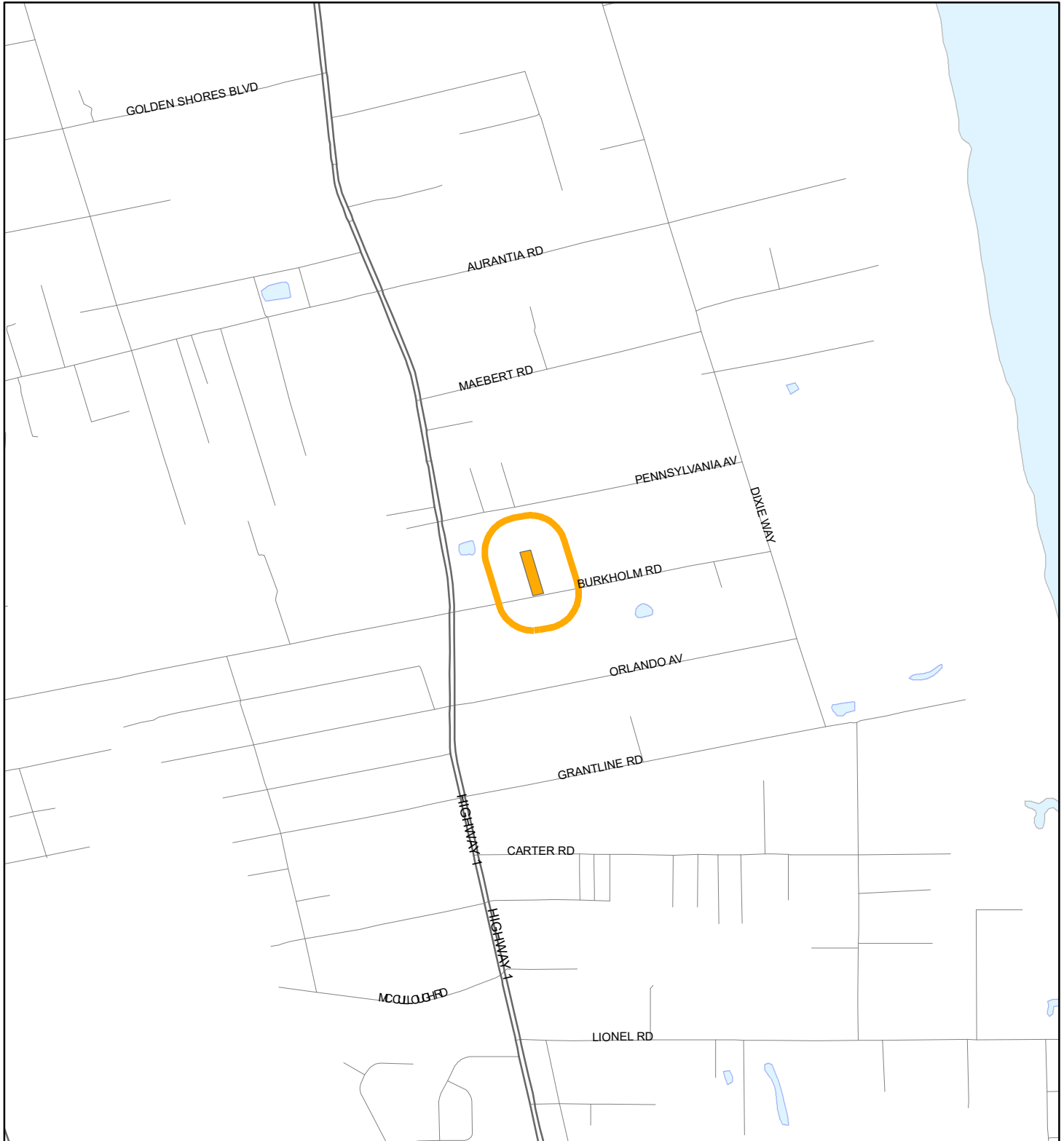



1:24,000 or 1 inch = 2,000 feet

Buffer Distance: 500 feet

This map was compiled from recorded documents and does not reflect an actual survey. The Brevard County Board of County Commissioners does not assume responsibility for errors or omissions hereon.

Produced by BoCC - GIS Date: 2/28/2023

 Buffer
 Subject Property

Morak, Matthew & Christine
23Z00010

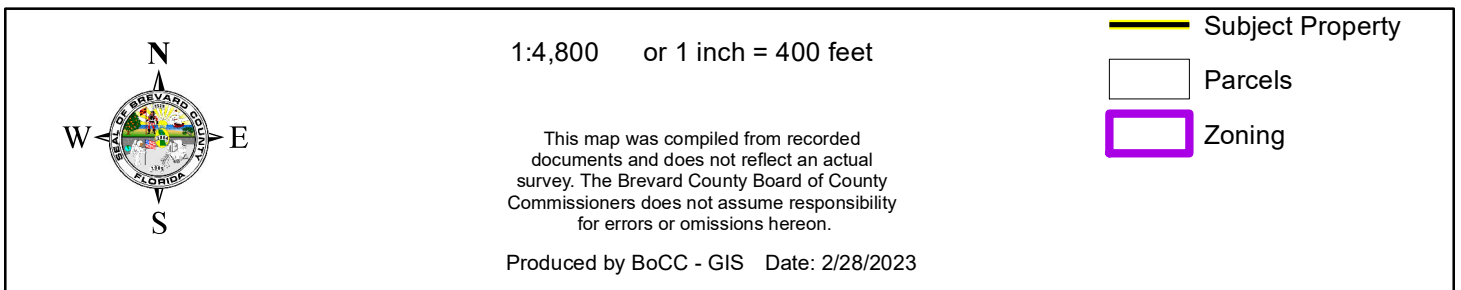

Morak, Matthew & Christine
23Z00010

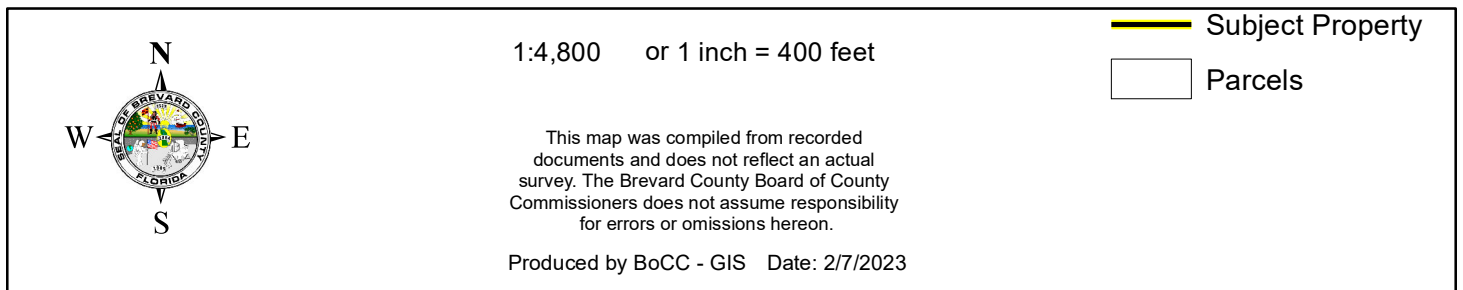

AERIAL MAP

Morak, Matthew & Christine

23Z00010

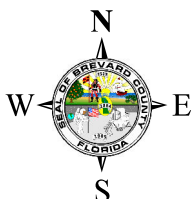

1:4,800 or 1 inch = 400 feet

PHOTO YEAR: 2022

This map was compiled from recorded documents and does not reflect an actual survey. The Brevard County Board of County Commissioners does not assume responsibility for errors or omissions hereon.

Produced by BoCC - GIS Date: 2/7/2023

 Subject Property

 Parcels

NWI WETLANDS MAP

Morak, Matthew & Christine

23Z00010

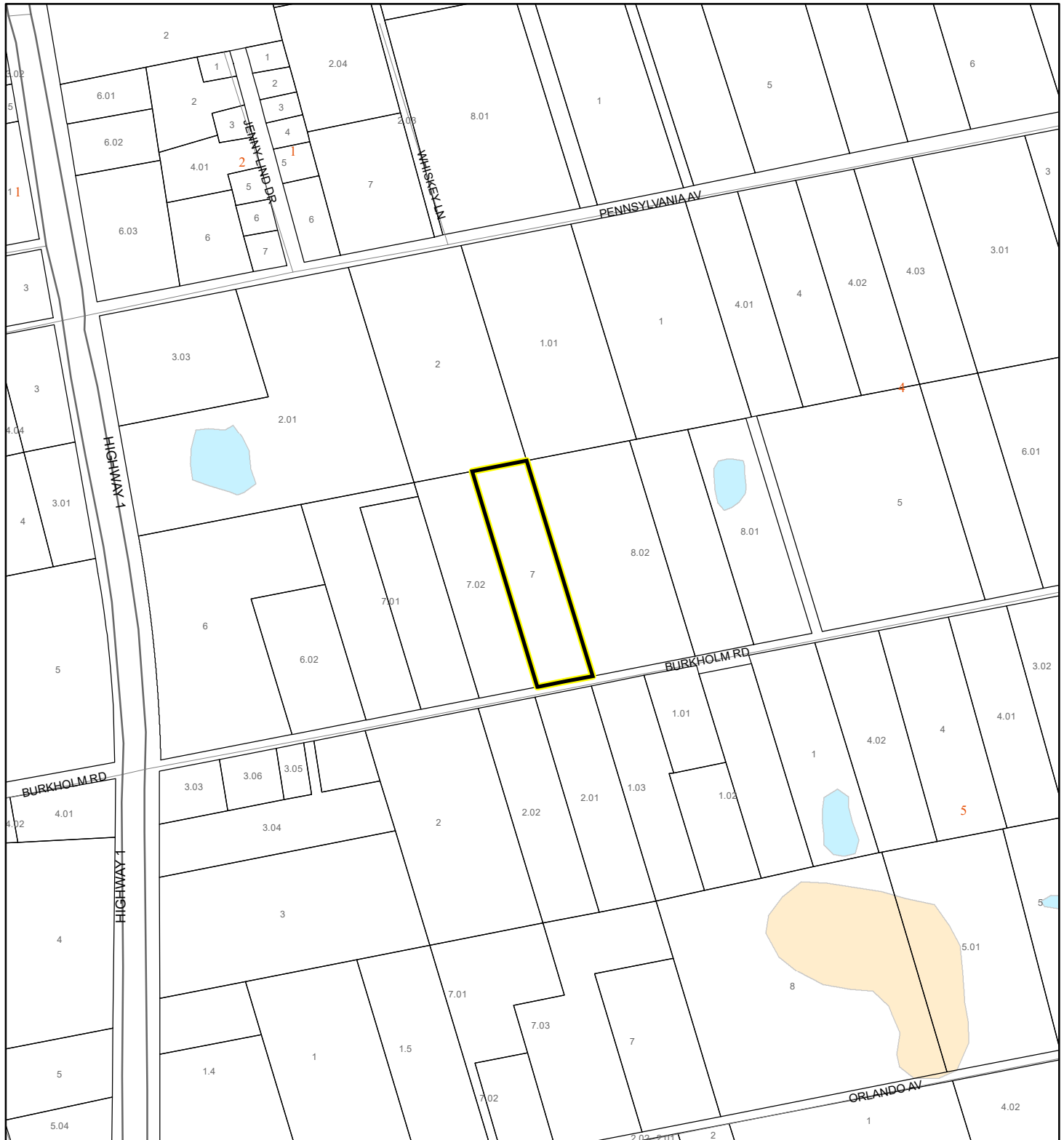









1:4,800 or 1 inch = 400 feet

This map was compiled from recorded documents and does not reflect an actual survey. The Brevard County Board of County Commissioners does not assume responsibility for errors or omissions hereon.

Produced by BoCC - GIS Date: 2/7/2023

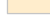
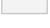
National Wetlands Inventory (NWI)

 Estuarine and Marine Deepwater	 Freshwater Pond
 Estuarine and Marine Wetland	 Lake
 Freshwater Emergent Wetland	 Other
 Freshwater Forested/Shrub Wetland	 Riverine
 Subject Property	
 Parcels	

SJRWMD FLUCCS WETLANDS - 6000 Series MAP

Morak, Matthew & Christine

23Z00010



1:4,800 or 1 inch = 400 feet

This map was compiled from recorded documents and does not reflect an actual survey. The Brevard County Board of County Commissioners does not assume responsibility for errors or omissions hereon.

Produced by BoCC - GIS Date: 2/7/2023

SJRWMD FLUCCS WETLANDS

-  Wetland Hardwood Forests - Series 6100
-  Wetland Coniferous Forest - Series 6200
-  Wetland Forested Mixed - Series 6300
-  Vegetated Non-Forested Wetlands - Series 6400
-  Non-Vegetated Wetland - Series 6500

 Subject Property

 Parcels

USDA SCSSS SOILS MAP

Morak, Matthew & Christine

23Z00010

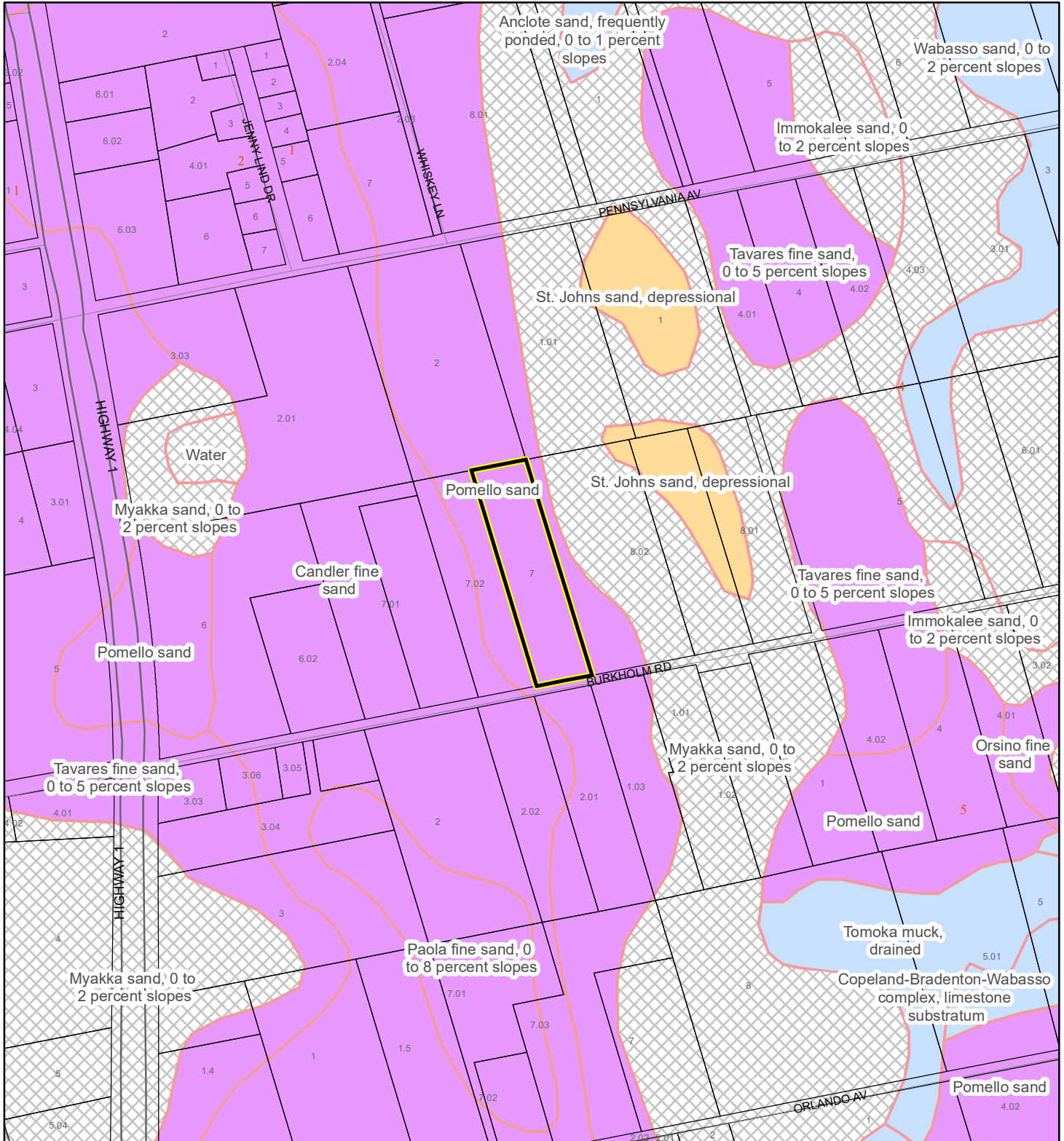

1:4,800 or 1 inch = 400 feet

This map was compiled from recorded documents and does not reflect an actual survey. The Brevard County Board of County Commissioners does not assume responsibility for errors or omissions hereon.

Produced by BoCC - GIS Date: 2/7/2023

USDA SCSSS Soils

- Aquifer and Hydric
- Aquifer
- Hydric
- None

Subject Property

Parcels

Morak, Matthew & Christine
23Z00010

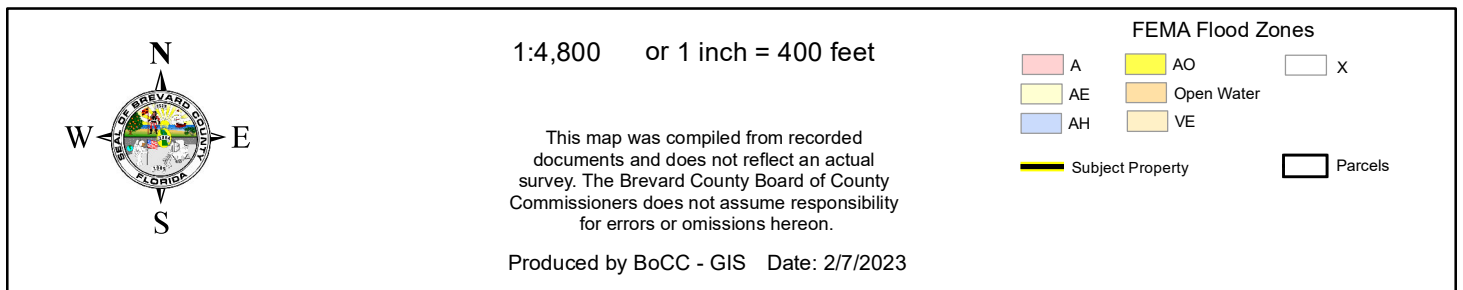

COASTAL HIGH HAZARD AREA MAP

Morak, Matthew & Christine

23Z00010



1:4,800 or 1 inch = 400 feet

This map was compiled from recorded documents and does not reflect an actual survey. The Brevard County Board of County Commissioners does not assume responsibility for errors or omissions hereon.

Produced by BoCC - GIS Date: 2/7/2023

 Subject Property

 Parcels

Coastal High Hazard Area

 SurgeZoneCat1

INDIAN RIVER LAGOON SEPTIC OVERLAY MAP

Morak, Matthew & Christine

23Z00010

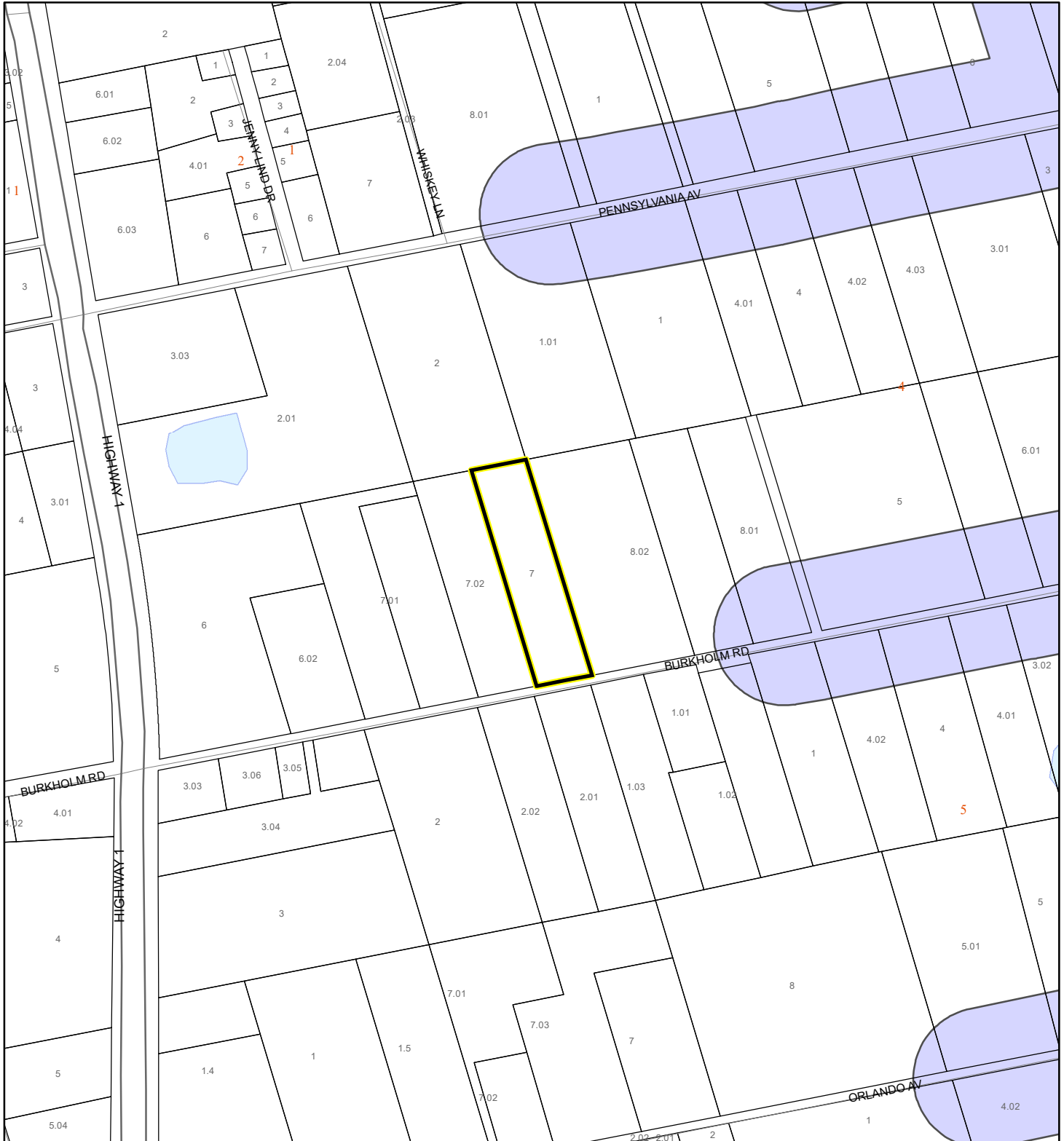

1:4,800 or 1 inch = 400 feet

This map was compiled from recorded documents and does not reflect an actual survey. The Brevard County Board of County Commissioners does not assume responsibility for errors or omissions hereon.

Produced by BoCC - GIS Date: 2/7/2023

 Subject Property

 Parcels

Septic Overlay

 40 Meters

 60 Meters

 All Distances

EAGLE NESTS MAP

Morak, Matthew & Christine

23Z00010



1:4,800 or 1 inch = 400 feet

This map was compiled from recorded documents and does not reflect an actual survey. The Brevard County Board of County Commissioners does not assume responsibility for errors or omissions hereon.

Produced by BoCC - GIS Date: 2/7/2023

 Subject Property

 Parcels

 Eagle Nests
FWS 2010

SCRUB JAY OCCUPANCY MAP

Morak, Matthew & Christine



23Z00010



1:4,800 or 1 inch = 400 feet

This map was compiled from recorded documents and does not reflect an actual survey. The Brevard County Board of County Commissioners does not assume responsibility for errors or omissions hereon.

Produced by BoCC - GIS Date: 2/7/2023

-  Subject Property
-  Parcels
-  Scrub Jay Occupancy

Morak, Matthew & Christine
23Z00010

