

# LOCATION MAP

CONSOLAZIO, MICHAEL JOHN AND SONYA LYNN  
22V00004

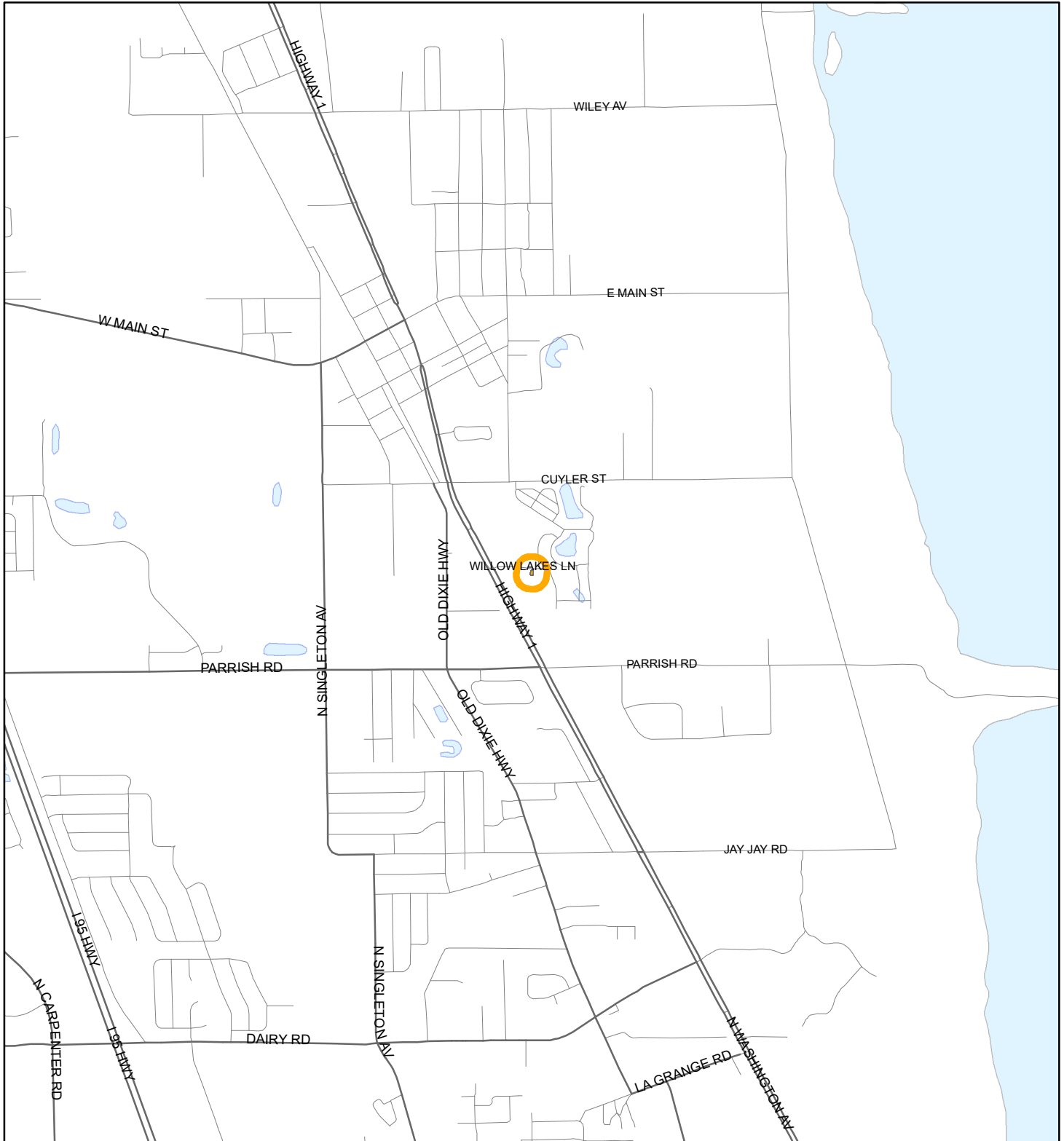



1:24,000 or 1 inch = 2,000 feet

Buffer Distance: 200 feet

This map was compiled from recorded documents and does not reflect an actual survey. The Brevard County Board of County Commissioners does not assume responsibility for errors or omissions hereon.

Produced by BoCC - GIS Date: 3/31/2022

 Buffer  
 Subject Property

# ZONING MAP

CONSOLAZIO, MICHAEL JOHN AND SONYA LYNN

22V00004

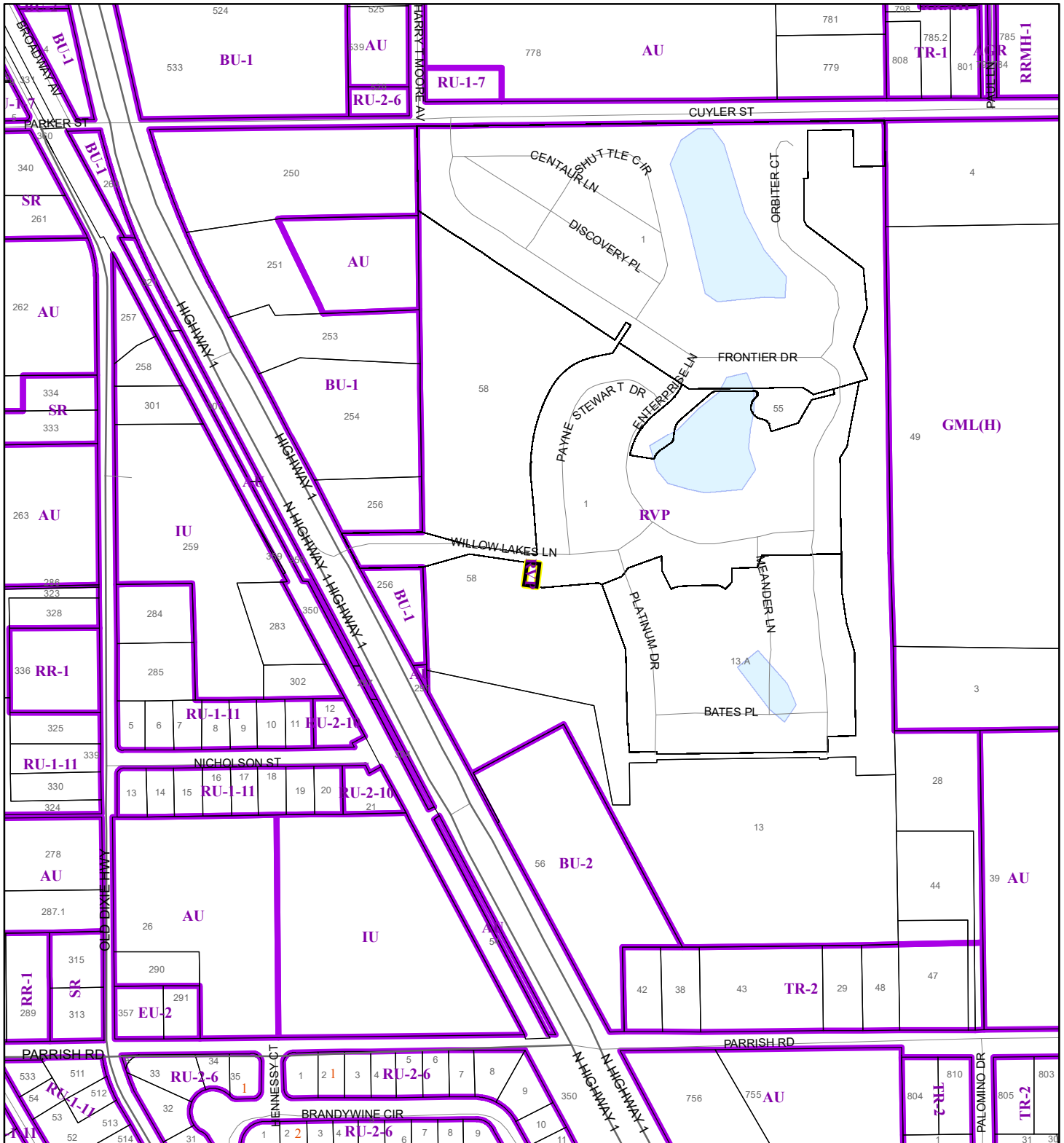

1:4,800 or 1 inch = 400 feet

This map was compiled from recorded documents and does not reflect an actual survey. The Brevard County Board of County Commissioners does not assume responsibility for errors or omissions hereon.

Produced by BoCC - GIS Date: 3/31/2022

 Subject Property

 Parcels

 Zoning



# AERIAL MAP

CONSOLAZIO, MICHAEL JOHN AND SONYA LYNN

22V00004



1:600 or 1 inch = 50 feet

PHOTO YEAR: 2021

This map was compiled from recorded documents and does not reflect an actual survey. The Brevard County Board of County Commissioners does not assume responsibility for errors or omissions hereon.

Produced by BoCC - GIS Date: 3/31/2022

 Subject Property

 Parcels