

LOCATION MAP

BUONO, MICHAEL P. AND CALHOUN, CHARLES T.

21Z00051

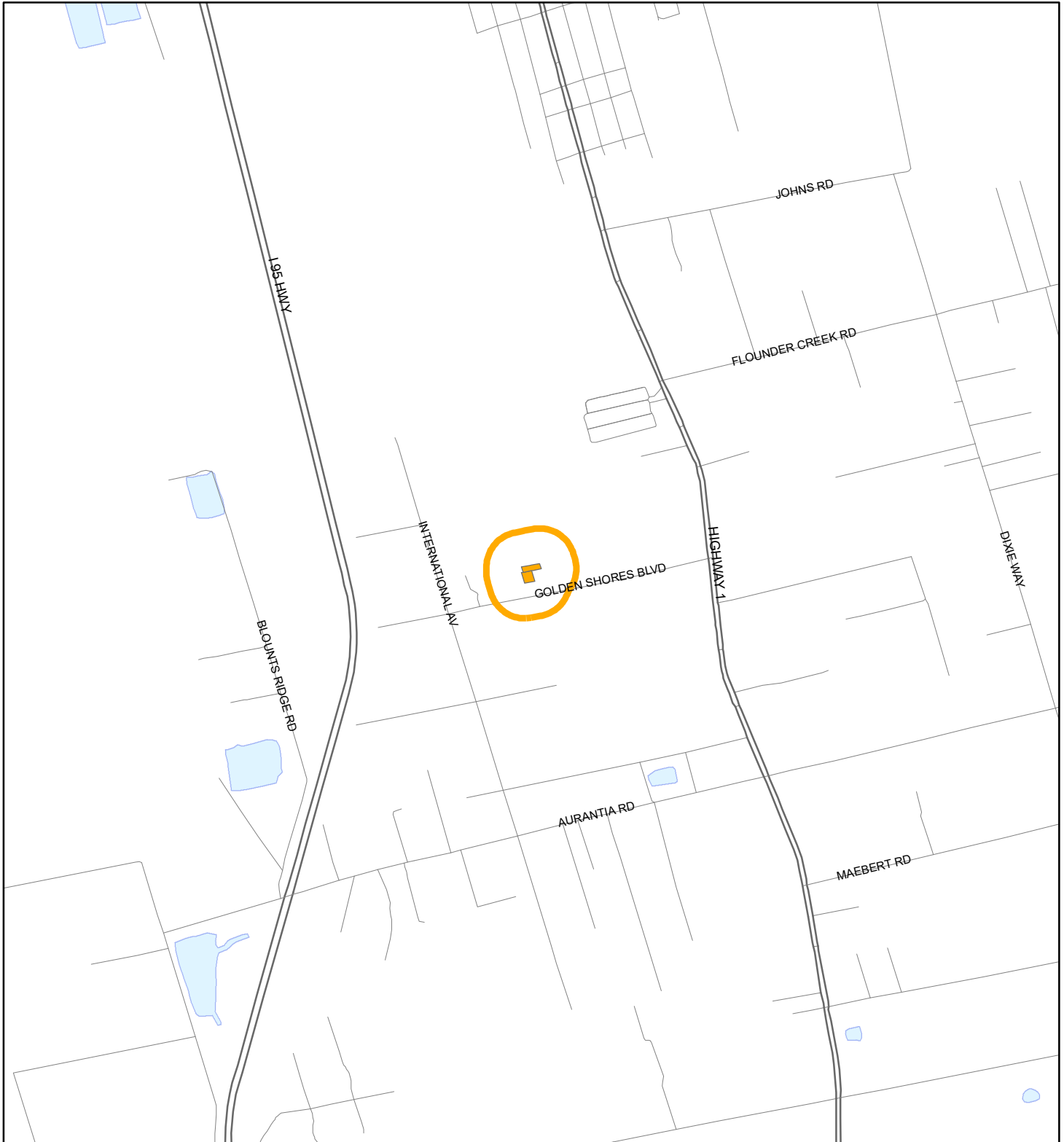



1:24,000 or 1 inch = 2,000 feet

Buffer Distance: 500 feet

This map was compiled from recorded documents and does not reflect an actual survey. The Brevard County Board of County Commissioners does not assume responsibility for errors or omissions hereon.

Produced by BoCC - GIS Date: 1/20/2022

 Buffer
 Subject Property

ZONING MAP

BUONO, MICHAEL P. AND CALHOUN, CHARLES T.

21Z00051



1:4,800 or 1 inch = 400 feet

This map was compiled from recorded documents and does not reflect an actual survey. The Brevard County Board of County Commissioners does not assume responsibility for errors or omissions hereon.

Produced by BoCC - GIS Date: 1/20/2022

 Subject Property

 Parcels

 Zoning

FUTURE LAND USE MAP

BUONO, MICHAEL P. AND CALHOUN, CHARLES T.

21Z00051

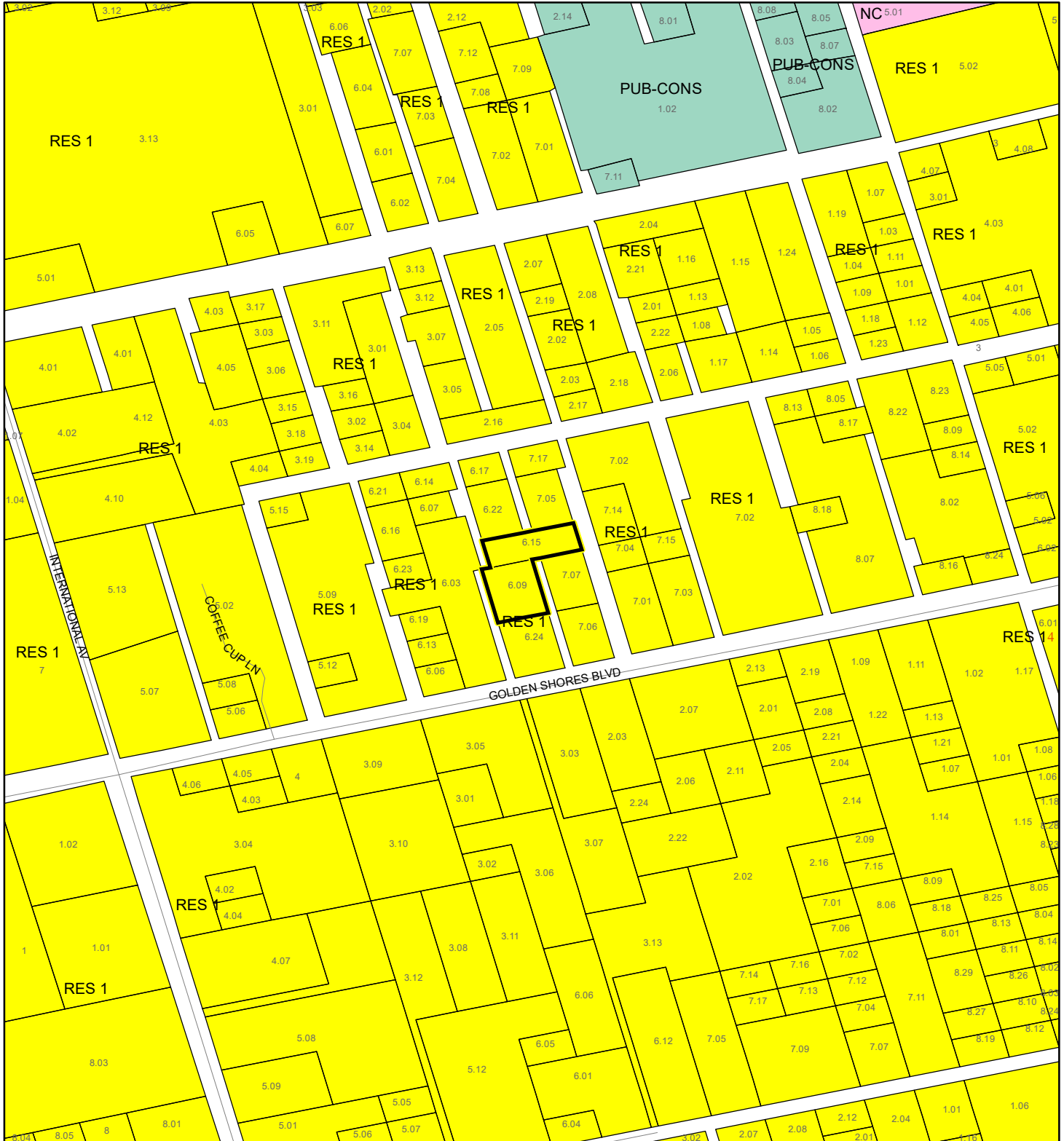

AERIAL MAP

BUONO, MICHAEL P. AND CALHOUN, CHARLES T.

21Z00051



1:4,800 or 1 inch = 400 feet

PHOTO YEAR: 2021

This map was compiled from recorded documents and does not reflect an actual survey. The Brevard County Board of County Commissioners does not assume responsibility for errors or omissions hereon.

Produced by BoCC - GIS Date: 1/20/2022

 Subject Property

 Parcels

NWI WETLANDS MAP

BUONO, MICHAEL P. AND CALHOUN, CHARLES T.

21Z00051

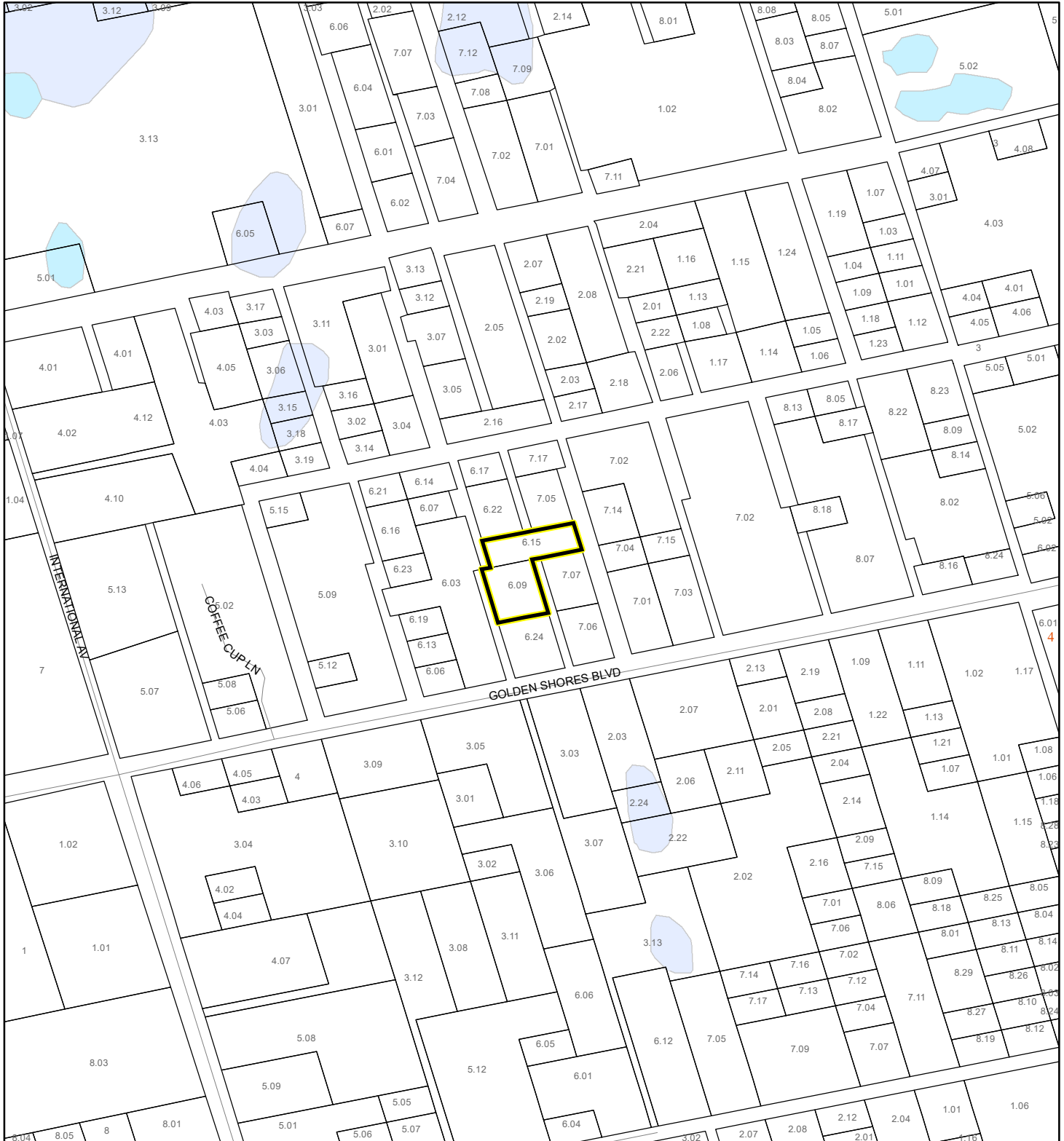









1:4,800 or 1 inch = 400 feet

This map was compiled from recorded documents and does not reflect an actual survey. The Brevard County Board of County Commissioners does not assume responsibility for errors or omissions hereon.

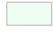
Produced by BoCC - GIS Date: 1/20/2022

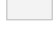
National Wetlands Inventory (NWI)

 Estuarine and Marine Deepwater	 Freshwater Pond
 Estuarine and Marine Wetland	 Lake
 Freshwater Emergent Wetland	 Other
 Freshwater Forested/Shrub Wetland	 Riverine
	 Subject Property
	 Parcels

SJRWMD FLUCCS WETLANDS - 6000 Series MAP

BUONO, MICHAEL P. AND CALHOUN, CHARLES T.

21Z00051



1:4,800 or 1 inch = 400 feet

This map was compiled from recorded documents and does not reflect an actual survey. The Brevard County Board of County Commissioners does not assume responsibility for errors or omissions hereon.

Produced by BoCC - GIS Date: 1/20/2022

SJRWMD FLUCCS WETLANDS

- Wetland Hardwood Forests - Series 6100
- Wetland Coniferous Forest - Series 6200
- Wetland Forested Mixed - Series 6300
- Vegetated Non-Forested Wetlands - Series 6400
- Non-Vegetated Wetland - Series 6500

Subject Property

Parcels

USDA SCSSS SOILS MAP

BUONO, MICHAEL P. AND CALHOUN, CHARLES T.

21Z00051

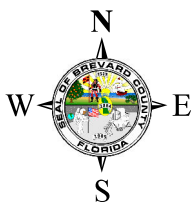
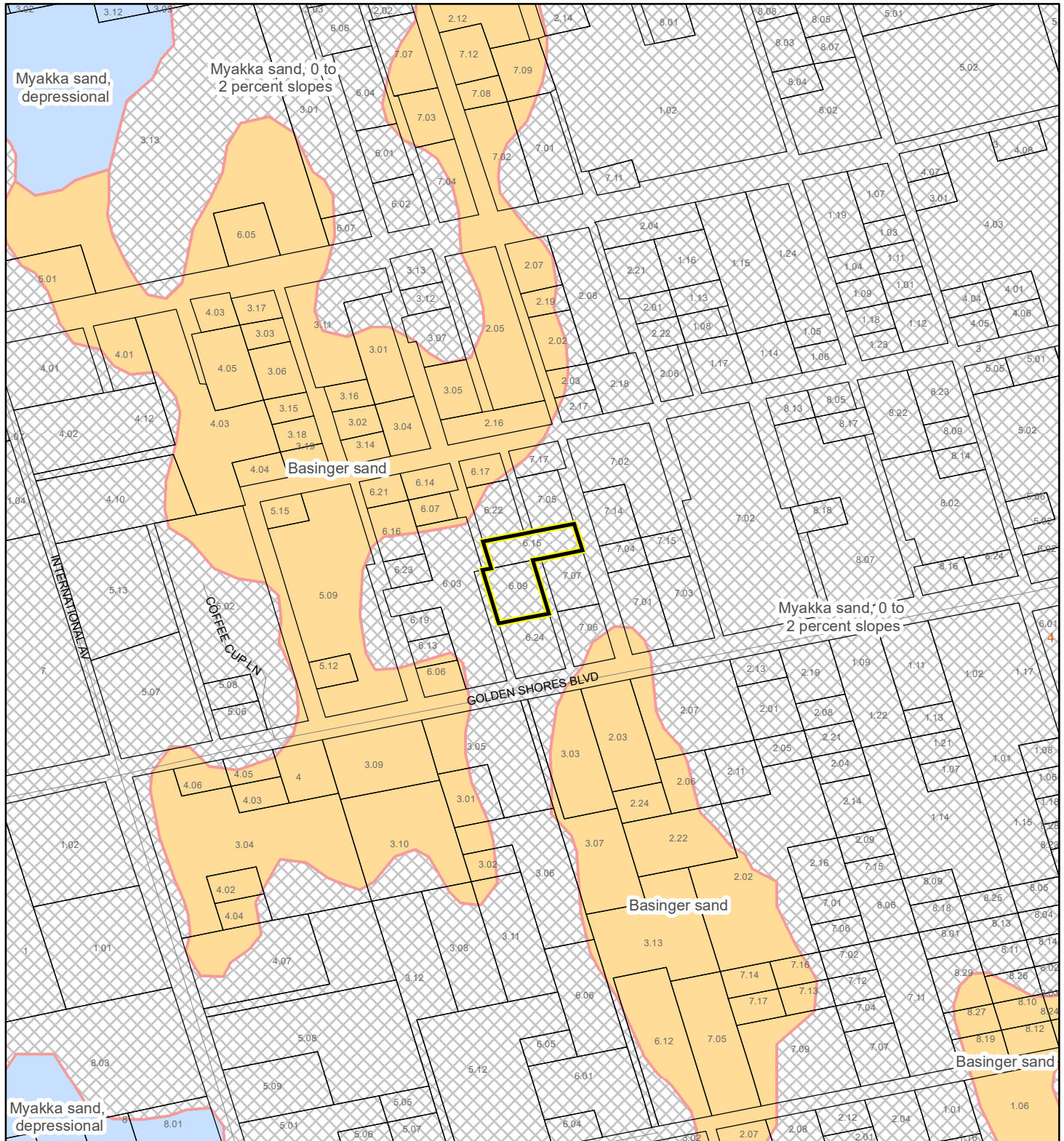

1:4,800 or 1 inch = 400 feet

This map was compiled from recorded documents and does not reflect an actual survey. The Brevard County Board of County Commissioners does not assume responsibility for errors or omissions hereon.

Produced by BoCC - GIS Date: 1/20/2022

USDA SCSSS Soils

Aquifer and Hydric

Aquifer

Hydric

None

Subject Property

Parcels

FEMA FLOOD ZONES MAP

BUONO, MICHAEL P. AND CALHOUN, CHARLES T.

21Z00051

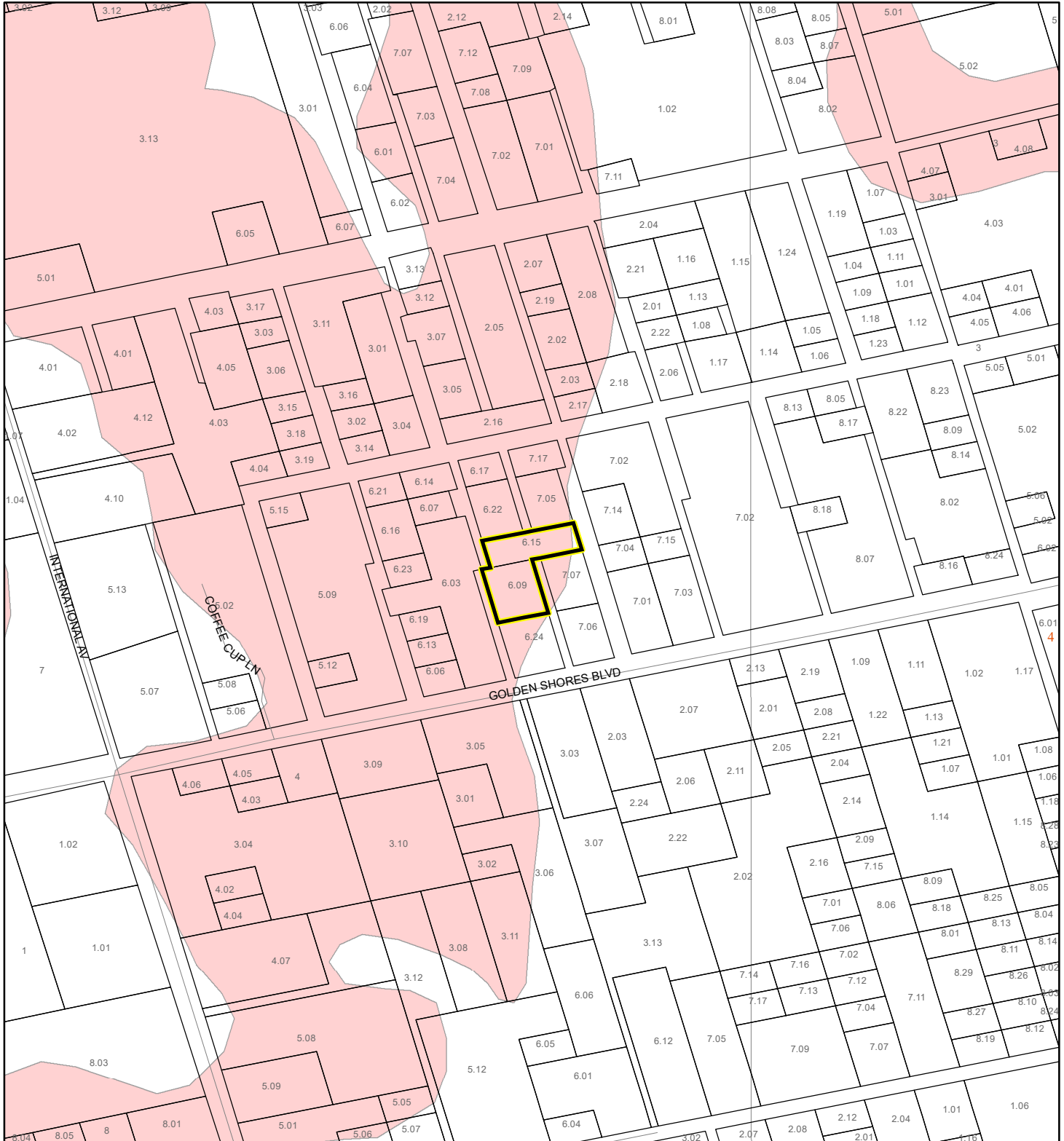

COASTAL HIGH HAZARD AREA MAP

BUONO, MICHAEL P. AND CALHOUN, CHARLES T.

21Z00051

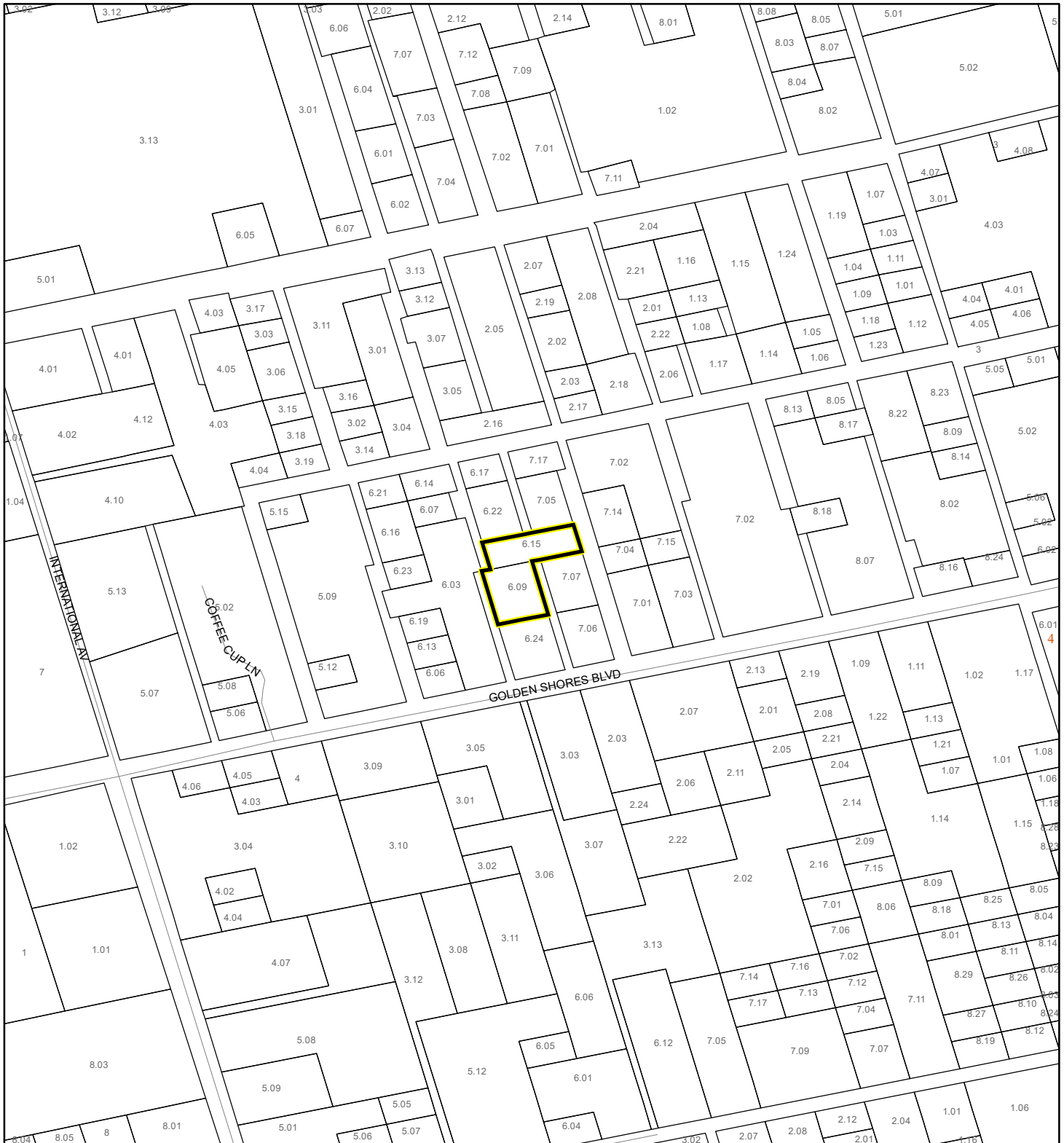

1:4,800 or 1 inch = 400 feet

This map was compiled from recorded documents and does not reflect an actual survey. The Brevard County Board of County Commissioners does not assume responsibility for errors or omissions hereon.

Produced by BoCC - GIS Date: 1/20/2022

 Subject Property

 Parcels

Coastal High Hazard Area

 SurgeZoneCat1

INDIAN RIVER LAGOON SEPTIC OVERLAY MAP

BUONO, MICHAEL P. AND CALHOUN, CHARLES T.

21Z00051



EAGLE NESTS MAP

BUONO, MICHAEL P. AND CALHOUN, CHARLES T.

21Z00051

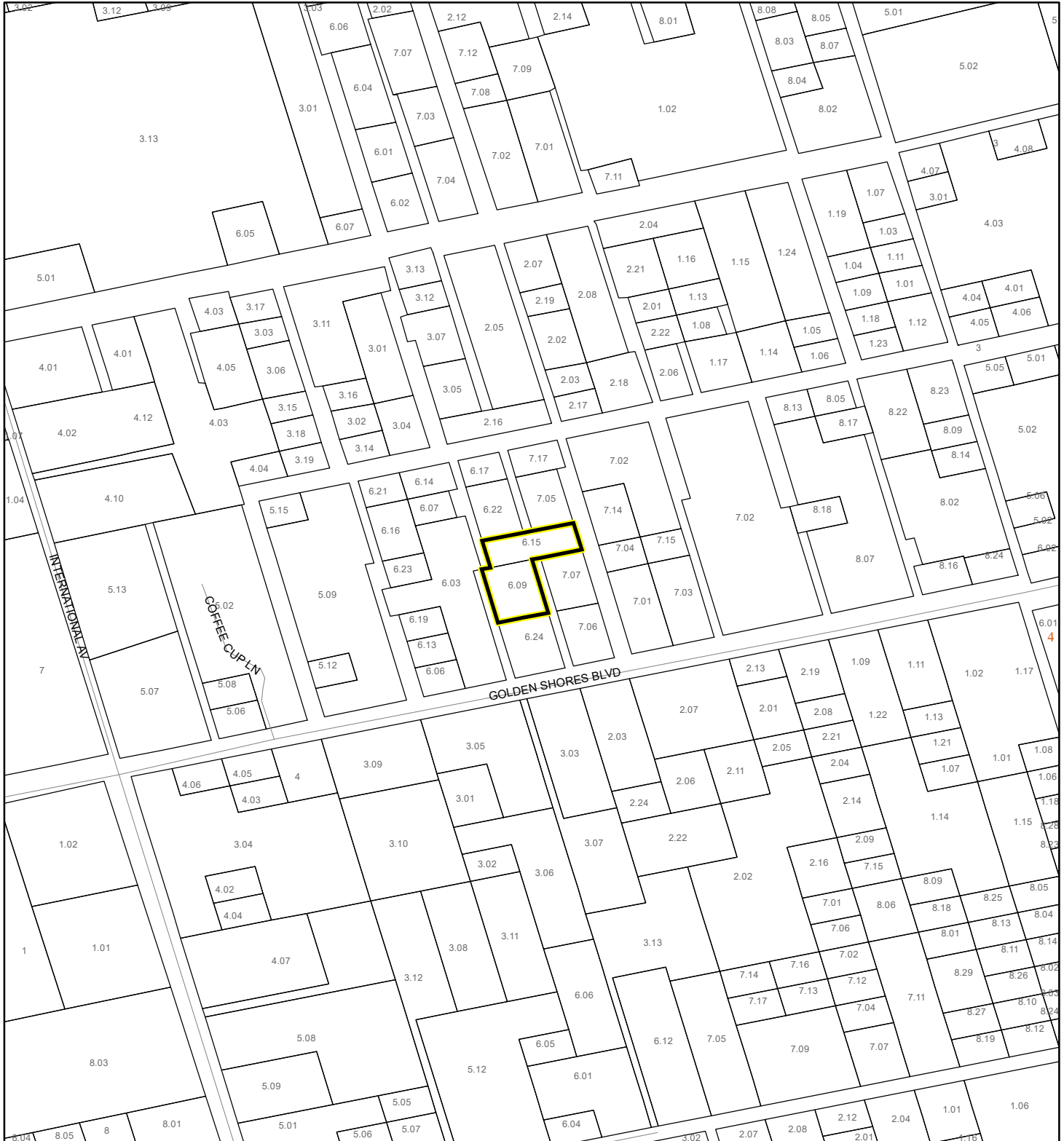

1:4,800 or 1 inch = 400 feet

This map was compiled from recorded documents and does not reflect an actual survey. The Brevard County Board of County Commissioners does not assume responsibility for errors or omissions hereon.

Produced by BoCC - GIS Date: 1/20/2022

 Subject Property

 Parcels



Eagle Nests
FWS 2010

21Z00051

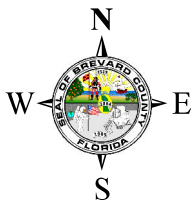
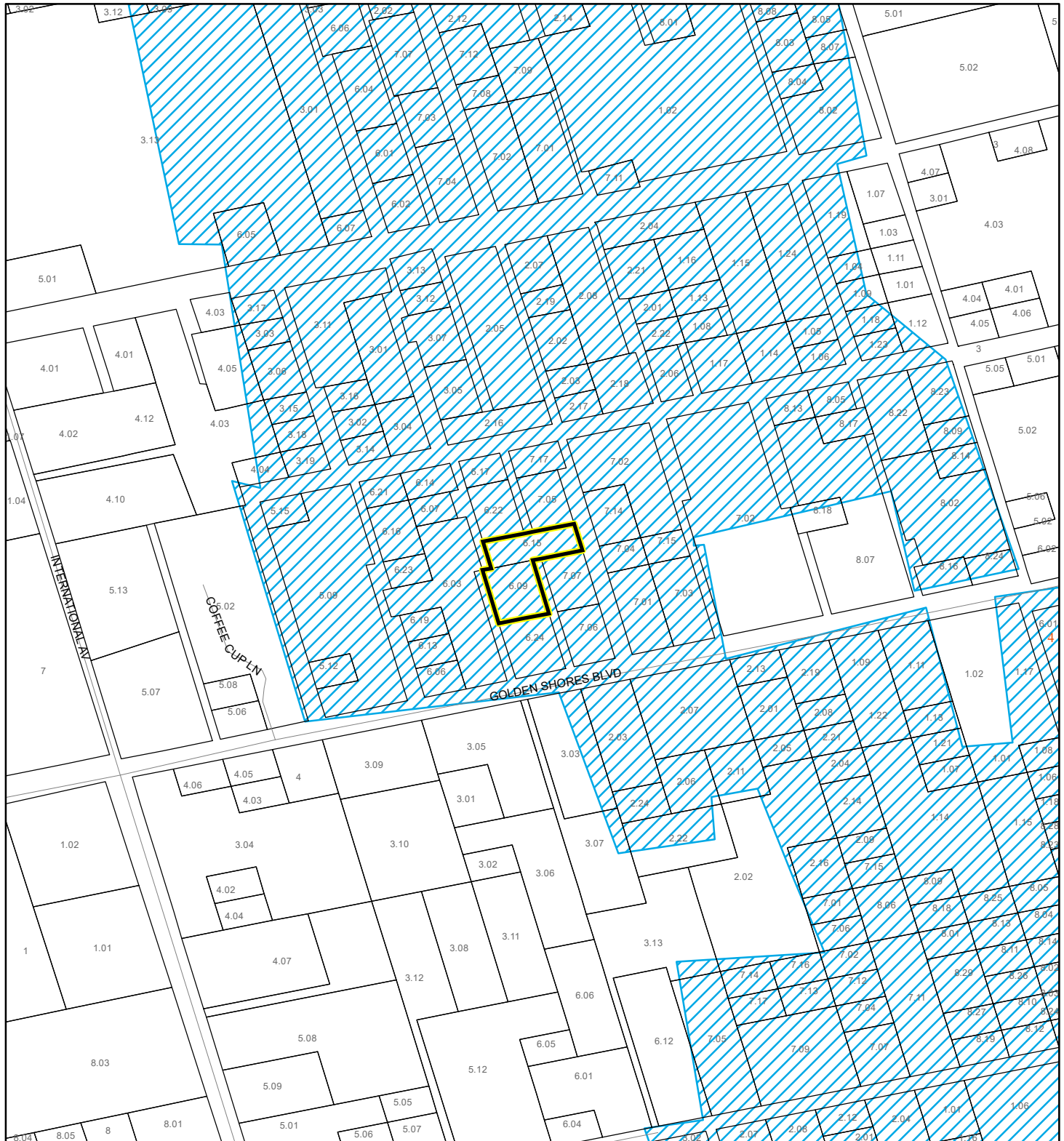

1:4,800 or 1 inch = 400 feet

This map was compiled from recorded documents and does not reflect an actual survey. The Brevard County Board of County Commissioners does not assume responsibility for errors or omissions hereon.

Produced by BoCC - GIS Date: 1/20/2022

Subject Property

Parcels

 Scrub Jay Occupancy

SJRWMD FLUCCS UPLAND FORESTS - 4000 Series MAP

BUONO, MICHAEL P. AND CALHOUN, CHARLES T.

21Z00051



1:4,800 or 1 inch = 400 feet

This map was compiled from recorded documents and does not reflect an actual survey. The Brevard County Board of County Commissioners does not assume responsibility for errors or omissions hereon.

Produced by BoCC - GIS Date: 1/20/2022

SJRWMD FLUCCS Upland Forests

- Upland Coniferous Forest - 4100 Series
- Upland Hardwood Forest - 4200 Series
- Upland Mixed Forest - 4300 Series
- Tree Plantations - 4400 Series

Subject Property Parcels