

LOCATION MAP

Di Vita, Thomas & Meredith
24V00031

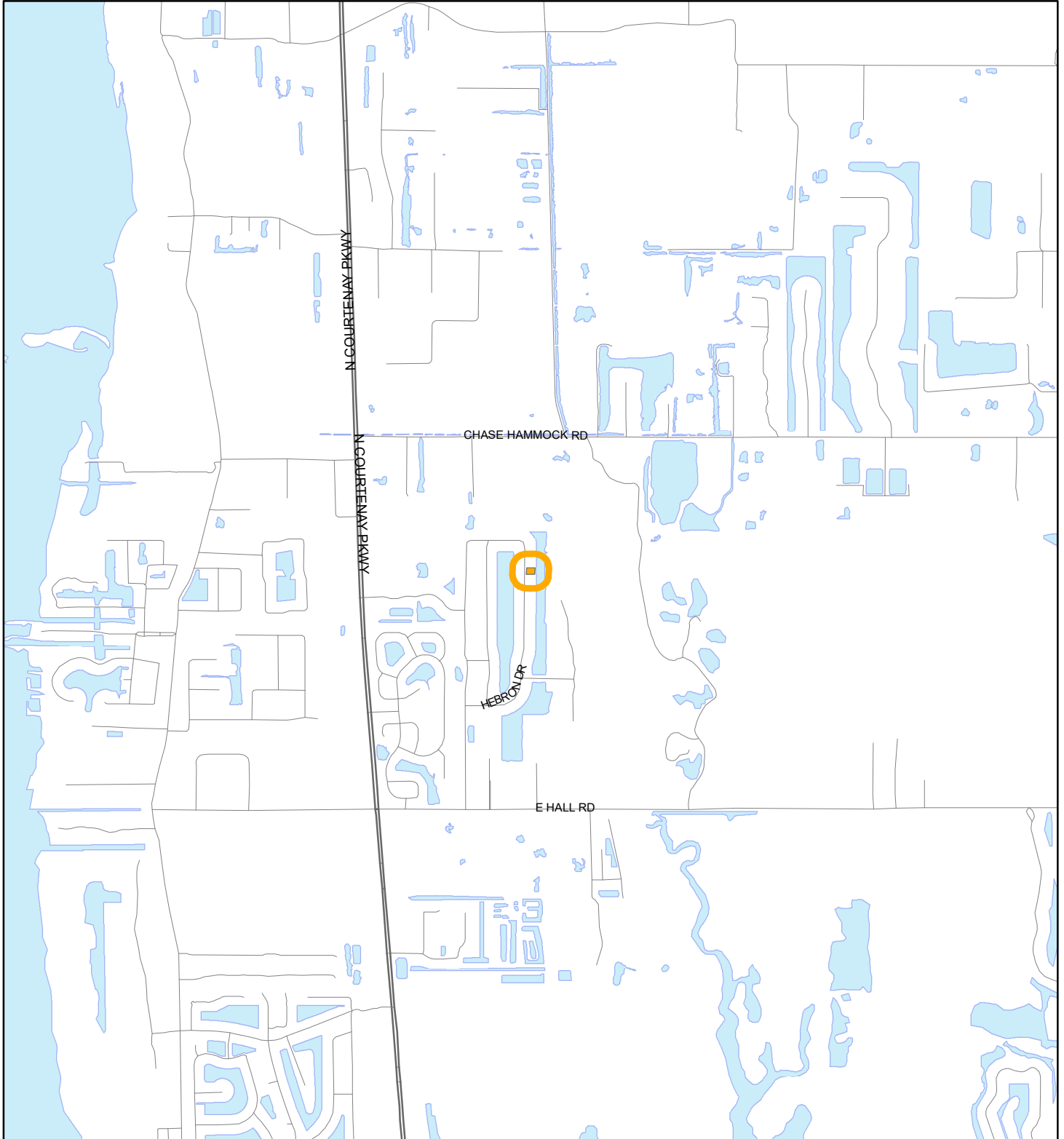

1:24,000 or 1 inch = 2,000 feet

Buffer Distance: 200 feet

This map was compiled from recorded documents and does not reflect an actual survey. The Brevard County Board of County Commissioners does not assume responsibility for errors or omissions hereon.

Produced by BoCC - GIS Date: 8/22/2024

-  Buffer
-  Subject Property

ZONING MAP

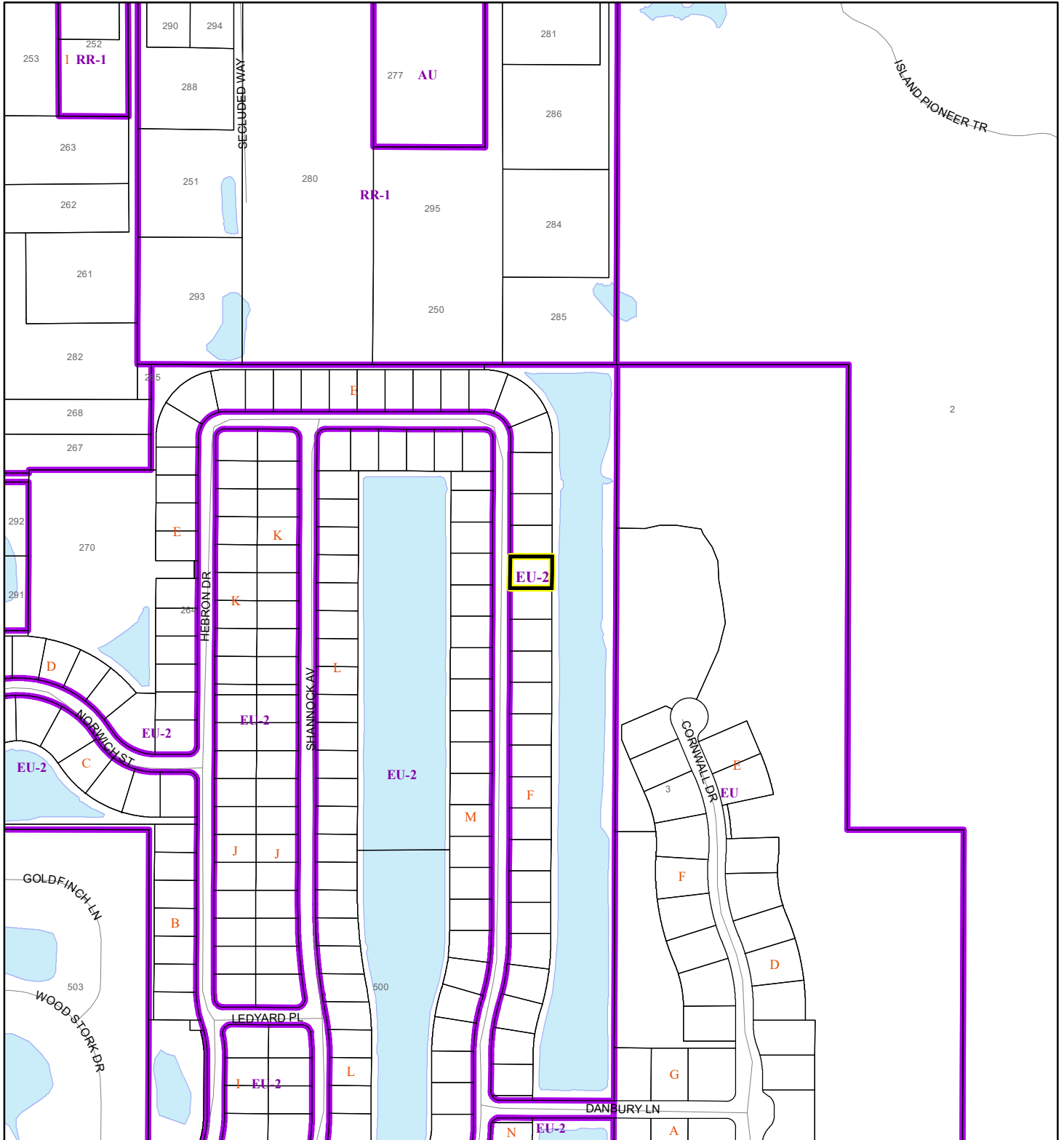

Di Vita, Thomas & Meredith
24V00031



1:4,800 or 1 inch = 400 feet

This map was compiled from recorded documents and does not reflect an actual survey. The Brevard County Board of County Commissioners does not assume responsibility for errors or omissions hereon.

Produced by BoCC - GIS Date: 8/22/2024

-  Subject Property
-  Parcels
-  Zoning

AERIAL MAP

Di Vita, Thomas & Meredith
24V00031





1:1,200 or 1 inch = 100 feet

PHOTO YEAR: 2024

This map was compiled from recorded documents and does not reflect an actual survey. The Brevard County Board of County Commissioners does not assume responsibility for errors or omissions hereon.

Produced by BoCC - GIS Date: 8/22/2024

-  Subject Property
-  Parcels