

LOCATION MAP

DOCI, ZAMIRA AND GEZIM

19PZ00124

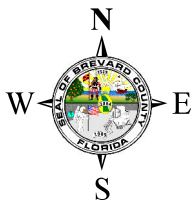

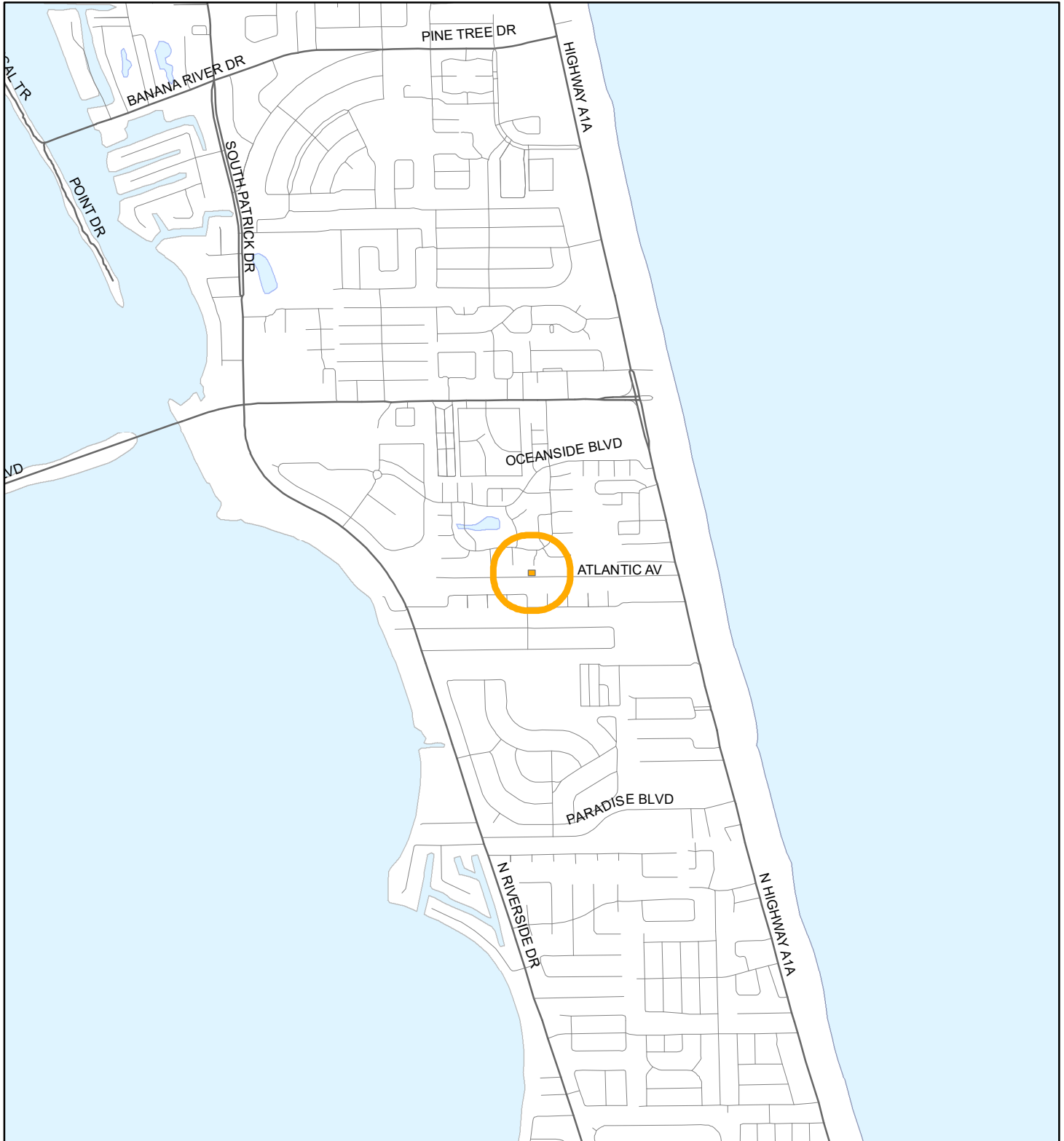

1:24,000 or 1 inch = 2,000 feet

Buffer Distance: 500 feet

This map was compiled from recorded documents and does not reflect an actual survey. The Brevard County Board of County Commissioners does not assume responsibility for errors or omissions hereon.

Produced by BoCC - GIS Date: 10/2/2019

-  Buffer
-  Subject Property

ZONING MAP

DOCI, ZAMIRA AND GEZIM

19PZ00124

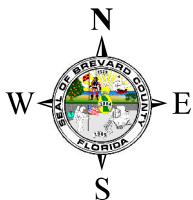
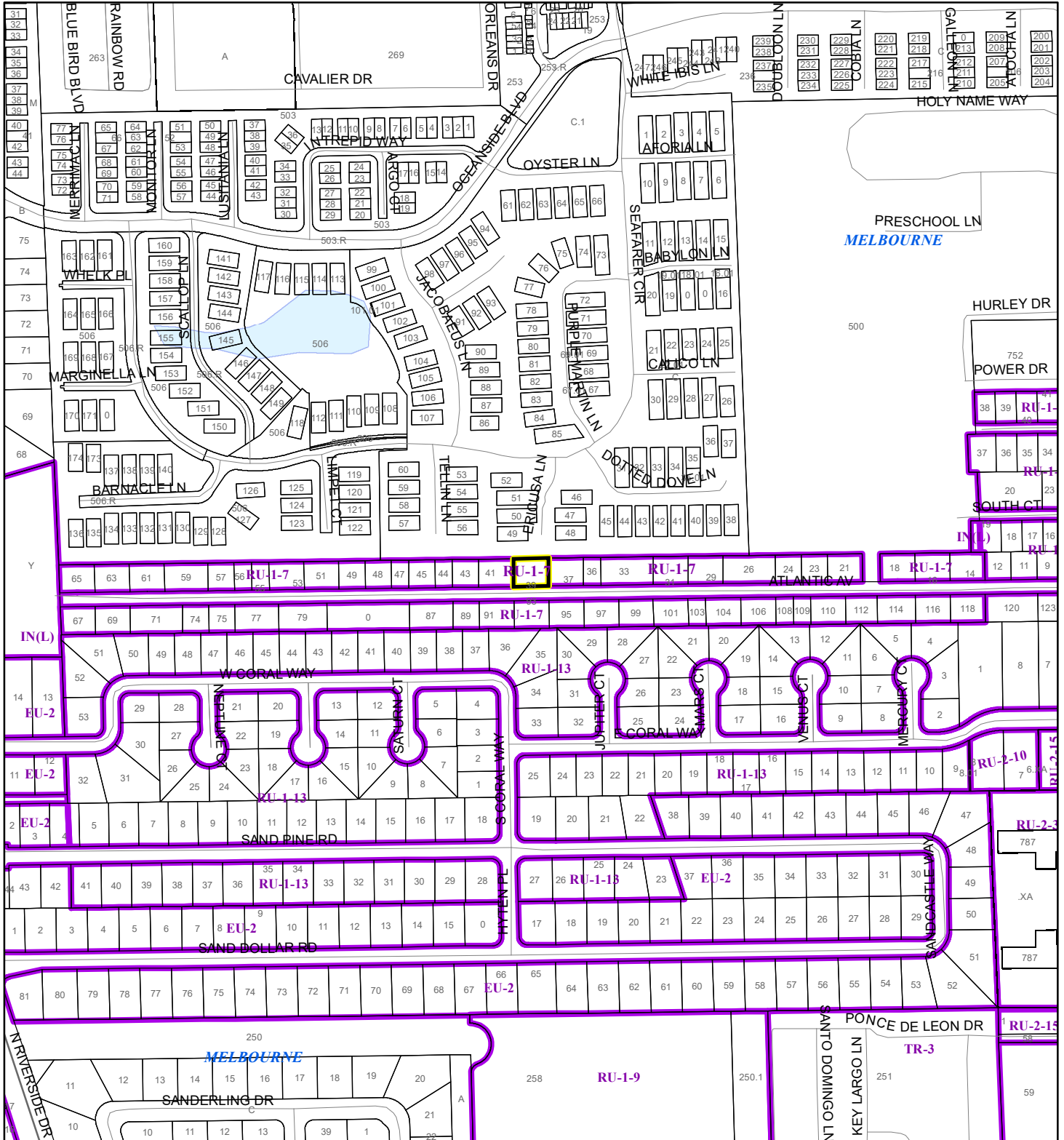

1:4,800 or 1 inch = 400 feet

- Subject Property
- Parcels
- Zoning

This map was compiled from recorded documents and does not reflect an actual survey. The Brevard County Board of County Commissioners does not assume responsibility for errors or omissions hereon.

Produced by BoCC - GIS Date: 10/3/2019

FUTURE LAND USE MAP

DOCI, ZAMIRA AND GEZIM

19PZ00124

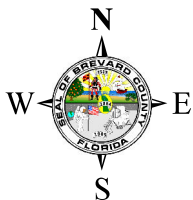
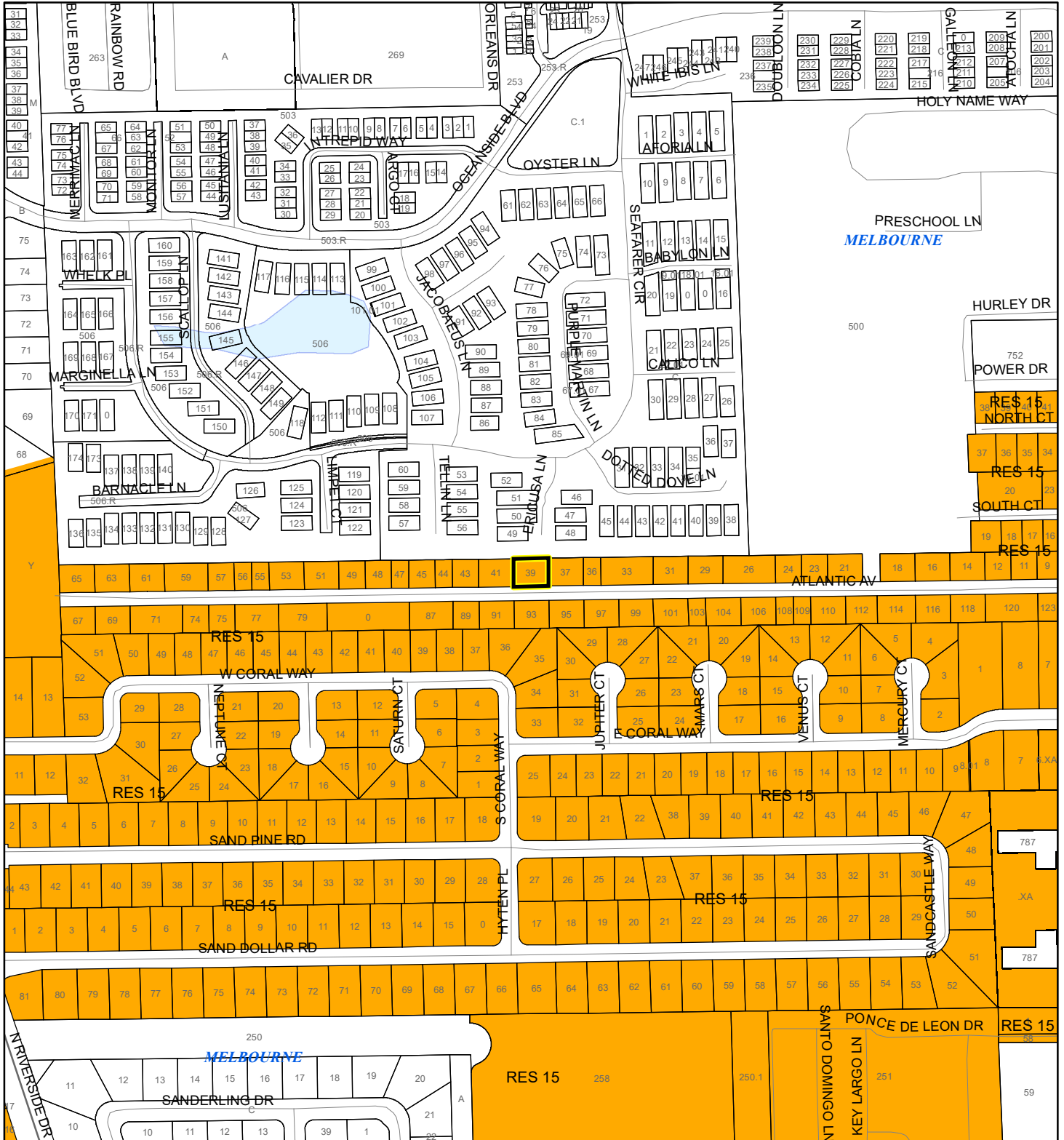

1:4,800 or 1 inch = 400 feet

- Subject Property
- Parcels

This map was compiled from recorded documents and does not reflect an actual survey. The Brevard County Board of County Commissioners does not assume responsibility for errors or omissions hereon.

Produced by BoCC - GIS Date: 10/2/2019

AERIAL MAP

DOCI, ZAMIRA AND GEZIM

19PZ00124

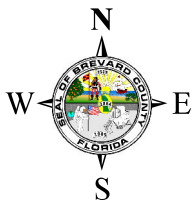
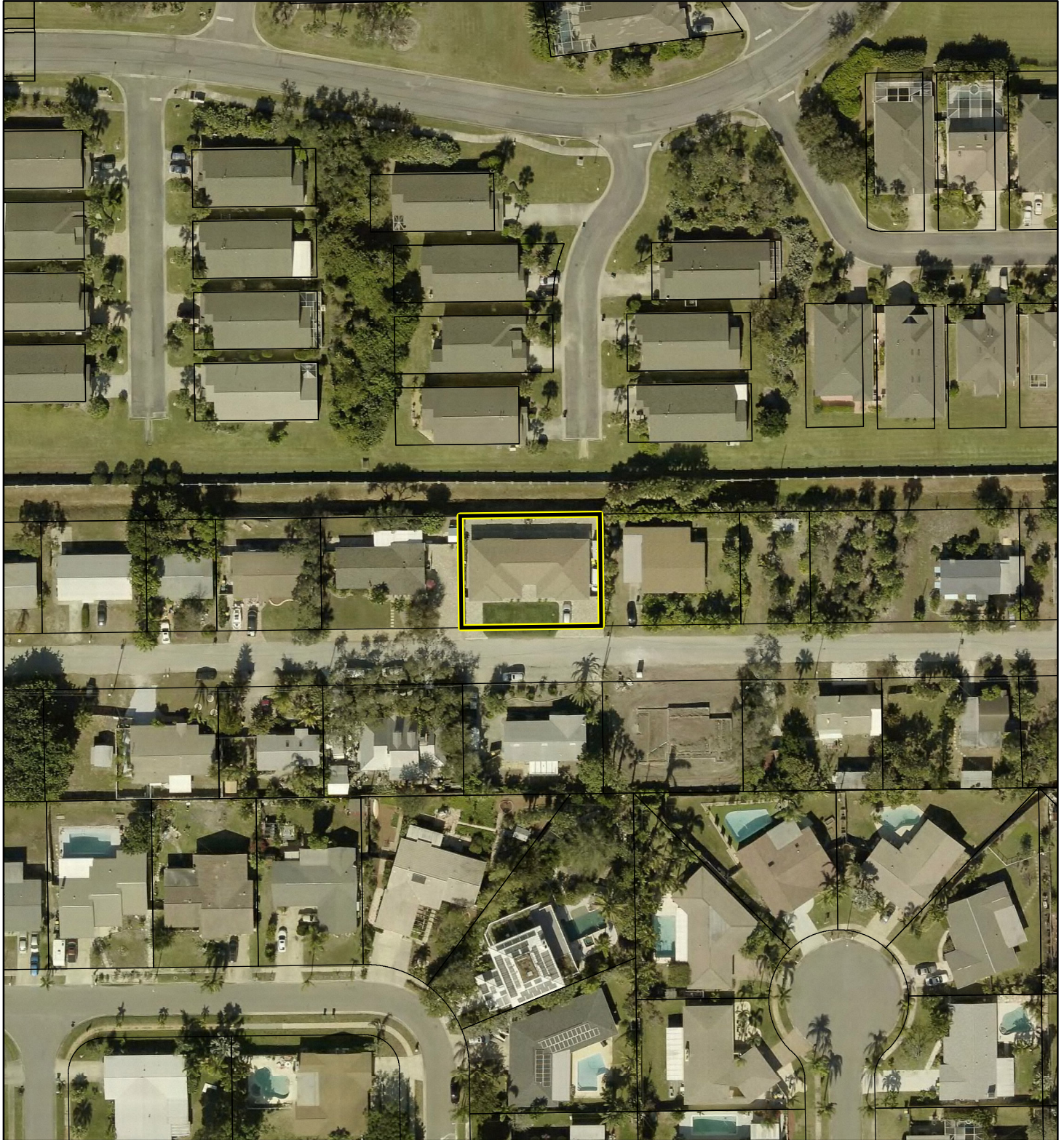

1:1,200 or 1 inch = 100 feet

PHOTO YEAR: 2019

This map was compiled from recorded documents and does not reflect an actual survey. The Brevard County Board of County Commissioners does not assume responsibility for errors or omissions hereon.

Produced by BoCC - GIS Date: 10/2/2019

 Subject Property

 Parcels

NWI WETLANDS MAP

DOCI, ZAMIRA AND GEZIM

19PZ00124

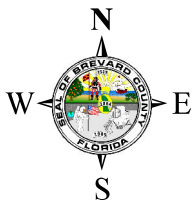
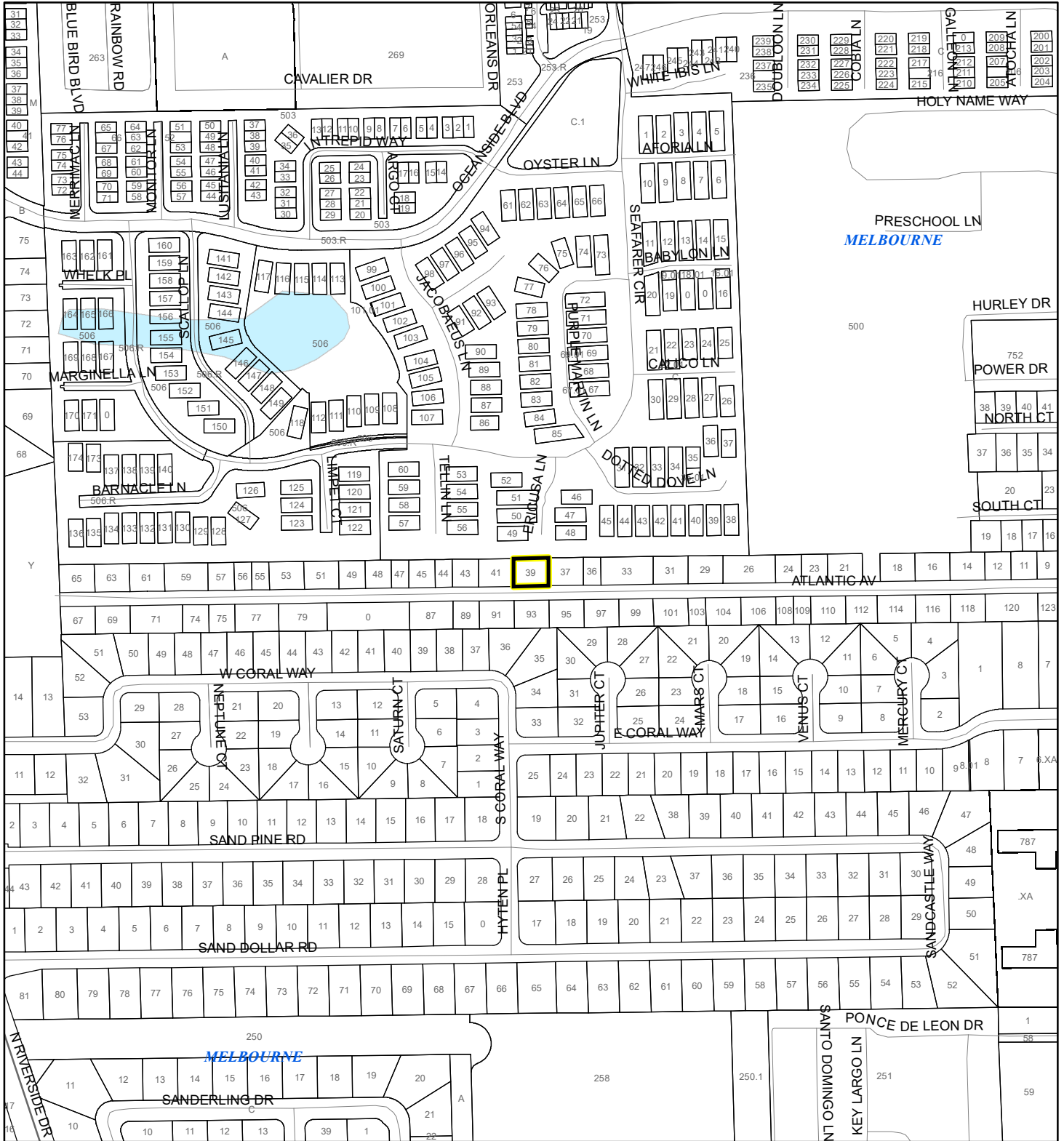











1:4,800 or 1 inch = 400 feet

This map was compiled from recorded documents and does not reflect an actual survey. The Brevard County Board of County Commissioners does not assume responsibility for errors or omissions hereon.

Produced by BoCC - GIS Date: 10/2/2019

National Wetlands Inventory (NWI)

- | | |
|--|--|
|  Estuarine and Marine Deepwater |  Freshwater Pond |
|  Estuarine and Marine Wetland |  Lake |
|  Freshwater Emergent Wetland |  Other |
|  Freshwater Forested/Shrub Wetland |  Riverine |
| |  Subject Property |
| |  Parcels |

SJRWMD FLUCCS WETLANDS - 6000 Series MAP

DOCI, ZAMIRA AND GEZIM

19PZ00124

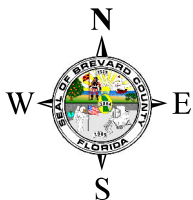
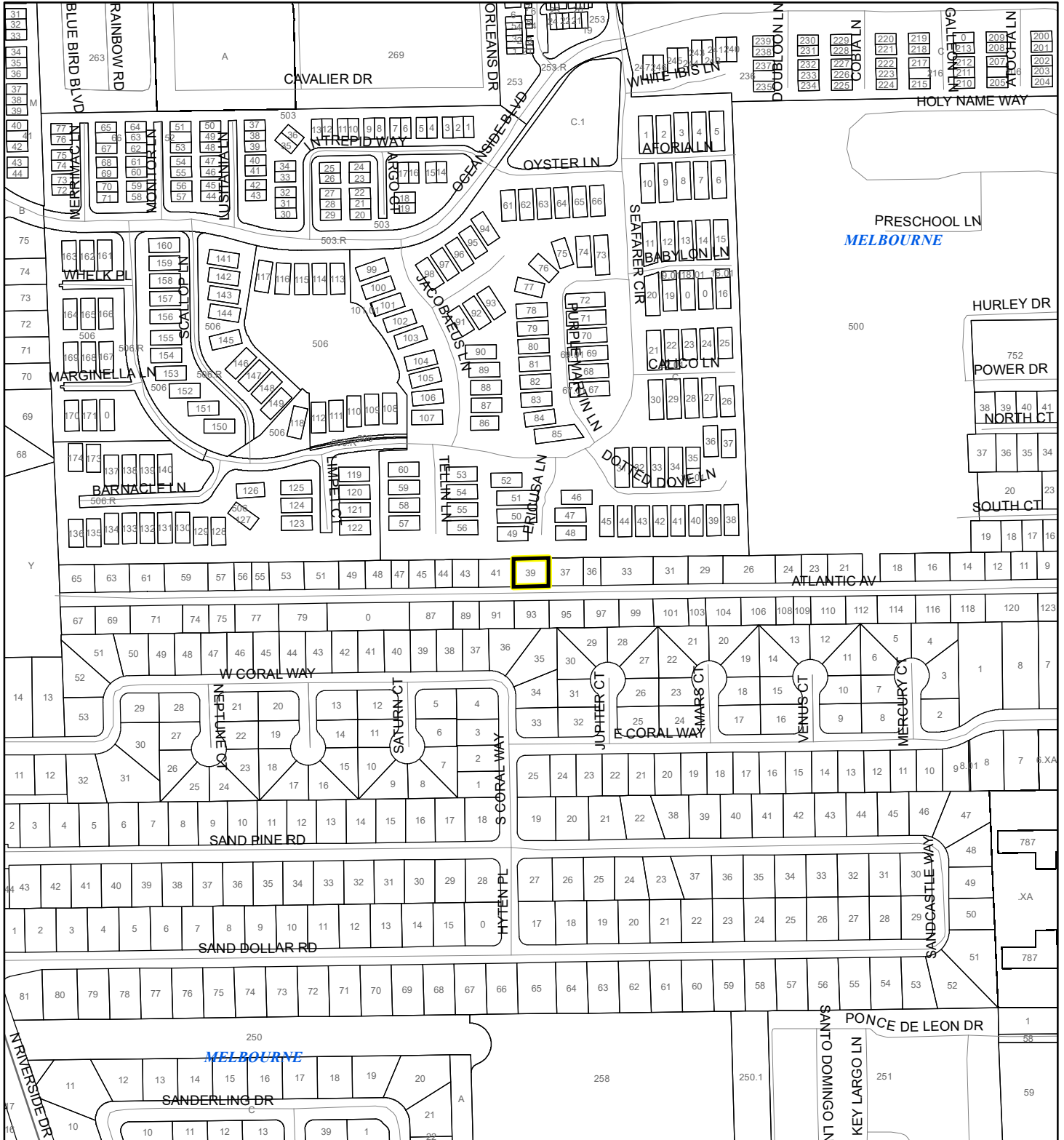

1:4,800 or 1 inch = 400 feet

This map was compiled from recorded documents and does not reflect an actual survey. The Brevard County Board of County Commissioners does not assume responsibility for errors or omissions hereon.

Produced by BoCC - GIS Date: 10/2/2019

SJRWMD FLUCCS WETLANDS

- Wetland Hardwood Forests - Series 6100
- Wetland Coniferous Forest - Series 6200
- Wetland Forested Mixed - Series 6300
- Vegetated Non-Forested Wetlands - Series 6400
- Non-Vegetated Wetland - Series 6500

Subject Property

Parcels

USDA SCSSS SOILS MAP

DOCI, ZAMIRA AND GEZIM

19PZ00124

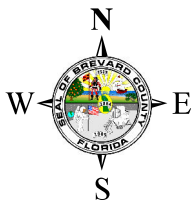
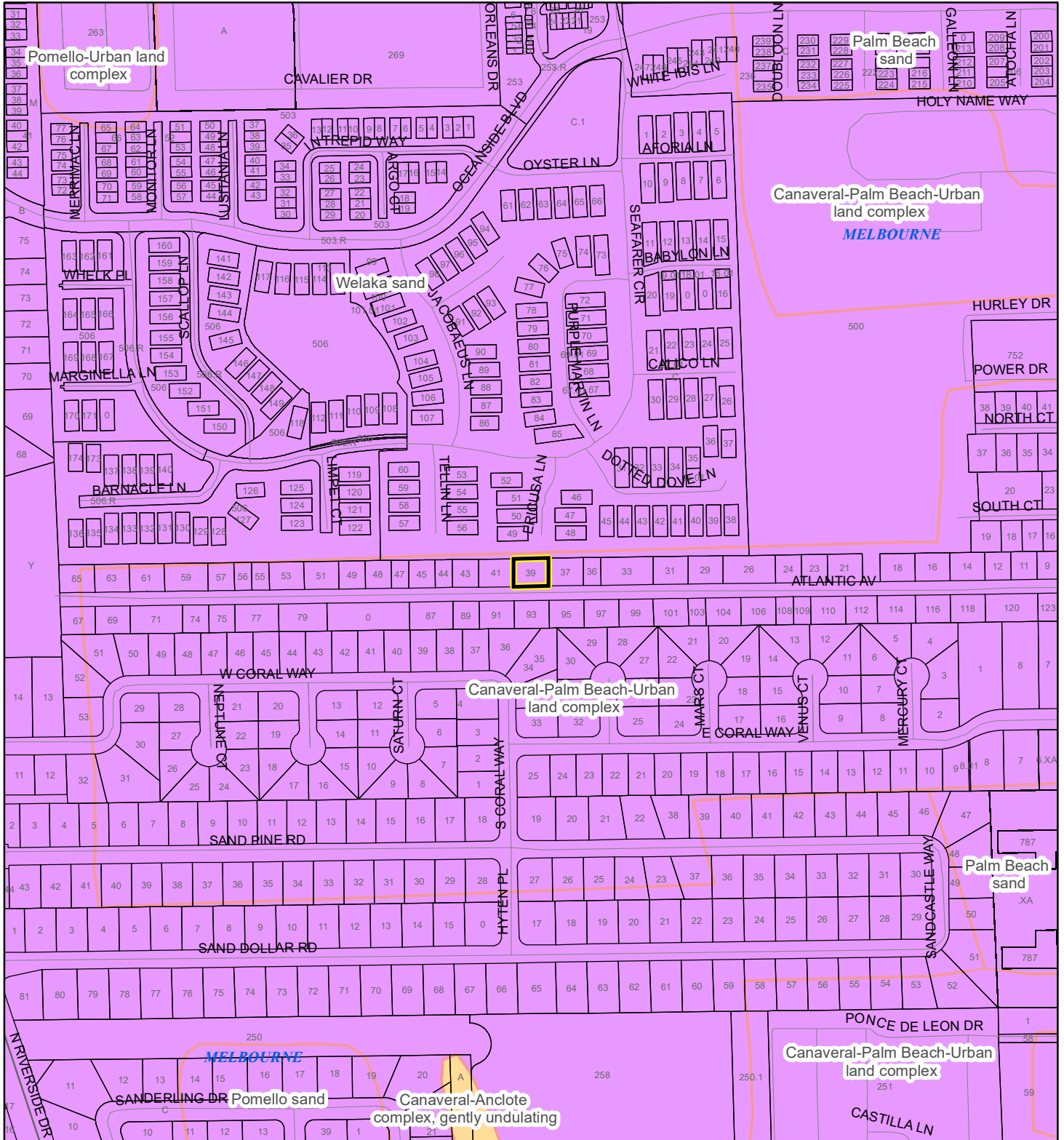

1:4,800 or 1 inch = 400 feet

USDA SCSSS Soils

Aquifer and Hydric

Aquifer

Hydric

None

Subject Property

Parcels

This map was compiled from recorded documents and does not reflect an actual survey. The Brevard County Board of County Commissioners does not assume responsibility for errors or omissions hereon.

Produced by BoCC - GIS Date: 10/2/2019

FEMA FLOOD ZONES MAP

DOCI, ZAMIRA AND GEZIM

19PZ00124

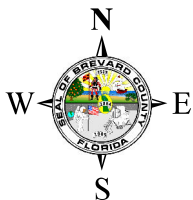
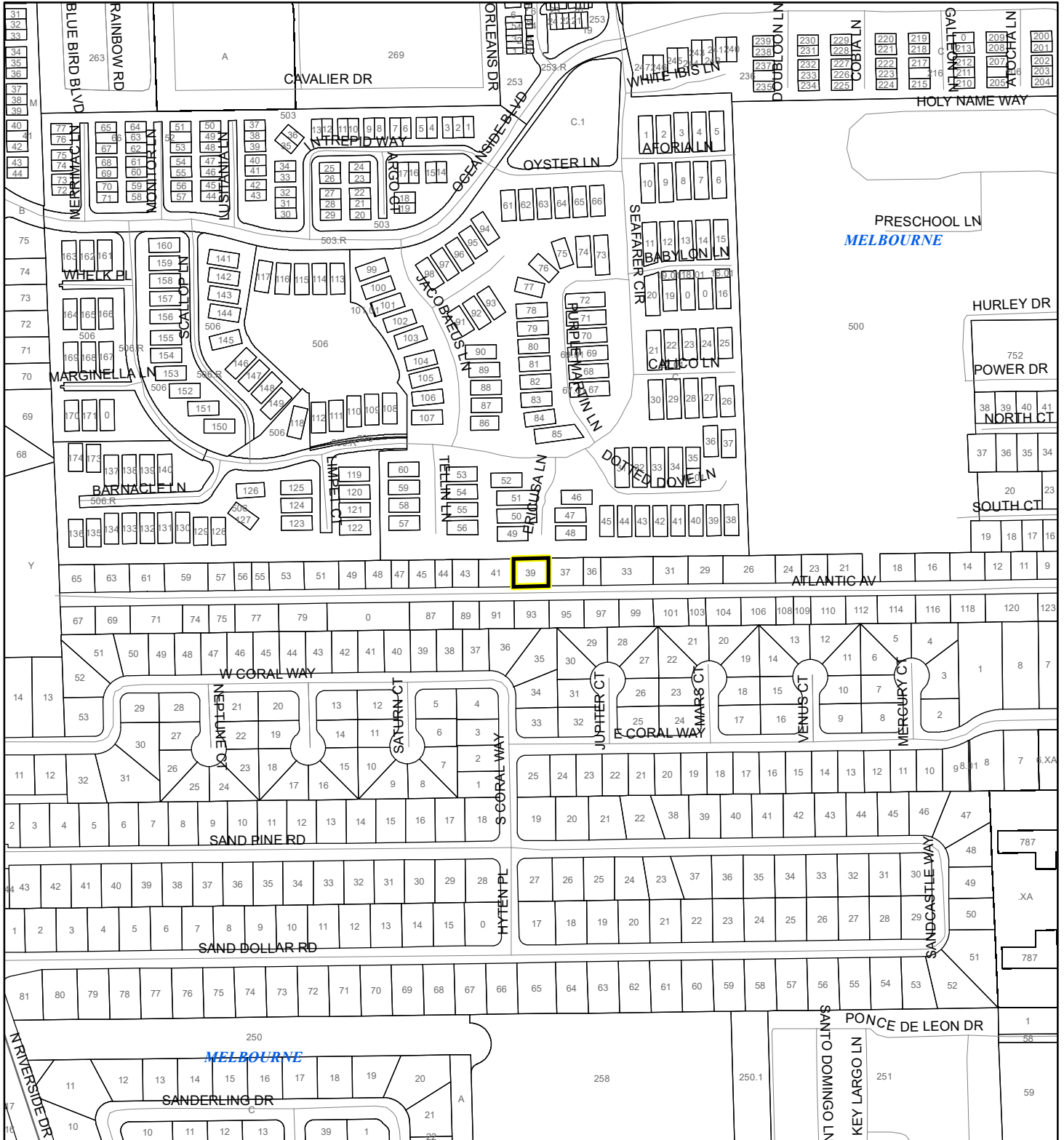

1:4,800 or 1 inch = 400 feet

This map was compiled from recorded documents and does not reflect an actual survey. The Brevard County Board of County Commissioners does not assume responsibility for errors or omissions hereon.

Produced by BoCC - GIS Date: 10/2/2019

FEMA Flood Zones

- | | | |
|---|------------|----------------------|
| A | AO | X |
| AE | Open Water | X Protected By Levee |
| AH | VE | |
| 0.2 Percent Annual Chance Flood Hazard | | |
| 0.2 Percent Annual Chance Flood Hazard Contained in Channel | | |
| Subject Property | Parcels | |

INDIAN RIVER LAGOON SEPTIC OVERLAY MAP

DOCI, ZAMIRA AND GEZIM

19PZ00124

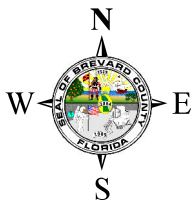
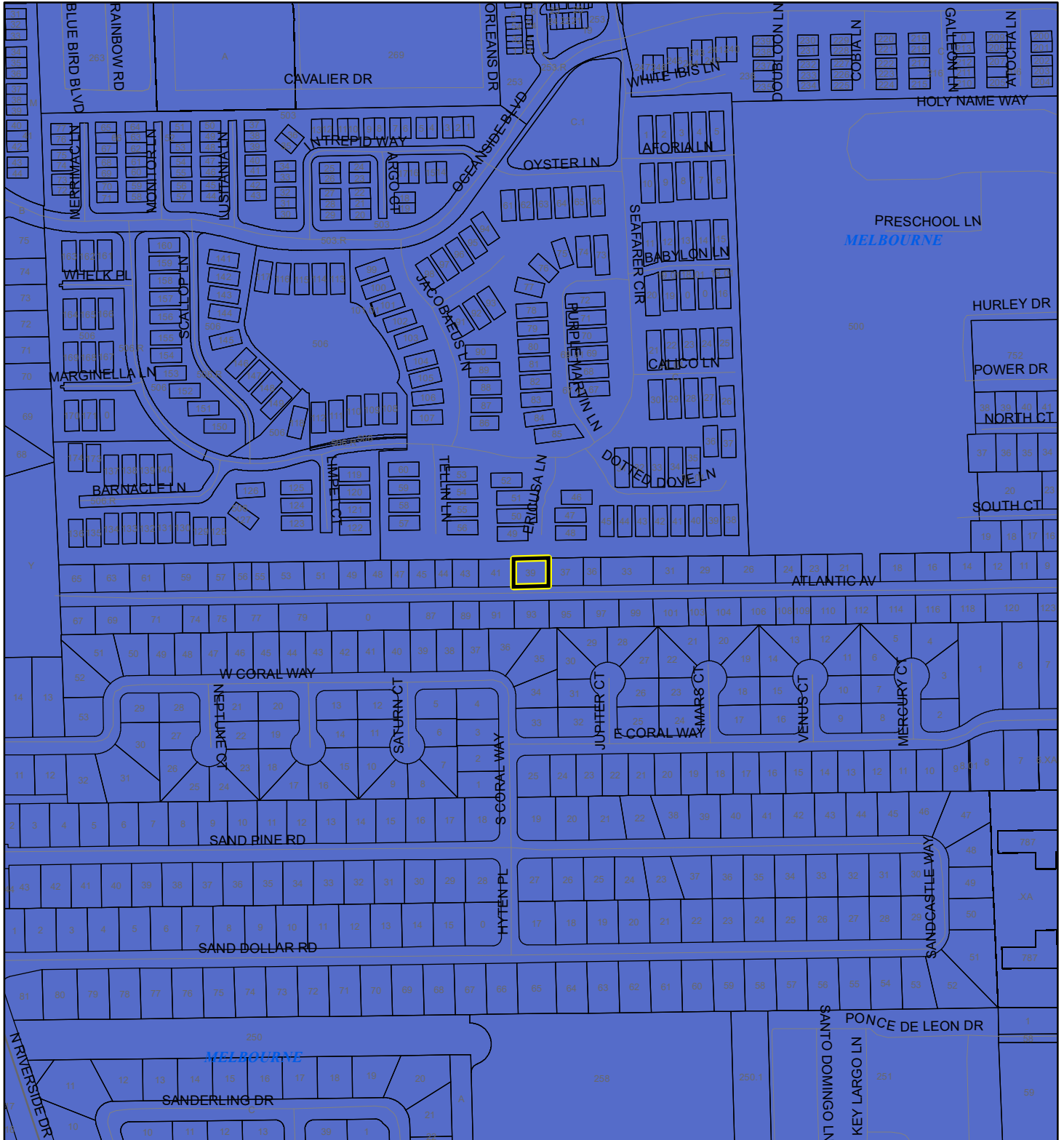

1:4,800 or 1 inch = 400 feet

This map was compiled from recorded documents and does not reflect an actual survey. The Brevard County Board of County Commissioners does not assume responsibility for errors or omissions hereon.

Produced by BoCC - GIS Date: 10/2/2019

 Subject Property

 Parcels

Septic Overlay

 40 Meters

 60 Meters

 All Distances

EAGLE NESTS MAP

DOCI, ZAMIRA AND GEZIM

19PZ00124

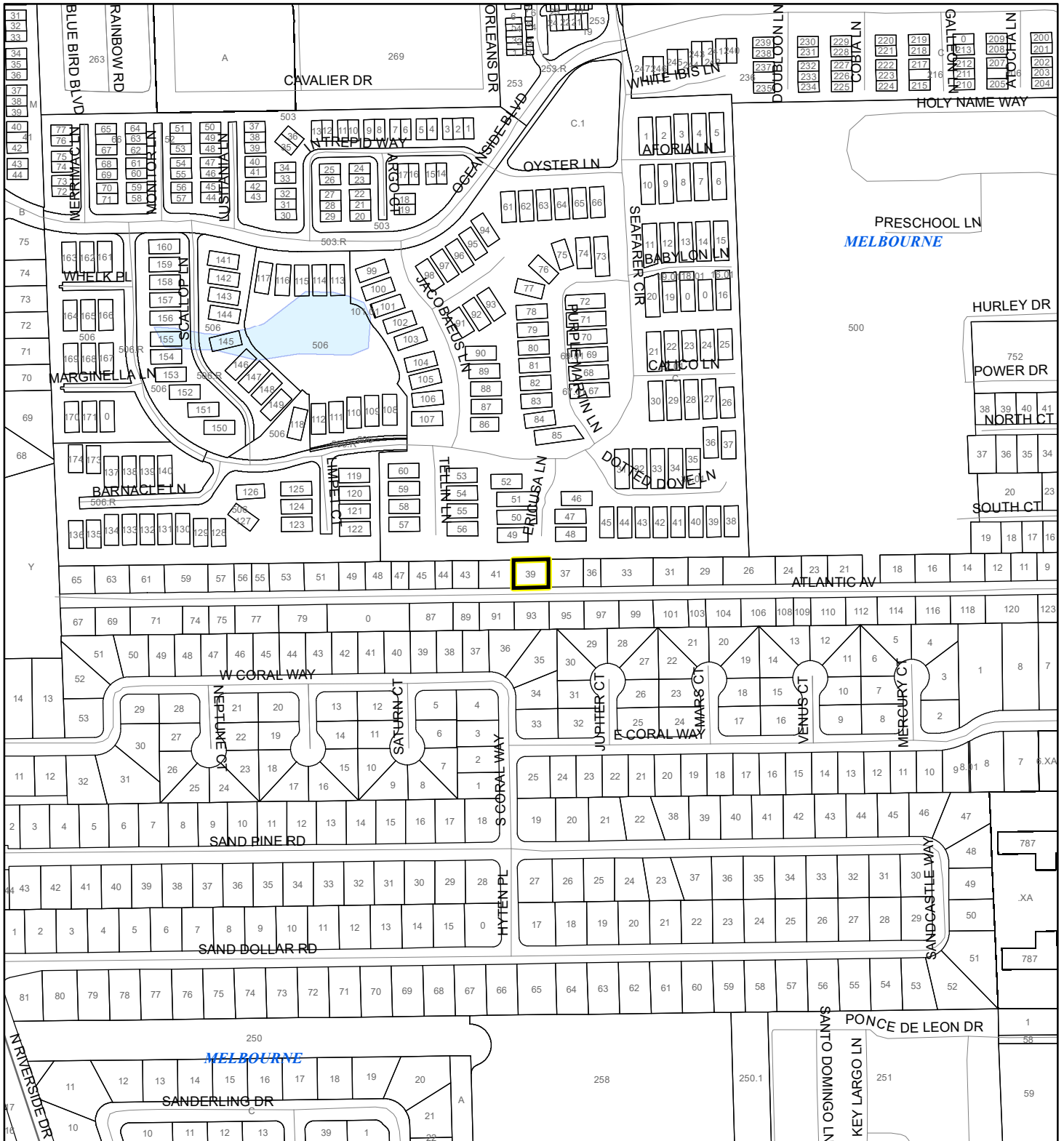

SCRUB JAY OCCUPANCY MAP

DOCI, ZAMIRA AND GEZIM

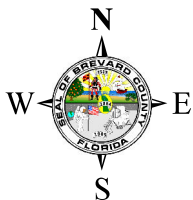
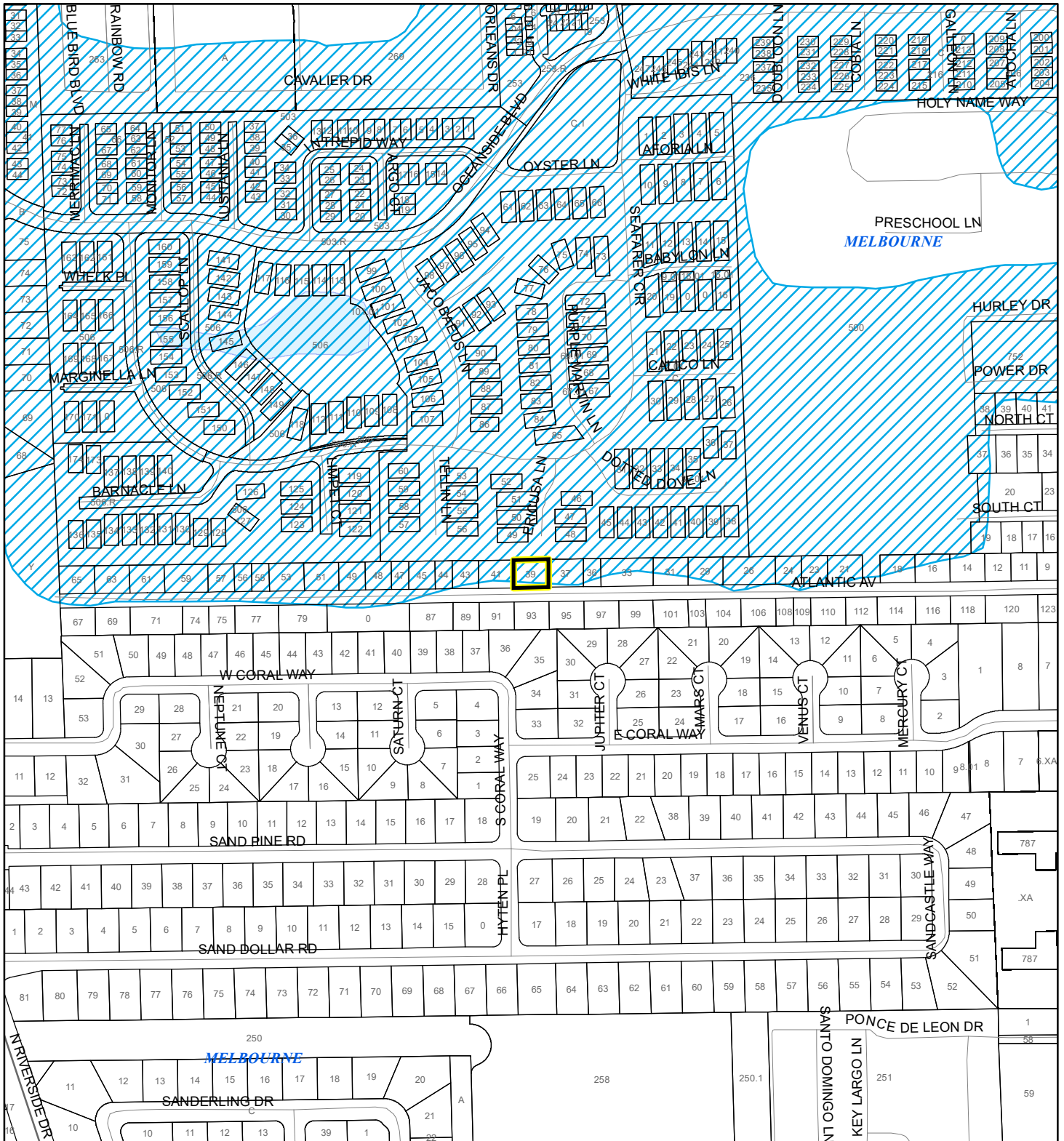

19PZ00124



1:4,800 or 1 inch = 400 feet

This map was compiled from recorded documents and does not reflect an actual survey. The Brevard County Board of County Commissioners does not assume responsibility for errors or omissions hereon.

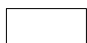
Produced by BoCC - GIS Date: 10/2/2019

-  Subject Property
-  Parcels
-  Scrub Jay Occupancy

SJRWMD FLUCCS UPLAND FORESTS - 4000 Series MAP

DOCI, ZAMIRA AND GEZIM

19PZ00124

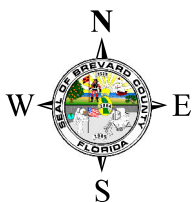
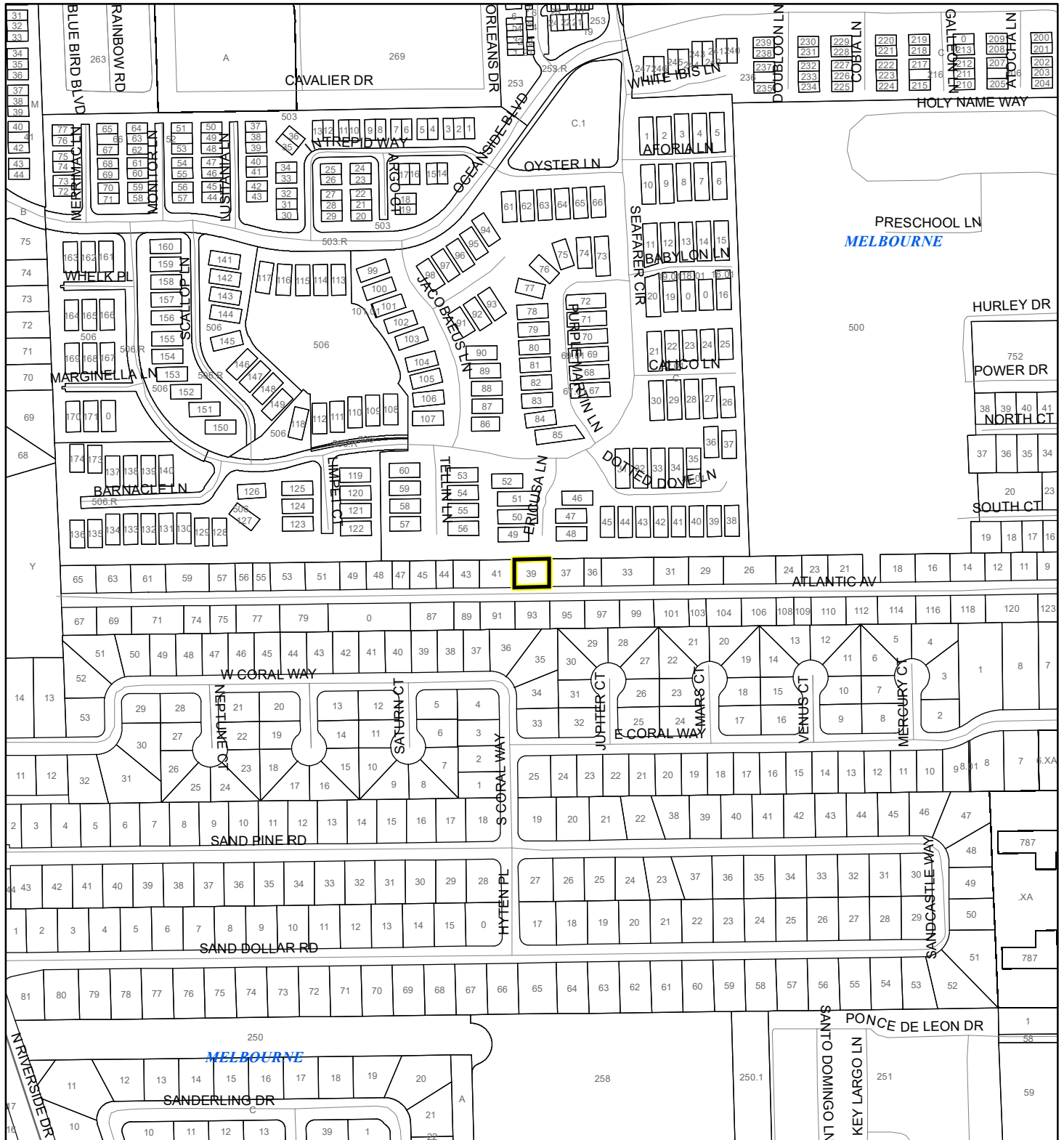

1:4,800 or 1 inch = 400 feet

SJRWMD FLUCCS Upland Forests

- Upland Coniferous Forest - 4100 Series
- Upland Hardwood Forest - 4200 Series
- Upland Mixed Forest - 4300 Series
- Tree Plantations - 4400 Series

This map was compiled from recorded documents and does not reflect an actual survey. The Brevard County Board of County Commissioners does not assume responsibility for errors or omissions hereon.

Produced by BoCC - GIS Date: 10/2/2019

Subject Property Parcels