

LOCATION MAP

LEE, ANDREW P
25V00054

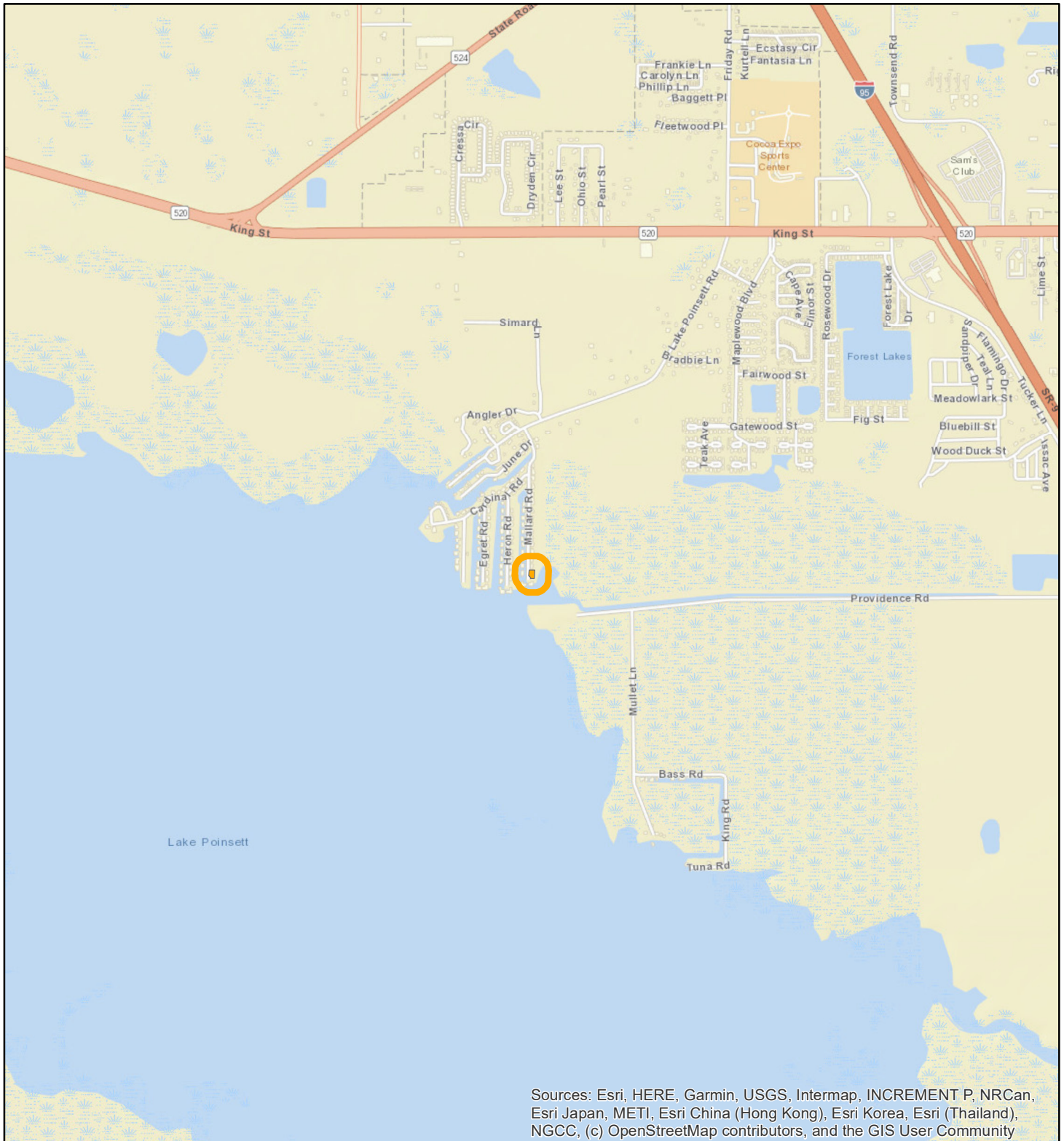



1:24,000 or 1 inch = 2,000 feet

Buffer Distance: 200 feet

This map was compiled from recorded documents and does not reflect an actual survey. The Brevard County Board of County Commissioners does not assume responsibility for errors or omissions hereon.

Produced by BoCC - GIS Date: 8/14/2025

 Buffer
 Subject Property

LEE, ANDREW P
25V00054

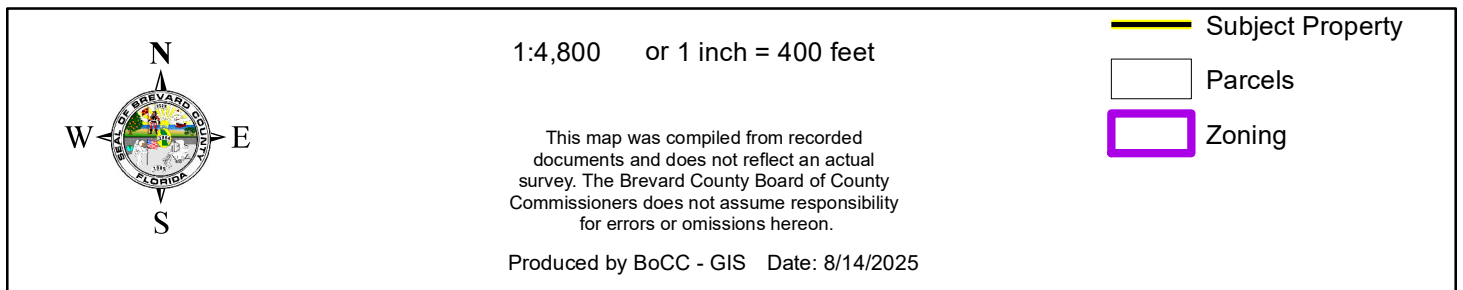

AERIAL MAP

LEE, ANDREW P

25V00054



1:1,200 or 1 inch = 100 feet

PHOTO YEAR: 2025

This map was compiled from recorded documents and does not reflect an actual survey. The Brevard County Board of County Commissioners does not assume responsibility for errors or omissions hereon.

Produced by BoCC - GIS Date: 8/14/2025

 Subject Property

 Parcels