

# LOCATION MAP

782 LLC  
25Z00039

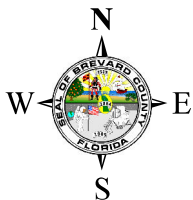

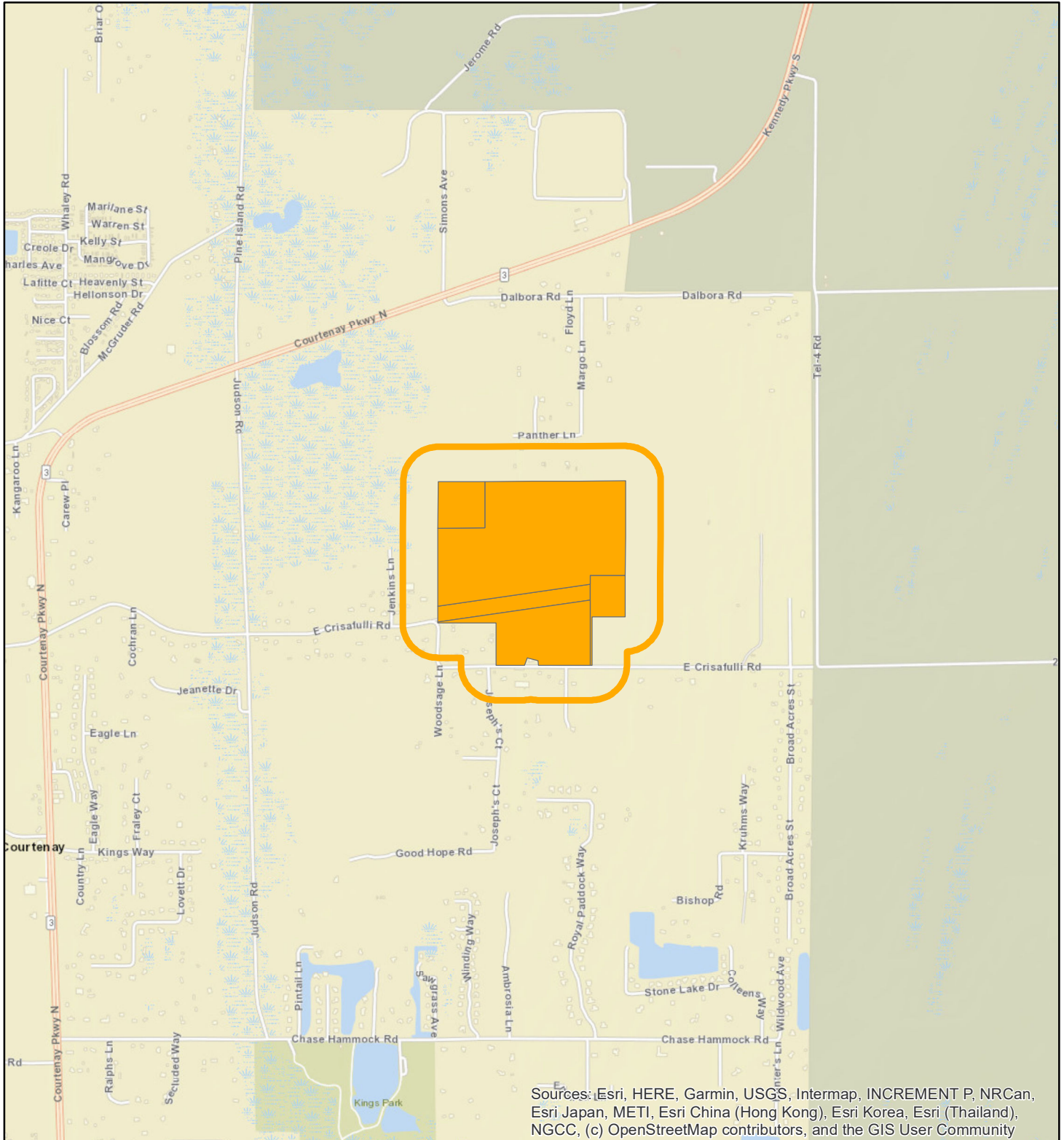

1:24,000 or 1 inch = 2,000 feet

Buffer Distance: 500 feet

This map was compiled from recorded documents and does not reflect an actual survey. The Brevard County Board of County Commissioners does not assume responsibility for errors or omissions hereon.

Produced by BoCC - GIS Date: 10/13/2025

 Buffer  
 Subject Property

# ZONING MAP

782 LLC  
25Z00039

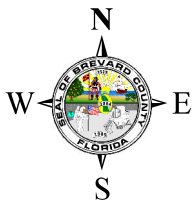
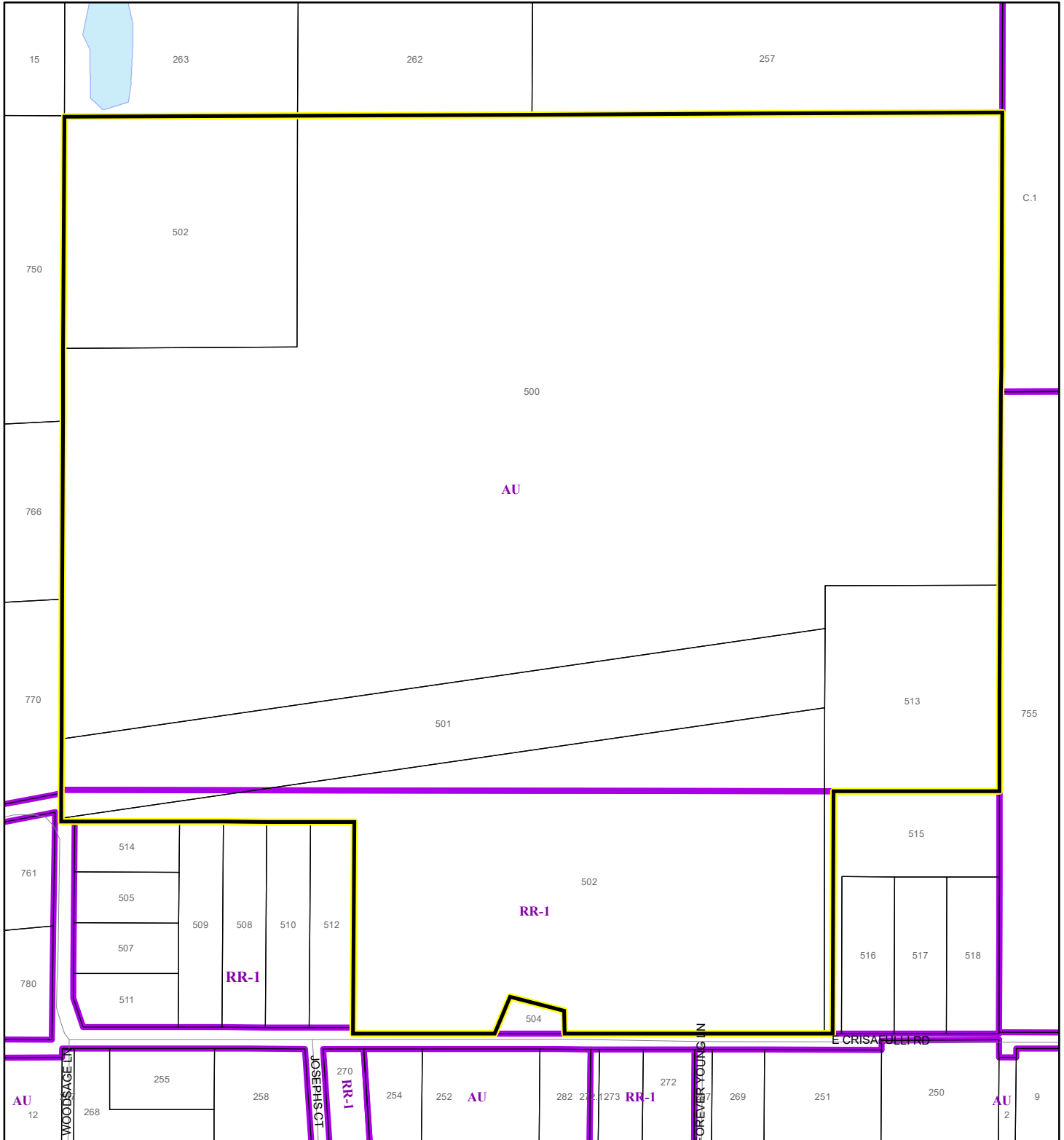

1:4,800 or 1 inch = 400 feet

This map was compiled from recorded documents and does not reflect an actual survey. The Brevard County Board of County Commissioners does not assume responsibility for errors or omissions hereon.

Produced by BoCC - GIS Date: 10/13/2025

       Subject Property

Parcels



Zoning

# FUTURE LAND USE MAP

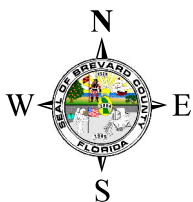
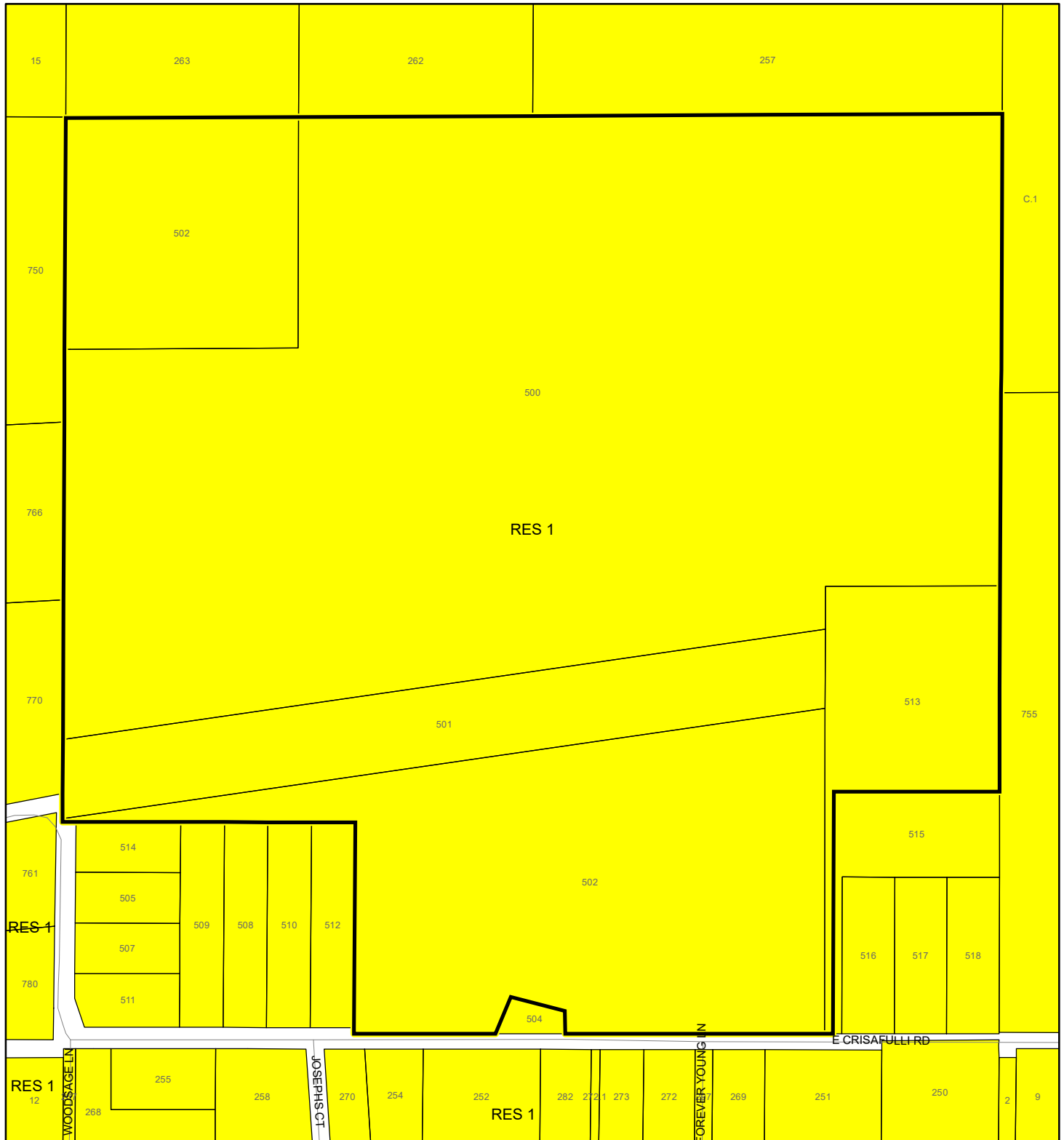
782 LLC  
25Z00039



1:4,800 or 1 inch = 400 feet

 Subject Property  
 Parcels

This map was compiled from recorded documents and does not reflect an actual survey. The Brevard County Board of County Commissioners does not assume responsibility for errors or omissions hereon.

Produced by BoCC - GIS Date: 10/13/2025

# AERIAL MAP

782 LLC  
25Z00039

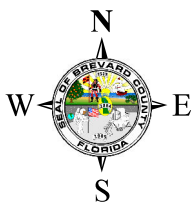



1:4,800 or 1 inch = 400 feet

PHOTO YEAR: 2025

This map was compiled from recorded documents and does not reflect an actual survey. The Brevard County Board of County Commissioners does not assume responsibility for errors or omissions hereon.

Produced by BoCC - GIS Date: 10/13/2025

 Subject Property  
 Parcels

# NWI WETLANDS MAP

782 LLC  
25Z00039

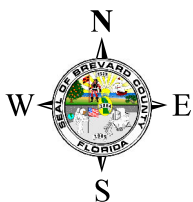
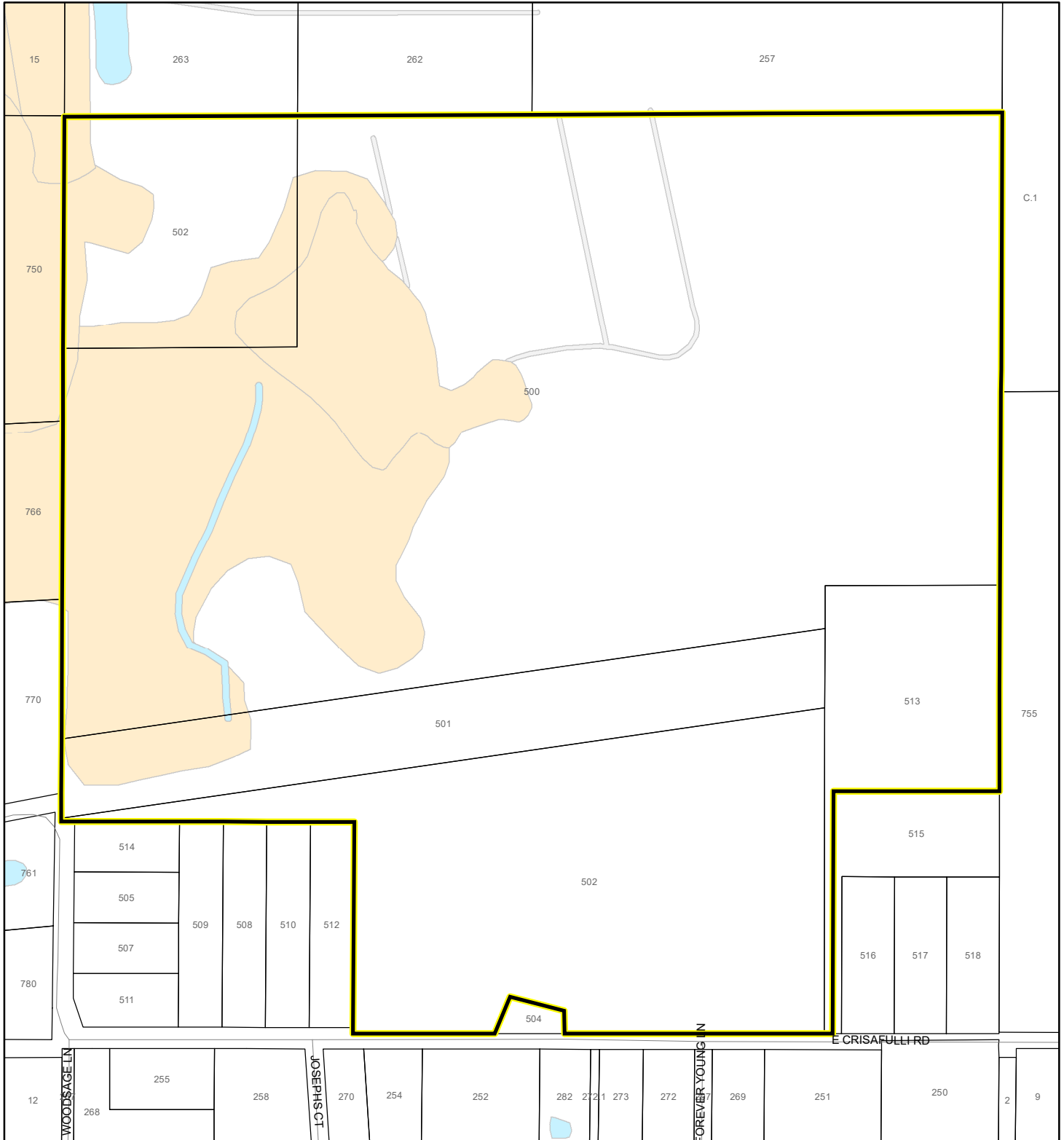

1:4,800 or 1 inch = 400 feet

This map was compiled from recorded documents and does not reflect an actual survey. The Brevard County Board of County Commissioners does not assume responsibility for errors or omissions hereon.

Produced by BoCC - GIS Date: 10/13/2025

## National Wetlands Inventory (NWI)

Estuarine and Marine Deepwater	Freshwater Pond
Estuarine and Marine Wetland	Lake
Freshwater Emergent Wetland	Other
Freshwater Forested/Shrub Wetland	Riverine
Subject Property	
Parcels	

## SJRWMD FLUCCS WETLANDS - 6000 Series MAP

782 LLC  
25Z00039

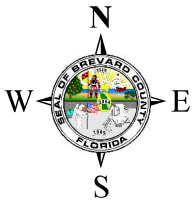
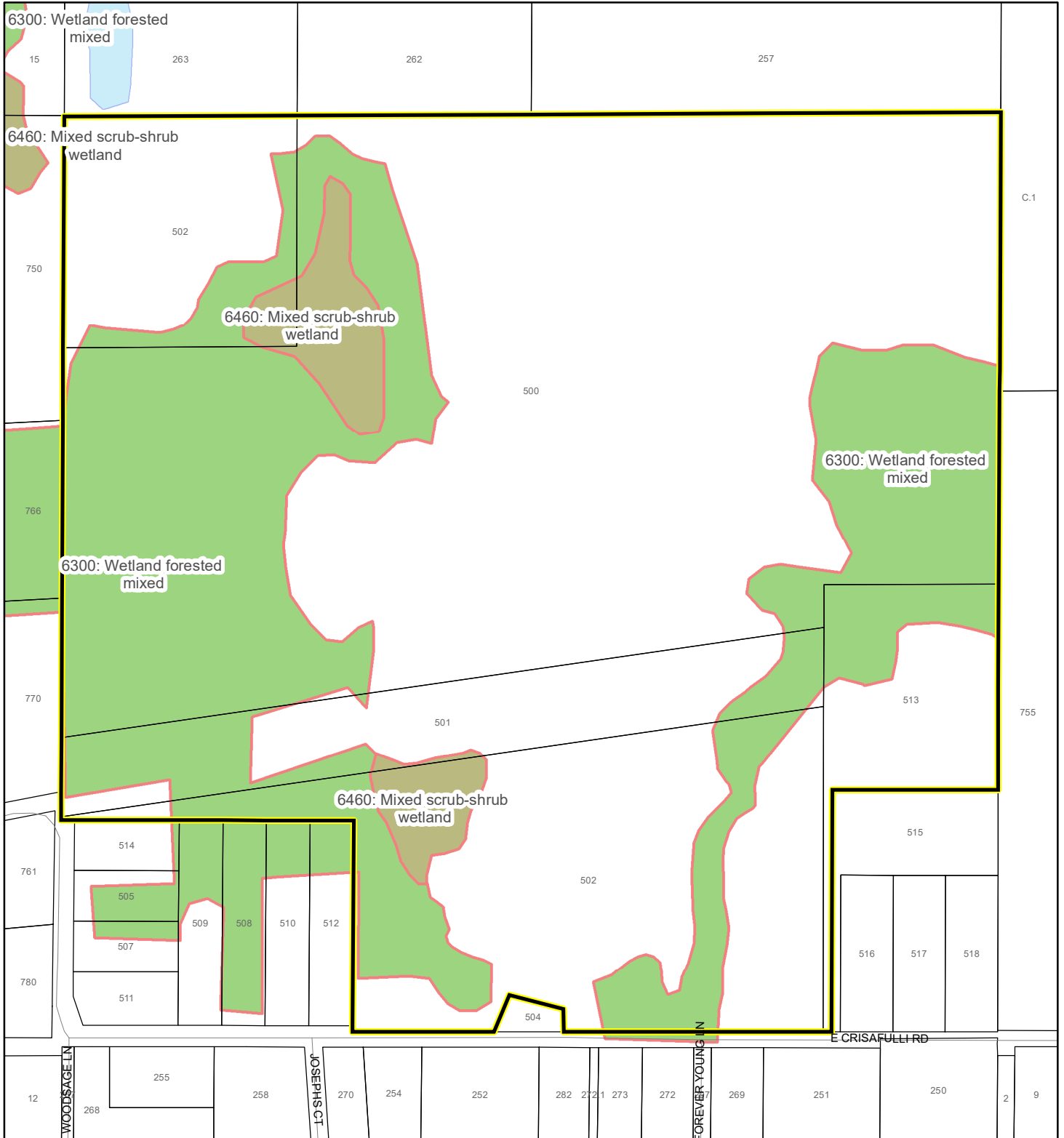

1:4,800      or 1 inch = 400 feet

This map was compiled from recorded documents and does not reflect an actual survey. The Brevard County Board of County Commissioners does not assume responsibility for errors or omissions hereon.

Produced by BoCC - GIS    Date: 10/13/2025

## SJRWMD FLUCCS WETLANDS

-  Wetland Hardwood Forests - Series 6100
-  Wetland Coniferous Forest - Series 6200
-  Wetland Forested Mixed - Series 6300
-  Vegetated Non-Forested Wetlands - Series 6400
-  Non-Vegetated Wetland - Series 6500

**Subject Property**

☐ Parcels

# USDA SCSSS SOILS MAP

782 LLC  
25Z00039

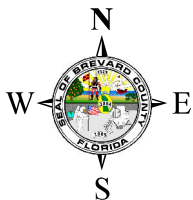
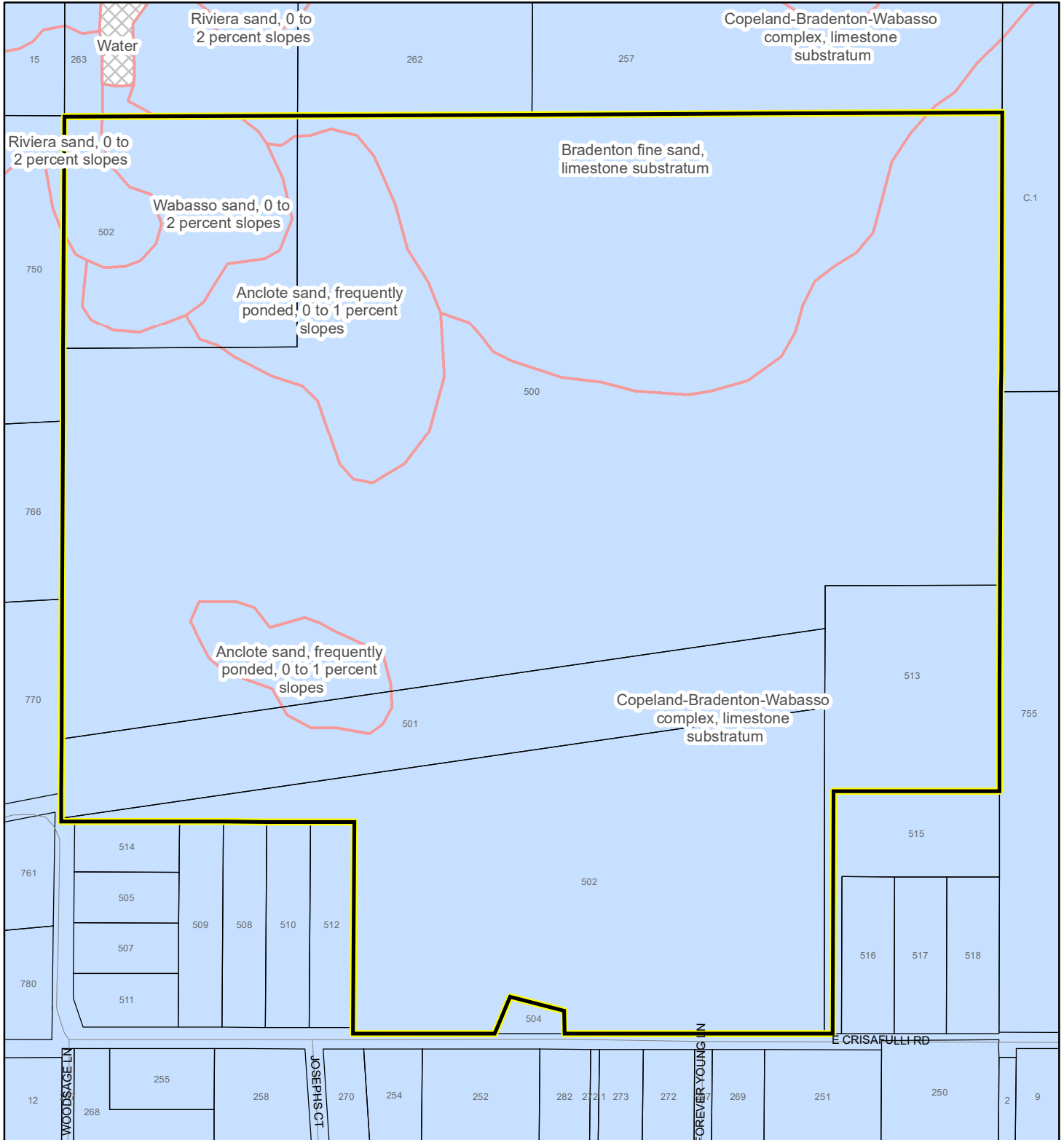

1:4,800 or 1 inch = 400 feet

This map was compiled from recorded documents and does not reflect an actual survey. The Brevard County Board of County Commissioners does not assume responsibility for errors or omissions hereon.

Produced by BoCC - GIS Date: 10/13/2025

## USDA SCSSS Soils

- Aquifer and Hydric
- Aquifer
- Hydric
- None

- Subject Property
- Parcels

# FEMA FLOOD ZONES MAP

782 LLC  
25Z00039

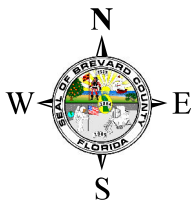
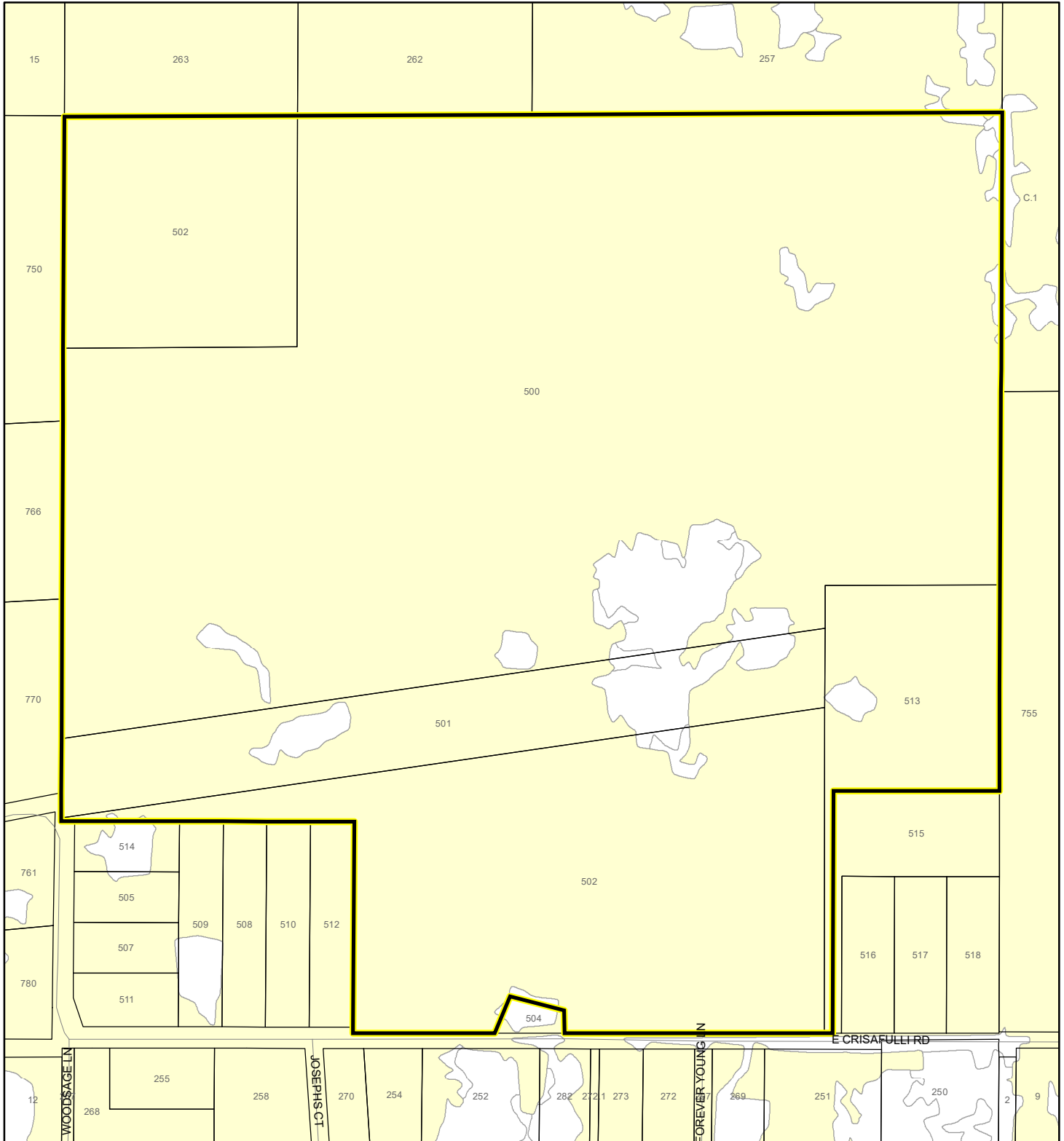

1:4,800 or 1 inch = 400 feet

This map was compiled from recorded documents and does not reflect an actual survey. The Brevard County Board of County Commissioners does not assume responsibility for errors or omissions hereon.

Produced by BoCC - GIS Date: 10/13/2025

## FEMA Flood Zones

A	AO	X
AE	Open Water	
AH	VE	
Subject Property	Parcels	

# COASTAL HIGH HAZARD AREA MAP

782 LLC  
25Z00039

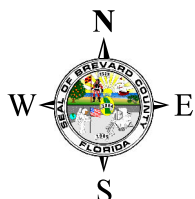
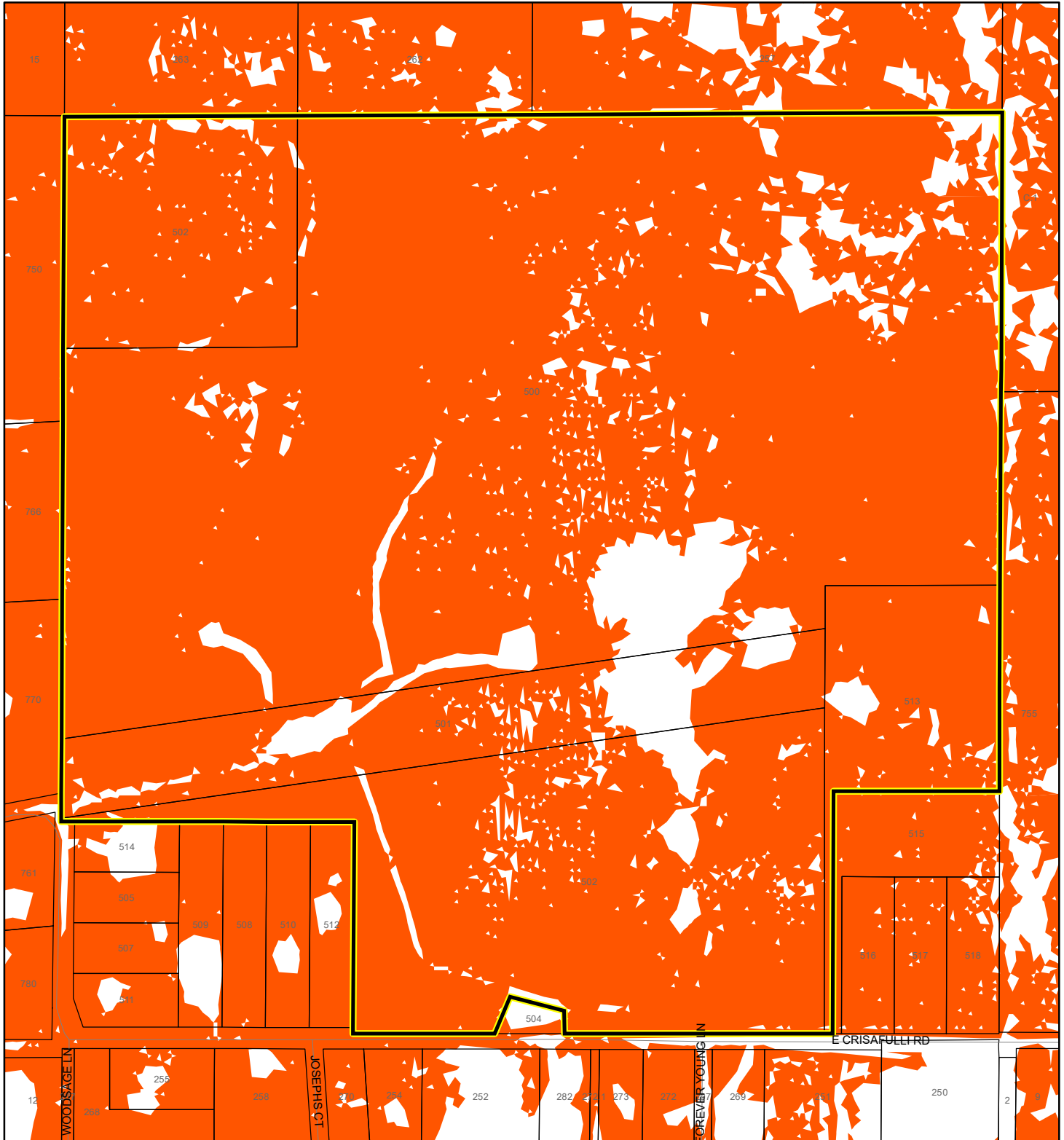

1:4,800 or 1 inch = 400 feet

This map was compiled from recorded documents and does not reflect an actual survey. The Brevard County Board of County Commissioners does not assume responsibility for errors or omissions hereon.

Produced by BoCC - GIS Date: 10/13/2025

Subject Property

Parcels

**Coastal High Hazard Area**

SurgeZoneCat1

# INDIAN RIVER LAGOON SEPTIC OVERLAY MAP

782 LLC  
25Z00039

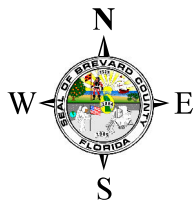
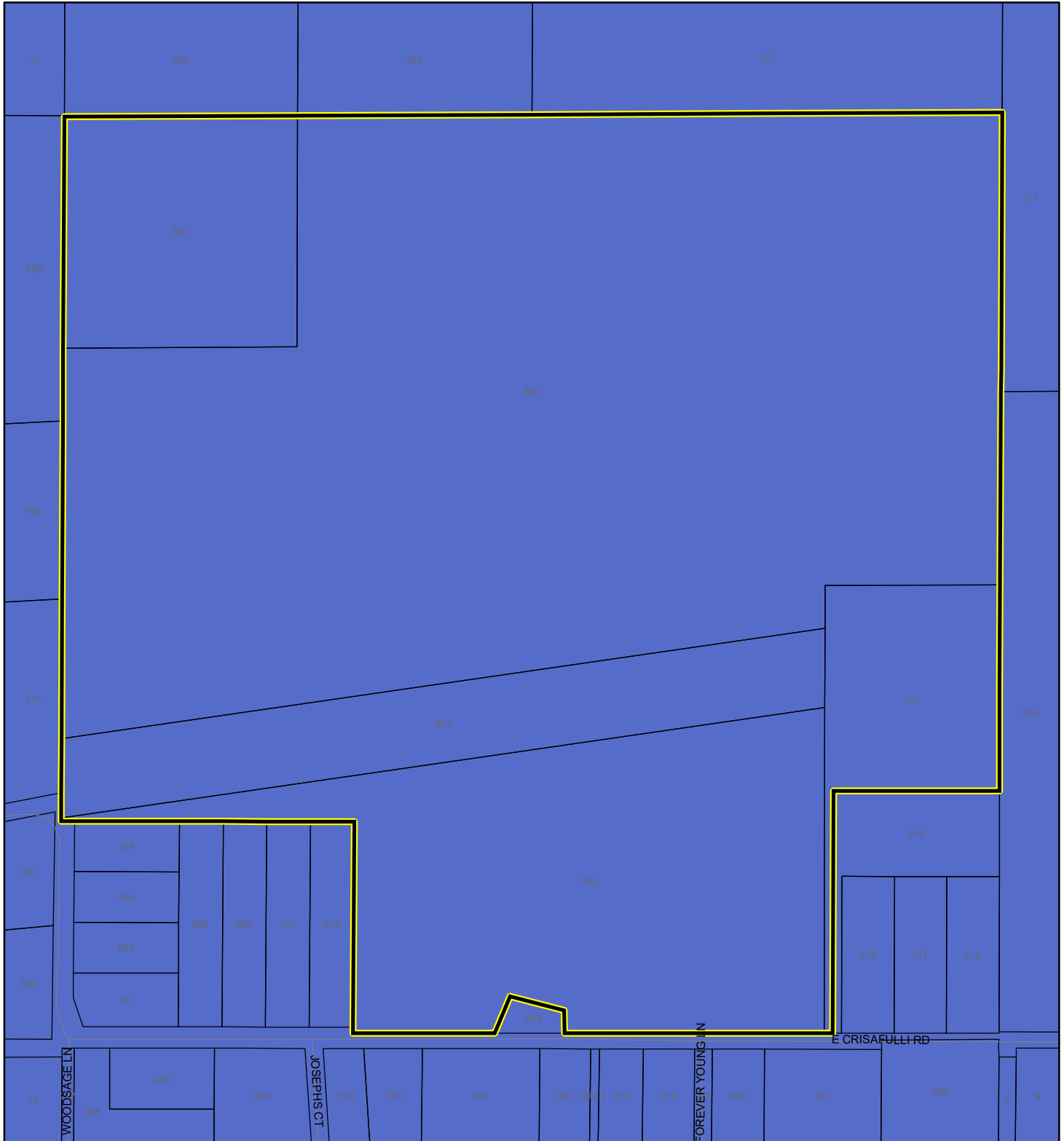

1:4,800 or 1 inch = 400 feet

This map was compiled from recorded documents and does not reflect an actual survey. The Brevard County Board of County Commissioners does not assume responsibility for errors or omissions hereon.

Produced by BoCC - GIS Date: 10/13/2025

 Subject Property

 Parcels

**Septic Overlay**

 40 Meters

 60 Meters

 All Distances

# EAGLE NESTS MAP

782 LLC  
25Z00039

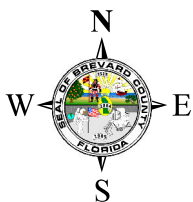
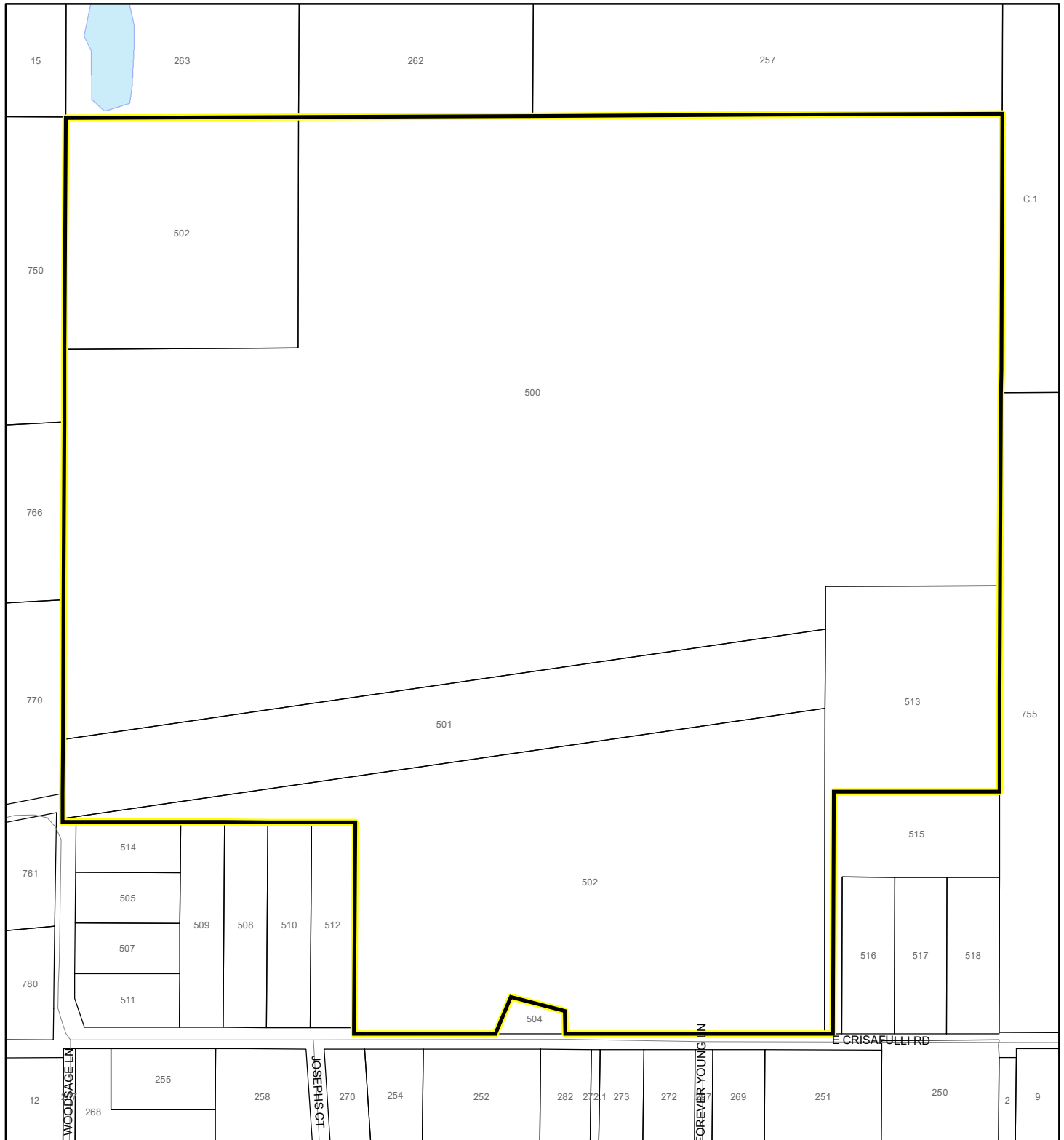

1:4,800 or 1 inch = 400 feet

This map was compiled from recorded documents and does not reflect an actual survey. The Brevard County Board of County Commissioners does not assume responsibility for errors or omissions hereon.

Produced by BoCC - GIS Date: 10/13/2025

 Subject Property

 Parcels

 Eagle Nests FWS

# SCRUB JAY OCCUPANCY MAP

782 LLC  
25Z00039

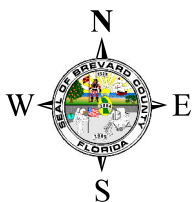
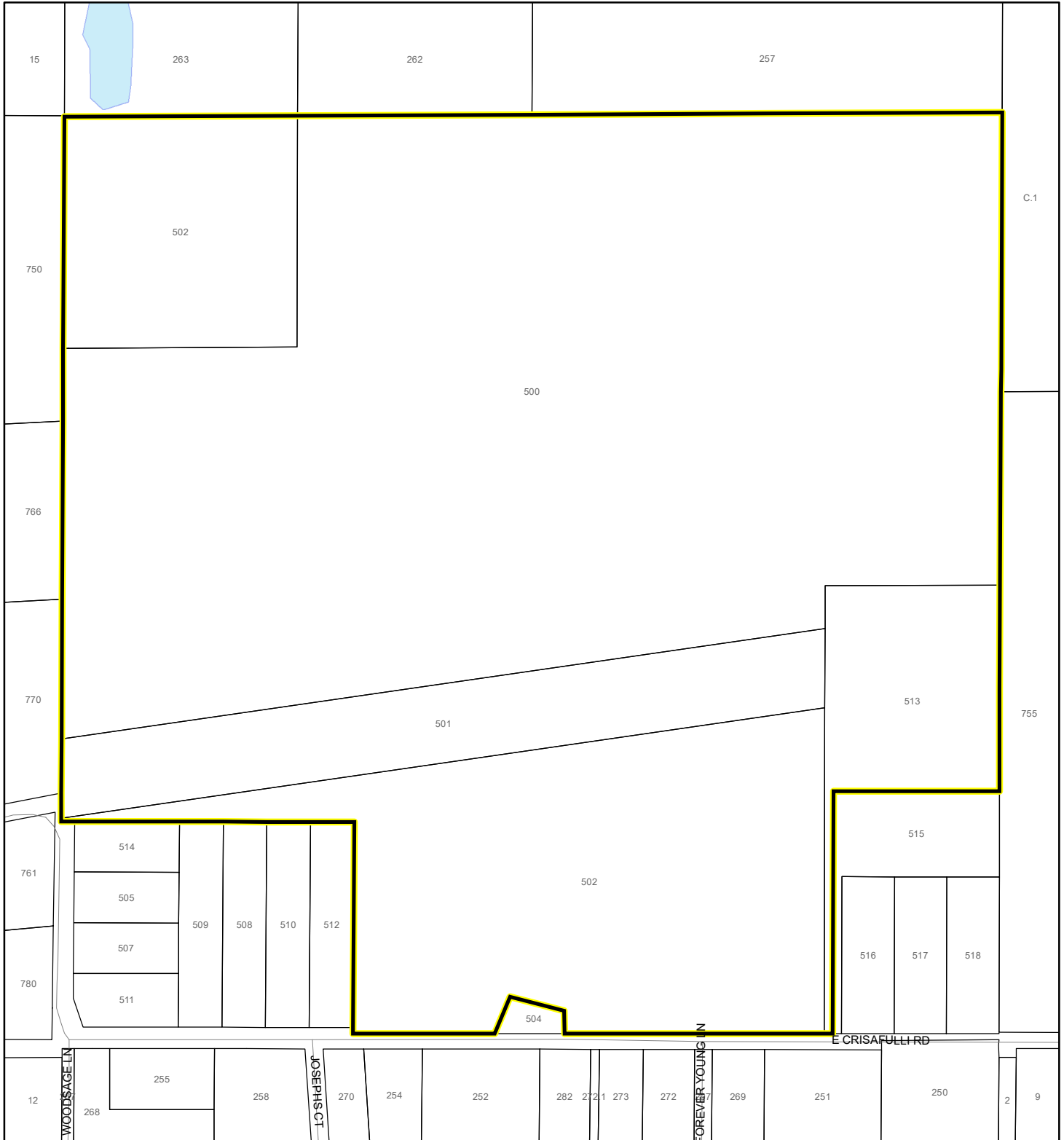

1:4,800 or 1 inch = 400 feet

This map was compiled from recorded documents and does not reflect an actual survey. The Brevard County Board of County Commissioners does not assume responsibility for errors or omissions hereon.

Produced by BoCC - GIS Date: 10/13/2025

- Subject Property
- Parcels
- Scrub Jay Occupancy

# SJRWMD FLUCCS UPLAND FORESTS - 4000 Series MAP

782 LLC  
25Z00039

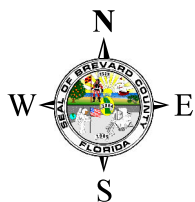
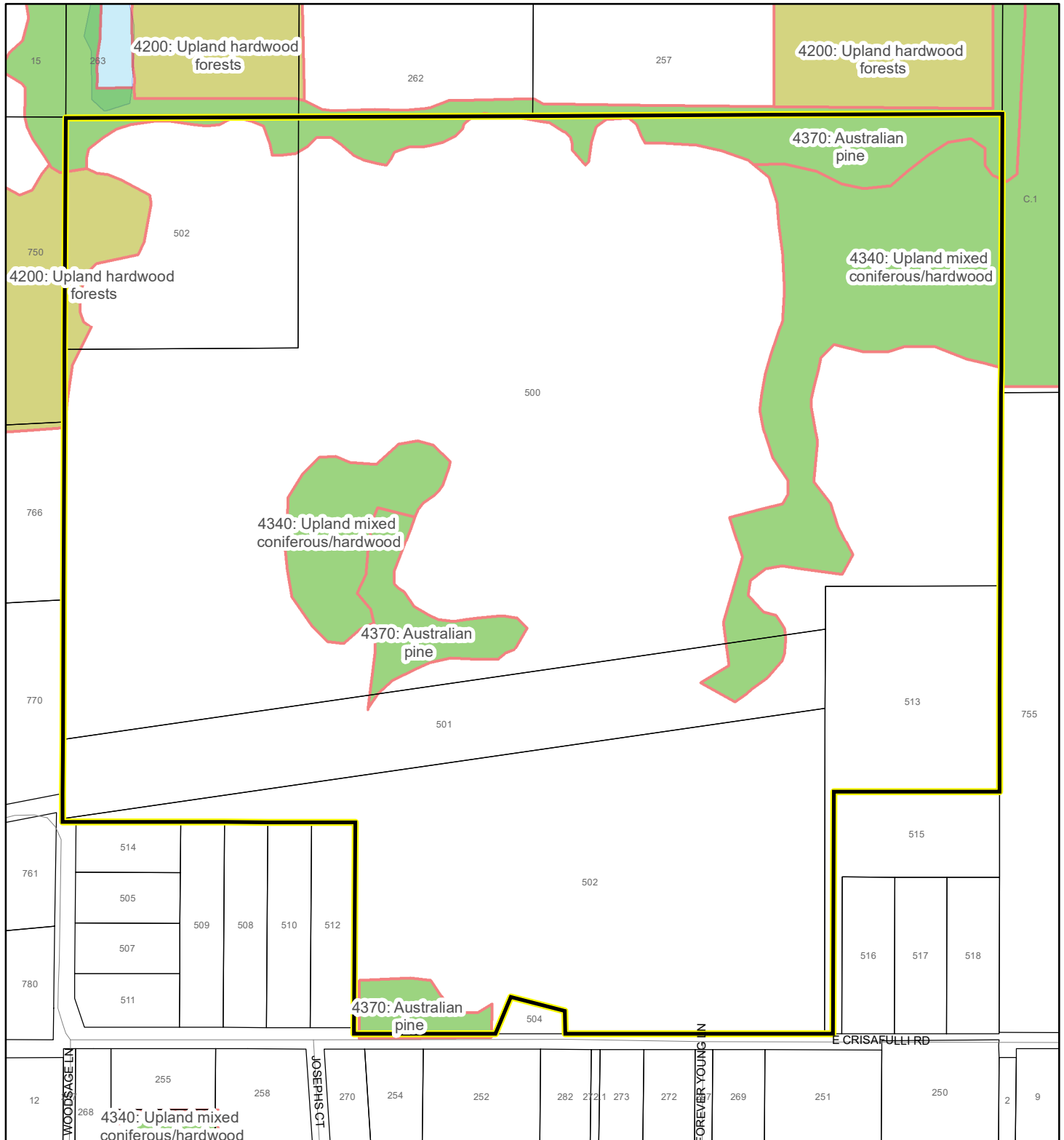

1:4,800 or 1 inch = 400 feet

This map was compiled from recorded documents and does not reflect an actual survey. The Brevard County Board of County Commissioners does not assume responsibility for errors or omissions hereon.

Produced by BoCC - GIS Date: 10/13/2025

## SJRWMD FLUCCS Upland Forests

- Upland Coniferous Forest - 4100 Series
- Upland Hardwood Forest - 4200 Series
- Upland Mixed Forest - 4300 Series
- Tree Plantations - 4400 Series

Subject Property

Parcels