

LOCATION MAP
NTS

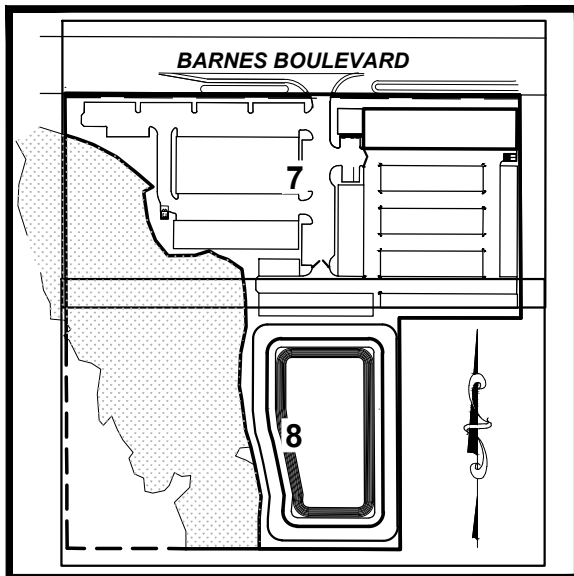

SHEET LAYOUT
NTS

- LEGEND**
- NEW PAVEMENT SECTION (SEE SHEET 21 FOR DETAILS)
 - PROPOSED SIDEWALK
 - EXISTING PAVEMENT TO BE RE-MILLED & RESURFACED

B.E. CONSULTANTS, INC.
CONSULTING - ENGINEERING - LAND SURVEYING

312 SOUTH HARBOR CITY BOULEVARD, SUITE 4
MELBOURNE, FLORIDA 32901
PHONE: (321) 723-3674 FAX: (321) 723-1159
CERTIFICATE OF PROFESSIONAL ENGINEERS
BUSINESS AUTHORIZATION: 4905
CERTIFICATE OF LAND SURVEYING
BUSINESS AUTHORIZATION: LB0004905

SCOTT M. GLAUBITZ, P.E. & P.L.S.
STATE OF FLORIDA, No. 33659 No. 4151

HASSAN A. KAMAL, P.E.
STATE OF FLORIDA, No. 41951

(IN FEET)

VERTICAL DATUM: NAVD83

DATE:	2/18/25
DESIGN/DRAWN:	HAK/EAK
PROJECT TITLE	
BARNES BOULEVARD SELF STORAGE	
SHEET TITLE	
OVERALL SITE EXHIBIT	
PROJECT NO.	11633
DRAWING NO.	11633_200_014
SHEET	1 of 1

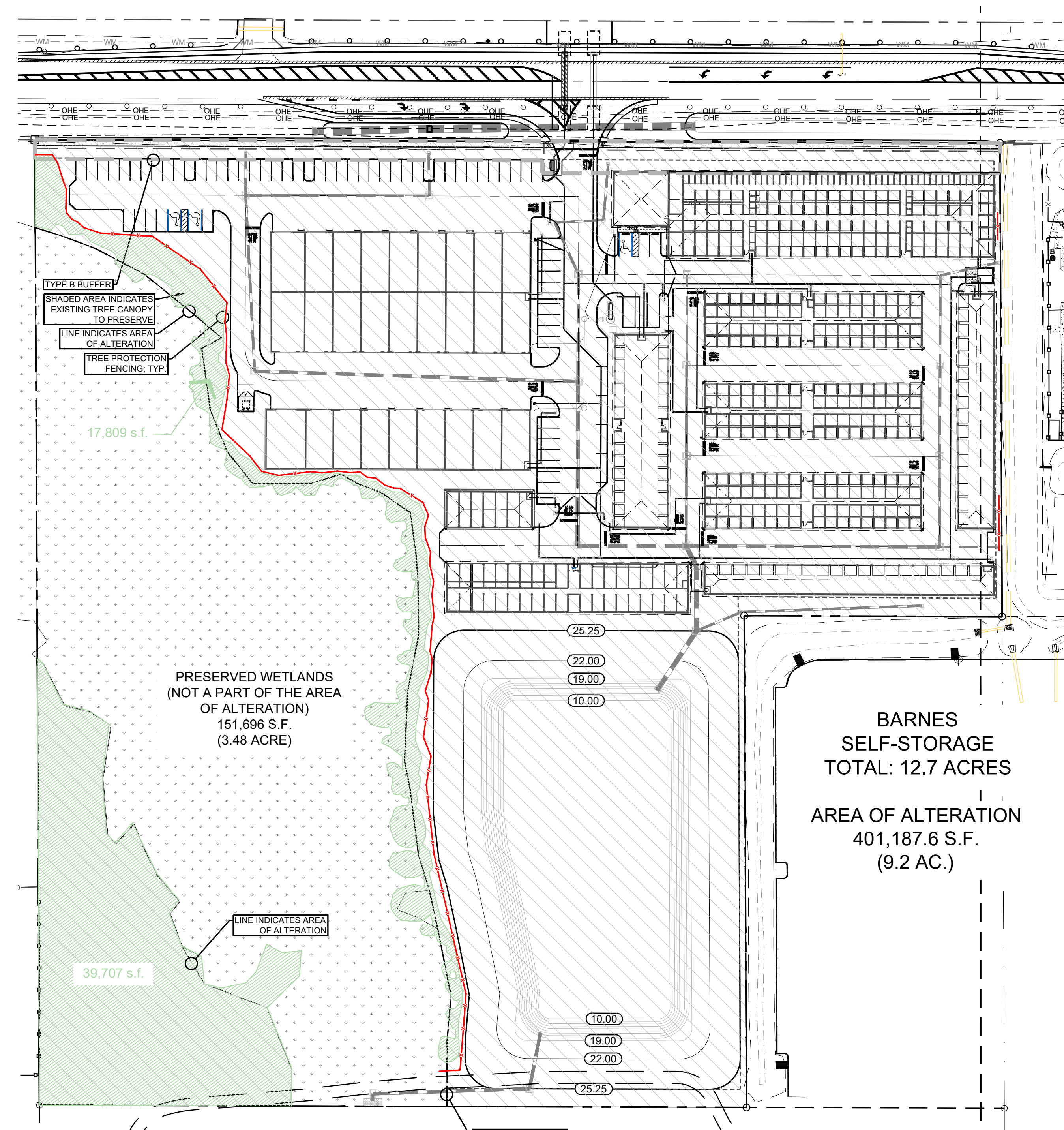

OVERALL SITE COVER SHEET

SCALE: NOT TO SCALE



LANDSCAPE ARCHITECTURE BY: SUSAN HALL
LANDSCAPE ARCHITECTURE, INC.

LEGAL DESCRIPTION:

A PART OF THE EAST 1/2 OF THE WEST 1/2 OF THE SW 1/4 OF SECTION 36, TOWNSHIP 23 SOUTH, RANGE 35 EAST, BREVARD COUNTY, FLORIDA, BEING MORE PARTICULARLY DESCRIBED AS FOLLOWS: FOR A POINT OF REFERENCE, COMMENCE AT THE SW CORNER OF SAID SECTION 36, THENCE EAST ALONG THE SOUTH LINE OF SAID SECTION 36 A DISTANCE OF 669.58 FEET; THENCE N. 0 DEGREES 20' 47" W., 50 FEET TO THE POINT OF BEGINNING; SAID POINT BEING ON THE NORTHERLY R/W OF CANAVERAL GROVES BLVD.; THENCE N. 0 DEGREES 20' 47" W., 2218.02 FEET; THENCE N. 89 DEGREES 32' 10" E., 671.18 FEET; THENCE S 0 DEGREES 18' 07" E., 2222.93 FEET TO THE NORTHERLY RIGHT OF WAY LINE OF CANAVERAL GROVES BLVD.; THENCE WEST 669.46 FEET TO THE POINT OF BEGINNING.

PLAN INDEX		ISSUE DATE			REVISION
L-1	COVER SHEET	11.13.24	#3	11.13.24	05.23.23: COUNTY COMMENTS: ADDED ADD'L NOTE ON L-1 & ADDED TREE PROTECTION FENCING LAYOUTS ON PLAN.
L-2	EXISTING VEGETATION PLAN, LIST & DETAILS	11.13.24	#3	11.13.24	
L-3	NORTHERN SITE LANDSCAPE PLAN	11.13.24	#3	11.13.24	
L-4	SOUTHERN SITE LANDSCAPE PLAN	11.13.24	#3	11.13.24	05.20.24: COORDINATION WITH CIVIL SITE PLAN REVISIONS
L-5	LANDSCAPE CALCULATIONS & PLANT LIST	11.13.24			
L-6	LANDSCAPE DETAILS & SPECIFICATIONS	11.13.24			11.13.24: COORDINATION WITH CIVIL SITE PLAN REVISIONS

NOTE:
PROTECT EXISTING TREES. CALL 321.633.2016 FOR TREE ROOT PROTECTION INSPECTION PRIOR TO ANY LAND CLEARING, ALTERATION, OR COMMENCEMENT OF CONSTRUCTION INCLUDING GRADING AND FILLING. FAILURE TO SCHEDULE AN INSPECTION OR PROVIDE MAY BE SUBJECT TO STOP WORK ORDER AND OTHER PENALTIES AND REMEDIES PURSUANT TO SECTION 62-4336. SEE TYPICAL DETAIL (SHEET L-6).



Susan Hall, ASLA
LANDSCAPE ARCHITECTURE
LC26000357
244 McLEOD STREET
MERRITT ISLAND, FL 32953
PHONE: (321) 449-0790
FAX: (321) 449-1225
www.hall-la.com

BARNES SELF-STORAGE
Barnes Boulevard & Playa Del Sol Drive
BREVARD COUNTY, FL

SHEET TITLE COVER SHEET	
DATE 11.13.24	
DESIGN S.H.	
DRAWN D.F.	
SCALE	
REVISIONS 05.23.23: COUNTY COMMENTS: ADDED ADD'L NOTE ON L-1 & ADDED TREE PROTECTION FENCING LAYOUTS ON PLAN.	
SEAL 11-13-24	
L-1 SHEET	6 OF

EXISTING VEGETATION					
TREE #	TYPE	DBH IN INCHES	STATUS	REMARKS	MITIGATION (INCHES)
1	Slash Pine (<i>Pinus elliotti</i>)	21	Preserve		
2	Slash Pine (<i>Pinus elliotti</i>)	16	Remove	In Parking lot	
3	Slash Pine (<i>Pinus elliotti</i>)	13	Remove	In Parking lot	
4	Slash Pine (<i>Pinus elliotti</i>)	20	Remove	In Parking lot	
5	Slash Pine (<i>Pinus elliotti</i>)	14	Remove	In Parking lot	
6	Slash Pine (<i>Pinus elliotti</i>)	17	Remove	In Parking lot	
7	Slash Pine (<i>Pinus elliotti</i>)	15	Remove	In Parking lot	
8	Slash Pine (<i>Pinus elliotti</i>)	15	Remove	In Parking lot	
9	Slash Pine (<i>Pinus elliotti</i>)	15	Remove	In Parking lot	
10	Slash Pine (<i>Pinus elliotti</i>)	13	Remove	In Building Pad	
11	Slash Pine (<i>Pinus elliotti</i>)	13	Remove	In Building Pad	
12	Slash Pine (<i>Pinus elliotti</i>)	15	Remove	In Building Pad	
13	Slash Pine (<i>Pinus elliotti</i>)	15	Remove	In Drive	
14	Slash Pine (<i>Pinus elliotti</i>)	22	Remove	In Building Pad	
15	Slash Pine (<i>Pinus elliotti</i>)	12	Remove	In Building Pad	
16	Slash Pine (<i>Pinus elliotti</i>)	14	Remove	In Building Pad	
17	Slash Pine (<i>Pinus elliotti</i>)	13	Remove		
18	Slash Pine (<i>Pinus elliotti</i>)	10	Remove	In Parking lot	
19	Slash Pine (<i>Pinus elliotti</i>)	15	Remove	Affected by New Sidewalk	
20	Slash Pine (<i>Pinus elliotti</i>)	15	Remove	Double Trunk; In Drive	
21	Slash Pine (<i>Pinus elliotti</i>)	14	Remove	In Building Pad	
22	Slash Pine (<i>Pinus elliotti</i>)	15	Remove	In Building Pad	
23	Slash Pine (<i>Pinus elliotti</i>)	13	Remove		
24	Slash Pine (<i>Pinus elliotti</i>)	14	Preserve		
25	Slash Pine (<i>Pinus elliotti</i>)	16	Remove	In Building Pad	
26	Slash Pine (<i>Pinus elliotti</i>)	15	Remove	In Drive	
27	Slash Pine (<i>Pinus elliotti</i>)	13	Remove	Double Trunk; In Drive	
28	Slash Pine (<i>Pinus elliotti</i>)	17	Remove	In Drive	
29	Slash Pine (<i>Pinus elliotti</i>)	14	Remove	In Drive	
30	Slash Pine (<i>Pinus elliotti</i>)	16	Remove		
31	Slash Pine (<i>Pinus elliotti</i>)	16	Remove		
32	Slash Pine (<i>Pinus elliotti</i>)	15	Remove	In Building Pad	
33	Slash Pine (<i>Pinus elliotti</i>)	22	Remove	In Building Pad	
34	Slash Pine (<i>Pinus elliotti</i>)	16	Remove	In Drive	
35	Slash Pine (<i>Pinus elliotti</i>)	12	Remove	In Drive	
36	Slash Pine (<i>Pinus elliotti</i>)	16	Remove	In Drive	
37	Slash Pine (<i>Pinus elliotti</i>)	15	Remove	In Drive	
38	Slash Pine (<i>Pinus elliotti</i>)	16	Remove	In Building Pad	
39	Slash Pine (<i>Pinus elliotti</i>)	25	Remove	In Building Pad; Mitigate @ 25%	6.5
40	Slash Pine (<i>Pinus elliotti</i>)	22	Remove	In Building Pad	
41	Slash Pine (<i>Pinus elliotti</i>)	9	Remove	In Building Pad	
42	Slash Pine (<i>Pinus elliotti</i>)	10	Remove	In Building Pad	
43	Slash Pine (<i>Pinus elliotti</i>)	10	Remove	In Building Pad	
44	Slash Pine (<i>Pinus elliotti</i>)	7	Remove	In Building Pad	
45	Slash Pine (<i>Pinus elliotti</i>)	7	Remove	In Building Pad	
46	Slash Pine (<i>Pinus elliotti</i>)	10	Remove	In Building Pad	
47	Sabal Palm (<i>Sabal palmetto</i>)	10	Remove	Affected by New Sidewalk	
48	Sabal Palm (<i>Sabal palmetto</i>)	12	Remove	Affected by New Sidewalk	
49	Unknown Species	6	Remove	In Building Pad	
50	Unknown Species	Cluster	Remove	In Building Pad	
51	Live Oak (<i>Quercus virginiana</i>)	6	Remove	In Building Pad	
52	Live Oak (<i>Quercus virginiana</i>)	6	Remove	In Building Pad	
53	Live Oak (<i>Quercus virginiana</i>)	5	Remove	In Building Pad	
54	Slash Pine (<i>Pinus elliotti</i>)	18	Remove	In Building Pad	
55	Slash Pine (<i>Pinus elliotti</i>)	7	Remove	In Building Pad	
56	Slash Pine (<i>Pinus elliotti</i>)	10	Remove	In Building Pad	
57	Live Oak (<i>Quercus virginiana</i>)	4	Remove		
58	Live Oak (<i>Quercus virginiana</i>)	8	Remove		
59	Live Oak (<i>Quercus virginiana</i>)	4	Remove	In Building Pad	
60	Live Oak (<i>Quercus virginiana</i>)	11	Remove	In Drive	
61	Slash Pine (<i>Pinus elliotti</i>)	9 & 12	Remove	Double Trunk; In Building Pad	
62	Live Oak (<i>Quercus virginiana</i>)	7	Remove	In Building Pad	
63	Live Oak (<i>Quercus virginiana</i>)	21	Remove		
64	Live Oak (<i>Quercus virginiana</i>)	12	Remove	In Building Pad	
65	Slash Pine (<i>Pinus elliotti</i>)	10	Remove		
66	Live Oak (<i>Quercus virginiana</i>)	11	Remove	In Building Pad	
67	Slash Pine (<i>Pinus elliotti</i>)	5	Remove	Conflicts with drainage pipe	
68	Slash Pine (<i>Pinus elliotti</i>)	8	Remove	Conflicts with drainage pipe	
69	Slash Pine (<i>Pinus elliotti</i>)	12	Remove		
70	Live Oak (<i>Quercus virginiana</i>)	30	Remove	Mitigate @ 25%	7.5
71	Slash Pine (<i>Pinus elliotti</i>)	13	Remove		
72	Live Oak (<i>Quercus virginiana</i>)	17	Remove		
73	Slash Pine (<i>Pinus elliotti</i>)	14	Preserve		
74	Slash Pine (<i>Pinus elliotti</i>)	12	Preserve		
75	Slash Pine (<i>Pinus elliotti</i>)	14	Preserve		
76	Slash Pine (<i>Pinus elliotti</i>)	15	Preserve		
77	Slash Pine (<i>Pinus elliotti</i>)	15	Preserve		
78	Slash Pine (<i>Pinus elliotti</i>)	20	Preserve		
79	Slash Pine (<i>Pinus elliotti</i>)	14	Preserve		
80	Live Oak (<i>Quercus virginiana</i>)	14	Remove		
81	Live Oak (<i>Quercus virginiana</i>)	15	Remove		
82	Live Oak (<i>Quercus virginiana</i>)	23	Remove		
83	Live Oak (<i>Quercus virginiana</i>)	16	Remove		
84	Live Oak (<i>Quercus virginiana</i>)	17	Remove		
85	Live Oak (<i>Quercus virginiana</i>)	13	Remove	Double Trunk	
86	Live Oak (<i>Quercus virginiana</i>)	19	Remove		
87	Slash Pine (<i>Pinus elliotti</i>)	23	Remove	Protected Canopy	
88	Slash Pine (<i>Pinus elliotti</i>)	20	Remove	In Building Pad	
89	Slash Pine (<i>Pinus elliotti</i>)	22	Remove		
90	Sabal Palm (<i>Sabal palmetto</i>)	15	Remove	Affected by New Sidewalk	
91	Sabal Palm (<i>Sabal palmetto</i>)	14	Remove	Affected by New Sidewalk	
92	Unknown Species	?	Remove		
93	Live Oak (<i>Quercus virginiana</i>)	6	Remove	Affected by New Sidewalk	
94	Slash Pine (<i>Pinus elliotti</i>)	10	Remove		
95	Slash Pine (<i>Pinus elliotti</i>)	16	Remove		
96	Sabal Palm (<i>Sabal palmetto</i>)	16	Remove		
97	Slash Pine (<i>Pinus elliotti</i>)	16	Remove	Affected by New Sidewalk	
98	Sabal Palm (<i>Sabal palmetto</i>)	16	Remove		
99	Sabal Palm (<i>Sabal palmetto</i>)	12	Remove		
100	Slash Pine (<i>Pinus elliotti</i>)	18	Remove		
101	Live Oak (<i>Quercus virginiana</i>)	4	Remove	In Building Pad	
102	Sabal Palm (<i>Sabal palmetto</i>)	15	Remove	In Parking lot	
103	Sabal Palm (<i>Sabal palmetto</i>)	18	Remove	In Parking lot	
104	Slash Pine (<i>Pinus elliotti</i>)	14	Remove	In Parking lot	
105	Sabal Palm (<i>Sabal palmetto</i>)	14	Remove	In Parking lot	
106	Slash Pine (<i>Pinus elliotti</i>)	18	Remove		
107	Sabal Palm (<i>Sabal palmetto</i>)	14	Remove	Affected by New Sidewalk	
108	Slash Pine (<i>Pinus elliotti</i>)	16	Preserve		
109	Sabal Palm (<i>Sabal palmetto</i>)	18	Remove		
110	Slash Pine (<i>Pinus elliotti</i>)	25	Preserve		
111	Slash Pine (<i>Pinus elliotti</i>)	22	Remove	In Parking lot	
Total Mitigation Inches Required:				14.0	

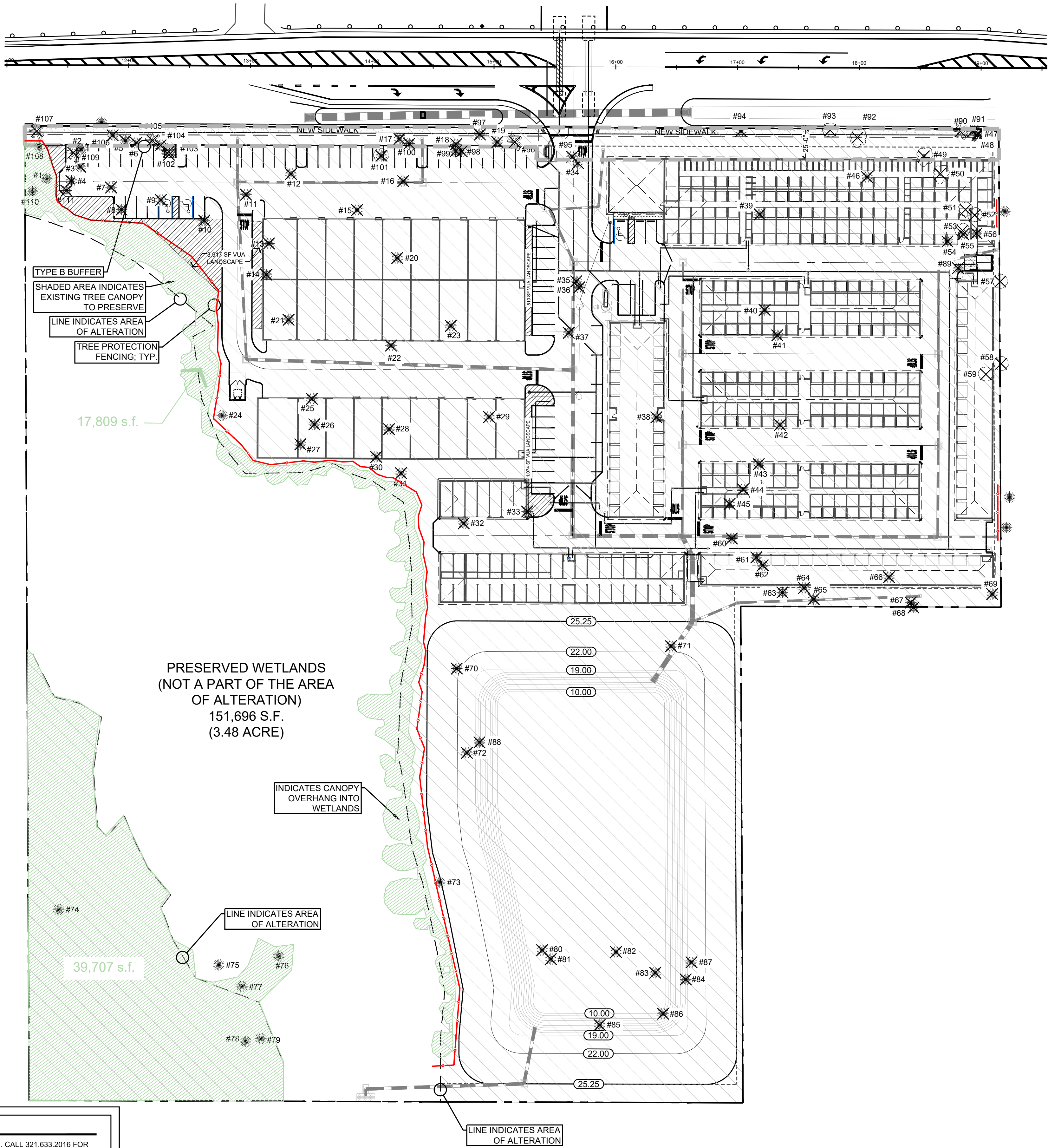

NOTE:

PROTECT EXISTING TREES. CALL 321.633.2016 FOR TREE ROOT PROTECTION INSPECTION PRIOR TO ANY LAND CLEARING, ALTERATION, OR COMMENCEMENT OF CONSTRUCTION INCLUDING GRADING AND FILLING. FAILURE TO SCHEDULE AN INSPECTION OR PROVIDE MAY BE SUBJECT TO STOP WORK ORDER AND OTHER PENALTIES AND REMEDIES PURSUANT TO SECTION 62-4336. SEE TYPICAL DETAIL (SHEET L-6).

REMOVAL NOTES:

- AUSTRALIAN PINES, BRAZILIAN PEPPERS AND ALL OTHER INVASIVES SHALL BE REMOVED, INCLUDING ROOTBALL FROM BARNES SELF-STORAGE SITE.
- SEE TREE PROTECTION DETAIL SHEET L-6; SILT FENCES SHALL BE KEPT IN-PLACE AT ALL TIMES THROUGHOUT CONSTRUCTION.

ABBREVIATIONS

CAL - CALIPER
CONC. - CONCRETE
C.T. - CLEAR TRUNK
CY - CUBIC YARD
EA - EACH
EX - EXISTING
FFE - FINISHED FLOOR ELEVATION
FG - FIELD GROWN
FM - FORCE MAIN
FTB - FULL TO BASE
G - GALLON
GAL - GALLON
GW - GREY WOOD
HT - HEIGHT
LF - LINEAR FOOT
MT - MULTI TRUNK
OC - ON CENTER
OA - OVERALL HEIGHT
PLTG. - PLANTING
SF - SQUARE FEET
SPD - SPREAD
TOB - TOP OF BANK
TYP. - TYPICAL

EXISTING TREE LEGEND

EXISTING OAK TO REMAIN
EXISTING OAK TO BE REMOVED
EXISTING PINE TREE TO REMAIN
EXISTING PINE TREE TO BE REMOVED
EXISTING PALM TO REMAIN
EXISTING PALM TO BE REMOVED
EXISTING UNKNOWN TREE TO REMAIN
EXISTING UNKNOWN TREE TO BE REMOVED
PRESERVED CANOPY
AREAS OF VEGETATION PRESERVED IN A NATURAL STATE
TREE PROTECTION FENCING

0' 25' 50' 100' 150'
SCALE: 1" = 50'-0"



KNOW WHAT'S BELOW
ALWAYS CALL 811
BEFORE YOU DIG
It's fast, it's free, it's the law.
Call 811 two business days
before digging

Susan Hall, ASLA
LANDSCAPE ARCHITECTURE
LC26000357
244 McLEOD STREET
MERRITT ISLAND, FL 32953
PHONE: (321) 449-0790
FAX: (321) 449-1225
www.hall-la.com

BARNES SELF-STORAGE
Barnes Boulevard & Playa Del Sol Drive
BREVARD COUNTY, FL

EXISTING
VEGETATION
PLAN, LIST &
DETAILS

DATE
11.13.24

DESIGN
S.H.

DRAWN
D.F.

SCALE
1" = 50'-0"

REVISIONS
11.13.24: COUNTY COMMENTS ADDED
ADDTL NOTE ON L-8 ADDED
TREE PROTECTION FENCING
LAYOUTS ON PLAN.



11-13-24

L-2 6
SHEET OF

NOTES TO CONTRACTOR:

1. ALL MATERIAL CALCULATIONS ARE BASED ON MEASUREMENTS FROM AUTOCAD DRAWINGS AND DO NOT INCLUDE SHRINKAGE, CUTS & WASTE, ETC. CONTRACTOR IS RESPONSIBLE FOR MEASURING & VERIFYING QUANTITIES/CALCULATIONS FOR THE PROJECT.
2. ALL TREES WITHIN SODDED AREAS SHALL RECEIVE MULCH RINGS.
3. ALL BEDLINES SHALL BE INSTALLED SO THAT CATCH BASINS ARE LOCATED IN SODDED AREAS. ANY CATCH BASIN LOCATED WITHIN A PLANT BED SHALL HAVE 4-6"Ø COQUINA INSTALLED AROUND THE CATCH BASIN

KEY MAP

SCALE: NTS

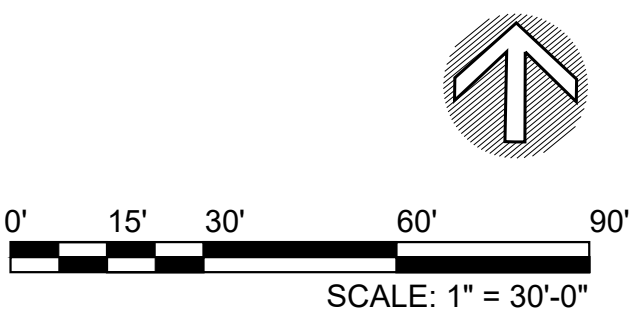
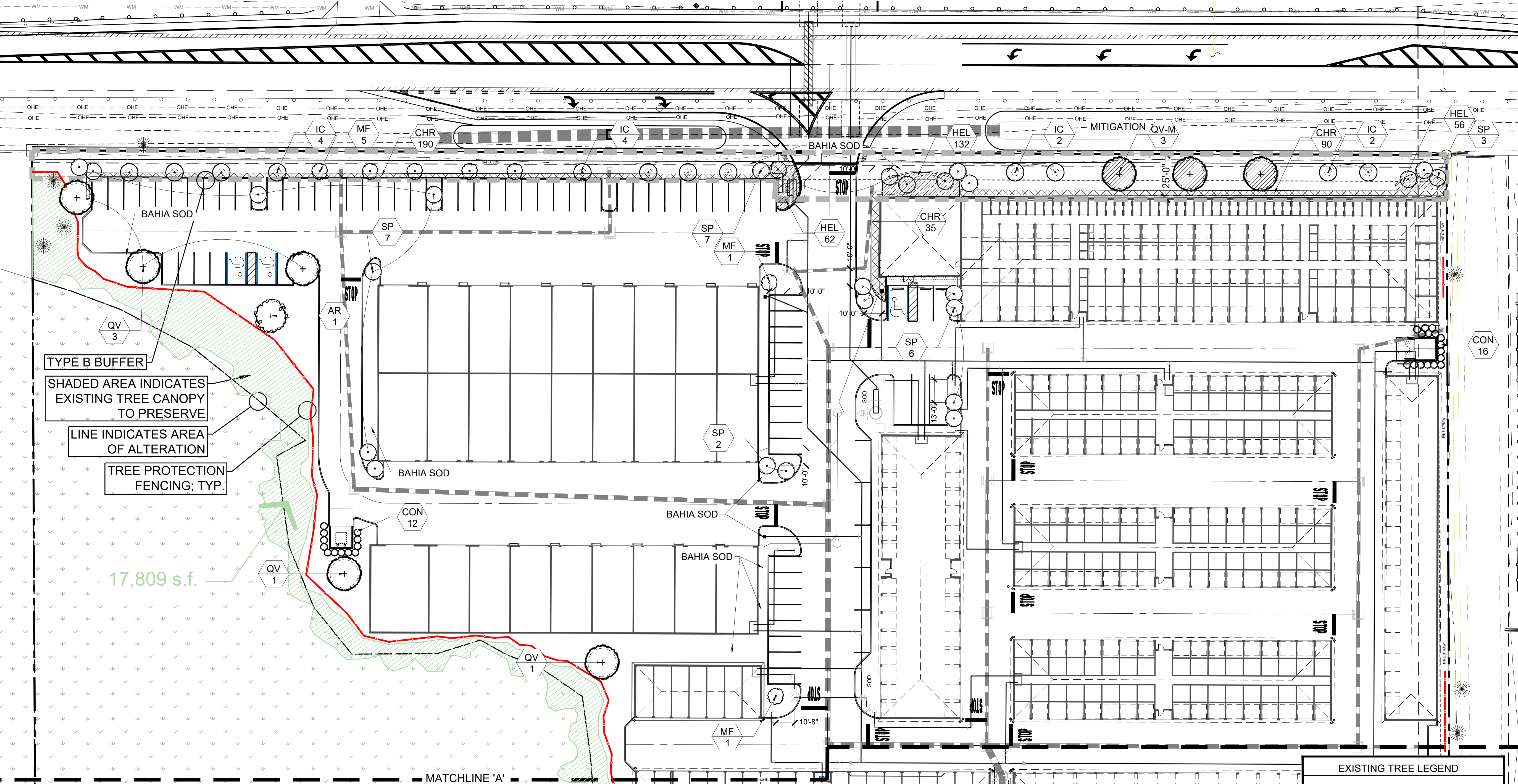

EXISTING TREE LEGEND

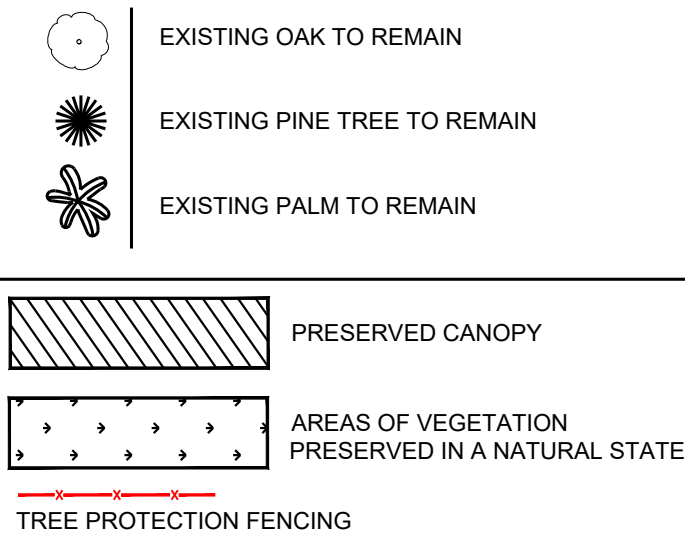

ABBREVIATIONS

CAL - CALIFER
CONC - CONCRETE
C.T. - CLEAR TRUNK
CY - CUBIC YARD
EA - EACH
EX - EXISTING
FFE - FINISHED FLOOR ELEVATION
FG - FIELD GROWN
FM - FORCE MAIN
FTB - FULL TO BASE
G - GALLON
GAL - GALLON
GW - GREY WOOD
HT - HEIGHT
LF - LINEAR FOOT
MT - MULTI TRUNK
OC - ON CENTER
OA - OVERALL HEIGHT
PLTG. - PLANTING
SF - SQUARE FEET
SPD - SPREAD
TOB - TOP OF BANK
TYP. - TYPICAL

Susan Hall, ASLA
LANDSCAPE ARCHITECTURE
LC26000357
244 McLEOD STREET
MERRITT ISLAND, FL 32953
PHONE: (321) 449-0790
FAX: (321) 449-1225
www.hall-la.com

BARNES SELF-STORAGE
Barnes Boulevard & Playa Del Sol Drive
BREVARD COUNTY, FL

SHEET TITLE
NORTHERN
SITE
LANDSCAPE
PLAN

DATE
11.13.24

DESIGN
S.H.

DRAWN
D.F.

SCALE
1" = 30'-0"

REVISIONS
11.13.24: COUNTY COMMENTS ADDED
ADDTL NOTE ON L-8 ADDED
TREE PROTECTION FENCING
LAYOUTS ON PLAN.

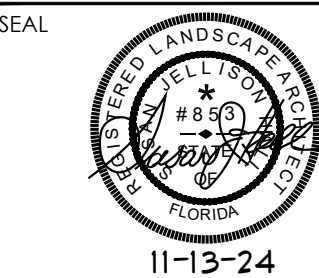

11-13-24

L-3
SHEET

6
OF

Susan Hall, ASLA
LANDSCAPE ARCHITECTURE
LC26000357
244 McLEOD STREET
MERRITT ISLAND, FL 32953
PHONE: (321) 449-0790
FAX: (321) 449-1225
www.hall-la.com

BARNES SELF-STORAGE
Barnes Boulevard & Playa Del Sol Drive
BREVARD COUNTY, FL

SHEET TITLE
**SOUTHERN
SITE
LANDSCAPE
PLAN**

DATE
11.13.24

DESIGN
S.H.

DRAWN
D.F.

SCALE
1"= 30'-0"

REVISIONS
11.13.24: COUNTY COMMENTS ADDED
ADDTL NOTE ON L-1 & ADDED
TREE PROTECTION FENCING
LAYOUTS ON PLAN.

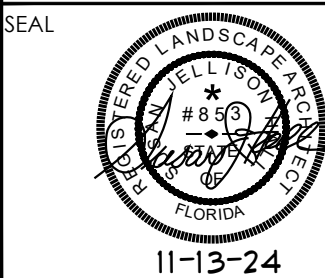

L-4
SHEET

6
OF

KEY MAP

SCALE: NTS

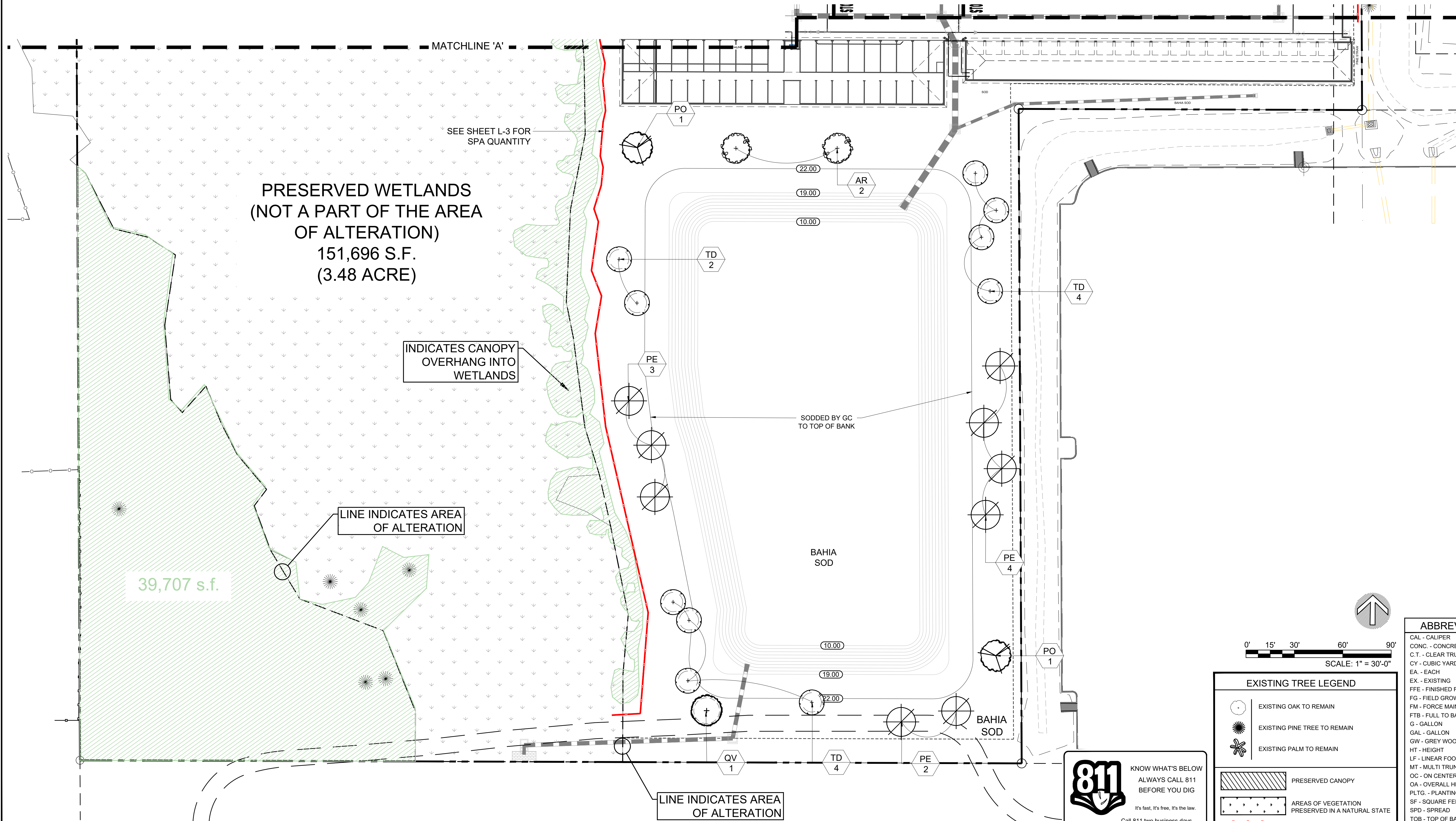
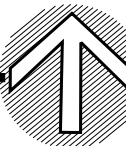

0' 15' 30' 60' 90'
SCALE: 1"= 30'-0"

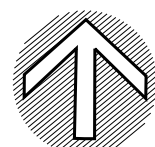

EXISTING TREE LEGEND

- EXISTING OAK TO REMAIN
- EXISTING PINE TREE TO REMAIN
- EXISTING PALM TO REMAIN

PRESERVED CANOPY

AREAS OF VEGETATION
PRESERVED IN A NATURAL STATE

TREE PROTECTION FENCING

ABBREVIATIONS

- CAL - CALIPER
- CONC - CONCRETE
- C.T. - CLEAR TRUNK
- CY - CUBIC YARD
- EA - EACH
- EX - EXISTING
- FFE - FINISHED FLOOR ELEVATION
- FG - FIELD GROWN
- FM - FORCE MAIN
- FTB - FULL TO BASE
- G - GALLON
- GAL - GALLON
- GW - GREY WOOD
- HT - HEIGHT
- LF - LINEAR FOOT
- MT - MULTI TRUNK
- OC - ON CENTER
- OA - OVERALL HEIGHT
- PLTG - PLANTING
- SF - SQUARE FEET
- SPD - SPREAD
- TOB - TOP OF BANK
- TYP - TYPICAL



KNOW WHAT'S BELOW
ALWAYS CALL 811
BEFORE YOU DIG
It's fast, it's free, it's the law.
Call 811 two business days
before digging

LANDSCAPE CALCULATIONS BARNES STORAGE FACILITY
BARNES BOULEVARD, BREVARD COUNTY, FLORIDA

LOT AREA: 12.7 ACRES [553,212 SF]
AREA OF ALTERATION: **9.2 ACRES = 401,187.6 SF**

CANOPY PRESERVATION REQUIREMENTS:

PRESERVED CANOPY SHALL BE 10% OF THE AREA OF ALTERATIONS, OR, IF EXISTING CANOPY IS LESS THAN THE LISTED MINIMUM CANOPY PRESERVATION REQUIRMENTS, THE EXISTING CANOPY PERCENTAGE SHALL BE USED IN LIEU OF THE MINIMUM CANOPY PRESERVATION REQUIREMENT PER SEC.62-4339 (2)(J) OF THE CODE.

AREA OF ALTERATION [401,187.6] X 10% REQUIRED PRESERVATION = **40,118.76 SF;**

TOTAL PRESERVATION PROVIDED: 57,516 SF = 14.3%

LANDSCAPE CANOPY CREDITS PROVIDED: **22,941 CREDITS** [REFER TO PLANT LIST THIS SHEET]
22,868 CREDITS REQUIRED.

MITIGATION REQUIREMENTS: THERE ARE TWO SPECIMEN TREES LARGER THAN 24” DBH BEING REMOVED FROM THIS SITE. ALL ARE MITIGATED AT 25%; SEE SHADED TREES INDICATED ON THE LANDSCAPE PLAN.

TYPE 'B' BUFFER REQUIREMENTS:

BARNES BOULEVARD TYPE B BUFFER LENGTH: 800 LF MINUS 50' ACCESS DRIVE X 25 WIDTH, MINIMUM PRESERVATION OF OVERSTORY TREES & PINES, AND UNDERSTORY SHRUBS/GROUDCOVERS. REFER TO SITE PLAN.

- GROUP 1 PLANTS: 750/4=188 SHRUBS REQUIRED AT MINIMUM OF 3' HT; 190 COCOPLUM PROVIDED
GROUP 2 PLANTS: 750/25 = 30 TREES REQUIRED AT 8' HT; 32 PROVIDED
GROUP 3 PLANTS: 750/ = 250 GROUNDCOVERS REQUIRED AT MINIMUM OF 12” HT; 250 DUNE SUNFLOWERS PROVIDED.

ALL OTHER PROPERTY LINES ABUT COMMERCIAL SITES OR WETLANDS.

VUA AND PARKING LOT REQUIREMENTS:

207,008 SF DRIVES / 400 X 10 = 5,175.2 S.F. OF VUA LANDSCAPE REQUIRED. 5,501 S.F. OF VUA LANDSCAPE PROVIDED - REFER TO SHEET L-2 FOR VUA LANDSCAPE PROVIDED.

TREE & SHRUB REQUIREMENTS:

5 TREES/ACRE. 5 X 7.98 ACRES AREA OF ALTERATION = 39.90=40 TREES REQUIRED; 117 TREES PROVIDED.
125 SHRUBS/AREA OF ALTERATION. 125 X 7.98 ACRE = 997.5 = 1,502 SHRUBS REQUIRED, 3G OR LARGER.
PROVIDED THROUGH PRESERVED VEGETATION: 57,516 SF / 16 SF = [1] 3g SHRUB CREDIT; 3,595 SHRUB CREDITS PROVIDED.

ADDITIONAL REQUIREMENTS:

- 1) ALL PLANTING SHALL BE FLORIDA #1 GRADE OR BETTER, AS DEFINED BY THE GARDES & STANDARDS FOR NURSERY PLANTS, 1998.
- 2) AT LEAST 70% OF REQUIRED TREES SHALL BE OF NATIVE SPECIES & AT LEAST 50% OF REQUIRED SHRUBS AND GROUNDCOVERS SHALL BE OF NATIVE SPECIES OR RECOMMENDED BY “WATERWISE FLORIDA LANDSCAPES'. SEE PLANTLIST ABOVE FOR COMPLIANCE.
- 3) 13 PALMS MAY BE USED TO SATISFY UP TO 25% OF REQUIRED LANDSCAPING.
- 4) ALL NON-NATIVE INVASIVE PLANTS, AS DEFINED IN THIS DIVISION, SHALL BE REMOVED.

Barnes Self-Storage Plant List

PLANT MATERIAL							NATIVE	WATER WISE	CANOPY CREDITS PER TREE	TOTAL CANOPY CREDITS	MITIGATION (INCHES)
TREES & PALMS											
QTY	SYMBOL	BOTANICAL NAME	COMMON NAME	INSTALLED SIZE	SPECIFICATIONS	SPACING					
3	AR	<i>Acer rubrum 'Florida Flame'</i>	Red Maple 'Florida Flame'	Container	12' ht. x 5' spd. x 2.5" cal.	As Shown	✓	✓	123	369	
12	IC	<i>Ilex cassine</i>	Dahoon Holly	FG	10' ht. x 3' spd. x 2.0" cal.	As Shown	✓	✓	64	768	
7	MF	<i>Myrcianthes fragrans</i>	Simpson's Stopper	FG	8' ht. x 2' spd. x 1" cal.	As Shown	✓	✓	64	448	
9	PE	<i>Pinus elliottii 'Densa'</i>	Slash Pine 'Densa'	FG	12' ht. x 5' spd. x 2.5" cal.	As Shown	✓	✓	363	3267	
6	QV	<i>Quercus virginiana</i>	Live Oak	FG	12' ht. x 5' spd. x 2.5" cal.	As Shown	✓	✓	1590	9540	
3	QV-M	<i>Quercus virginiana</i>	Live Oak	FG	MITIGATION: 16' ht. x 5' spd. x 4" cal.	As Shown	✓	✓	1590	4770	14.5
2	PO	<i>Platanus occidentalis</i>	Sycamore	FG	12' ht. x 5' spd. x 2.5" cal.	As Shown	✓	✓	707	1414	
25	SP	<i>Sabal palmetto</i>	Sabal Palm	FG	10-18' Clear Trunk; Varied Height; Slick Trunks	As Shown	✓	✓	33	825	
10	TD	<i>Taxodium distichum</i>	Bald Cypress	FG	12' ht. x 5' spd. x 2.5" cal.	As Shown	✓	✓	154	1540	
TOTAL CANOPY CREDITS PROVIDED:									22941		
MITIGATION INCHES PROVIDED:									14.5		
SHRUBS & GROUNDCOVERS											
QTY	SYMBOL	BOTANICAL NAME	COMMON NAME	INSTALLED SIZE	SPECIFICATIONS	SPACING	NATIVE	WATER WISE			
315	CHR	<i>Chrysobalanus icaco 'Red Tip'</i>	Red Tip Cocoplum	3G	20" x 18"	36" OC			✓	✓	
28	CON	<i>Conocarpus erectus 'Sericeus'</i>	Silver Buttonwood	3G	20" x 18"	36" OC	✓	✓			
250	HEL	<i>Helianthus debilis</i>	Dune Sunflower	1G	12" x 12"	24" OC	✓	✓			
MISCELLANEOUS LANDSCAPE ITEMS											
122618	SF	Site Preparation- The General Contractor shall provide the rough grade; the Landscape Contractor shall provide the fine grading as specified in the plans.									
77	CY	Sand-grown Argentine Bahia Sod: An additional 10% has been added for shrinkage, cuts and wastes; Landscape Contractor to field verify amount needed									
28217	SF	Planting Mix- 33% Clean Sharp Sand, 33% Florida Peat, 33% Well-rotted Wood Chips/Compost									
		Pine Straw Mulch									
		Drip Irrigation System until plants established - 2 Years Minimum / Water Source: 2" Well									
Bracing, Guying, Staking & Fertilizing is to be included in the unit price for installed plant material; This estimate reflects current market pricing as of the date listed and is subject to change.											
All material calculations are based on measurements from AutoCAD drawings and do not include shrinkage, cuts & waste, etc. Contractor is responsible for measuring & verifying quantities/calculations for the project.											

GENERAL NOTES:

- GRAPHIC SYMBOLS TAKE PRECEDENCE OVER WRITTEN QUANTITIES AND KEYS ON PLAN.
- CONTRACTOR TO PROVIDE SITE IRRIGATION FOR ALL NEW LANDSCAPE AREAS. LAWN AREAS SHALL BE KEPT ON SEPARATE ZONES FROM SHRUB BEDS. DO NOT SPRAY ONTO BUILDING. IRRIGATION SYSTEM TO BE DESIGNED AND INSTALLED PER ALL LOCAL, STATE AND FEDERAL CODES.
- ALL MATERIAL CALCULATIONS ARE BASED ON MEASUREMENTS FROM AUTOCAD DRAWINGS AND DO NOT INCLUDE SHRINKAGE, CUTS & WASTE, ETC. CONTRACTOR IS RESPONSIBLE FOR MEASURING & VERIFYING QUANTITIES/CALCULATIONS FOR THE PROJECT.
- ALL TREES WITHIN SODDED AREAS SHALL RECEIVE MULCH RINGS.

BREVARD COUNTY NATURAL RESOURCES MANAGEMENT (NRM) STANDARD NOTES

- THIS SITE PLAN/SUBDIVISION PLAN WILL COMPLY WITH SEC. 62-4333 OF THE BREVARD COUNTY LANDSCAPING, LAND CLEARING, AND TREE PROTECTION ORDINANCE REGARDING THE REMOVAL AND CONTROL IN PERPETUITY OF ALL NON-NATIVE INVASIVE PLANT SPECIES.
- THIS SITE PLAN/SUBDIVISION PLAN WILL COMPLY WITH SEC. 62-4341 (14) OF THE BREVARD COUNTY LANDSCAPING, LAND CLEARING, AND TREE PROTECTION ORDINANCE REGARDING SITE AND SOIL PREPARATION AND WILL COMPLY WITH SEC. 62-4342 REGARDING MAINTENANCE IN PERPETUITY FOR ALL REQUIRED PLANTED AND PRESERVED LANDSCAPE MATERIALS.
- THE METHOD OF IRRIGATION FOR PLANTS ON THIS SITE WILL BE A WELL.
- PER SEC. 62-4339 (2)(E) OF THE BREVARD COUNTY LANDSCAPING, LAND CLEARING, AND TREE PROTECTION ORDINANCE, CANOPY PRESERVATION AREAS NEW SUBDIVISIONS, INDUSTRIAL, INSTITUTIONAL, PUBLIC, OR COMMERCIAL DEVELOPMENTS SHALL BE WITHIN SEPARATE TRACTS, DECLARATION OF COVENANTS, RECORDED PLAT CONDITION, OR WITH SUFFICIENT PROTECTIVE LANGUAGE, NOTED ON THE APPROVED LANDSCAPE PLAN, TO PROHIBIT ACTIVITIES THAT ARE DETRIMENTAL TO THE PERPETUAL PRESERVATION OF THE AREA.
- PER SEC. 62-4338 (4) OF THE BREVARD COUNTY LANDSCAPING, LAND CLEARING, AND TREE PROTECTION ORDINANCE, VEGETATIVE BUFFERS OR OTHER GROUND COVERS THAT RETARD EROSION MUST BE ESTABLISHED WITHIN SEVEN (7) DAYS AFTER FINAL GRADE HAS BEEN ESTABLISHED OR WITHIN FOURTEEN (14) DAYS AFTER LAST CONSTRUCTION ACTIVITY HAS OCCURRED.
- ANY STATE AND FEDERAL PERMITS THAT MAY BE REQUIRED AS A RESULT OF LAND CLEARING AND LANDSCAPING ACTIVITIES ARE THE RESPONSIBILITY OF THE OWNER OR DESIGNEE.
- ANY CHANGES TO THE APPROVED LANDSCAPE AND/OR CLEARING PLAN WILL BE CONFIRMED IN WRITING THROUGH THE BREVARD COUNTY NATURAL RESOURCES MANAGEMENT OFFICE PRIOR TO PLANTING. FAILURE TO OBTAIN WRITTEN APPROVAL TO THE APPROVED LANDSCAPE AND/OR CLEARING PLAN BY THE BREVARD COUNTY NATURAL RESOURCES MANAGEMENT OFFICE MAY DELAY THE ISSUANCE OF THE CERTIFICATE OF OCCUPANCY AND/OR CERTIFICATE OF COMPLETION.
- PER SEC. 62-4341 (3) OF THE BREVARD COUNTY LANDSCAPING, LAND CLEARING, AND TREE PROTECTION ORDINANCE, ALL PLANTINGS SHALL BE AT LEAST FLORIDA NO.1 GRADE AS DEFINED BY GRADES & STANDARDS FOR NURSERY PLANTS, 1998. DIVISION OF PLANT INDUSTRY, FLORIDA DEPARTMENT OF AGRICULTURE AND CONSUMER SERVICES, AS MAY BE AMENDED.
- PER SEC. 62-4339 (2)(C) OF THE BREVARD COUNTY LANDSCAPING, LAND CLEARING, AND TREE PROTECTION ORDINANCE, PRESERVED TREES SHALL HAVE PROTECTIVE BARRIERS DURING CONSTRUCTION WHICH ENCOMPASS THE ROOT PROTECTION ZONE...IT SHALL BE THE RESPONSIBILITY OF THE APPLICANT/OWNER TO SCHEDULE AN INSPECTION WITH NRMO OR PROVIDE A NOTARIZED STATEMENT FROM A RECOGNIZED KNOWLEDGEABLE PERSON, PROFESSIONAL LAND SURVEYOR REGISTERED IN THE STATE OF FLORIDA, PROFESSIONAL CIVIL ENGINEER, OR PROFESSIONAL ARCHITECT, REGISTERED IN THE STATE OF FLORIDA AND PROFICIENT IN SITE DESIGN THAT PROTECTIVE BARRIERS HAVE BEEN CORRECTLY INSTALLED. FAILURE TO SCHEDULE AN INSPECTION OR PROVIDE THE NOTARIZED STATEMENT PRIOR TO ANY LAND CLEARING, ALTERATION, OR COMMENCEMENT OF CONSTRUCTION INCLUDING GRADING AND FILLING, SHALL CONSTITUTE A VIOLATION...AND MAY BE SUBJECT TO STOP WORK ORDER AND OTHER PENALTIES AND REMEDIES PURSUANT TO SECTION 62-4336. THE ONLY ALLOWABLE ACTIVITIES PRIOR TO FILING THE NOTARIZED STATEMENT WITH NRMO SHALL BE THOSE ACTIVITIES NECESSARY FOR COMPLIANCE WITH STORMWATER POLLUTION PREVENTION PLANS (SWPPP) AND FLORIDA DEPARTMENT OF ENVIRONMENTAL PROTECTION (FDEP) NATIONAL POLLUTANT DISCHARGE ELIMINATION SYSTEM (NPDES).
- PER SECTION 62-4343, WHETHER PRESERVED OR PLANTED, LANDSCAPE MATERIAL MUST BE MAINTAINED THROUGH PROPER CARE OR REPLACEMENT IN PERPETUITY AFTER ISSUANCE OF CERTIFICATE OF COMPLETION/OCCUPANCY.

ADDITIONAL REQUIREMENTS:

- ALL PLANTINGS SHALL BE FLORIDA #1 GRADE OR BETTER, AS DEFINED BY THE GRADES AND STANDARDS FOR NURSERY PLANTS, LATEST EDITION.
- AT LEAST 70% OF REQUIRED TREES SHALL BE OF NATIVE SPECIES & AT LEAST 50% OF REQUIRED SHRUBS AND GROUNDCOVER SHALL BE OF NATIVE SPECIES OR RECOMMENDED BY "WATERWISE FLORIDA LANDSCAPES". SEE PLANT LIST FOR COMPLIANCE.
- AT LEAST 50% OF REQUIRED TREES SHALL BE LARGE CANOPY & AT LEAST 25% OF REQUIRED TREES SHALL BE MEDIUM CANOPY SPECIES.
- TWO PALMS SHALL BE COUNTED AS ONE TREE.
- THIS SITE SHALL BE IRRIGATED PROVIDING 100% COVERAGE, WITH AUTOMATIC CONTROLLER AND RAIN SENSOR.
- ACTUAL PLANTING LOCATIONS OF TREES AND SHRUBS MAY BE SLIGHTLY ADJUSTED AT TIME OF INSTALLATION TO AVOID INTERFERENCE OF MATURE GROWTH OF CANOPY AND ROOTS WITH CURBING, ABOVE GROUND AND UNDERGROUND UTILITIES, AND OTHER STRUCTURES.

REQUIREMENTS FOR PLANT MATERIAL USED TO MEET REQUIREMENTS

TREE TYPE	SIZE REQUIREMENT	ROOT ZONE REQ. (RPZ)
PALMS:	10' CT MIN	2 FEET
SMALL SPECIES TREES:	8' HT x 2' SPD x 1" CAL MIN	2' FEET
MEDIUM SPECIES TREES:	10' HT. x 3' SPD. x 1.5" CAL MIN	6' FEET
LARGE SPECIES TREES:	12' HT. x 5' SPD. x 2.5" CAL MIN	8' FEET



ABBREVIATIONS

CAL - CALIPER
CONC. - CONCRETE
C.T. - CLEAR TRUNK
CY - CUBIC YARD
EA - EACH
EX - EXISTING
FFE - FINISHED FLOOR ELEVATION
FG - FIELD GROWN
FM - FORCE MAIN
FTB - FULL TO BASE
G - GALLON
GAL - GALLON
GW - GREY WOOD
HT - HEIGHT
LF - LINEAR FOOT
MT - MULTI TRUNK
OC - ON CENTER
OA - OVERALL HEIGHT
PLTG. - PLANTING
SF - SQUARE FEET
SPD - SPREAD
TOB - TOP OF BANK
TYP. - TYPICAL

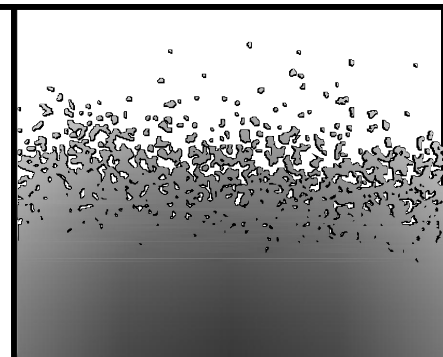

Susan Hall, ASLA
LANDSCAPE ARCHITECTURE
LC26000357
244 McLEOD STREET
MERRITT ISLAND, FL 32953
PHONE: (321) 449-0790
FAX: (321) 449-1225
www.hall-la.com

BARNES SELF-STORAGE
Barnes Boulevard & Playa Del Sol Drive
BREVARD COUNTY, FL

SHEET TITLE

LANDSCAPE
CALCULATIONS
& PLANT LIST

DATE

11.13.24

DESIGN

S.H.

DRAWN

D.F.

SCALE

NTS

REVISIONS

SEAL



11-13-24

L-5

6

SHEET

OF

LANDSCAPE SPECIFICATIONS:

- 1.00 GENERAL
- 1.01 The Contractor is reminded that the General Conditions and / or Special Conditions of this contract govern the work of this section of the Specifications whether attached hereto or not. Subcontractors undertaking to perform work under this Section shall be made fully aware of these documents and of their responsibilities and obligations thereunder. In the event of any discrepancies between the drawings and specifications and the following 'Scope of Work', the latter shall prevail.
- 2.00 SCOPE OF WORK
- 2.01 The work of this Section shall include all labor, materials, equipment, appliances, and accessories necessary for the complete performance of all excavation, grading, planting and backfill work in accordance with these Specifications and the Contract Drawing. Without restricting the generality of the foregoing, the items listed below and similar items shown on the Contract Drawings shall constitute the work of this Section:
- A. Finish grading and final site preparation of all areas to be landscaped.
- B. Furnishing and incorporating fertilizer and other soil amendments.
- C. Furnishing plant materials and grass materials and installing same.
- D. Furnishing and placing 'Planting Mixture' and other miscellaneous items to complete the work.
- E. Replacement of unsatisfactory plant material.
- F. Clean-up.
- 3.00 SITE PREPARATION
- 3.01 The Contractor shall provide finish grading and final preparation of all areas to be landscaped to within 2" of finish grade. This will require raking and pulverizing of all areas in order to crumble dirt, clogs and / or debris. The Landscape Contractor shall be responsible for finish grading, which is the top 2" of the site.
- 4.00 MATERIALS
- 4.01 Plant materials shall be furnished by the Landscape Contractor and as indicated on the plans. All plant materials shall meet or exceed the following standards.
- A. Plant species and sizes shall conform with plant list. Nomenclature shall conform to Standardized plant names, in accordance with the latest edition of the Florida Department of Agriculture's Grades and Standards for Nursery Plants.
- B. All plants shall be nursery grown or as stipulated herein and shall comply with all required inspections, grading standards and plant regulations as set forth in the Florida Department of Agriculture 'Grades and Standards for Nursery Plants', including revisions. Ensure that plant materials are shipped with tags stating the botanical and common name of the plant.
- C. The minimum grade for all trees, palms, shrubs, and groundcovers shall be Florida No. 1 and shall meet or exceed the size and quality standards of the American Association of Nursery Stock, sponsored by the American Association of Nurserymen, latest addition, unless otherwise indicated and all plants shall be sound, healthy and vigorous, well-branched and densely foliated when in leaf. They shall have healthy, well developed root systems and shall be free of disease and insect pests, eggs or larvae. Florida Fancy material shall be provided where plant list specifies 'specimen'.
- D. The determining measurements for trees shall be the height and spread, and shall be measured from the top of the plant to the root crown, not to include the immediate terminal growth. Their width shall be measured across the normal spread of the branches. Both measurements shall be made with the plants in their normal position.
- E. Plants larger in size than those specified may be used with approval of the Landscape Architect at no additional cost to the Owner. If the use of the larger plants is approved, the ball of earth or spread of roots shall be increased proportionately.
- F. Container grown plants the same quality as balled and burlapped plants may be substituted in lieu thereof. Plants grown in containers shall be delivered and remain in the containers in a shady location until planted. Plants in specifiers shall be watered prior to transportation and shall be kept moist until planted. The container must be removed prior to planting, with care as not to injure the roots.
- G. Grass materials shall consist of the following:
1. Sod: Solid sod shall be as indicated on the drawings. Sod must be strongly rooted and free of pernicious weeds. Mow to a height not to exceed 1 1/2" before lifting. Lifts shall have a uniform thickness of 1 inch to 1 1/2 inches. Sod containing nutgrass, lippia water sedge, dollar weed, or other common turfweed species (if applicable), will not be accepted.
2. Sodding installation:
- a) Sodding shall be done as soon as practical following finish grading. The day before sod installation, the contractor shall rake 50# Milorgonite per 1000 sf of area to receive sod. Ground shall be leveled with the back of a rake and sod laid with joints closely butted so that no voids are visible, keeping surface of sod flush with the adjoining seeded areas and or pavements. Lay sod to form a solid mass with tightly fitted joints. Butt ends and sides of sod strips; do not overlap. Hand tamp to ensure contact with subgrade, and water thoroughly with a fine spray immediately after laying.

- b) After sod is in place, it shall be top dressed with sufficient sharp, clean 60% sand/40% muck soil mix to fill all voids remaining and thoroughly watered to wash the top dressing into the sodded surface.
- c) All sod areas shall then be rolled using a vibrating #1500 sod roller if deemed necessary by the Landscape Architect, following installation.
- d) It is the Landscape Contractor's responsibility to keep new sod properly watered until completion of the contract. All watering shall meet specifications according to 'Grades and Standards' Section 983.
- H. Substitutions in plant species or size will be made only with prior written permission of the Landscape Architect.
- I. If, in the opinion of the Landscape Architect, materials and/or work do not conform with the plans and specifications, it may be rejected and upon rejection, must be removed immediately from the site by the Contractor and replaced.
- J. The Contractor shall be responsible for the certification and inspection of plant material that may be required by local, state, or federal authorities and shall bear the cost of the same, if any.
- 4.02 Materials used to install the job shall meet or exceed the following standards:
- A. Planting mix to be used for planting shall be: 1/3 coarse sand, 1/3 Florida peat, 1/3 well rotted pine chips or compost. 70% sand / 30% muck shall be used in planters or areas with poor drainage.
- B. Fertilizers: Fertilizer shall be delivered mixed as specified in standard bags, sealed, and showing weight by analysis and name of manufacturer. Fertilizer shall be stored in weatherproof storage and in such a manner that its effectiveness will not be impaired.
- C. Mulch: Mulch shall be 'Coco Brown' mulch from Florida Mulch or approved equal.
- D. Water: All water required for the execution of the work shall be supplied at the site by the Owner.
- 5.00 INSTALLATION
- 5.01 The Planting operations used to install the job shall meet or exceed the following standards:
- A. Excavation of Plant Pits: Plant pit excavations shall be roughly cylindrical in shape, with their side approximately vertical. Pit shall be excavated so that bottom of pit is same depth as root ball. Plants shall be centered in the hole, with the trunk location as shown in the plans. Holes for balled and burlapped plants shall be large enough to allow 12" minimum (depending on root ball size) of back fill around the sides of the root ball, and 12" of back fill beneath the root ball. In all cases the diameter of the plant hole shall be twice the diameter of the root ball. Where excess material has been excavated from the plant hole, the excavated material may be used to backfill to the proper level. Mix existing excavated material in 50% / 50% ratio with new planting soil mix. The Contractor, in excavation for plantings shall take care not to damage underground utilities or other sub-surface obstructions, and shall be held liable for their repair, if damaged.
- B. Setting Plants: All trees shall be set so, that when settled, the top of the root ball will be flush with the surrounding area of the finish grade or slightly above finish grade. Each plant shall be planted in planting soil mix in the center of the pit. Shrubs shall be set flush with the surrounding finish grade of the planting area. The back fill shall be made with prepared planting in mixture as specified herein and shall be firmly rodded and watered, so that no air-pockets remain. The quantity of water applied immediately upon planting shall be sufficient to thoroughly moisten all of the backfilled earth. Plants shall be kept in a moistened condition the duration of the planting.
- C. Staking and Guying: All trees shall be staked or guyed as shown in the details and according to the following specifications.
1. Use wide plastic, rubber or other flexible strapping materials to support the tree to stakes or ground anchors that will give as the tree moves in any direction up to 30 degrees. Use strapping material 'Arbor Tie' by Deep Root (800) 458-7668 dark green color, or approved equal. Do not use rope or wire through a hose. Use guy chords, hose or any other thin bracing or anchorage material which has a minimum 12" [300 mm] length of high visibility flagging tape secured to guys, midway between the tree and stakes for safety.
2. Stake trees larger than 1" [25 mm] diameter and smaller than 2" [50 mm] diameter with a 2" by 2" [50 by 50 mm] stake, set at least 2" [0/6 m] in ground and extending to the crown of the plant. Firmly fasten the plant to the stake with flexible strapping materials as noted above.
3. TREES OF 2 TO 3 1/2" [50 MM TO 90 MM] CALIPER: Stake all trees, other than palm trees, larger than 2" [50 mm] caliper and smaller than 3 1/2" [90 mm] caliper with two 2" by 4" [50 by 100 mm] stakes, 8' [2.4 m] long, set 2' [0.6 m] in the ground. Place the tree midway between the stakes and hold it firmly in place by flexible strapping materials as noted above.

4. LARGE TREES: Guy all trees, other than palm trees, larger than 3 1/2" [90 mm] caliper, from at least three points, with flexible strapping materials as noted above. Anchor flexible strapping to 2" by 4" by 24" [50 by 100 by 600 mm] stakes, driven into the ground such that the top of the stake is at least 3" [75 mm] below the finished ground.
5. SPECIAL REQUIREMENTS FOR PALM TREES: Brace palms which are to be staked with three 2" by 4" [50 by 100 mm] wood braces, toe-nailed to cleats which are securely banded at two points to the palm, at a point one third the height of the trunk. Pad the trunk with five layers of bubble wrap under the cleats. Place braces approximately 120 degrees apart and secure them underground by 2" by 4" by 12" [50 by 100 by 300 mm] stake pads. Paint wood flat dark green exterior paint, two coats.
6. TREE PROTECTION AND ROOT BARRIERS: Install tree barriers when called for in the Contract Documents or by the Landscape Architect to protect existing trees from damage during project construction. Place barricades at the drip line of the tree foliage or as far from the base of the tree trunk as possible. Barricades shall be able to withstand bumps by heavy equipment and trucks. Maintain barricades in good condition. When called for in the Contract Documents, install root barriers or fabrics in accordance with the details shown.
- D. Pruning: All broken or damaged roots or branches shall be cut smoothly and the tops of all trees shall be pruned in a manner complying with standard horticultural practice. At the time pruning is completed, all remaining wood shall be alive.
- E. Mulching: Within one week after planting, mulch material shall be uniformly applied to a minimum loose thickness of 2 inches, over the entire area of the backfilled hole or bed. The mulch shall be maintained continuously in place until the time of final inspection, and must be a minimum of 2 inches thick to be accepted. Mulch shall not be placed against stems or trunks.
- F. Fertilizing: Feeding of all trees and specimen shrubs shall be done with a slow release granular 12-6-8 with complete minors turf and ornamental fertilizer, as per manufacturer's instructions. Contractor shall submit and label to the Landscape Architect for approval prior to application.

- 6.00 MAINTENANCE
- 6.01 Maintenance and hand watering of all trees, shrubs and groundcover by the Landscape Contractor shall terminate upon final acceptance of such work, but shall not discharge the Landscape Contractor from his responsibility to honor the guarantee period. Maintenance prior to final acceptance shall include the removal of all dead or dying twigs and branches, the weeding, watering and normal pruning of plant material.
- 7.00 GUARANTEE
- 7.01 The Landscape Contractor shall guarantee and maintain all trees and palms for a period of one year. All shrubs, and groundcovers for a period of 180 days, and all sod for a period of 90 days. The Landscape Contractor shall replace at the direction of the Landscape Architect all trees, shrubs, or groundcovers deemed by the Landscape Architect to be unacceptable due to death or damage; Acts of God, Owner negligence, and Vandalism excepted.
1. Acts of God are natural hazards and events outside of human control that include but are not limited to: earthquakes, flash floods, fire caused by lightning, sustained winds in excess of 75mph, and freezing temperatures below 32 degrees for more than 4 hours.
- 7.02 The guarantee period shall begin upon final acceptance of the job and completion of final punch lists, as determined by the landscape architect.
- 7.03 New material used to replace material unacceptable to the Landscape Architect, shall be guaranteed for a similar period from date of installation.
- 7.04 New material used to replace material unacceptable to the Landscape Architect, shall be replaced with the grown-in size. Grown in size will be determined by the adjacent like plants in Florida #1 grade condition. This may require installing a larger container size than originally planted.
- 8.00 FINAL INSPECTION AND ACCEPTANCE
- 8.01 The Landscape Contractor shall advise the Landscape Architect in writing at the end of the guarantee period that the project is ready for final inspection. Only upon notification to the Landscape Architect by the Landscape Contractor in writing and subsequent inspection attended by the Landscape Contractor shall the requirements of the guarantee be met.
- 9.00 CLEAN-UP
- 9.01 Upon completion of all work under this section, the Landscape Contractor shall clear the site of all debris, superfluous material and all equipment to the satisfaction of the Landscape Architect
- 9.02 End

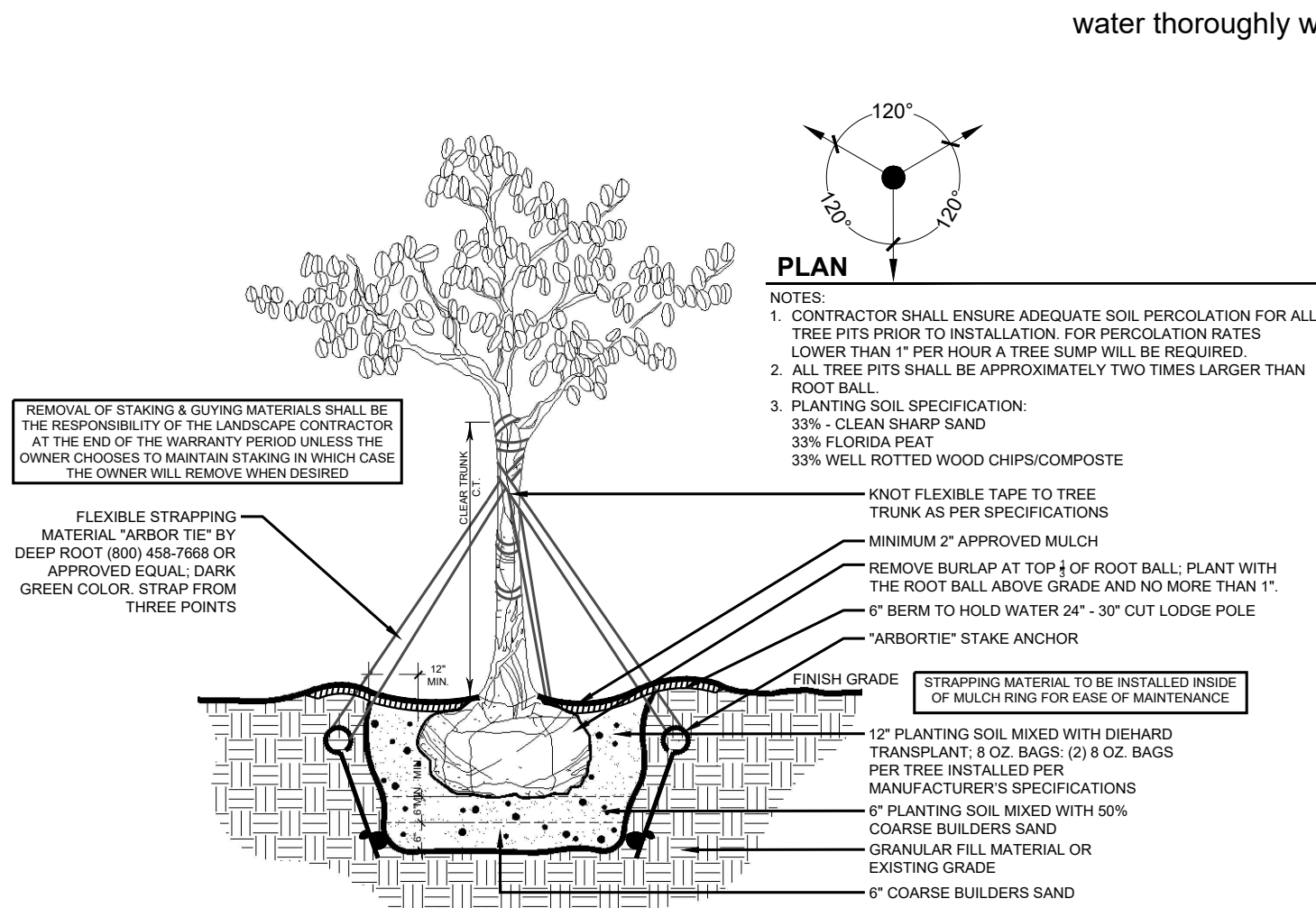

TREE PLANTING & GUYING DETAIL

N.T.S.

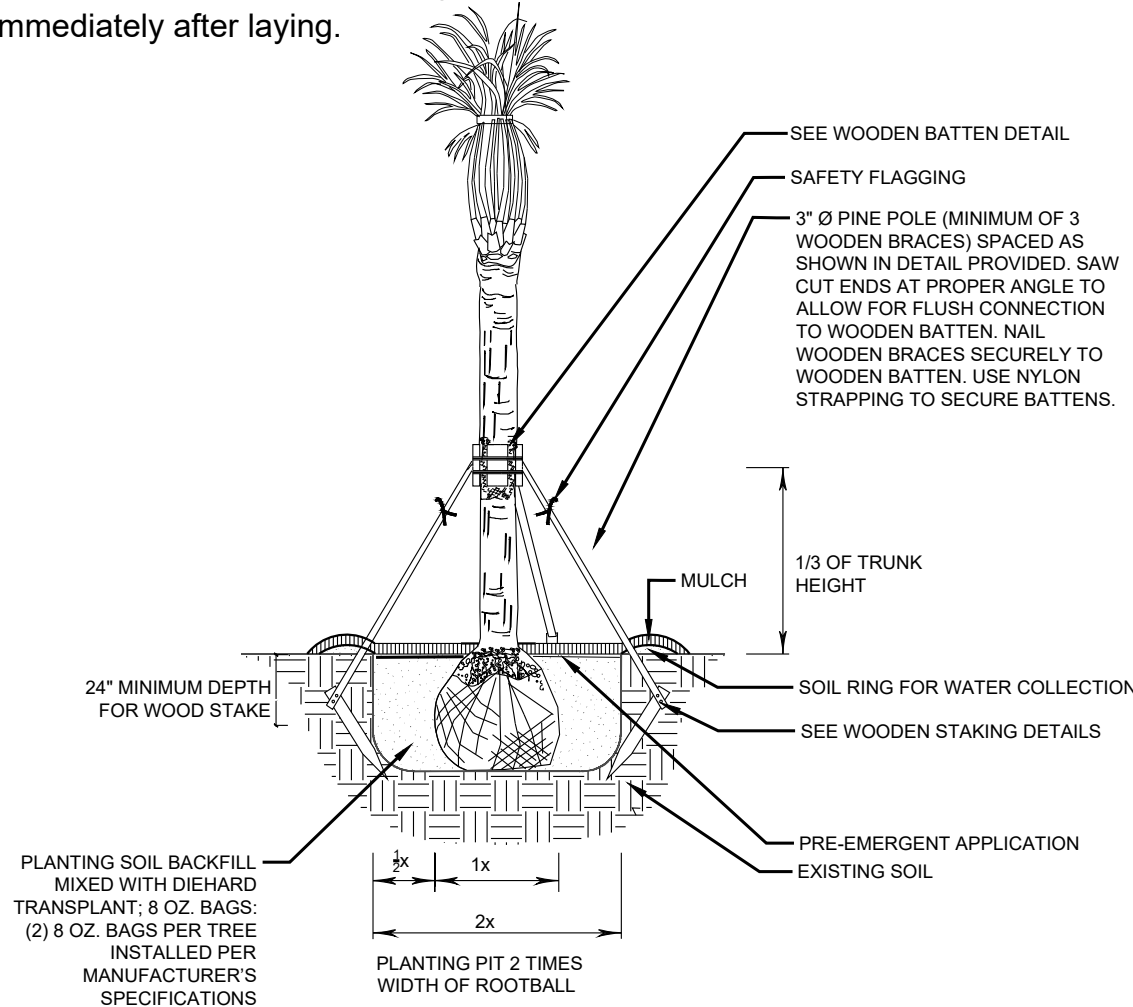

PALM PLANTING DETAIL

N.T.S.

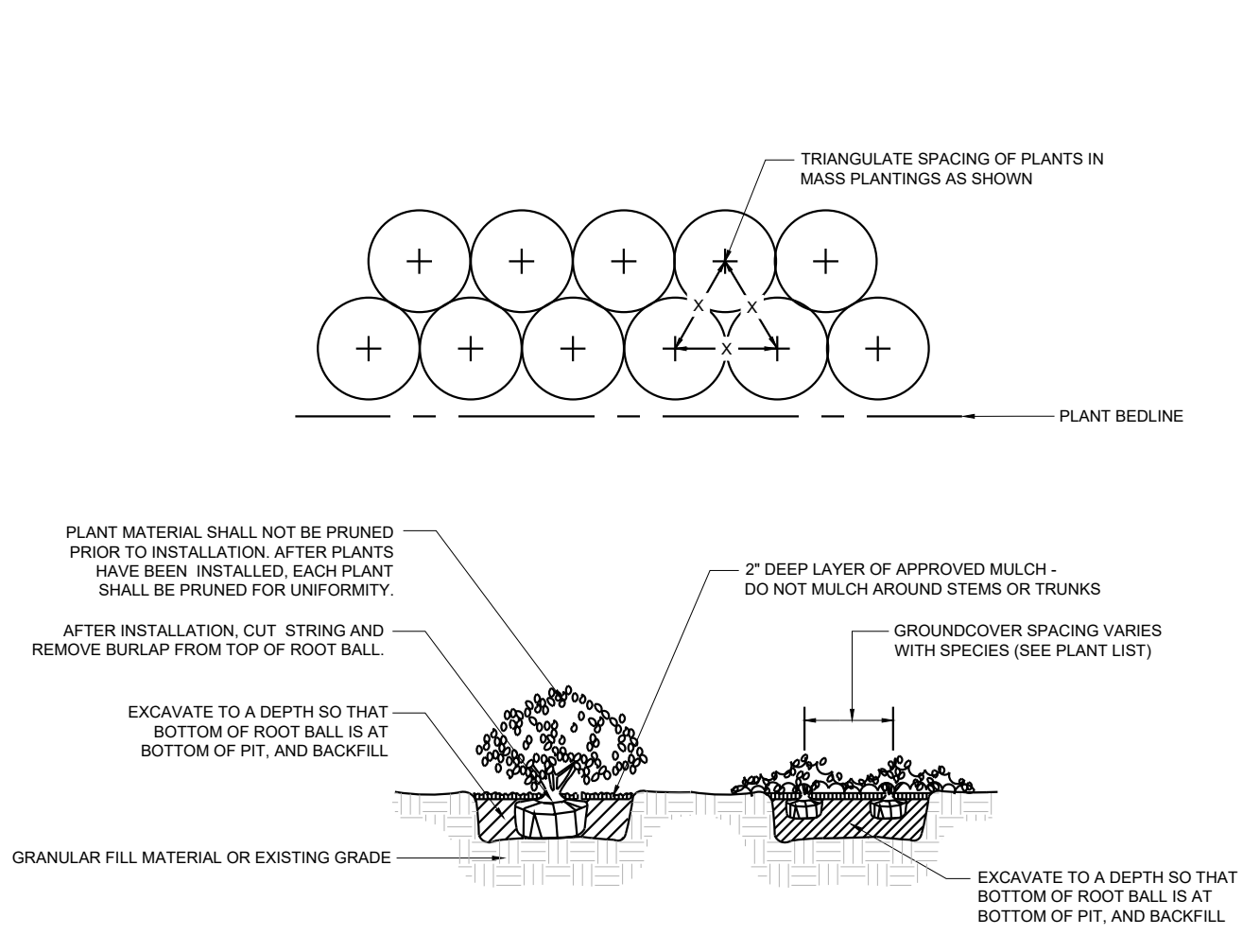

SHRUB & GROUNDCOVER PLANTING DETAIL

N.T.S.

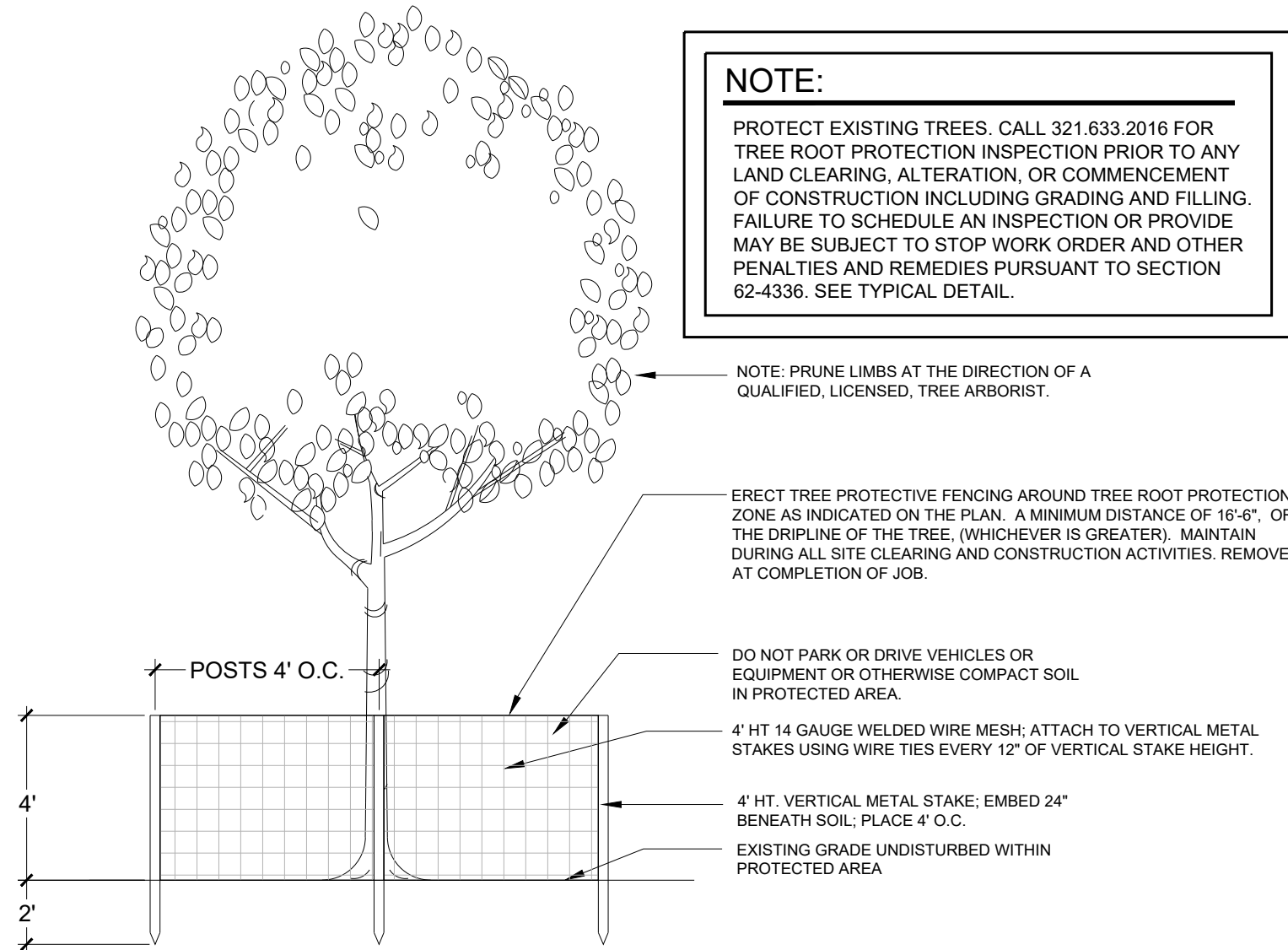

TREE PROTECTION DETAIL

SCALE: NOT TO SCALE

Susan Hall, ASLA
LANDSCAPE ARCHITECTURE
LC26000357
244 McLEOD STREET
MERRITT ISLAND, FL 32953
PHONE: (321) 449-0790
FAX: (321) 449-1225
www.hall-la.com

BARNES SELF-STORAGE

Barnes Boulevard & Playa Del Sol Drive

BREVARD COUNTY, FL

SHEET TITLE

LANDSCAPE
CALCULATIONS
& PLANT LIST

DATE

11.13.24

DESIGN

S.H.

DRAWN

D.F.

SCALE

NTS

REVISIONS

SEAL

11-13-24

L-6

6

SHEET OF