

# LOCATION MAP

RIVER FLY-IN CONDOMINIUM INC

22V00049

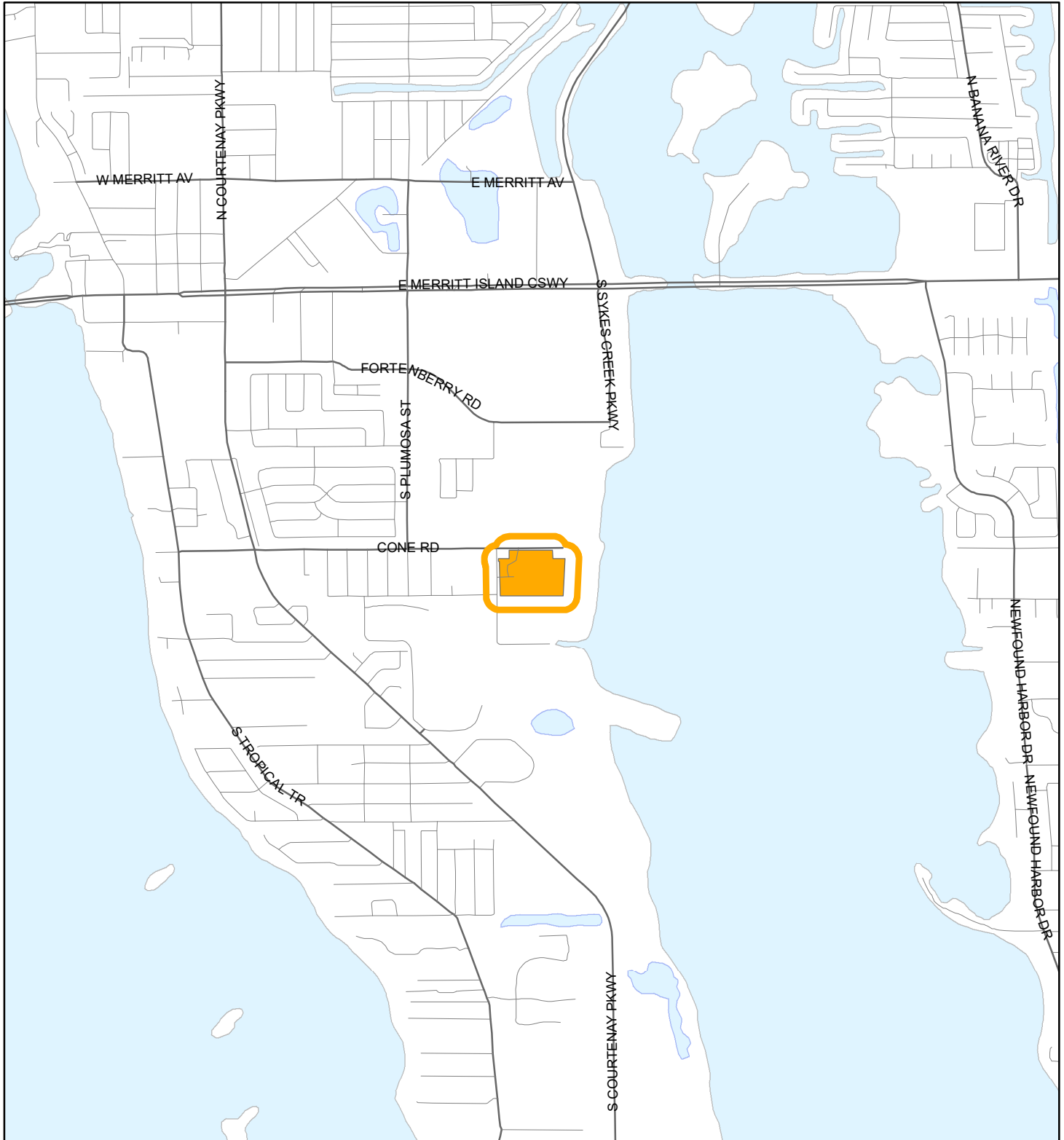

1:24,000 or 1 inch = 2,000 feet

Buffer Distance: 200 feet

This map was compiled from recorded documents and does not reflect an actual survey. The Brevard County Board of County Commissioners does not assume responsibility for errors or omissions hereon.

Produced by BoCC - GIS Date: 12/1/2022

Buffer

Subject Property

# ZONING MAP

RIVER FLY-IN CONDOMINIUM INC

22V00049

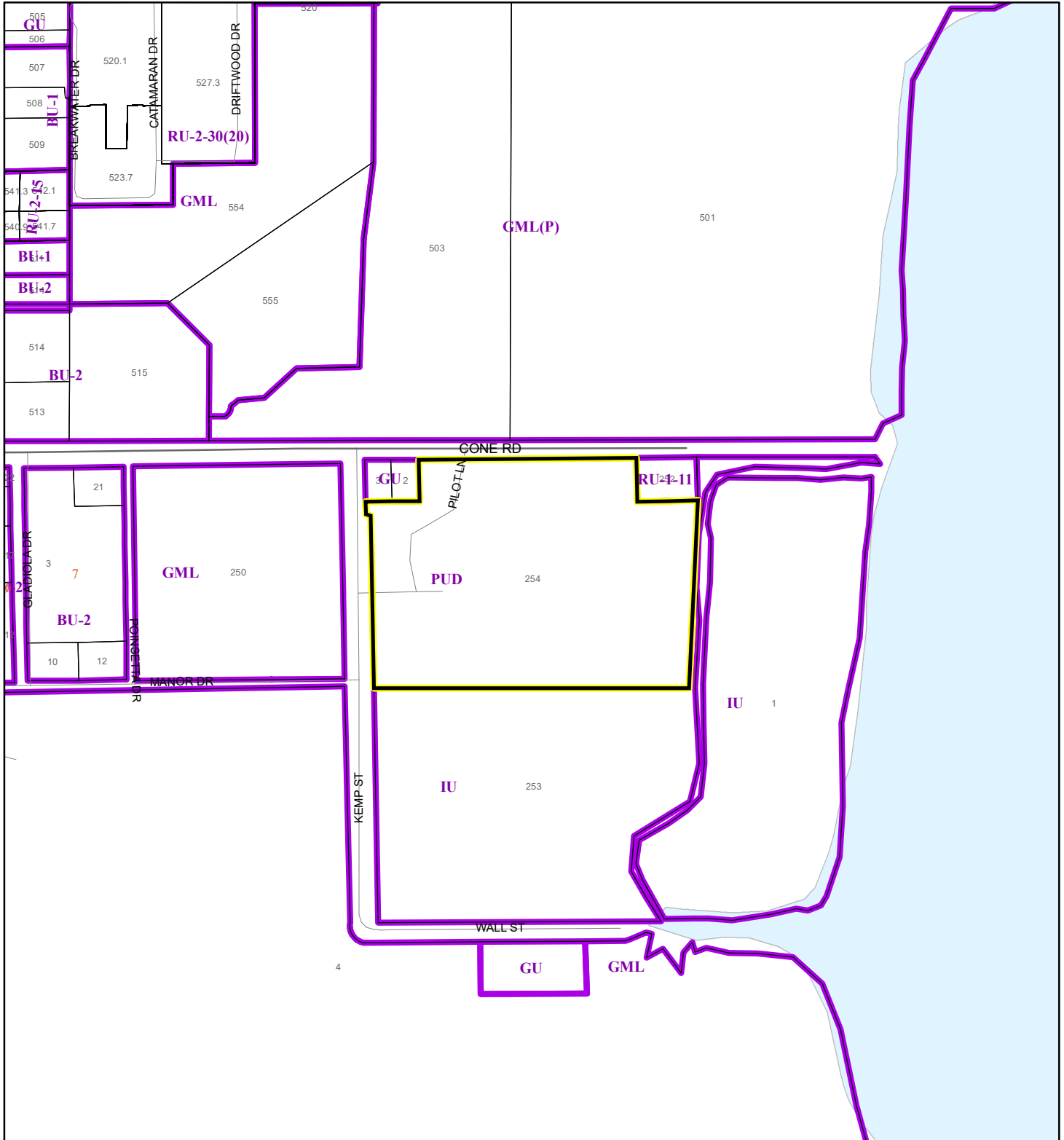

1:4,800 or 1 inch = 400 feet

This map was compiled from recorded documents and does not reflect an actual survey. The Brevard County Board of County Commissioners does not assume responsibility for errors or omissions hereon.

Produced by BoCC - GIS Date: 12/1/2022

 Subject Property

 Parcels

 Zoning



AERIAL MAP  
RIVER FLY-IN CONDOMINIUM INC  
22V00049

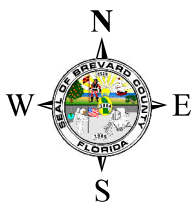



1:4,800 or 1 inch = 400 feet

PHOTO YEAR: 2022

This map was compiled from recorded documents and does not reflect an actual survey. The Brevard County Board of County Commissioners does not assume responsibility for errors or omissions hereon.

Produced by BoCC - GIS Date: 12/1/2022

 Subject Property  
 Parcels