

# LOCATION MAP

PATTERSON, GERALD L

24Z00022

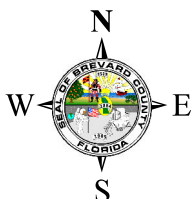

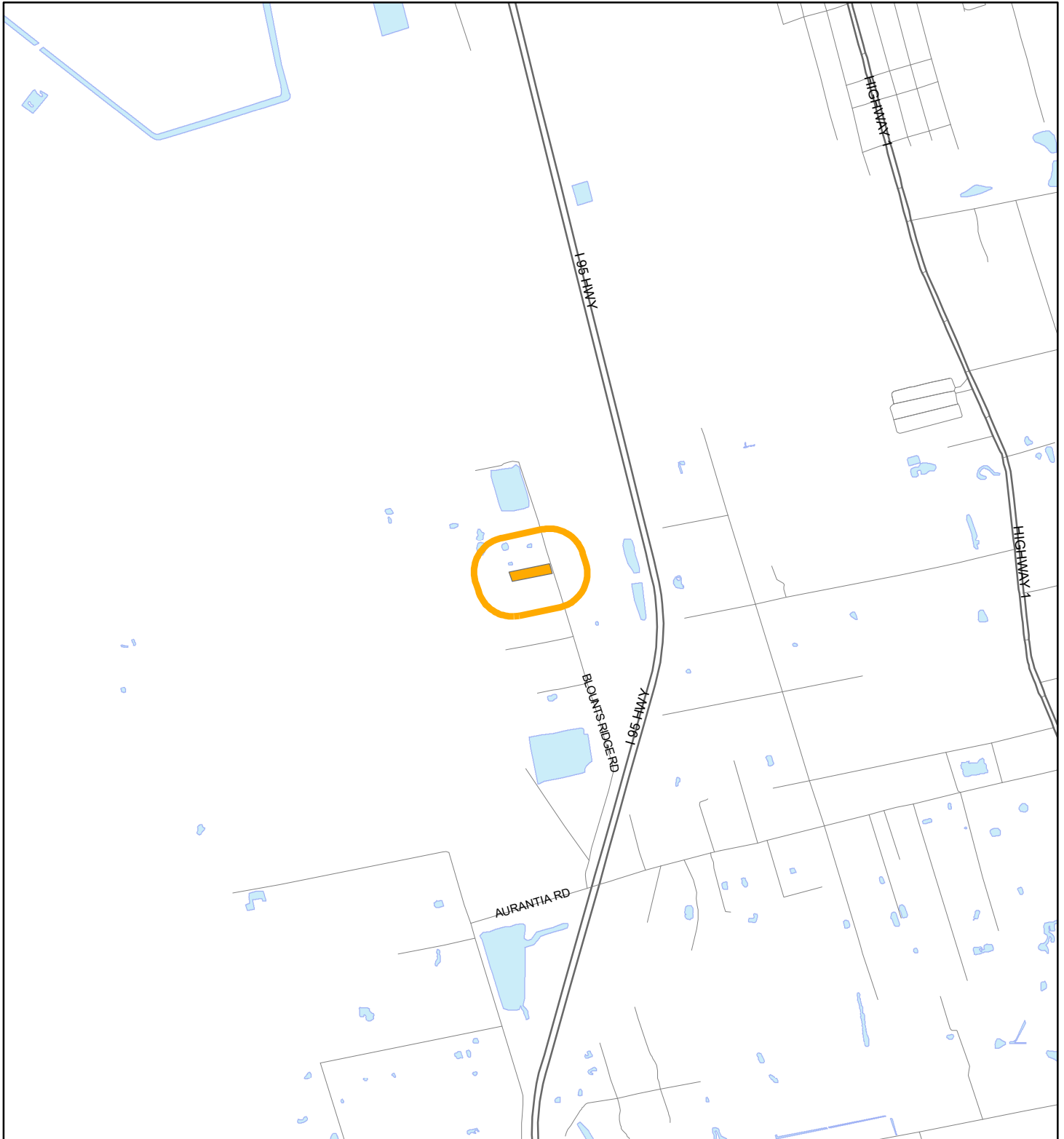

1:24,000 or 1 inch = 2,000 feet

Buffer Distance: 500 feet

This map was compiled from recorded documents and does not reflect an actual survey. The Brevard County Board of County Commissioners does not assume responsibility for errors or omissions hereon.

Produced by BoCC - GIS Date: 7/9/2024

 Buffer  
 Subject Property

# ZONING MAP

PATTERSON, GERALD L

24Z00022

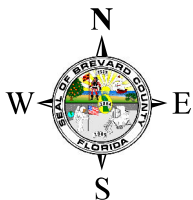

1:4,800 or 1 inch = 400 feet

This map was compiled from recorded documents and does not reflect an actual survey. The Brevard County Board of County Commissioners does not assume responsibility for errors or omissions hereon.

Produced by BoCC - GIS Date: 7/9/2024

Subject Property

Parcels

Zoning

PATTERSON, GERALD L  
24Z00022

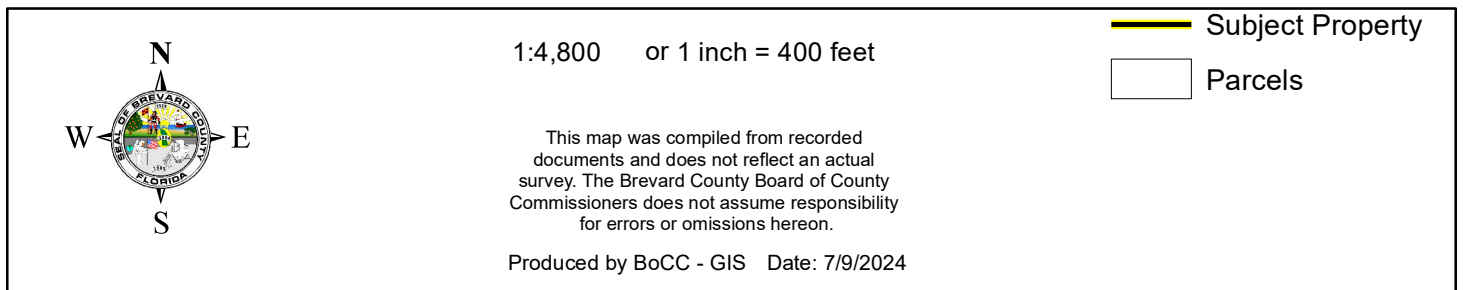



# AERIAL MAP

PATTERSON, GERALD L

24Z00022

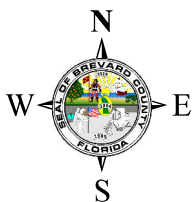

1:2,400 or 1 inch = 200 feet

PHOTO YEAR: 2024

This map was compiled from recorded documents and does not reflect an actual survey. The Brevard County Board of County Commissioners does not assume responsibility for errors or omissions hereon.

Produced by BoCC - GIS Date: 7/9/2024

 Subject Property

 Parcels



# NWI WETLANDS MAP

PATTERSON, GERALD L

24Z00022

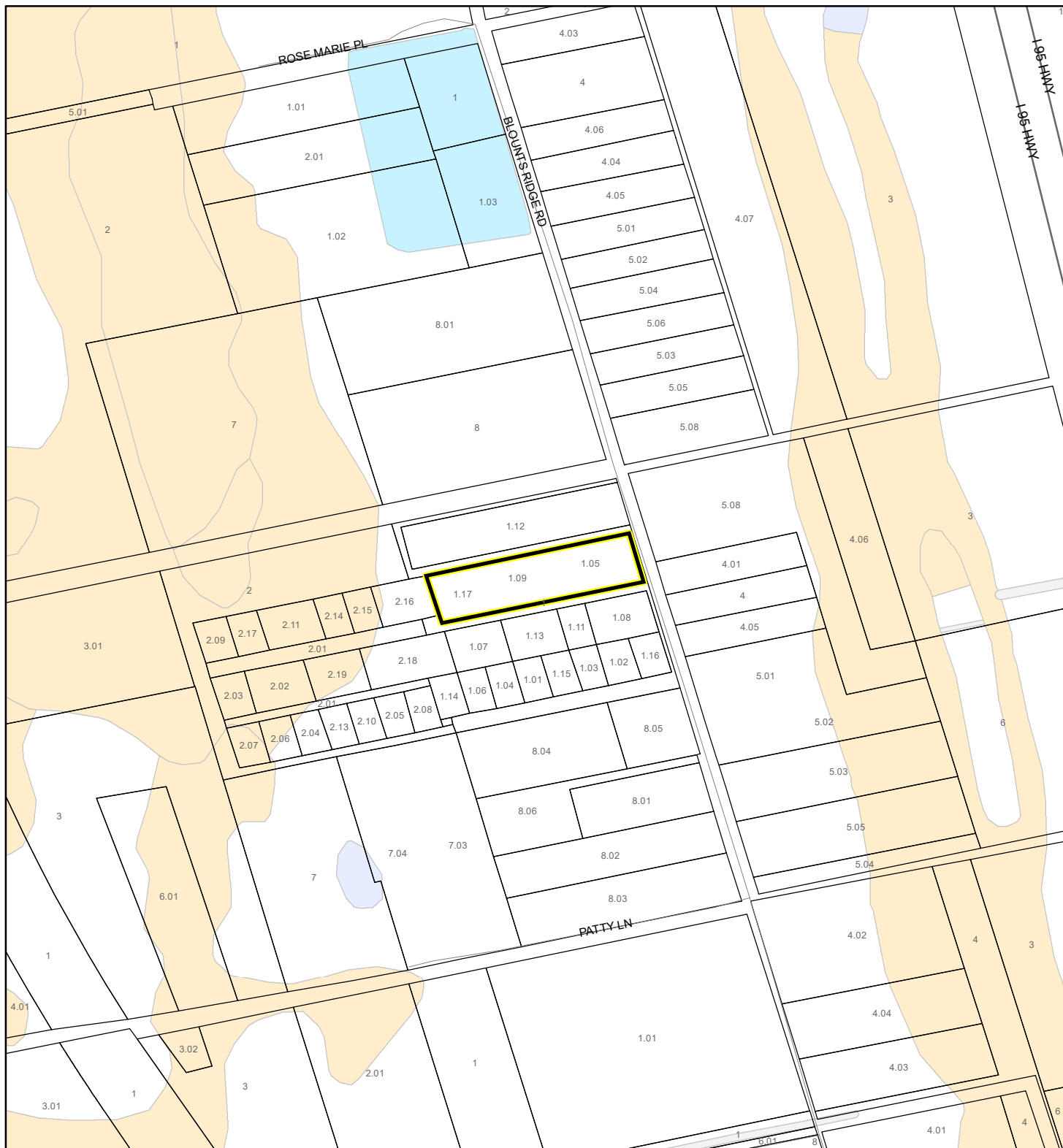









1:4,800 or 1 inch = 400 feet

This map was compiled from recorded documents and does not reflect an actual survey. The Brevard County Board of County Commissioners does not assume responsibility for errors or omissions hereon.

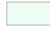
Produced by BoCC - GIS Date: 7/9/2024

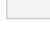
## National Wetlands Inventory (NWI)

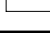
 Estuarine and Marine Deepwater	 Freshwater Pond
 Estuarine and Marine Wetland	 Lake
 Freshwater Emergent Wetland	 Other
 Freshwater Forested/Shrub Wetland	 Riverine
 Subject Property	
 Parcels	

# SJRWMD FLUCCS WETLANDS - 6000 Series MAP

PATTERSON, GERALD L

24Z00022

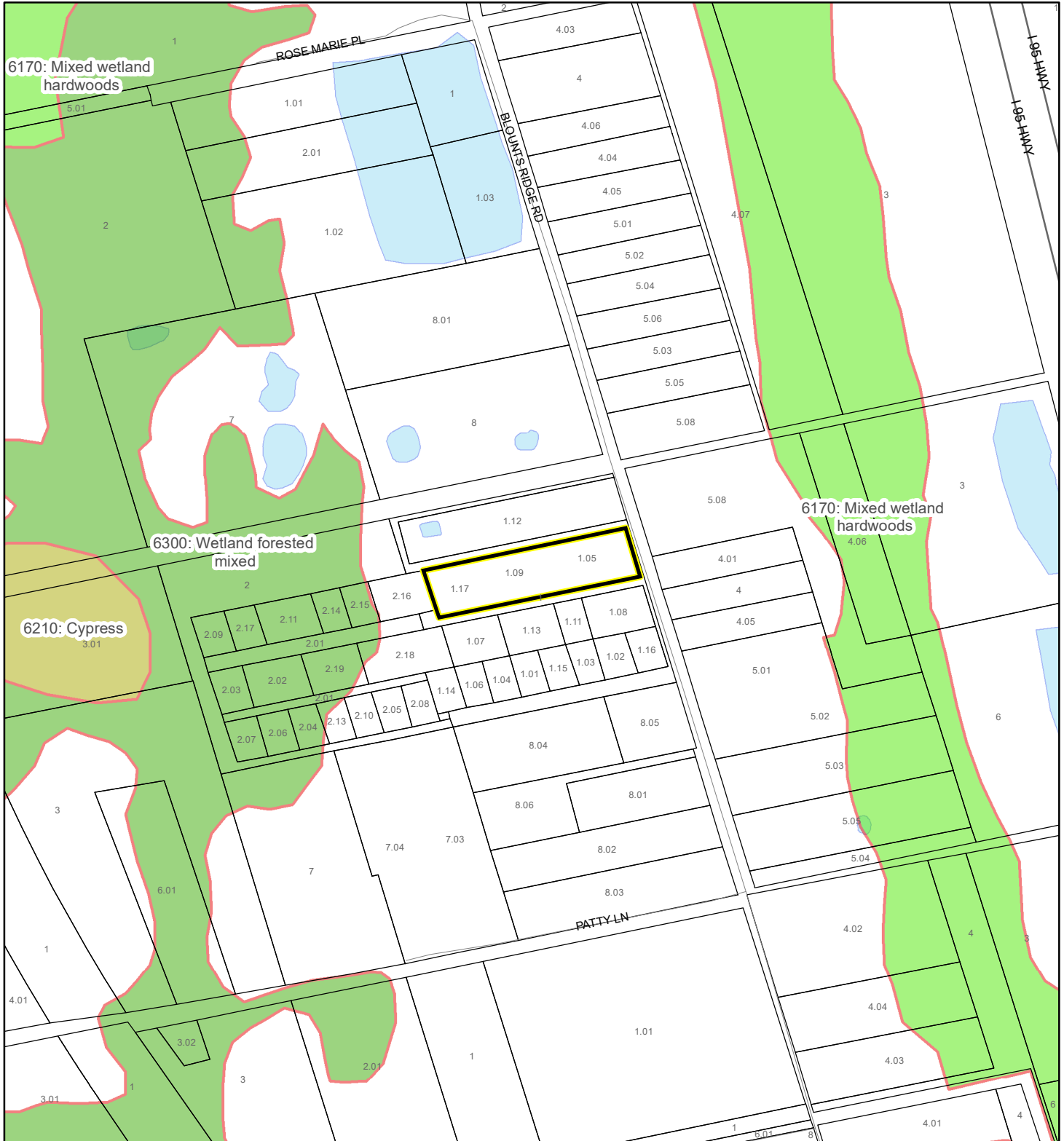

# USDA SCSSS SOILS MAP

PATTERSON, GERALD L

24Z00022

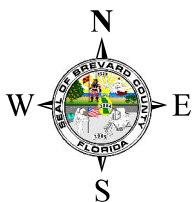
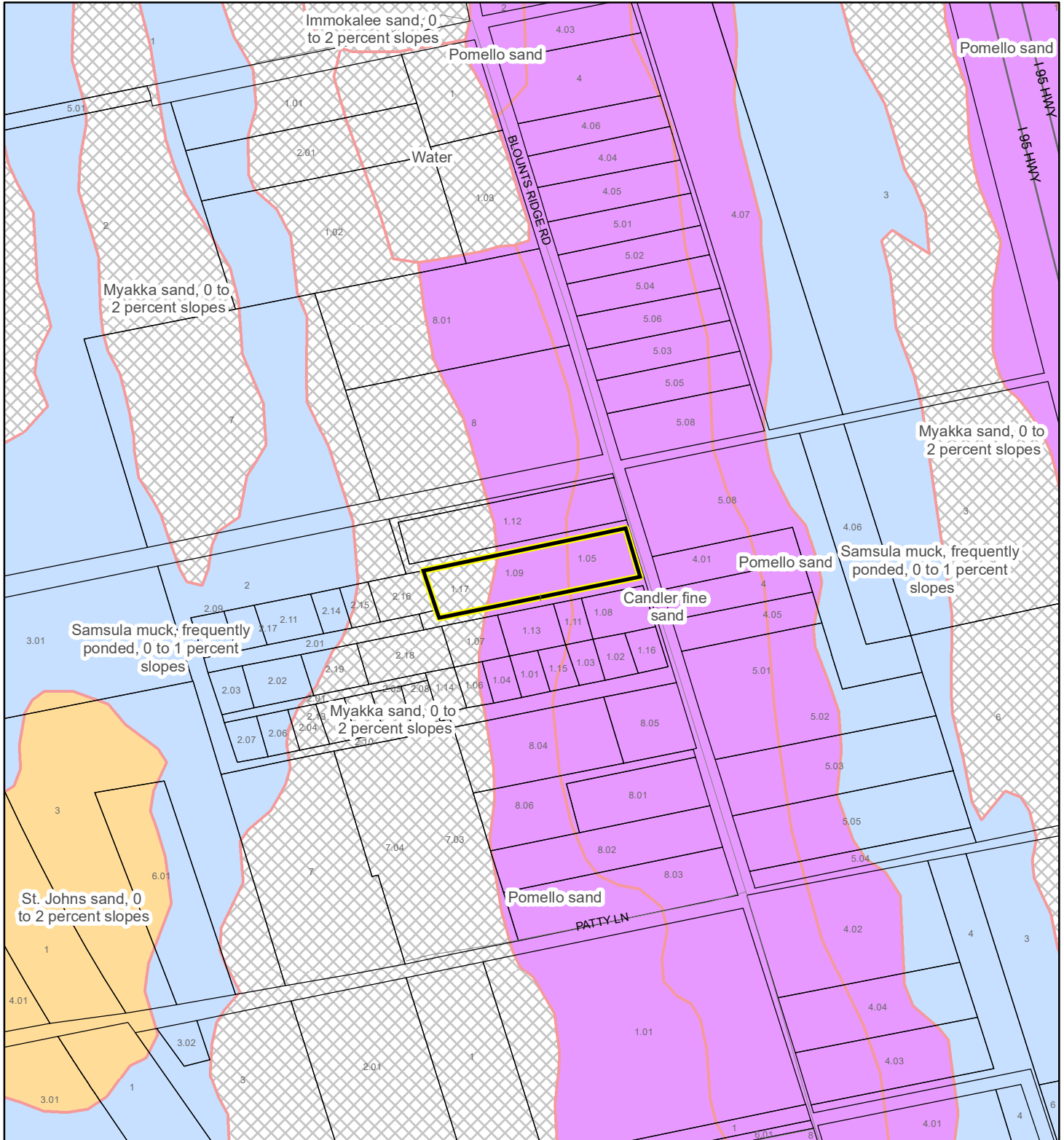

1:4,800 or 1 inch = 400 feet

This map was compiled from recorded documents and does not reflect an actual survey. The Brevard County Board of County Commissioners does not assume responsibility for errors or omissions hereon.

Produced by BoCC - GIS Date: 7/9/2024

## USDA SCSSS Soils

Aquifer and Hydric

Aquifer

Hydric

None

Subject Property

Parcels

# FEMA FLOOD ZONES MAP

PATTERSON, GERALD L

24Z00022

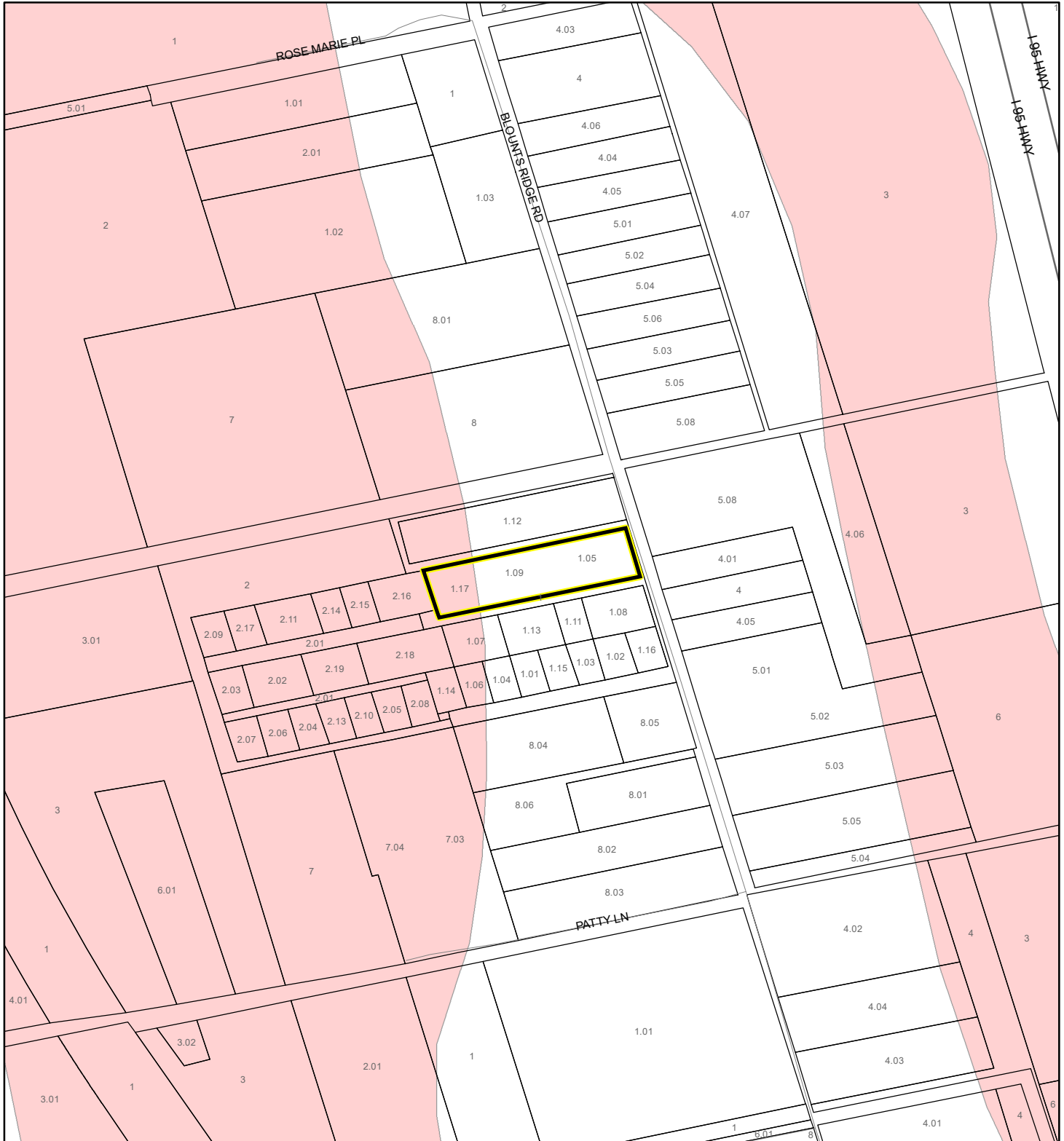



24Z00022

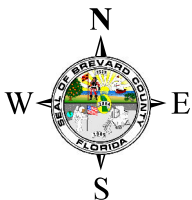
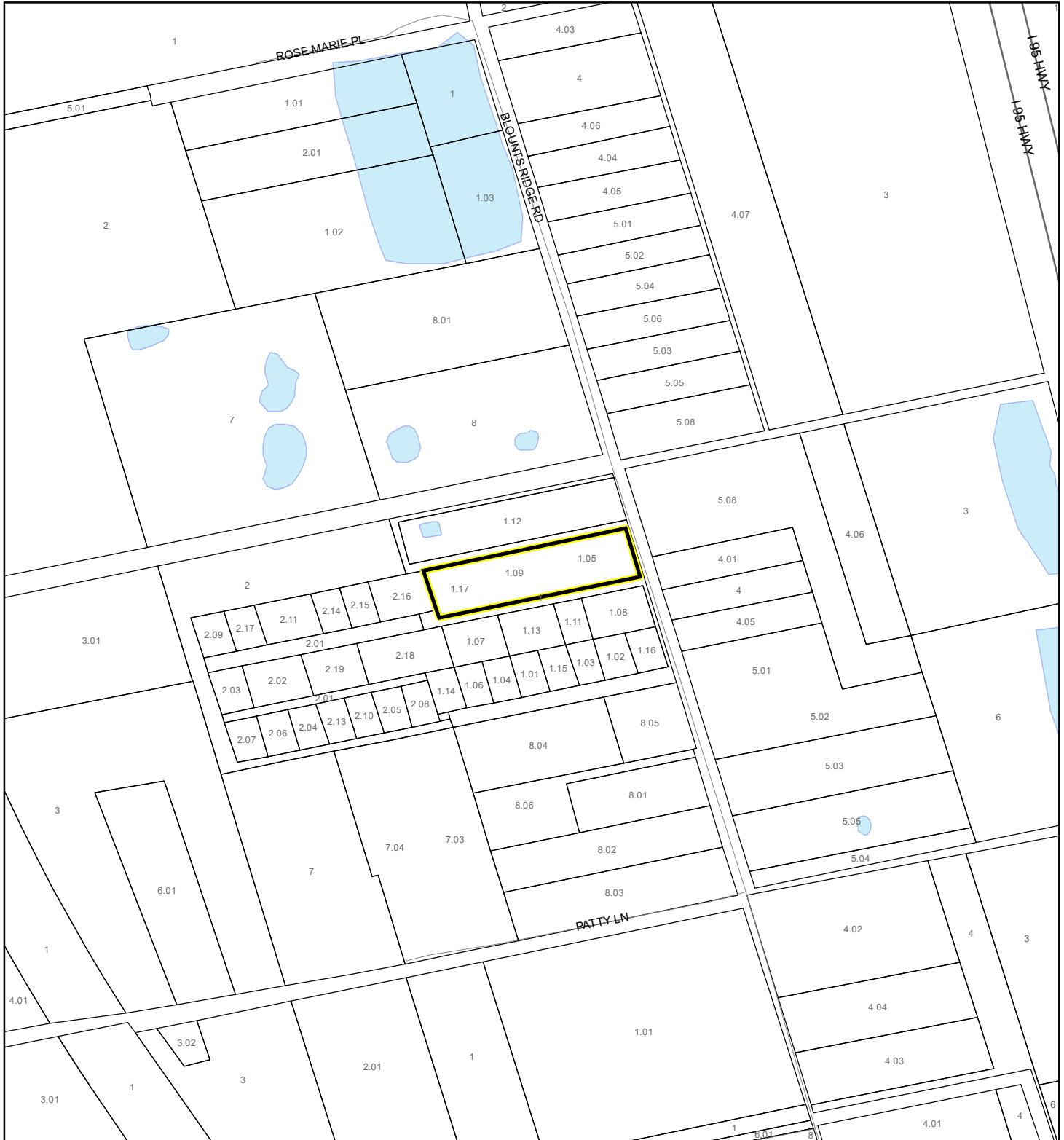

1:4,800      or 1 inch = 400 feet

This map was compiled from recorded documents and does not reflect an actual survey. The Brevard County Board of County Commissioners does not assume responsibility for errors or omissions hereon.

Produced by BoCC - GIS    Date: 7/9/2024

**Subject Property**

Parcels

### Coastal High Hazard Area

 SurgeZoneCat1

24Z00022

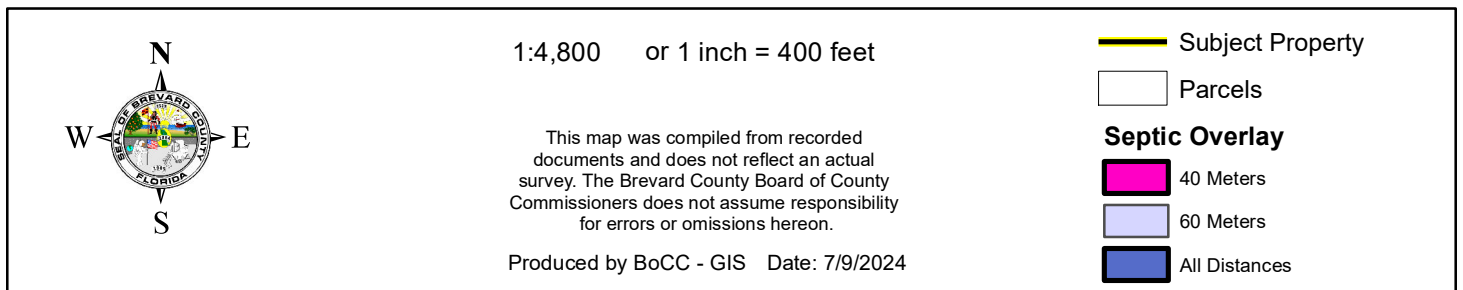

# EAGLE NESTS MAP

PATTERSON, GERALD L

24Z00022



1:4,800      or 1 inch = 400 feet

This map was compiled from recorded documents and does not reflect an actual survey. The Brevard County Board of County Commissioners does not assume responsibility for errors or omissions hereon.

Produced by BoCC - GIS    Date: 7/9/2024

**— Subject Property**

Parcels

Eagle Nests  
FWS



# SCRUB JAY OCCUPANCY MAP

PATTERSON, GERALD L

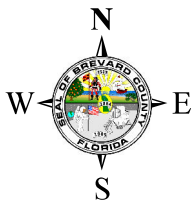
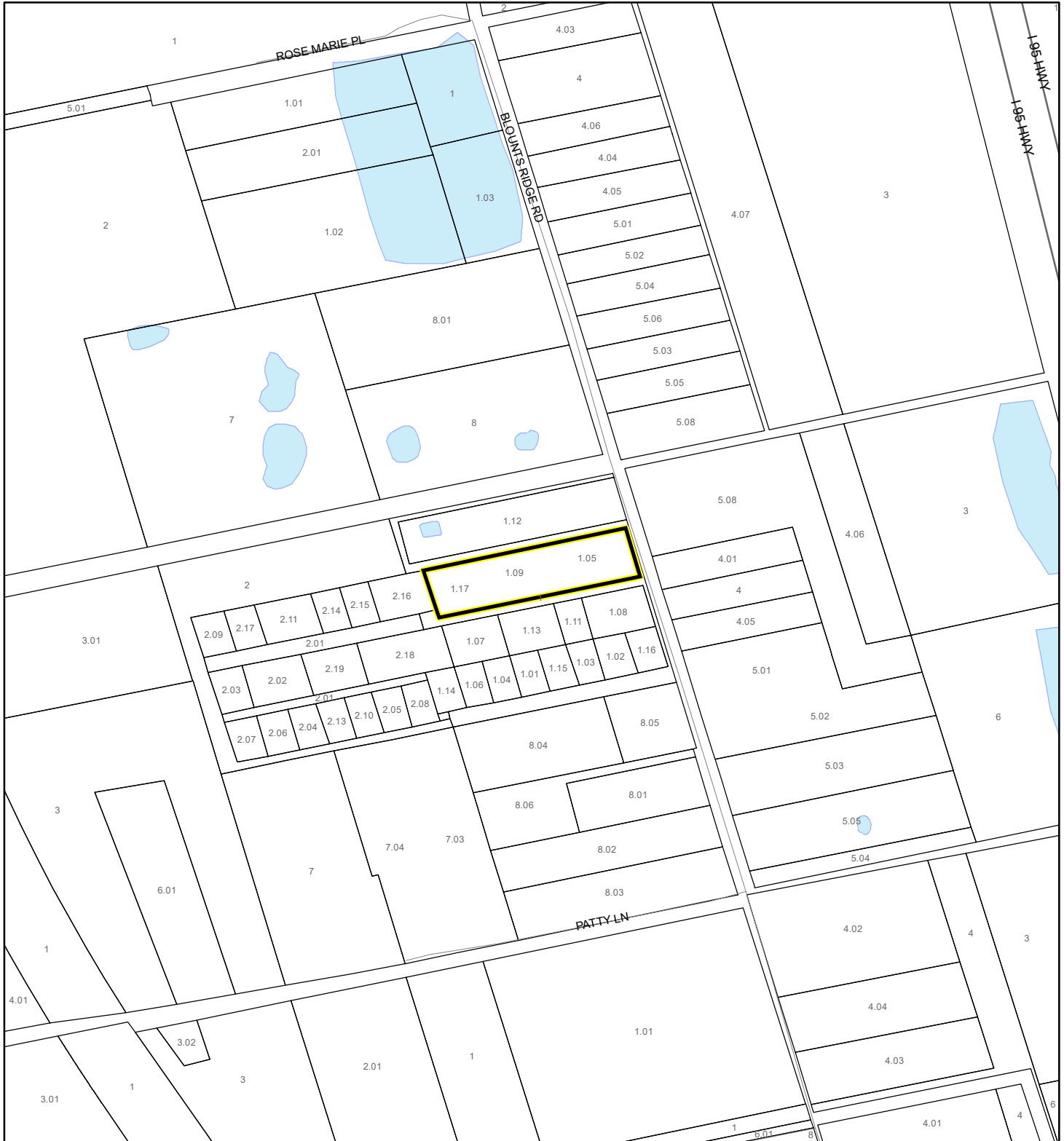

24Z00022



1:4,800 or 1 inch = 400 feet

This map was compiled from recorded documents and does not reflect an actual survey. The Brevard County Board of County Commissioners does not assume responsibility for errors or omissions hereon.

Produced by BoCC - GIS Date: 7/9/2024

-  Subject Property
-  Parcels
-  Scrub Jay Occupancy

# SJRWMD FLUCCS UPLAND FORESTS - 4000 Series MAP

PATTERSON, GERALD L

24Z00022

