

LOCATION MAP

MARKS, BREANNA DAWN

24V00038

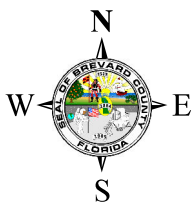

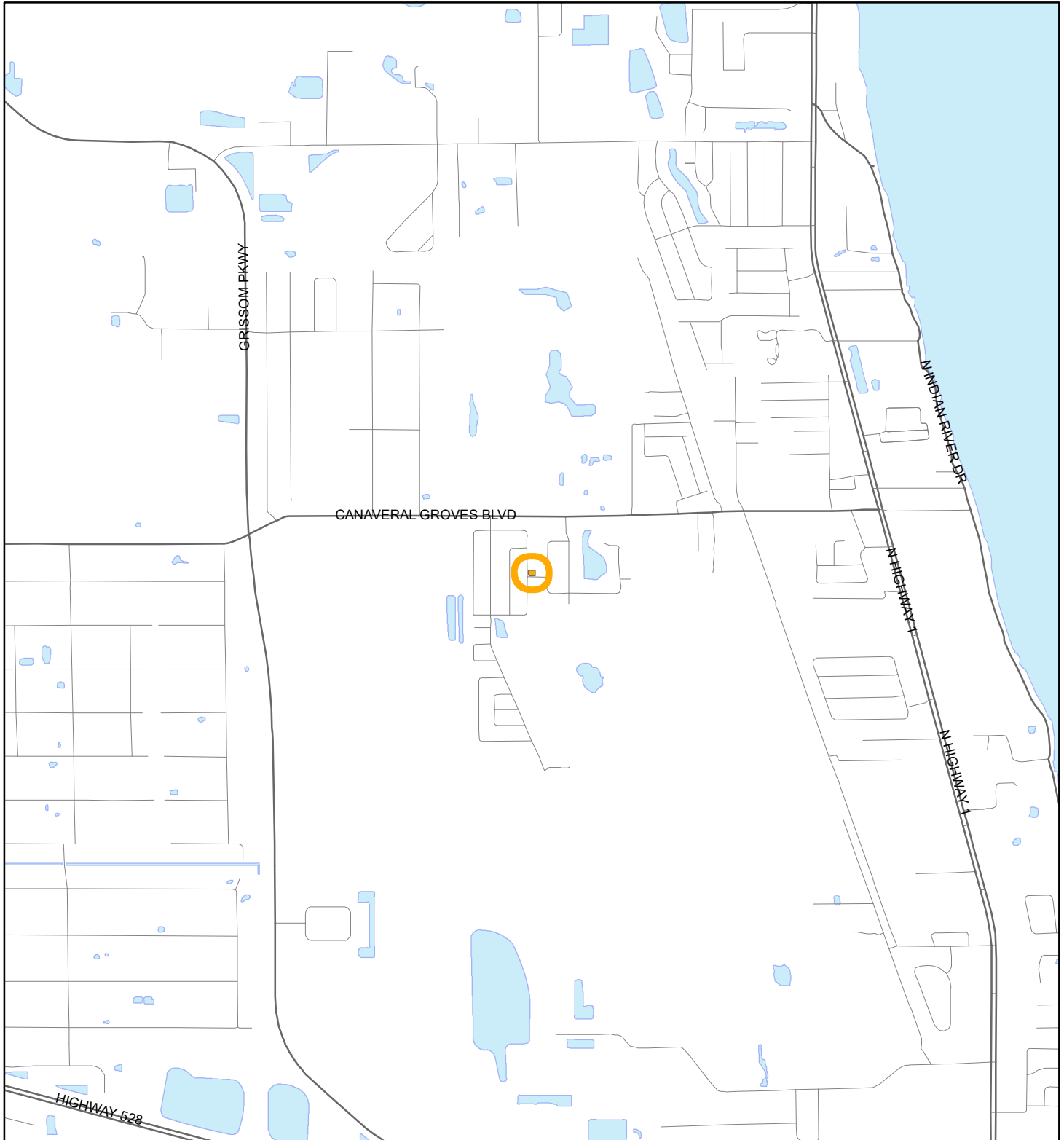

1:24,000 or 1 inch = 2,000 feet

Buffer Distance: 200 feet

This map was compiled from recorded documents and does not reflect an actual survey. The Brevard County Board of County Commissioners does not assume responsibility for errors or omissions hereon.

Produced by BoCC - GIS Date: 9/6/2024

 Buffer
 Subject Property

ZONING MAP

MARKS, BREANNA DAWN

24V00038

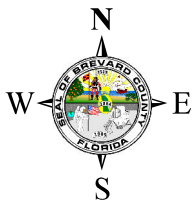
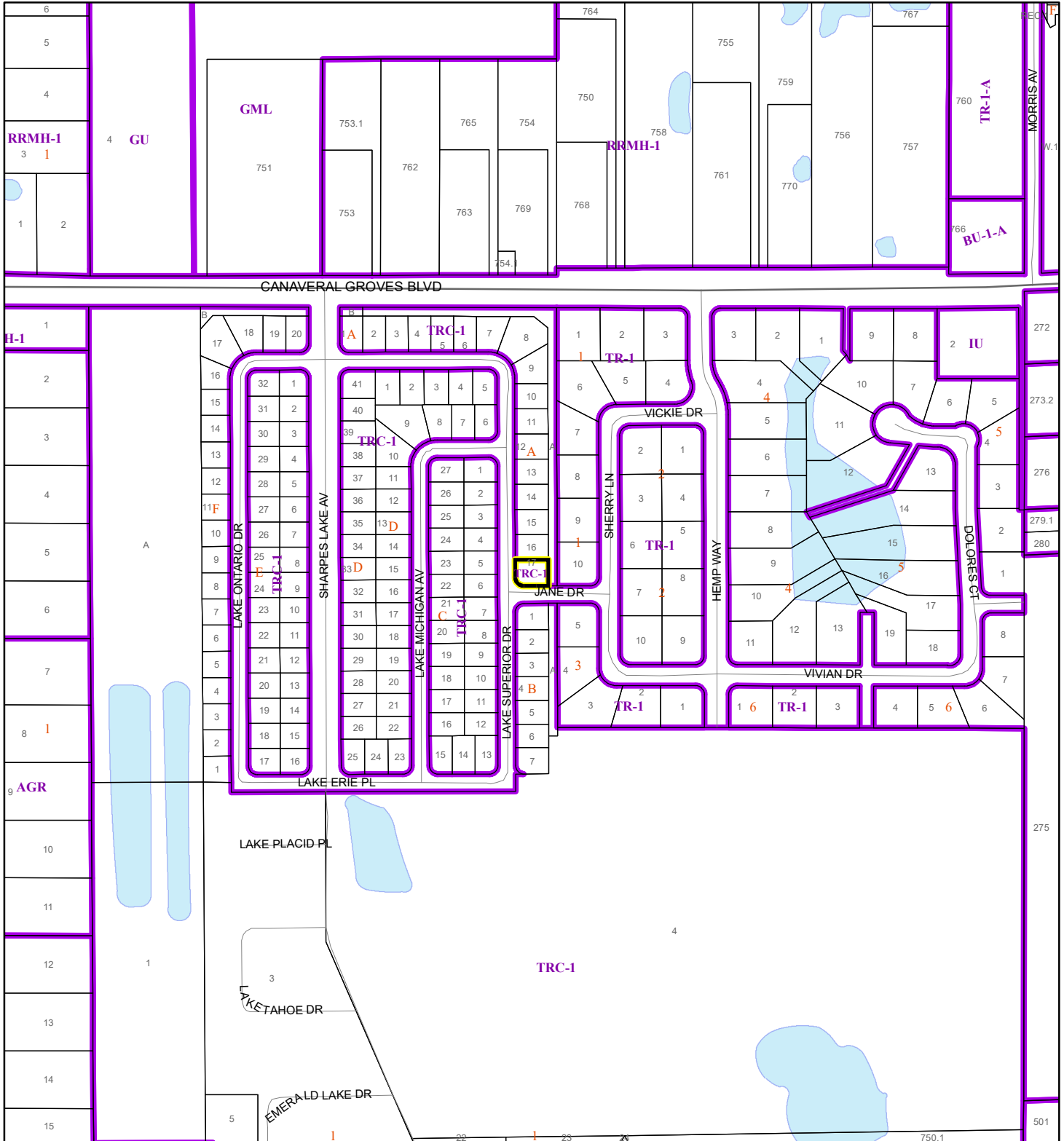

1:4,800 or 1 inch = 400 feet

This map was compiled from recorded documents and does not reflect an actual survey. The Brevard County Board of County Commissioners does not assume responsibility for errors or omissions hereon.

Produced by BoCC - GIS Date: 9/6/2024

 Subject Property

 Parcels

 Zoning

AERIAL MAP

MARKS, BREANNA DAWN

24V00038

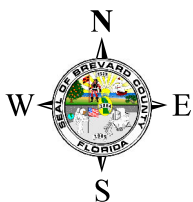
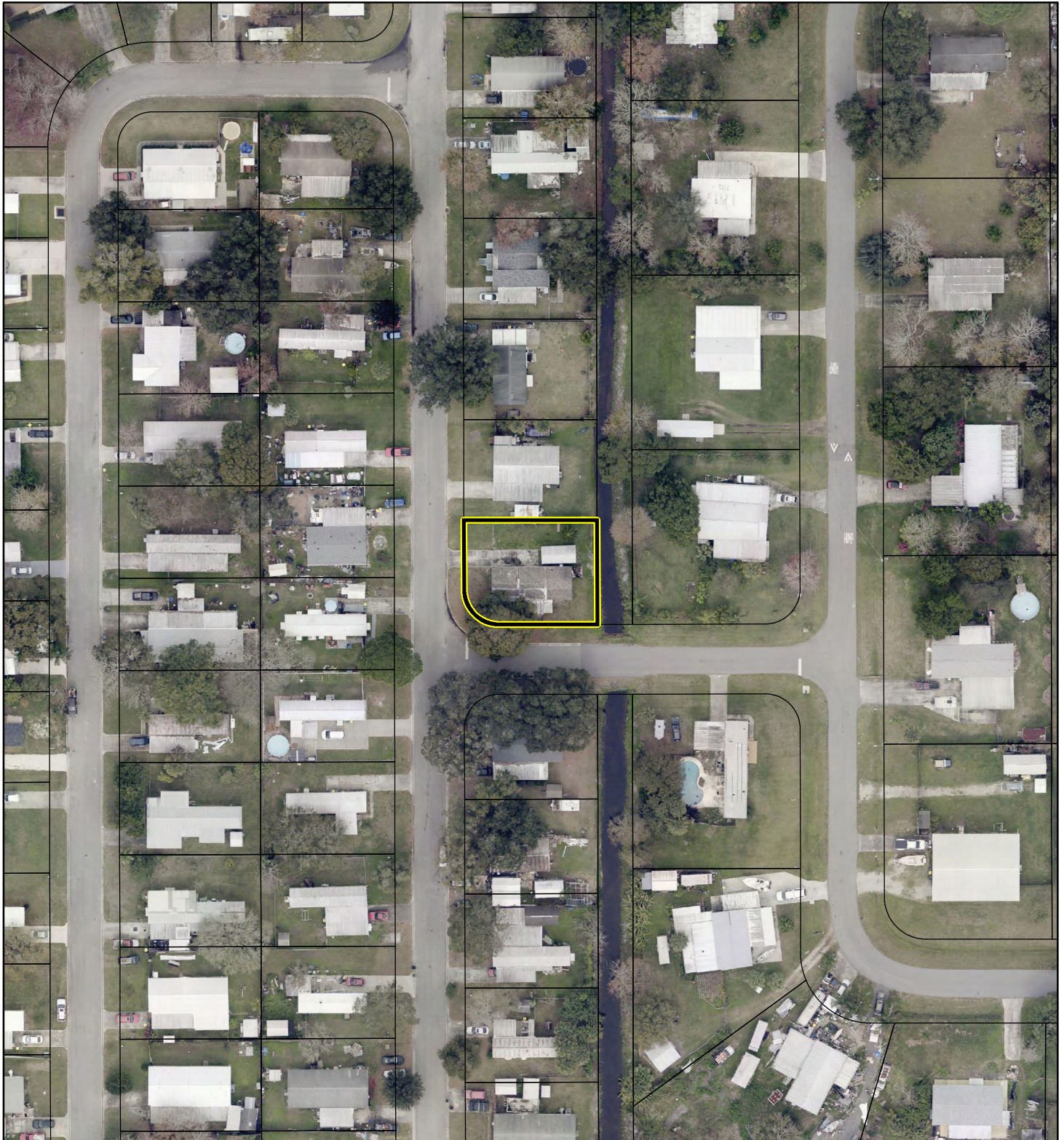



1:1,200 or 1 inch = 100 feet

PHOTO YEAR: 2024

This map was compiled from recorded documents and does not reflect an actual survey. The Brevard County Board of County Commissioners does not assume responsibility for errors or omissions hereon.

Produced by BoCC - GIS Date: 9/6/2024

 Subject Property
 Parcels