

# LOCATION MAP

WATKINS, KELEON R

24Z00048

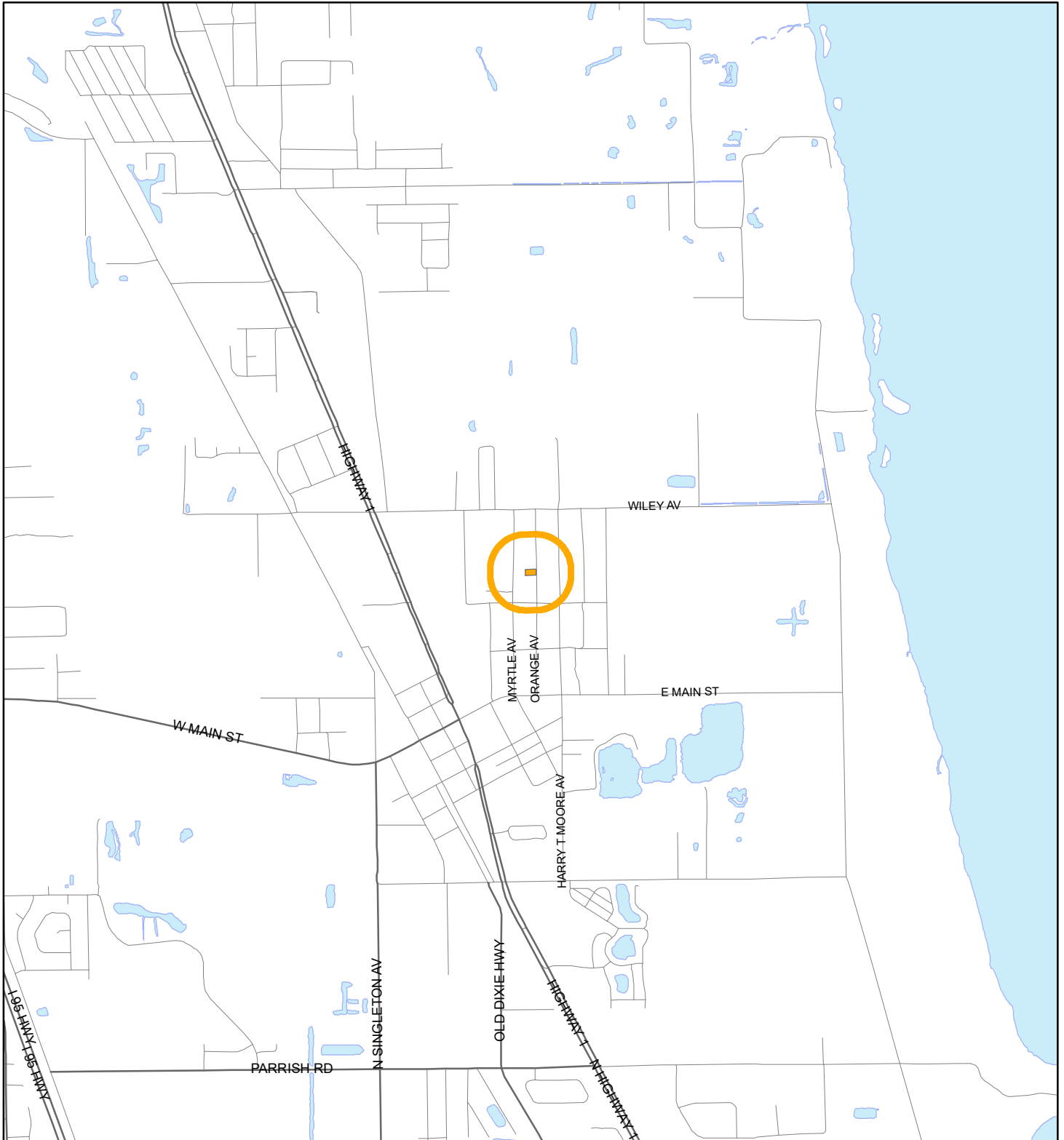



1:24,000 or 1 inch = 2,000 feet

Buffer Distance: 500 feet

This map was compiled from recorded documents and does not reflect an actual survey. The Brevard County Board of County Commissioners does not assume responsibility for errors or omissions hereon.

Produced by BoCC - GIS Date: 8/27/2024

-  Buffer
-  Subject Property

# ZONING MAP

WATKINS, KELEON R

24Z00048

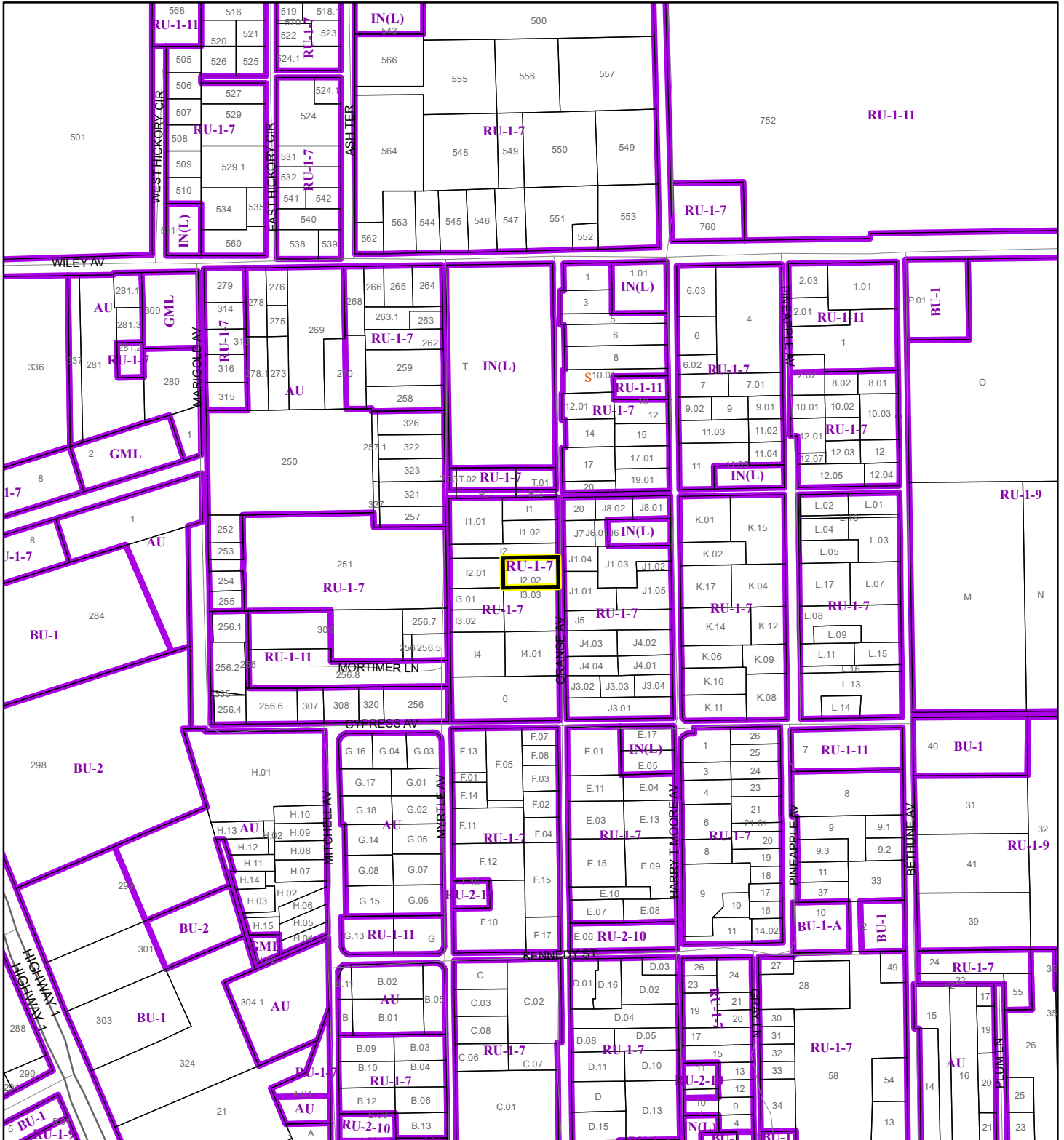

1:4,800 or 1 inch = 400 feet

This map was compiled from recorded documents and does not reflect an actual survey. The Brevard County Board of County Commissioners does not assume responsibility for errors or omissions hereon.

Produced by BoCC - GIS Date: 8/27/2024

- Subject Property
- Parcels
- Zoning



# FUTURE LAND USE MAP

WATKINS, KELEON R

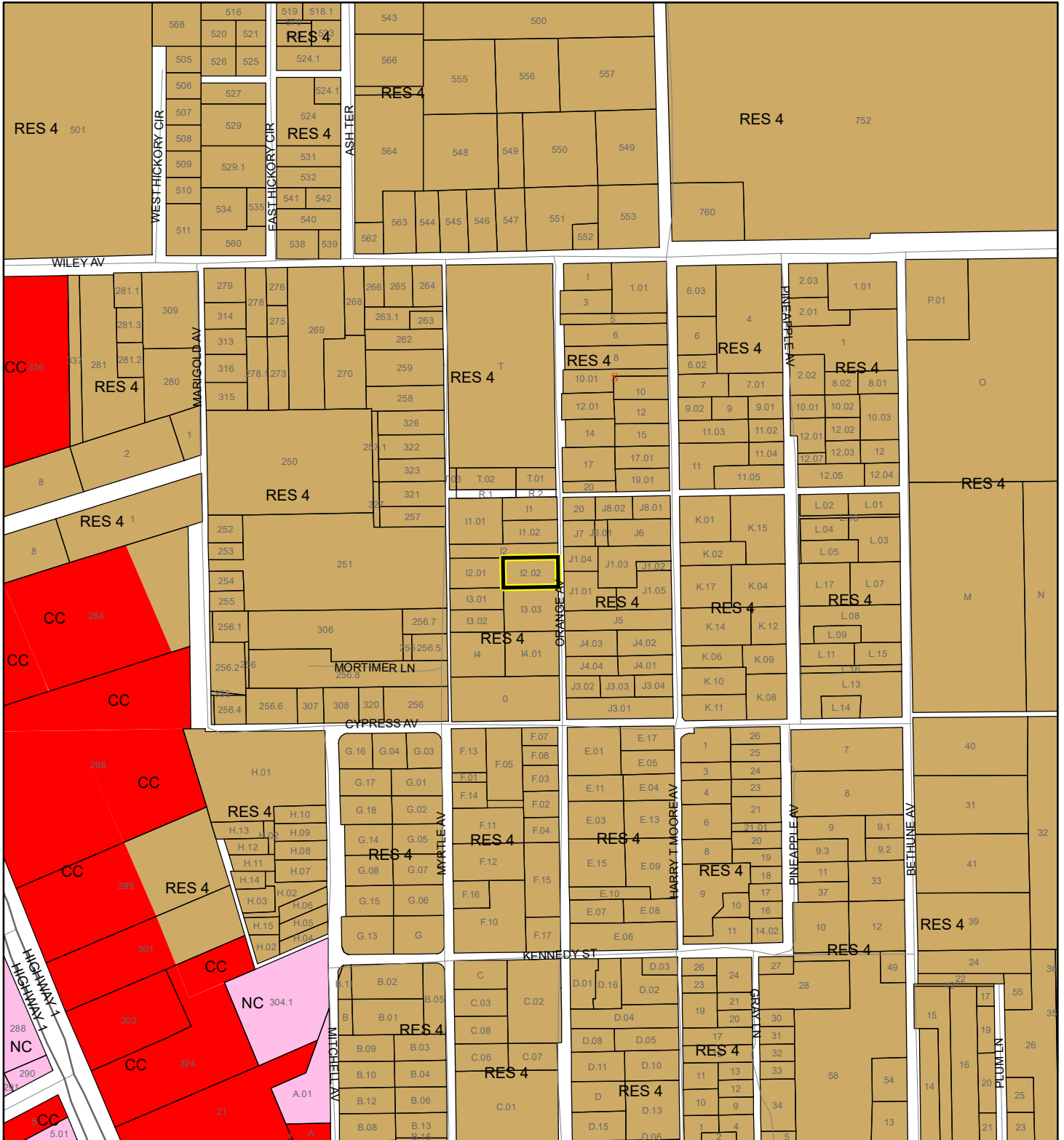
24Z00048



1:4,800 or 1 inch = 400 feet

 Subject Property  
 Parcels

This map was compiled from recorded documents and does not reflect an actual survey. The Brevard County Board of County Commissioners does not assume responsibility for errors or omissions hereon.

Produced by BoCC - GIS Date: 8/27/2024



# AERIAL MAP

WATKINS, KELEON R

24Z00048



1:1,200 or 1 inch = 100 feet

PHOTO YEAR: 2024

This map was compiled from recorded documents and does not reflect an actual survey. The Brevard County Board of County Commissioners does not assume responsibility for errors or omissions hereon.

Produced by BoCC - GIS Date: 8/27/2024

 Subject Property

 Parcels



# NWI WETLANDS MAP

WATKINS, KELEON R

24Z00048

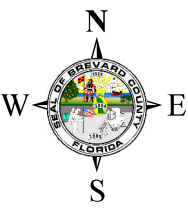
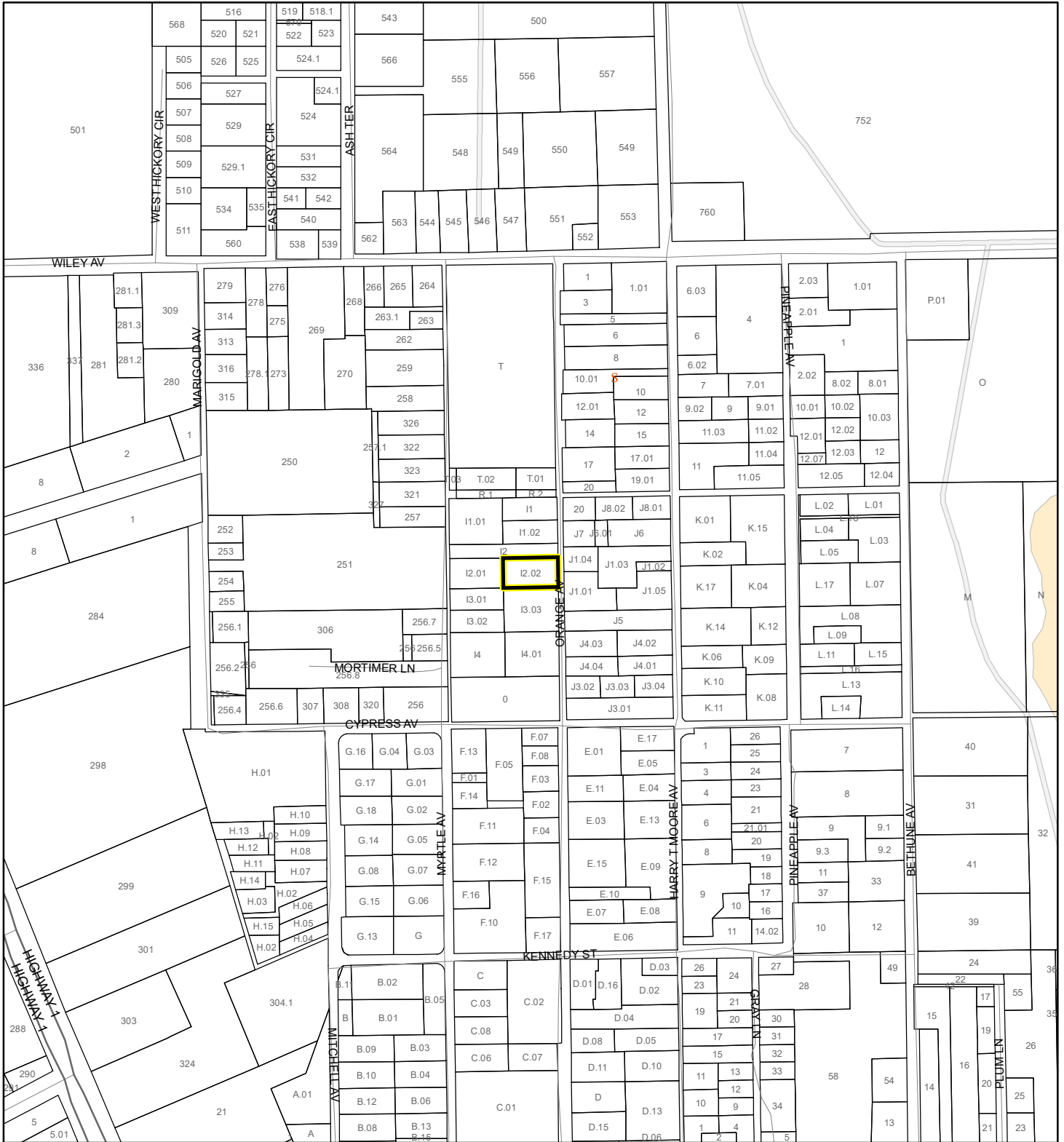

1:4,800 or 1 inch = 400 feet

This map was compiled from recorded documents and does not reflect an actual survey. The Brevard County Board of County Commissioners does not assume responsibility for errors or omissions hereon.

Produced by BoCC - GIS Date: 8/27/2024

### National Wetlands Inventory (NWI)

- Estuarine and Marine Deepwater
- Estuarine and Marine Wetland
- Freshwater Emergent Wetland
- Freshwater Forested/Shrub Wetland
- Freshwater Pond
- Lake
- Other
- Riverine
- Subject Property
- Parcels

# SJRWMD FLUCCS WETLANDS - 6000 Series MAP

WATKINS, KELEON R

24Z00048

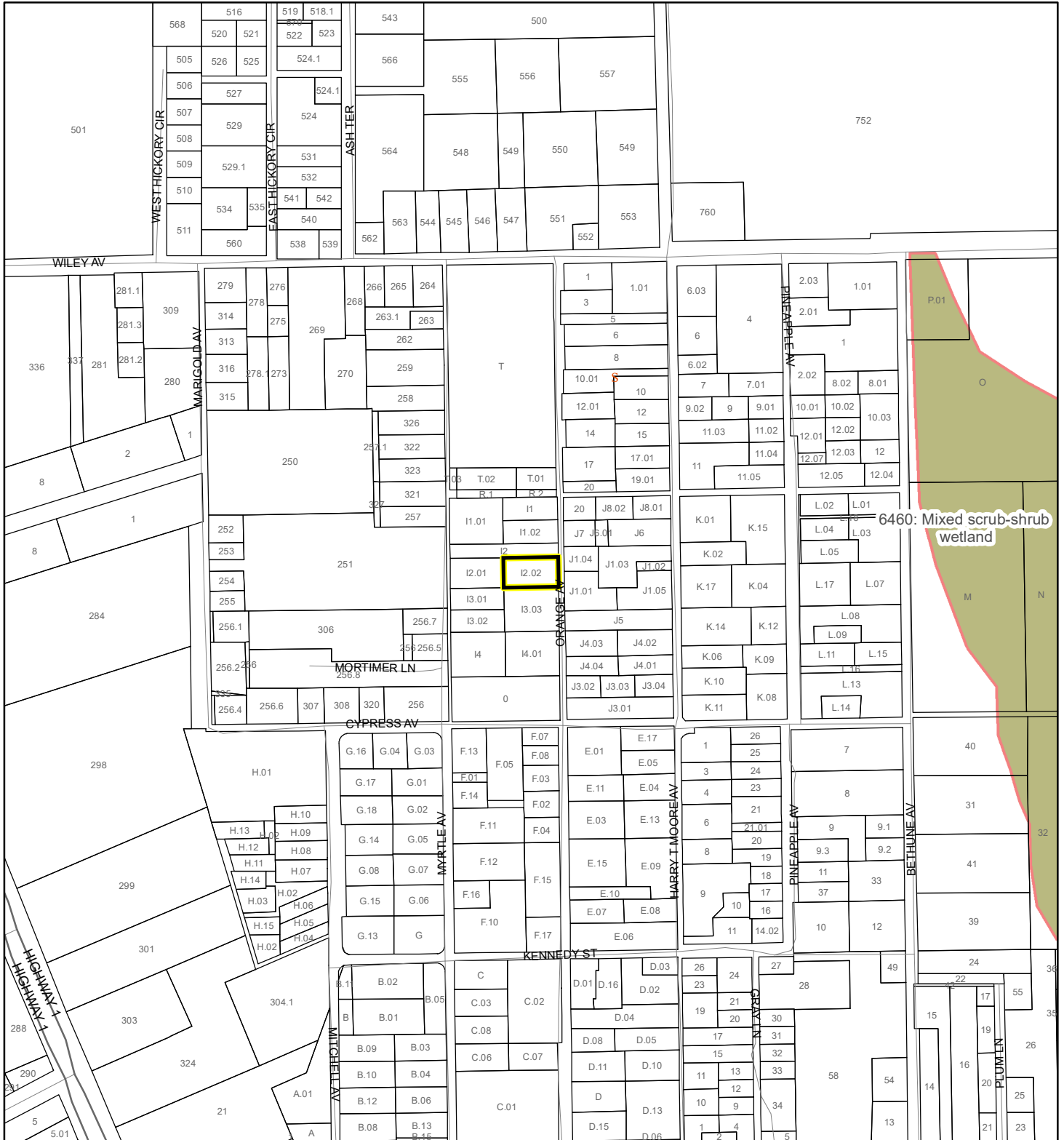

1:4,800 or 1 inch = 400 feet

This map was compiled from recorded documents and does not reflect an actual survey. The Brevard County Board of County Commissioners does not assume responsibility for errors or omissions hereon.

Produced by BoCC - GIS Date: 8/27/2024

## SJRWMD FLUCCS WETLANDS

- Wetland Hardwood Forests - Series 6100
- Wetland Coniferous Forest - Series 6200
- Wetland Forested Mixed - Series 6300
- Vegetated Non-Forested Wetlands - Series 6400
- Non-Vegetated Wetland - Series 6500

Subject Property

Parcels

# USDA SCSSS SOILS MAP

WATKINS, KELEON R

24Z00048

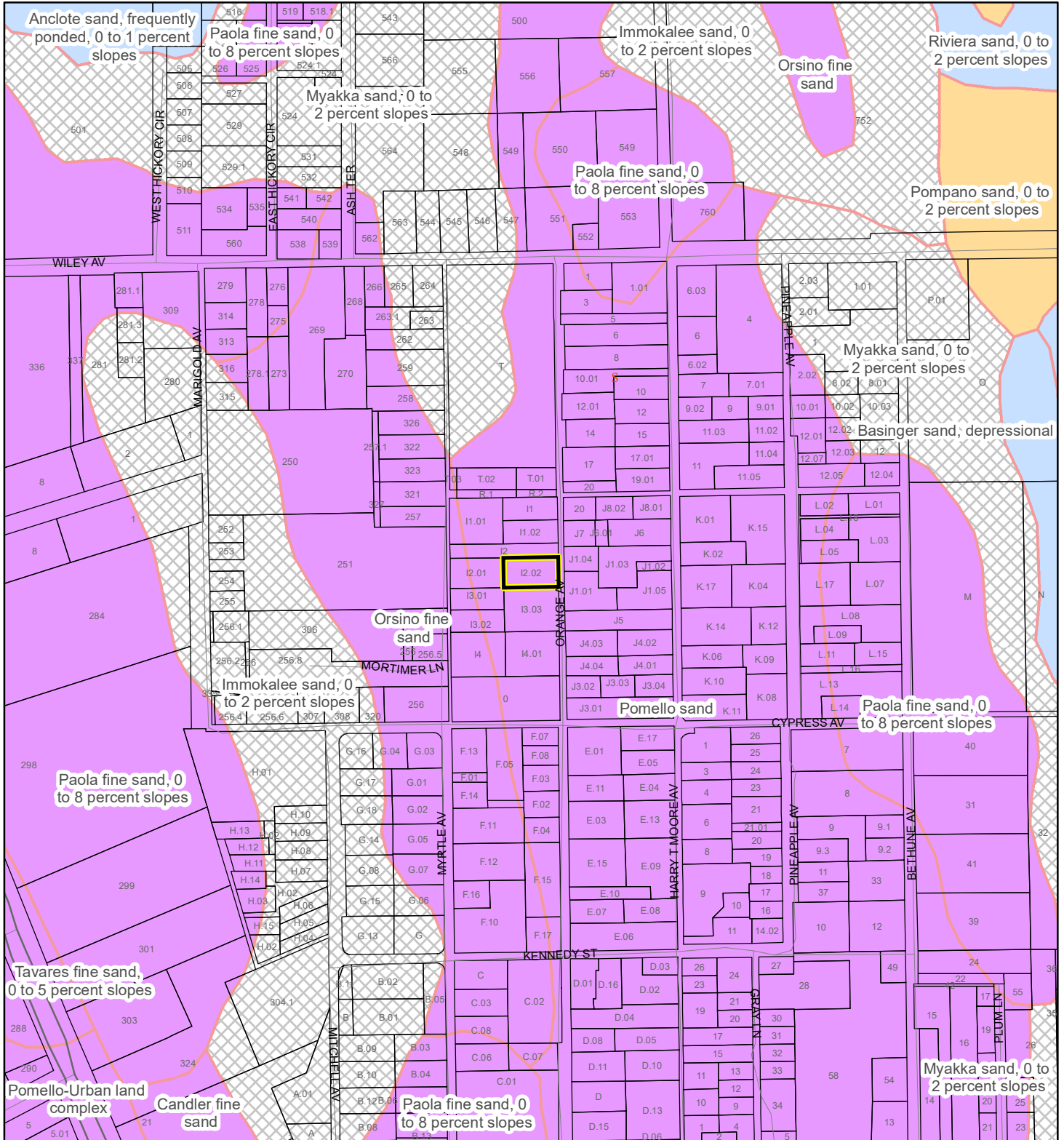

1:4,800 or 1 inch = 400 feet

### USDA SCSSS Soils

- Aquifer and Hydric
- Aquifer
- Hydric
- None
- Subject Property
- Parcels

This map was compiled from recorded documents and does not reflect an actual survey. The Brevard County Board of County Commissioners does not assume responsibility for errors or omissions hereon.

Produced by BoCC - GIS Date: 8/27/2024

# FEMA FLOOD ZONES MAP

WATKINS, KELEON R

24Z00048

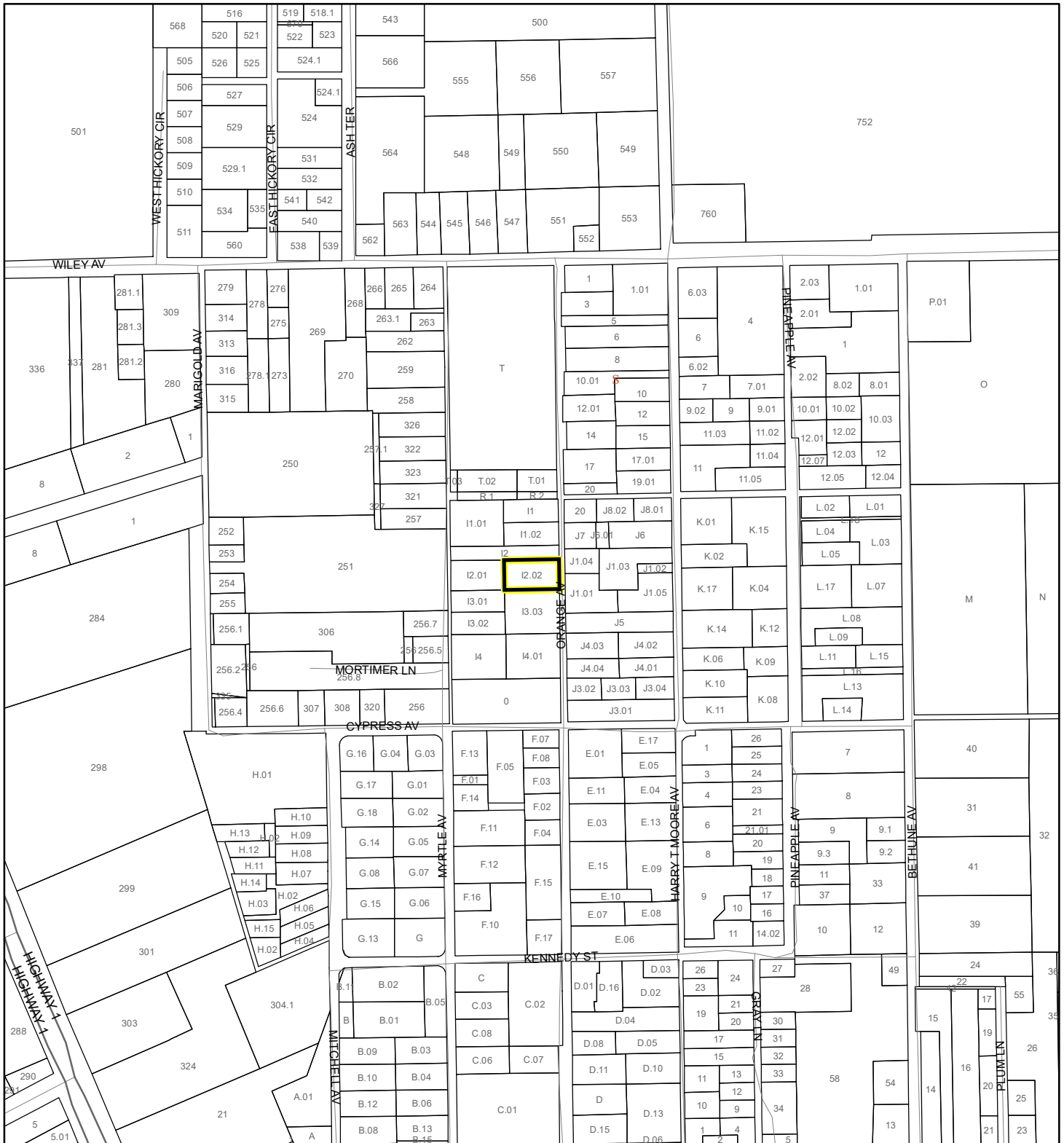

1:4,800 or 1 inch = 400 feet

This map was compiled from recorded documents and does not reflect an actual survey. The Brevard County Board of County Commissioners does not assume responsibility for errors or omissions hereon.

Produced by BoCC - GIS Date: 8/27/2024

### FEMA Flood Zones

- |                  |            |   |
|------------------|------------|---|
| A                | AO         | X |
| AE               | Open Water |   |
| AH               | VE         |   |
| Subject Property | Parcels    |   |



# COASTAL HIGH HAZARD AREA MAP

WATKINS, KELEON R

24Z00048

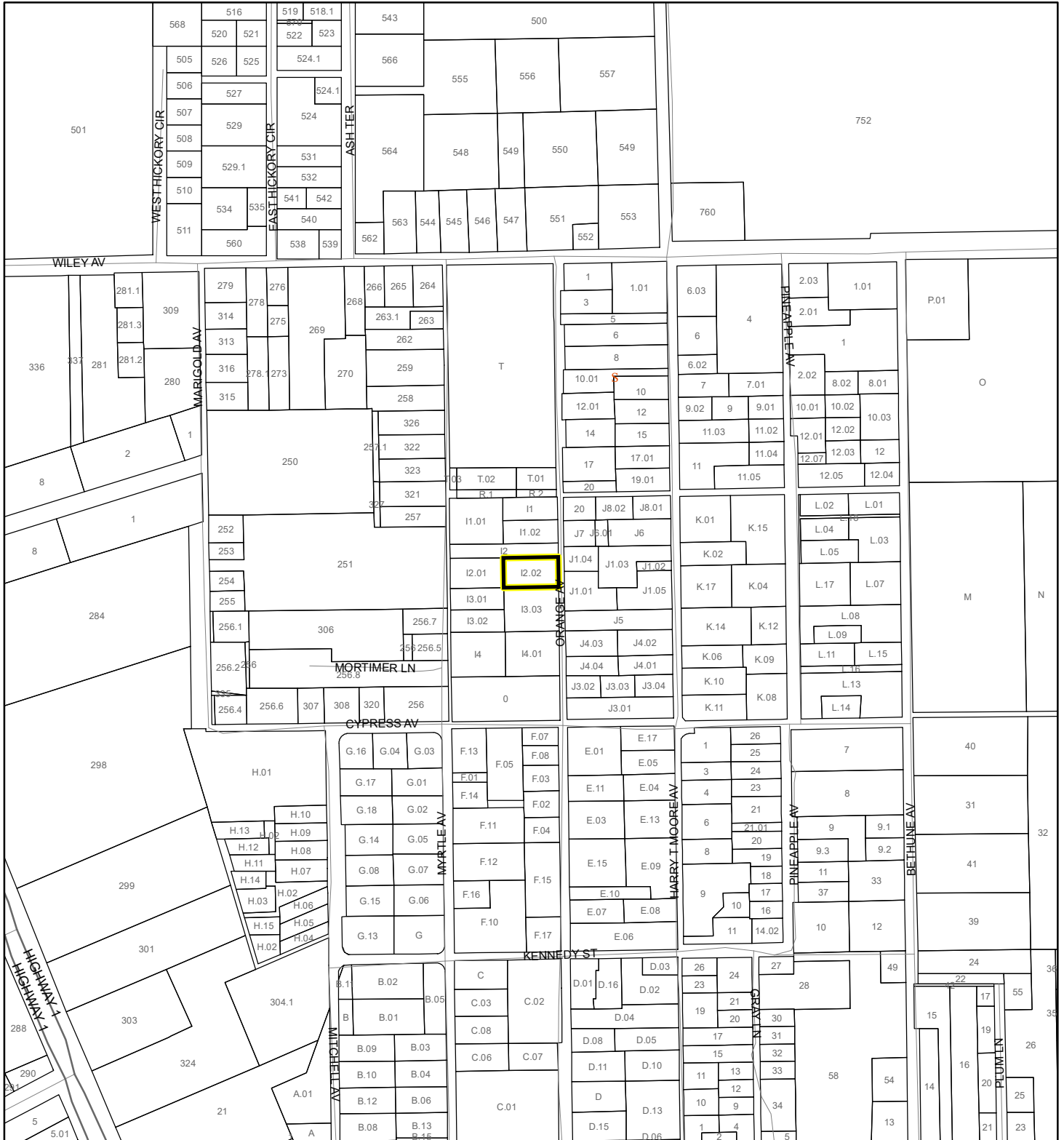

N



1:4,800 or 1 inch = 400 feet

 Subject Property

 Parcels

**Coastal High Hazard Area**

 SurgeZoneCat1

This map was compiled from recorded documents and does not reflect an actual survey. The Brevard County Board of County Commissioners does not assume responsibility for errors or omissions hereon.

Produced by BoCC - GIS Date: 8/27/2024

# INDIAN RIVER LAGOON SEPTIC OVERLAY MAP

WATKINS, KELEON R

24Z00048

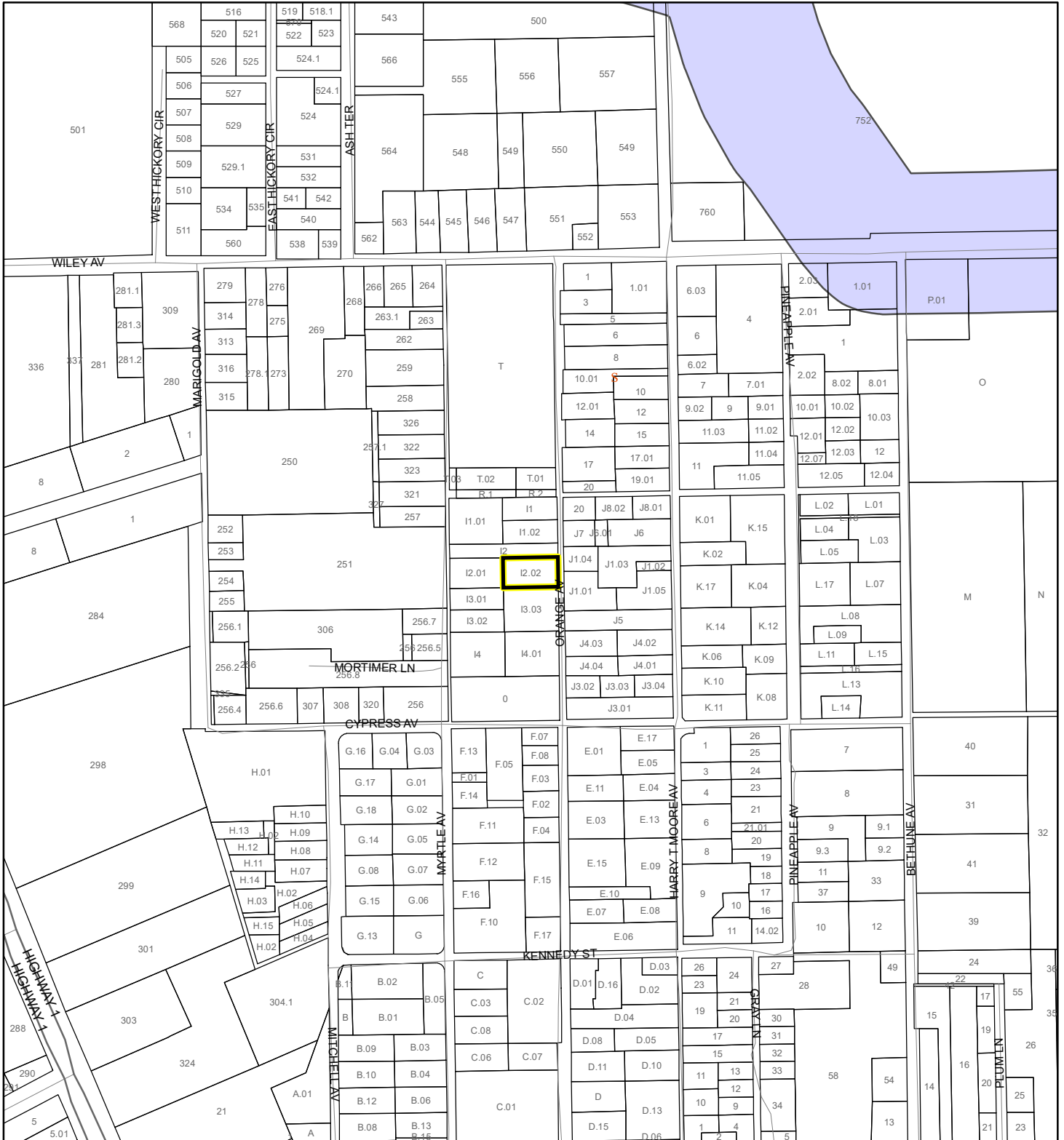

1:4,800 or 1 inch = 400 feet

This map was compiled from recorded documents and does not reflect an actual survey. The Brevard County Board of County Commissioners does not assume responsibility for errors or omissions hereon.

Produced by BoCC - GIS Date: 8/27/2024

 Subject Property

 Parcels

**Septic Overlay**

 40 Meters

 60 Meters

 All Distances

# EAGLE NESTS MAP

WATKINS, KELEON R

24Z00048

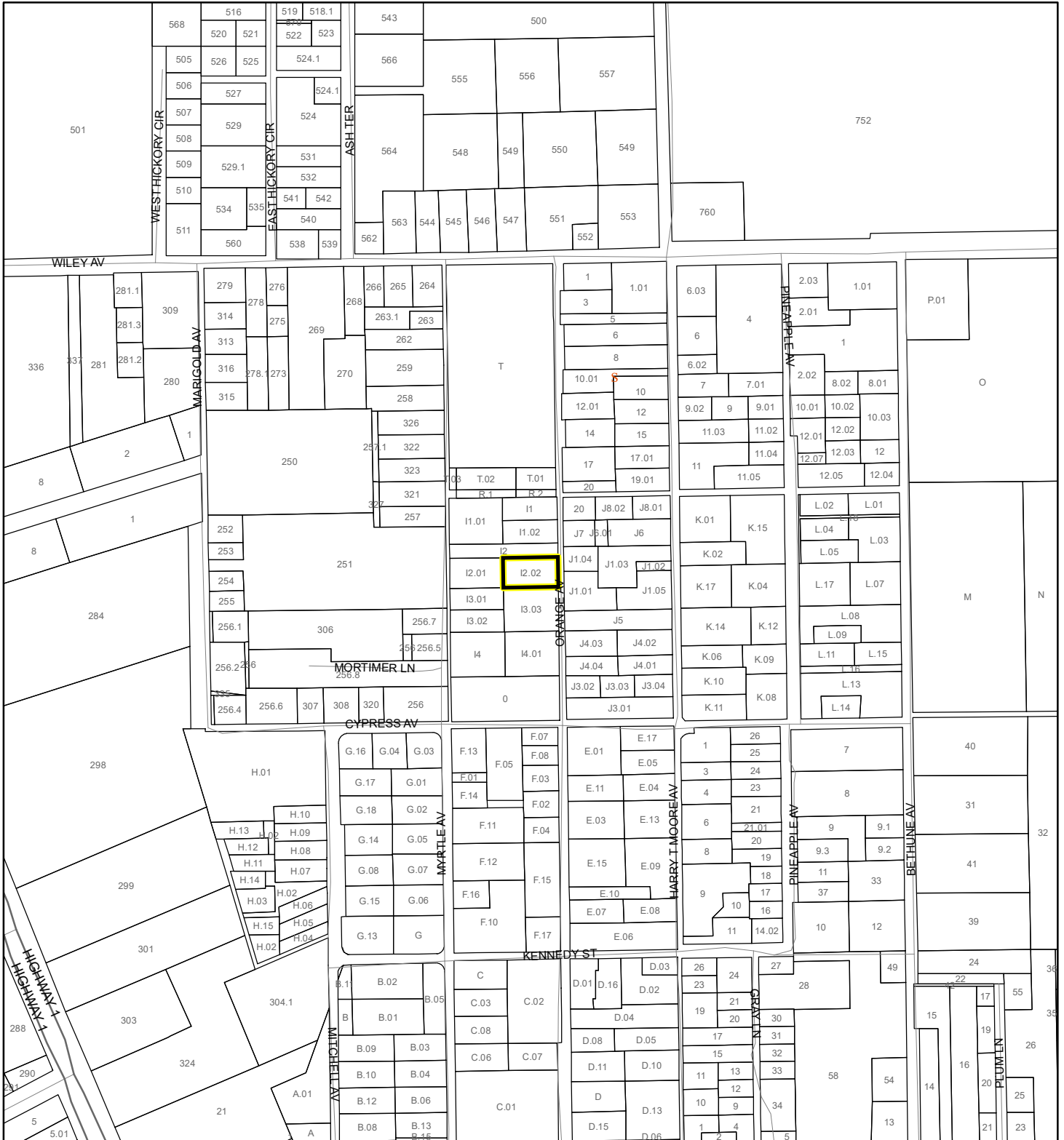

1:4,800 or 1 inch = 400 feet

Subject Property

Parcels

This map was compiled from recorded documents and does not reflect an actual survey. The Brevard County Board of County Commissioners does not assume responsibility for errors or omissions herein.

Eagle Nests  
FWS

Produced by BoCC - GIS Date: 8/27/2024



# SCRUB JAY OCCUPANCY MAP

WATKINS, KELEON R

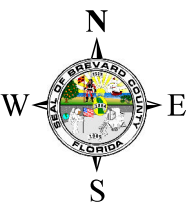
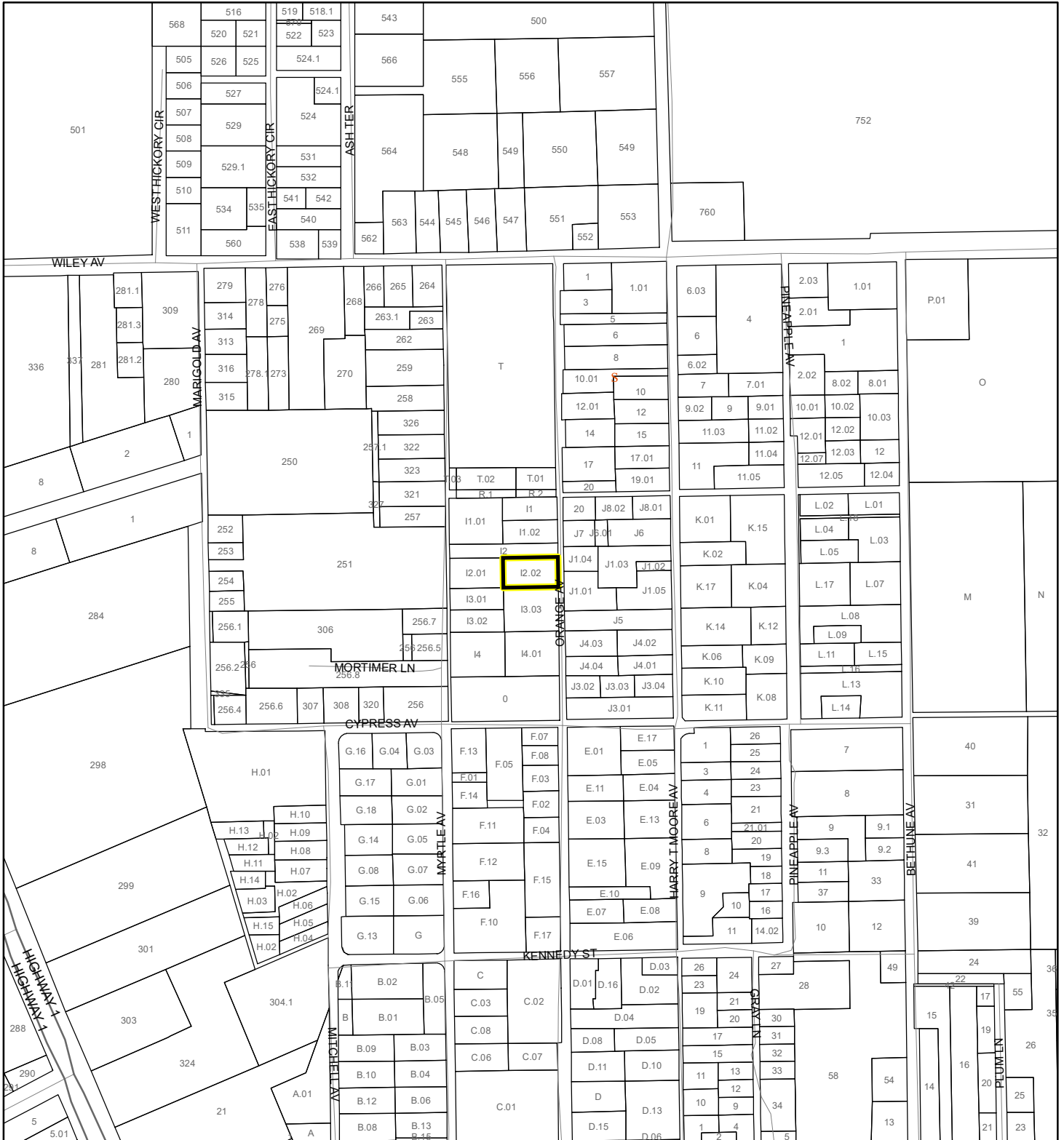

24Z00048



1:4,800 or 1 inch = 400 feet

This map was compiled from recorded documents and does not reflect an actual survey. The Brevard County Board of County Commissioners does not assume responsibility for errors or omissions hereon.

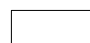
Produced by BoCC - GIS Date: 8/27/2024

-  Subject Property
-  Parcels
-  Scrub Jay Occupancy

# SJRWMD FLUCCS UPLAND FORESTS - 4000 Series MAP

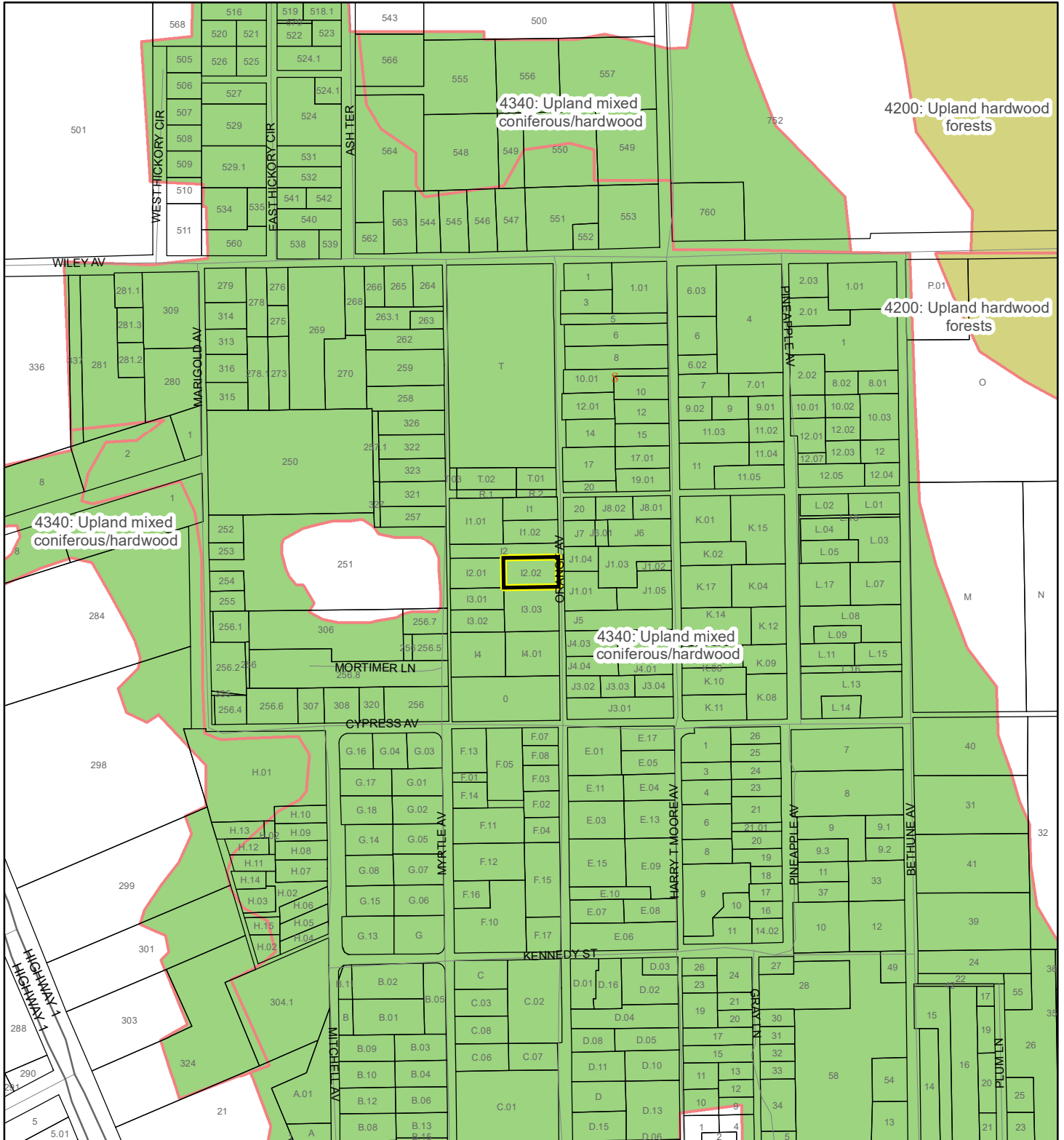

WATKINS, KELEON R

24Z00048

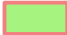
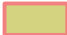

1:4,800 or 1 inch = 400 feet

## SJRWMD FLUCCS Upland Forests

-  Upland Coniferous Forest - 4100 Series
-  Upland Hardwood Forest - 4200 Series
-  Upland Mixed Forest - 4300 Series
-  Tree Plantations - 4400 Series

This map was compiled from recorded documents and does not reflect an actual survey. The Brevard County Board of County Commissioners does not assume responsibility for errors or omissions hereon.

Produced by BoCC - GIS Date: 8/27/2024

 Subject Property  Parcels