

# LOCATION MAP

HAGGARD, JEFF

23V00046

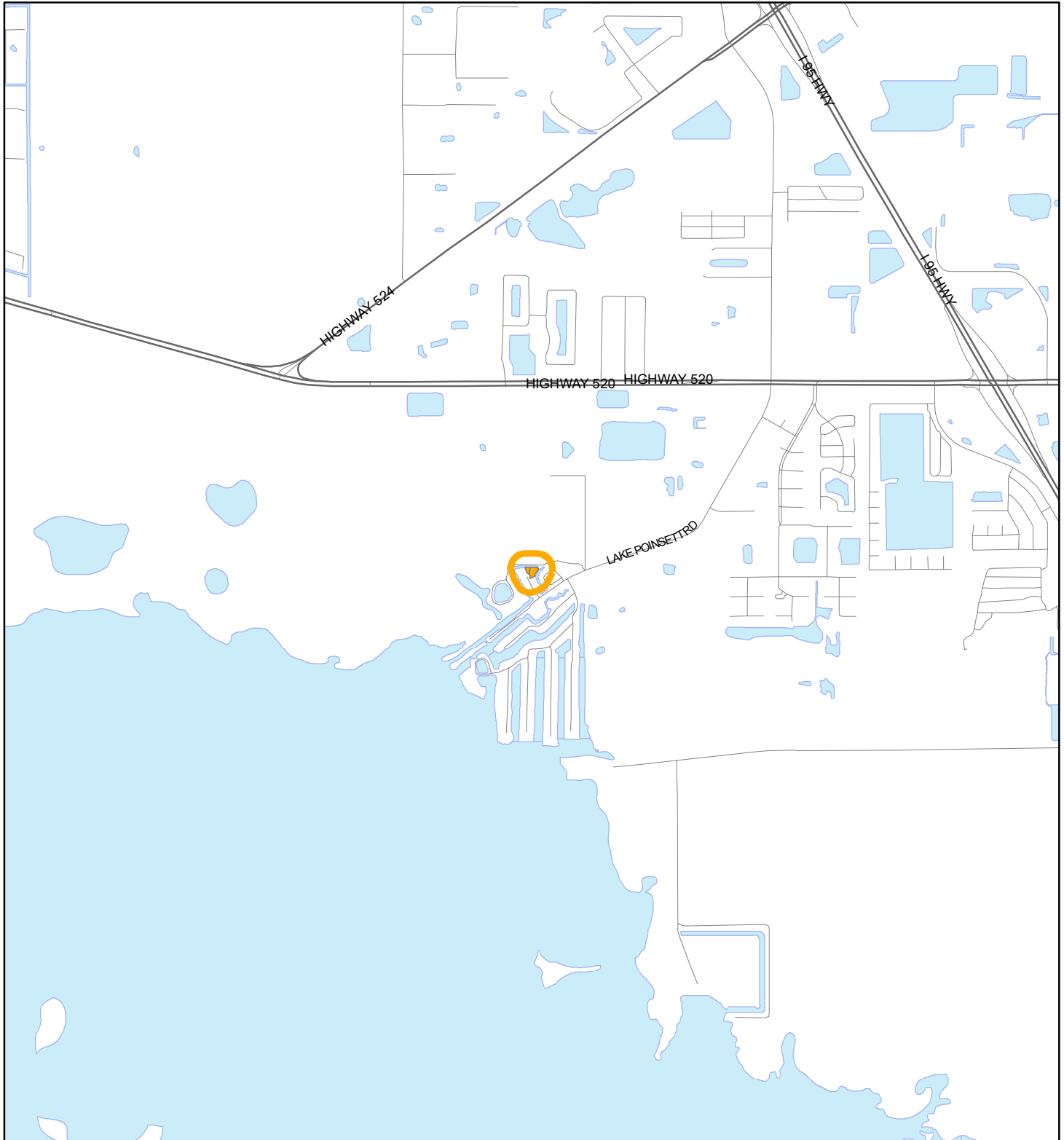



1:24,000 or 1 inch = 2,000 feet

Buffer Distance: 200 feet

This map was compiled from recorded documents and does not reflect an actual survey. The Brevard County Board of County Commissioners does not assume responsibility for errors or omissions hereon.

Produced by BoCC - GIS Date: 11/20/2023

 Buffer  
 Subject Property

# ZONING MAP

HAGGARD, JEFF

23V00046

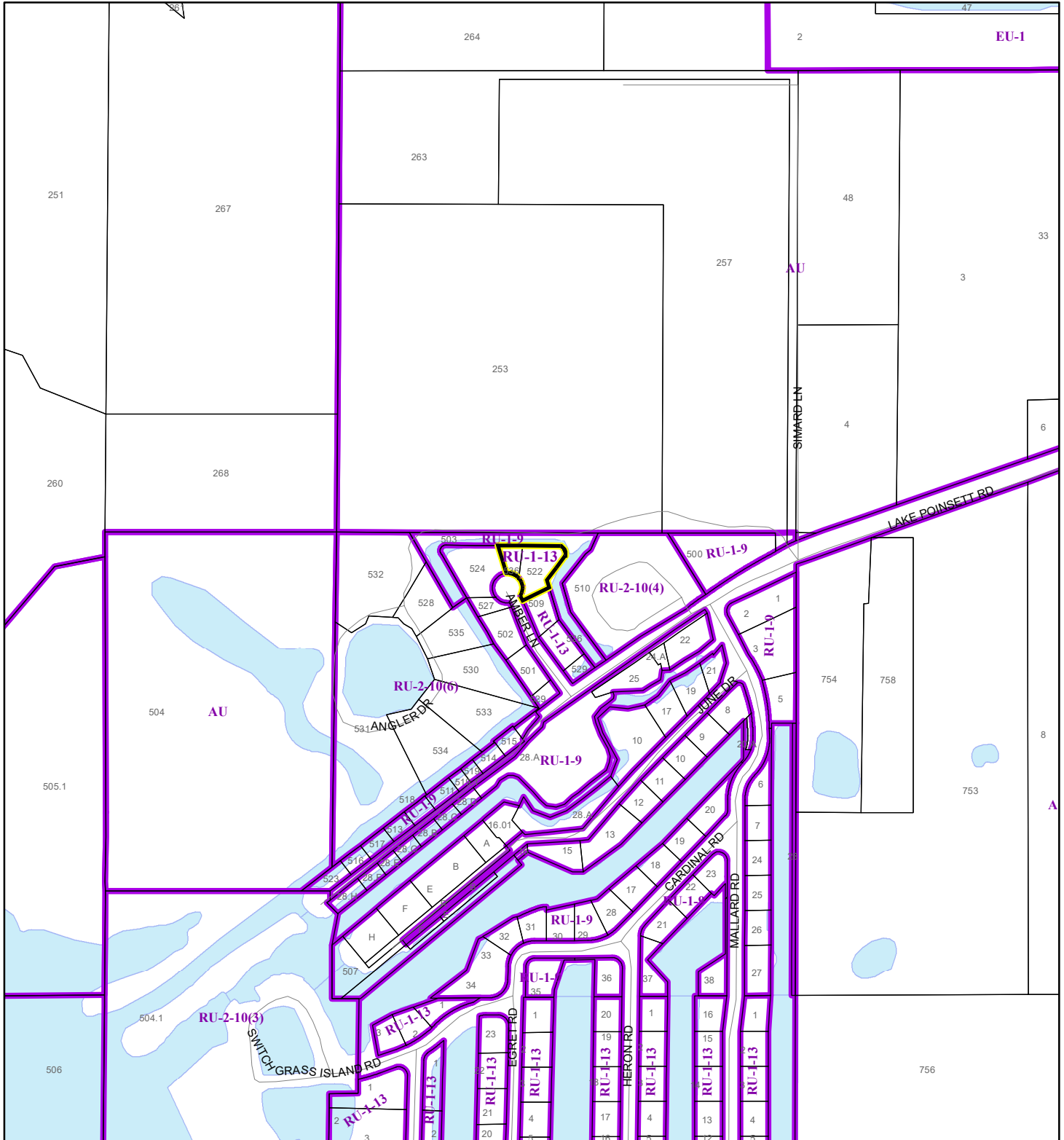

1:4,800 or 1 inch = 400 feet

This map was compiled from recorded documents and does not reflect an actual survey. The Brevard County Board of County Commissioners does not assume responsibility for errors or omissions hereon.

Produced by BoCC - GIS Date: 11/20/2023

 Subject Property

 Parcels

 Zoning



# AERIAL MAP

HAGGARD, JEFF

23V00046



1:1,200 or 1 inch = 100 feet

PHOTO YEAR: 2023

This map was compiled from recorded documents and does not reflect an actual survey. The Brevard County Board of County Commissioners does not assume responsibility for errors or omissions hereon.

Produced by BoCC - GIS Date: 11/20/2023

 Subject Property

 Parcels