

CONTR. #	INV. ±	TOP BANK	CONTR. BASIN ELEV.
1	21.5	23.5	22.2
2	22	24	22.6
3	21.8	23.7	22.6

TYPICAL ELEV. FOR CONTROL STRUCTURES

TYPICAL POND DETAIL

TYPICAL CROSS SECTION

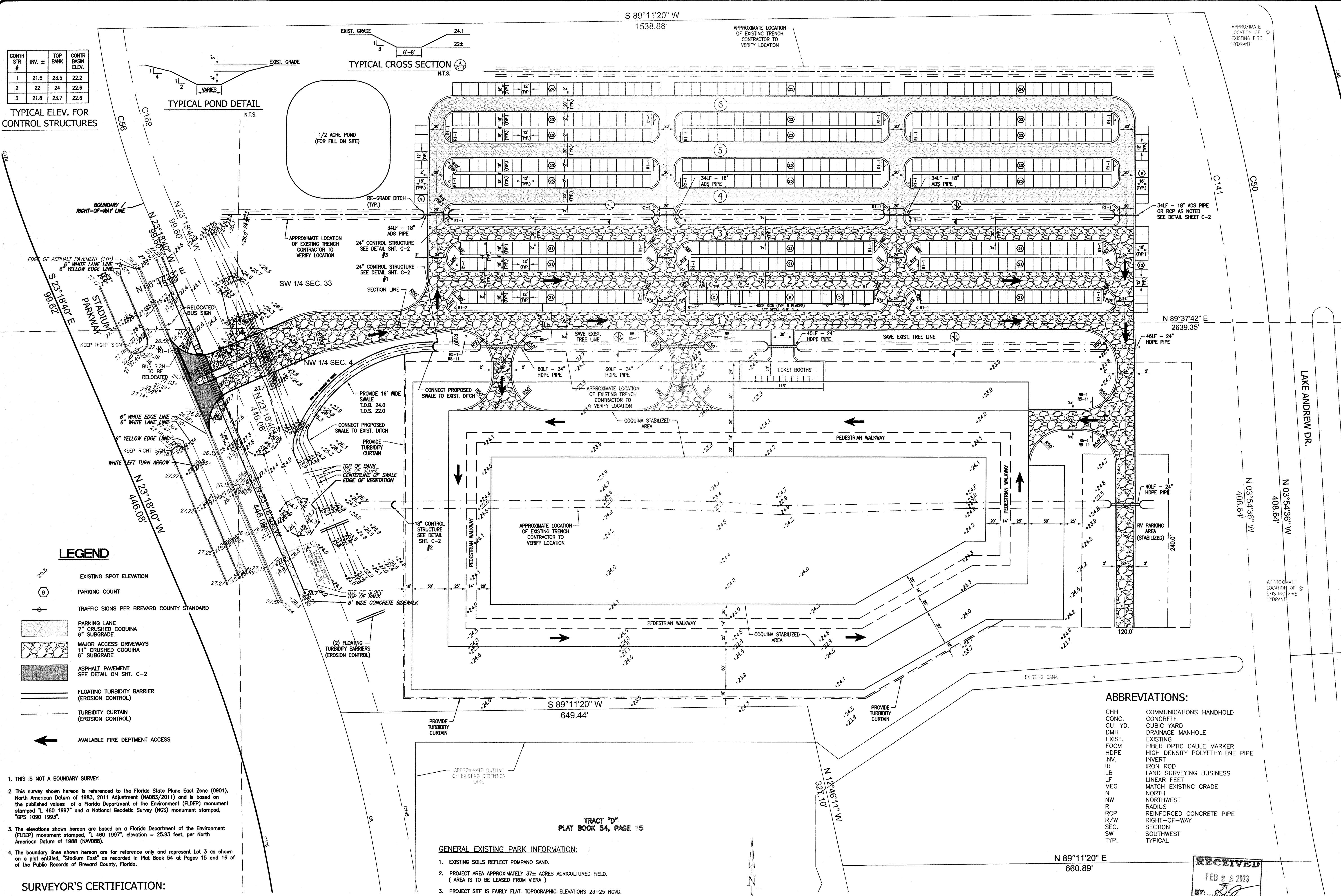

# LEGEND

- EXISTING SPOT ELEVATION
- PARKING COUNT
- TRAFFIC SIGNS PER BREVARD COUNTY STANDARD
- PARKING LANE 7" CRUSHED COQUINA 6" SUBGRADE
- MAJOR ACCESS DRIVEWAYS 11" CRUSHED COQUINA 6" SUBGRADE
- ASPHALT PAVEMENT SEE DETAIL ON SHT. C-2
- FLOATING TURBIDITY BARRIER (EROSION CONTROL)
- TURBIDITY CURTAIN (EROSION CONTROL)
- AVAILABLE FIRE DEPARTMENT ACCESS

- THIS IS NOT A BOUNDARY SURVEY.
- This survey shown hereon is referenced to the Florida State Plane East Zone (0901), North American Datum of 1983, 2011 Adjustment (NAD83/2011) and is based on the published values of a Florida Department of the Environment (FDEP) monument stamped "L 460 1997" and a National Geodetic Survey (NGS) monument stamped, "GPS 1090 1993".
- The elevations shown hereon are based on a Florida Department of the Environment (FDEP) monument stamped, "L 460 1997", elevation = 25.93 feet, per North American Datum of 1988 (NAD88).
- The boundary lines shown hereon are for reference only and represent Lot 3 as shown on a plat entitled, "Stadium East" as recorded in Plat Book 54 at Pages 15 and 16 of the Public Records of Brevard County, Florida.

## SURVEYOR'S CERTIFICATION:

I hereby certify that the attached sketch is an accurate representation of a Partial Topographic Survey, performed under my direction, in accordance with all applicable requirements of the "Standards of Practice" as described in Chapter 5J-17 Florida Administrative Code, pursuant to Chapter 472.027, Florida Statutes.

Not valid without the signature and the original raised seal of a Florida licensed surveyor and mapper.

Digitally signed by David J Irwin  
DN: c=US, o=ALLEN ENGINEERING INC., dnQualifier=A01410C00000185179F3CC  
70009176D, cn=David J Irwin  
Date: 2023.02.21 10:11:34 -05'00'

## GENERAL EXISTING PARK INFORMATION:

- EXISTING SOILS REFLECT POMPADOUR SAND.
- PROJECT AREA APPROXIMATELY 37± ACRES AGRICULTURED FIELD. (AREA IS TO BE LEASED FROM VIERA)
- PROJECT SITE IS FAIRLY FLAT. TOPOGRAPHIC ELEVATIONS 23-25 NGVD.
- NO OFF-SITE DRAINAGE INTO PARK AREA.
- APPROXIMATELY 15± ACRES TO BE LEFT IN EXISTING STATE.

## NOTES:

- COMPACT COQUINA TO 98% AASHTO T-180
- SOD SWALES VARY, TYPICALLY 2'± IN DEPTH IN MANY CROSSINGS, CULVERS WILL COMPLETELY BE IN SWALE, BELOW GROUND LINES.

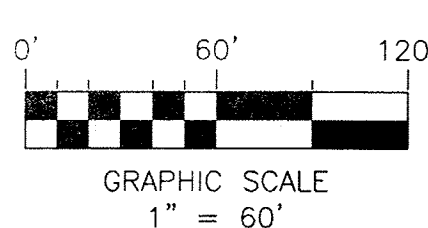

## ABBREVIATIONS:

CHH COMMUNICATIONS HANDHOLD  
CONC. CONCRETE  
CU. YD. CUBIC YARD  
DMH DRAINAGE MANHOLE  
EXIST. EXISTING  
FOCM FIBER OPTIC CABLE MARKER  
HDPE HIGH DENSITY POLYETHYLENE PIPE  
INV. INVERT  
IR IRON ROD  
LB LAND SURVEYING BUSINESS  
LF LINEAR FEET  
MEG MATCH EXISTING GRADE  
N NORTH  
NW NORTHWEST  
R RADIUS  
RCP REINFORCED CONCRETE PIPE  
R/W RIGHT-OF-WAY  
SEC. SECTION  
SW SOUTHWEST  
TYP. TYPICAL

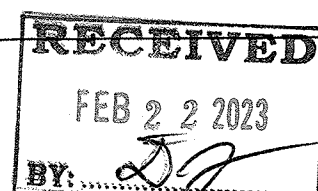

11" CRUSHED COQUINA - 4092 CU. YD. ±  
7" CRUSHED COQUINA - 1490 CU. YD. ±  
NOT INCLUDED - RV PARKING AREA  
NOT INCLUDED - PEDESTIAN WALKWAY

----- OUTLINE 10 ACRES ±  
REGULAR PARKING STALLS = 554  
HANDICAP PARKING STALLS = 10

**JOHN A. PEKAR, P.E., LLC.**  
CA#30197  
COLUMBIA COMMERCIAL PLAZA  
102 COLUMBIA DRIVE, SUITE 207  
CAPE CANAVERAL, FL, 32920  
(321) 288-1040

## Revisions/Comments:



## Cadd File Information

Cadd File: 220629 C-1  
Scale: AS NOTED

## Drawing Information

Drawn by: DPA  
Checked by: JAP  
Approved by: JAP  
Date: 01-26-2023

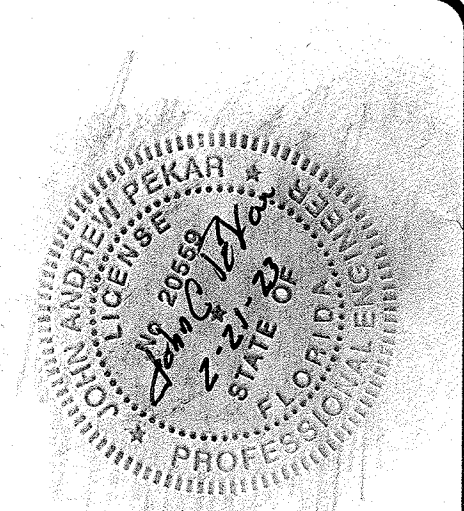
SPACE COAST  
DAILY PARK  
IMPROVEMENT PLANS  
SITE PLAN



John A. Pekar  
C.A. No. 30197  
P.E. No. 20559  
Seal

## Drawing Number

**C-1**

Drawing: 1 OF 4



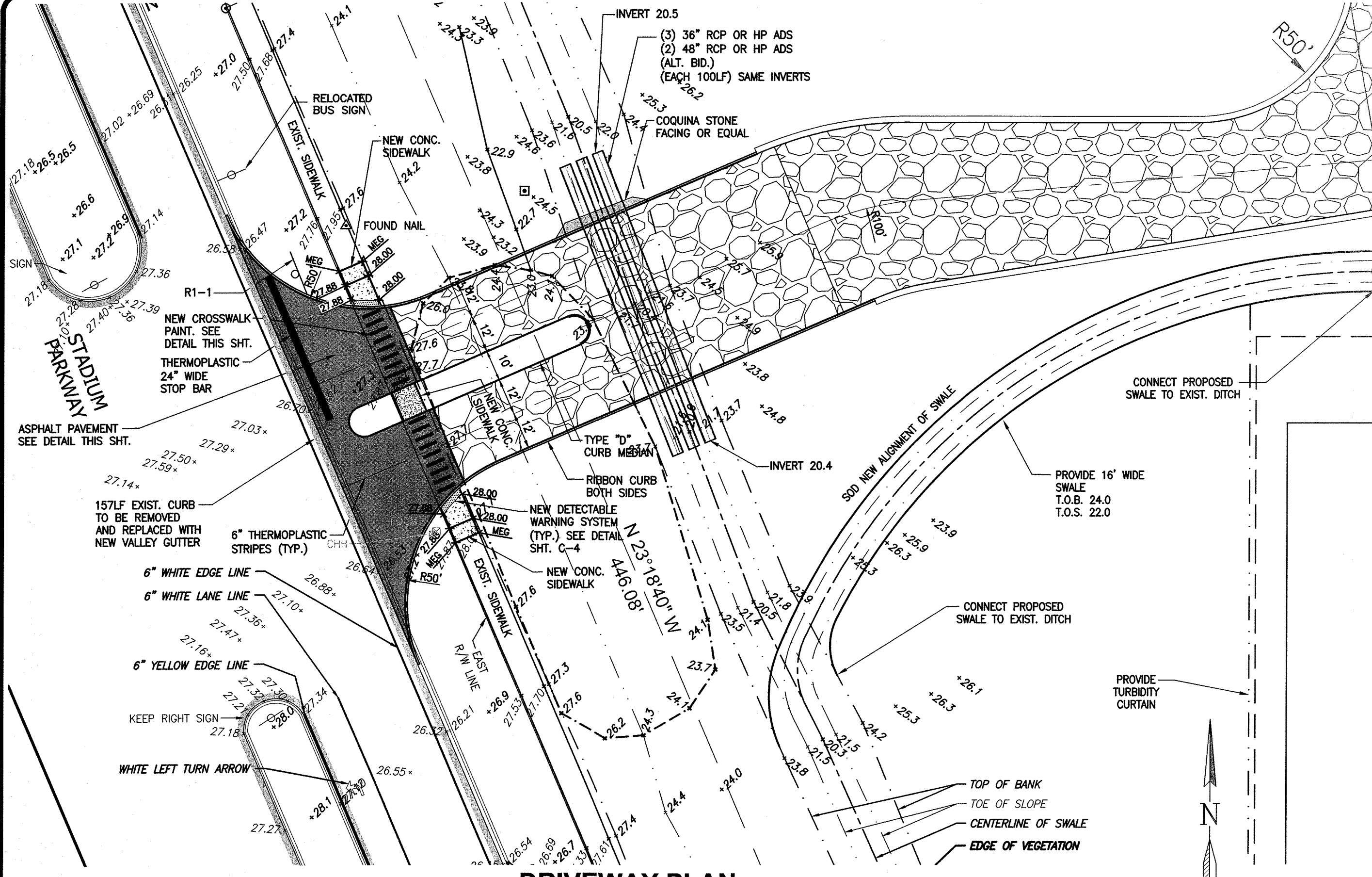

DRIVEWAY PLAN

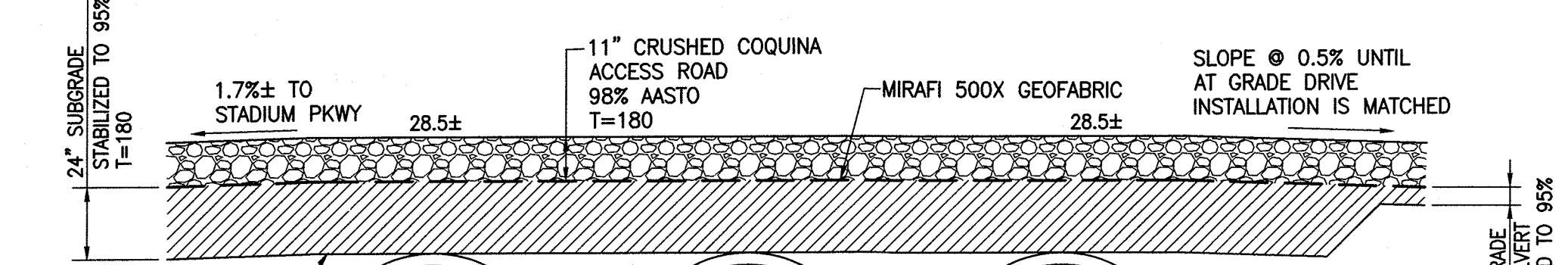

ROADWAY SECTION

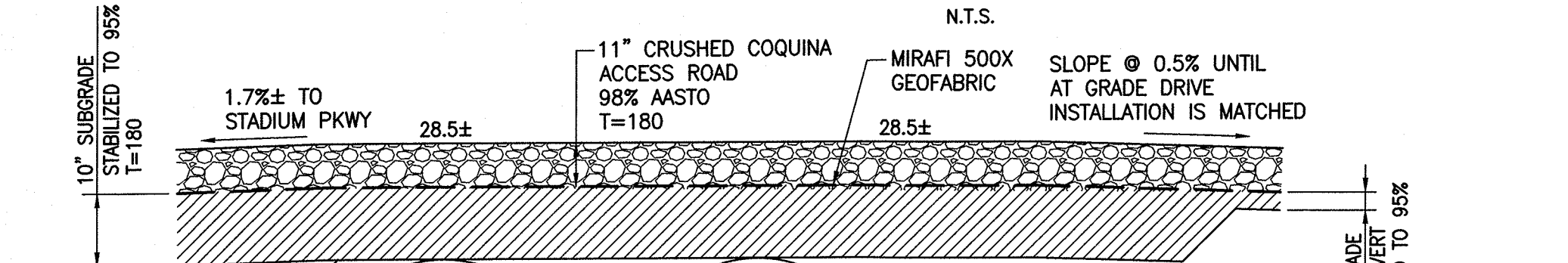

ROADWAY SECTION (ALT. BID)

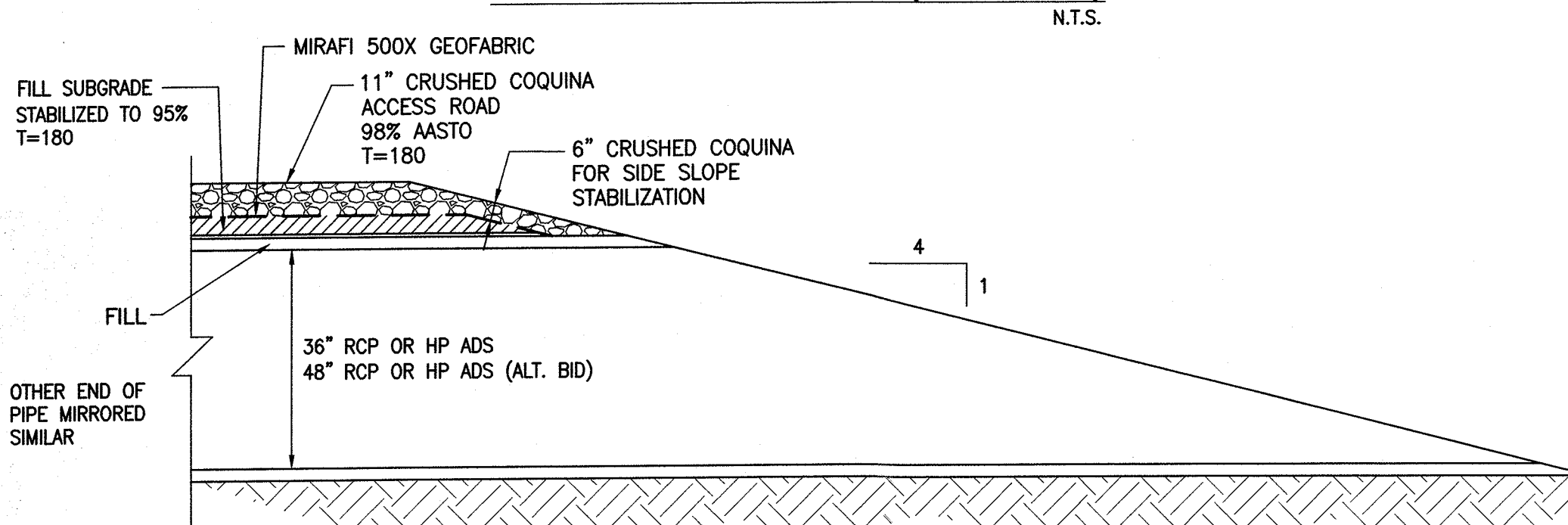

PIPE SECTION

DITCH CROSSING / CULVERT PIPE DETAIL

GENERAL NOTES: (SCALE SHOWN ON DRIVEWAY PLAN)

1. PAVING TO BE COORDINATED WITH GATE LOCATIONS.
2. REMOVE EXCESS SHELL/SAND BASE WITHIN 2 FEET OF THE BACK OF PAVEMENT. REPLACE REMOVED SHELL WITH CLEAN SAND AND SODDING.
3. CONTRACTOR TO PROVIDE EROSION CONTROL AND MOT PLAN.
4. GUTTERS ALONG STADIUM PARKWAY SHALL REMAIN SWEEP AND FREE OF ALL DEBRIS.
5. THERMOPLASTIC YELLOW STRIPPING TO BE USED FOR MEDIANS.
6. THERMOPLASTIC WHITE STRIPPING TO USED FOR LINE MARKINGS AND STOP BARS.
7. ALL THERMOPLASTIC STRIPPING TO BE INSTALLED 14 DAYS AFTER PAVING.
8. ALL SIGNS TO BE IN ACCORDANCE WITH BREVARD COUNTY STANDARD.
9. DRIVEWAY GRADES TO TIE TO F-CURB EXTENSIONS ON STADIUM PARKWAY. VARY SLOPE IN RADIUS AREAS TO MINIMIZE CUT.
10. SEVERAL PEPPER TREES HAVE BEEN REMOVED FROM SITE. TREES TO REMAIN ARE SHOWN ON DRONE PHOTOS ATTACHED TO COUNTY SUBMISSION PACKAGE.
11. WATER - FOR EACH SPECIAL EVENT THE CITY OF COCOA WILL INSTALL A TEMPORARY METER OFF EXISTING HYDRANTS ON EAST SIDE OF PROPERTY.
12. SPACE COAST DAILY PARK - THIS PARK IS PROPOSED FOR SPECIAL EVENTS WHICH INCLUDE FAIRS, CONCERTS, AND OTHER SPECIAL EVENTS. LAYOUTS ACROSS THE PARK GROUNDS WILL VARY PENDING THE NEEDS OF THE SPECIAL EVENT.

CONSTRUCTION NOTES:

1. CONTRACTOR SHALL UTILIZE EXISTING DRAINAGE FACILITIES ON SITE AND SHALL NOT ADVERSELY BLOCK EXISTING DRAINAGE WITH EXCEPTION SHORT TERM INSTALLATIONS.
2. ALL CROSS SLOPES WITHIN PARK FOR ACCESS AND PARKING LANES WILL BE 2% OR LESS. ALL PARK AREAS WILL BE AT GRADE LESS THAN 2%, FOLLOWING EXISTING GROUND.

PAVING NOTES:

1. EXISTING SHELL BASE SHALL BE REMOVED TO ALLOW FOR NEW PAVEMENT SECTION WHICH WILL CONSIST OF 2\"/>
2. TACK COAT TO BE APPLIED TO BASE PRIOR TO ASPHALT.
3. APPROVED FDOT MIX FOR 2\"/>
4. CENTER CROWN ALL DRIVEWAYS WITH 1.5% SLOPES AS SHOWN.
5. PAVE AND STRIPE. THERMOPLASTIC STRIPING SHALL BE APPLIED TO ASPHALT 14 DAYS AFTER PAVING.
6. 8\"/>
7. ASPHALT TO FEATHER DOWN TO MATCH TOP OF SIDEWALK WITHOUT CREATING A BUMP.
8. VARY CROSS SLOPES TO CONFORM TO GUTTER AND MINIMIZE CUT.
9. HANDICAP PARKING AREA TO BE COMPACTED COQUINA, 7\"/>

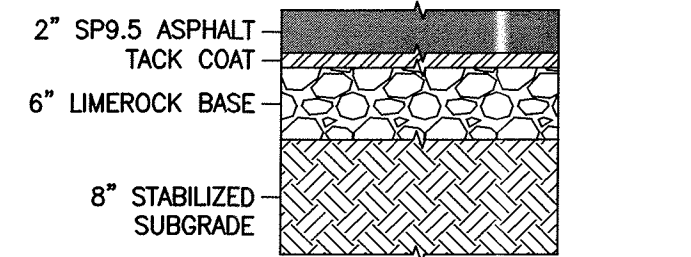

PAVEMENT DETAIL

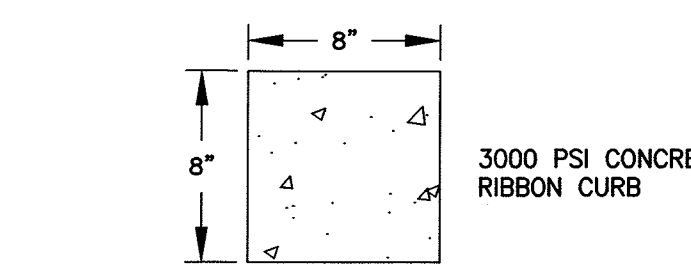

CURB DETAIL

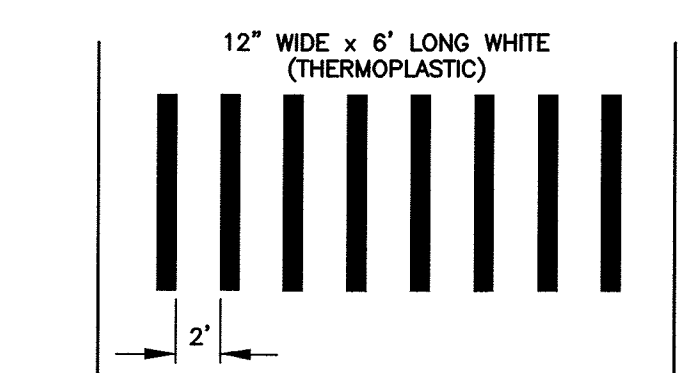

CROSS WALK PAINT DETAIL

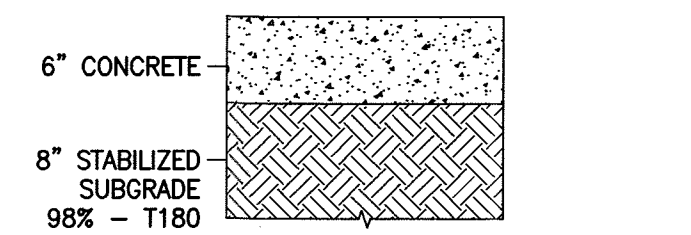

CONCRETE PAVING DETAIL

(ALTERNATE BID ITEM) N.T.S.  
CONTRACTOR TO FIRST PROVIDE JOINT SPACING

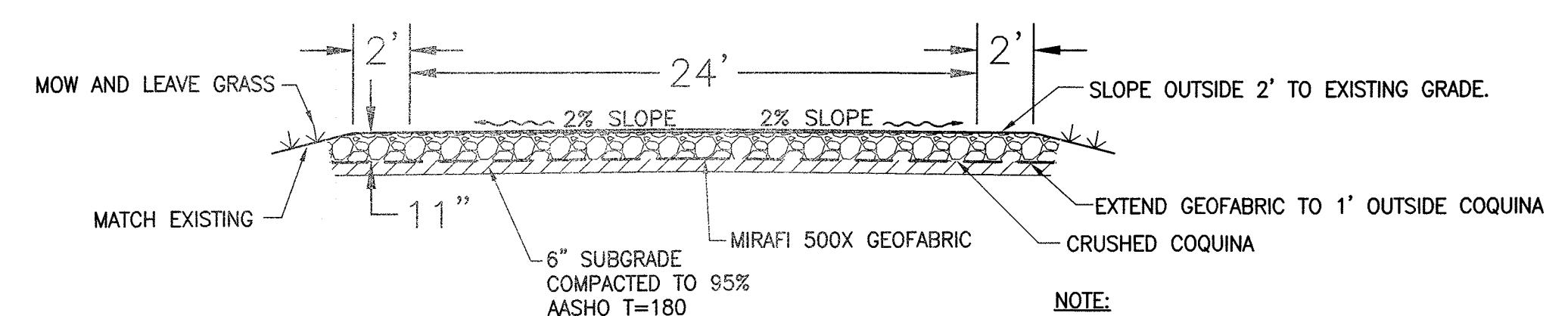
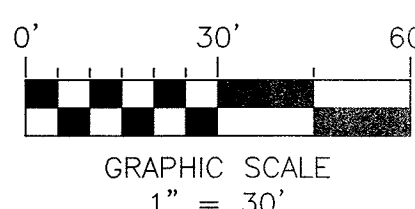

MAJOR ACCESS DRIVE

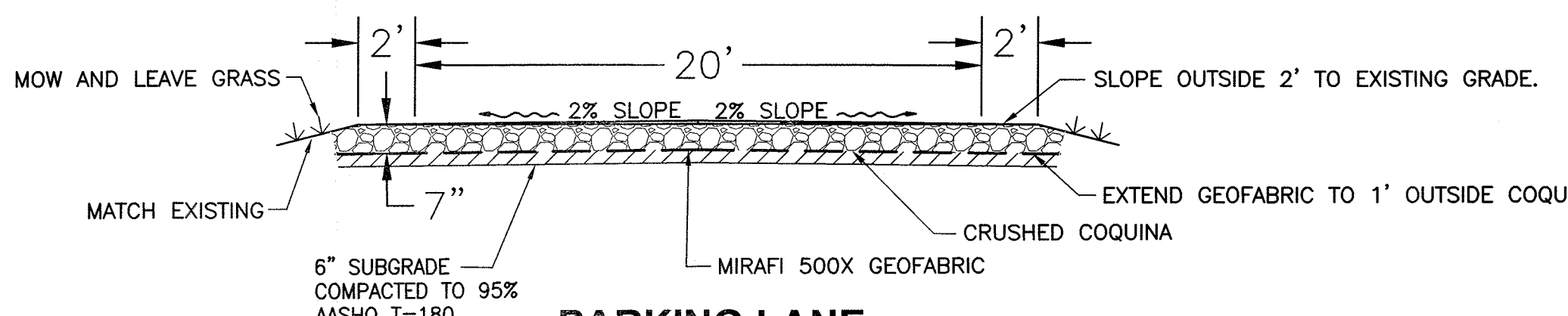

PARKING LANE

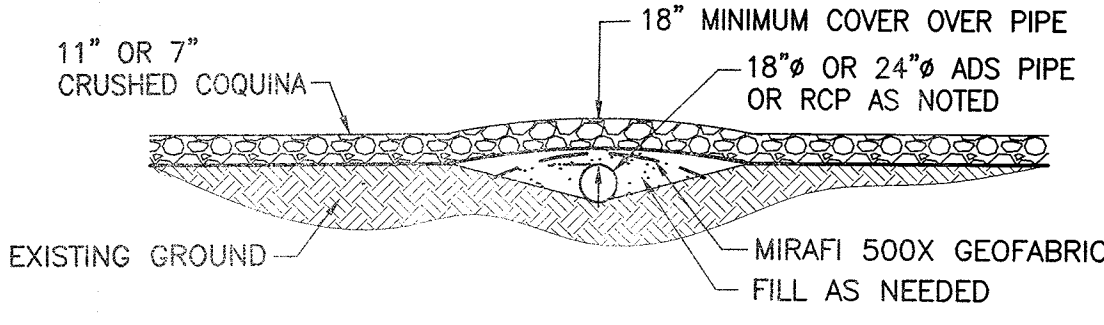

TYPICAL SWALE CROSSING WITH CULVERTS

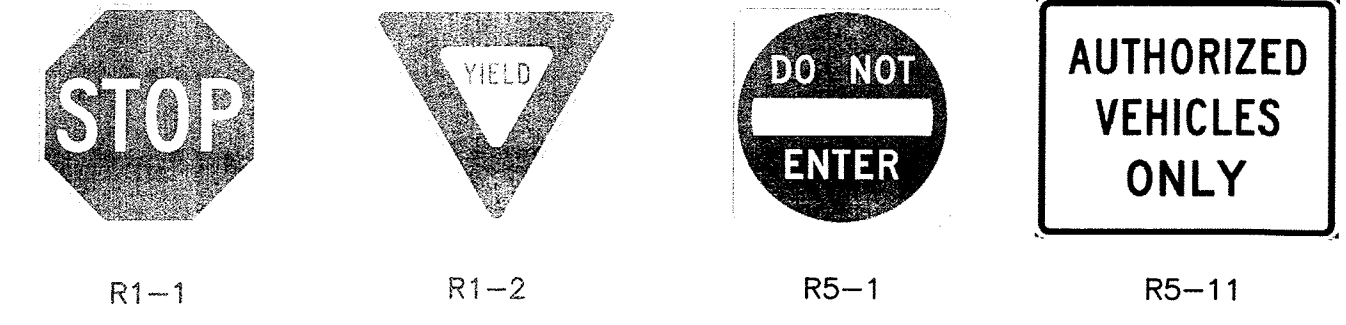

TRAFFIC SIGNS

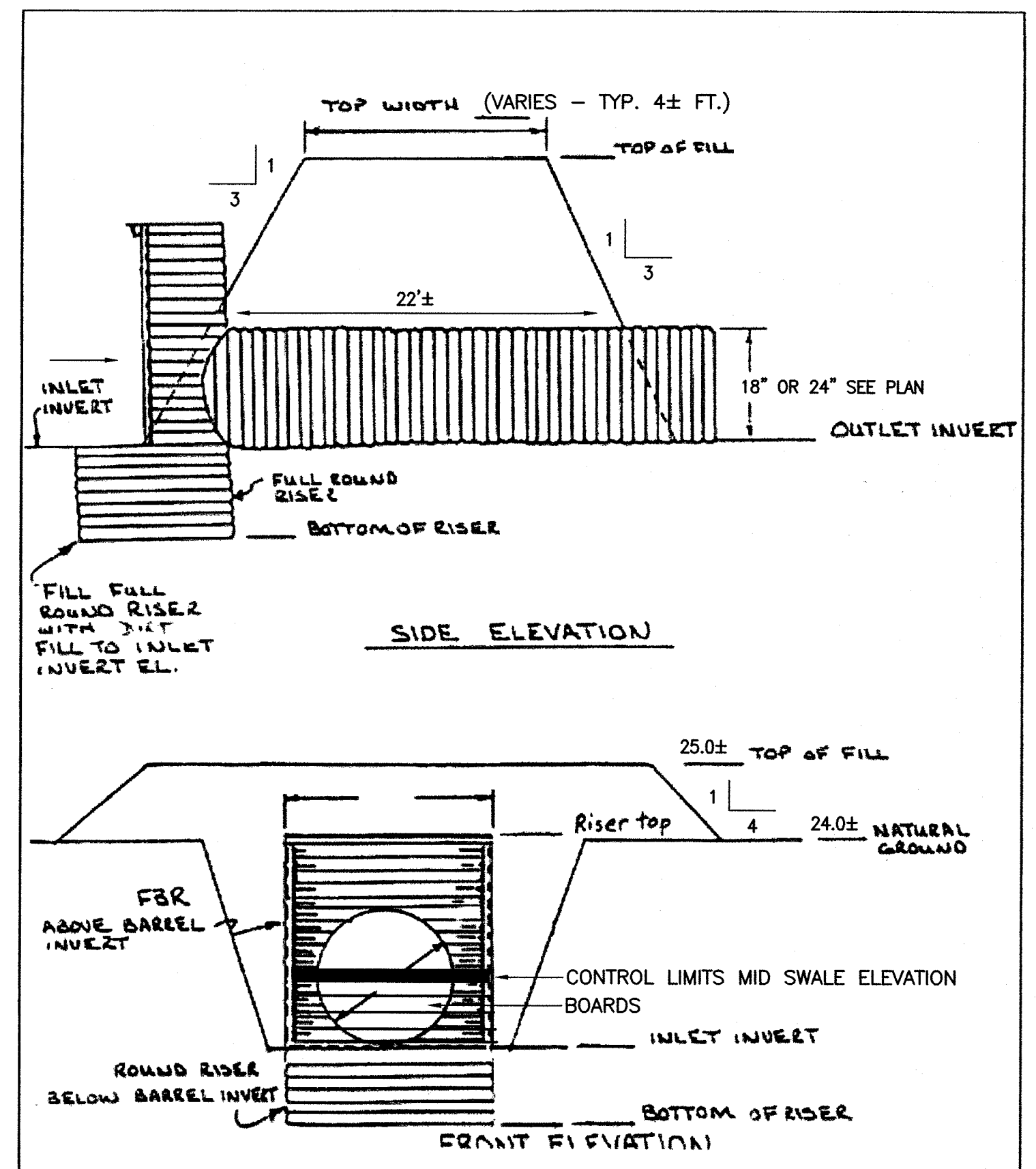
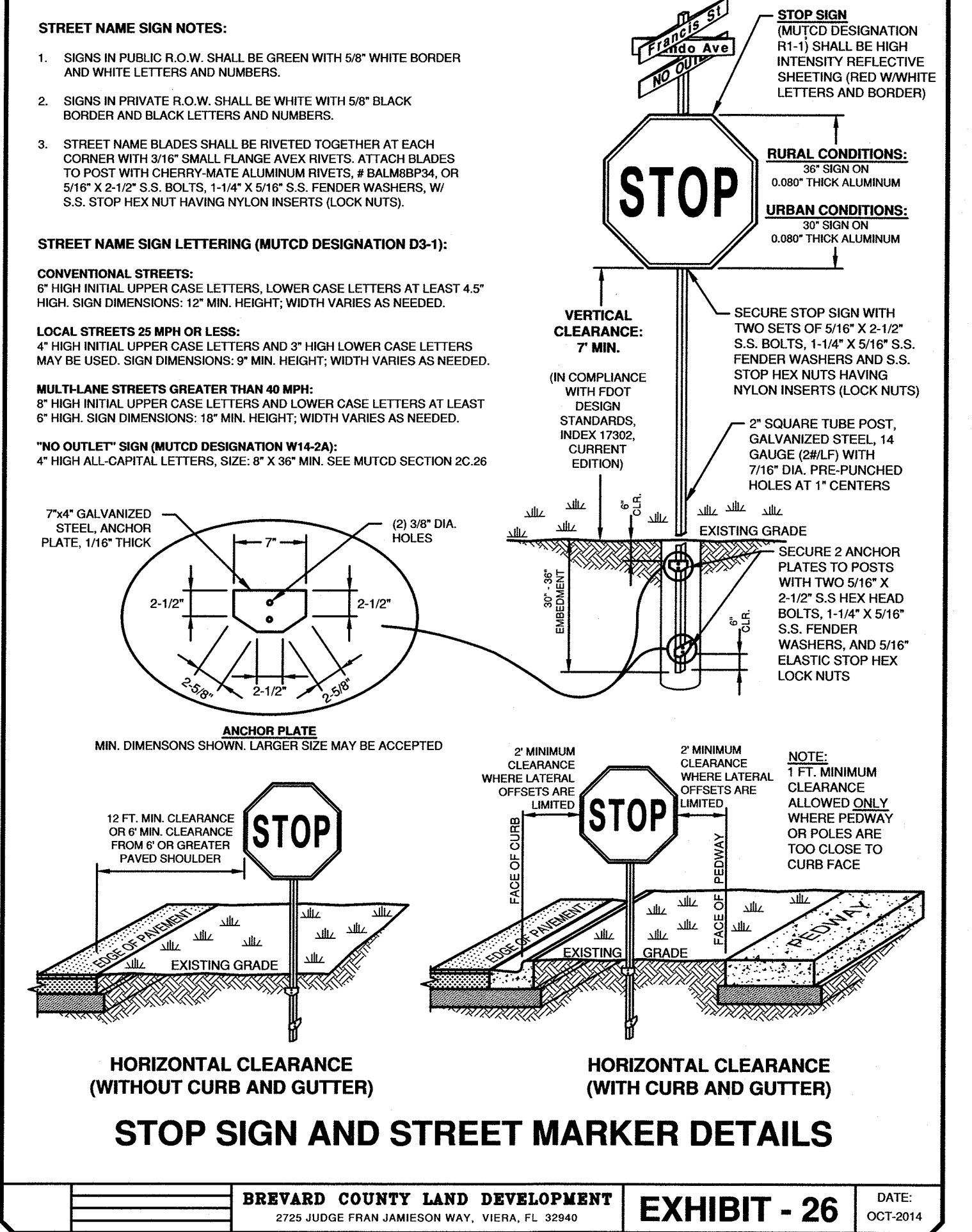

RISER-BOARD WATER CONTROL STRUCTURE

JOHN A. PEKAR, P.E., LLC.  
CA#30197  
COLUMBIA COMMERCIAL PLAZA  
102 COLUMBIA DRIVE, SUITE 207  
CAPE CANAVERAL, FL, 32920  
(321) 288-1040

Revisions/Comments:

Cadd File Information  
Cadd File: 220029 C-1  
Scale: AS NOTED

Drawing Information  
Drawn by: DPA  
Checked by: JAP  
Approved by: JAP  
Date: 01-26-2023

SPACE COAST  
DAILY PARK  
IMPROVEMENT PLANS  
TYPICAL  
CROSS SECTIONS

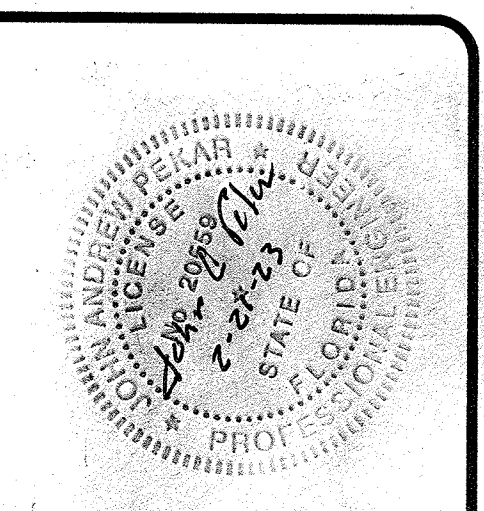

John A. Pekar  
Seal

Drawing Number

C-2

Drawing: 2 Of: 4



BREVARD COUNTY PUBLIC WORKS ENGINEERING STANDARD DEVELOPMENT NOTES

GENERAL

1. ALL CONSTRUCTION SHALL CONFORM TO FDOT DESIGN STANDARDS (LATEST EDITION), FDOT STANDARD SPECIFICATIONS FOR ROAD & BRIDGE CONSTRUCTION (LATEST EDITION), BREVARD COUNTY UTILITY SERVICES CRITERIA FOR WATER AND SANITARY SEWER SYSTEMS, AND BREVARD COUNTY CODE OF ORDINANCES.
2. ISSUANCE OF CERTIFICATE OF COMPLETION: UPON COMPLETION OF CONSTRUCTION OF THE PROJECT AND PRIOR TO SCHEDULING OF THE FINAL INSPECTION, THE APPLICANT OR THEIR AUTHORIZED REPRESENTATIVE, SHALL PROVIDE THE FOLLOWING DOCUMENTATION TO BREVARD COUNTY PUBLIC WORKS ENGINEERING:
- a. A CERTIFICATE OF COMPLETION - REQUEST FOR FINAL INSPECTION FORM. THE FORM MUST BE FROM A PROFESSIONAL ENGINEER LICENSED IN THE STATE OF FLORIDA WITH THEIR SEAL AFFIXED. THE FORM CERTIFIES THAT THE IMPROVEMENTS HAVE BEEN CONSTRUCTED IN CONFORMANCE WITH THE APPROVED CONSTRUCTION PLANS AND SPECIFICATIONS.
- b. A COMPLETE SET OF TESTING REPORTS FOR ALL TESTS PERFORMED ON THE PROJECT WITHIN THE COUNTY RIGHT-OF-WAY AND/OR FOR ALL SUBDIVISION CONSTRUCTION REGARDLESS OF PUBLIC OR PRIVATE.
- c. THREE SETS OF AS-BUILT DRAWINGS MEETING THE REQUIREMENTS OF SECTION 61017, F.A.C., AND SIGNED AND SEALED BY A SURVEYOR LICENSED IN THE STATE OF FLORIDA. AT A MINIMUM, ALL AS-BUILT DRAWINGS MUST INCLUDE:
- i. ROAD/PAVEMENT ELEVATIONS; ROADWAY CROSS SLOPES; PAVEMENT WIDTH; PAVEMENT SPOT ELEVATIONS NECESSARY TO CONFIRM STORMWATER DRAINAGE PATTERNS AT INTERSECTIONS AND SIDEWALKS; CURB SLOPES;
- ii. STORMWATER PIPE SIZES AND INVERT ELEVATIONS; LOCATION OF OUTFALL STRUCTURE(S) WITH AS-BUILT ELEVATIONS FOR ALL CONTROL STRUCTURE & SKIMMER ELEVATIONS SHOWN ON THE APPROVED PLANS; TOP OF BANK, GRADE BREAKS, BOTTOM ELEVATIONS FOR ALL STORMWATER PONDS OR BERM AREAS;
- iii. ANY OTHER ADDITIONAL AS-BUILT DATA THAT IS APPLICABLE TO THE PROJECT TO ENSURE COMPLETION IN ACCORDANCE WITH THE APPROVED CONSTRUCTION PLANS.
- d. PIPE INSPECTION VIDEO PER FDOT REQUIREMENTS. (IF APPLICABLE PER NOTE 4 OF DRAINAGE NOTES)
- e. IF A MUNICIPALITY IS ACCEPTING A PUBLIC WATER AND/OR SEWER SYSTEM, THERE MUST BE DOCUMENTATION INDICATING MUNICIPAL ACCEPTANCE OF THE CONSTRUCTION OF THE WATER AND/OR SEWER SYSTEM.
- f. PUBLIC WORKS ENGINEERING WILL NOT SIGN OFF ON A TEMPORARY CERTIFICATE OF OCCUPANCY (TCO) FROM THE BREVARD COUNTY BUILDING DEPARTMENT UNTIL THE AS-BUILT DRAWINGS AND OTHER DOCUMENTATION LISTED ABOVE HAVE BEEN SUBMITTED AND REVIEWED BY PUBLIC WORKS ENGINEERING.
- g. PROJECTS CONNECTED TO THE BREVARD COUNTY WATER, SANITARY SEWER, AND/OR RECLAIMED WATER SYSTEMS MUST OBTAIN FINAL APPROVAL FOR THE PROJECT DIRECTLY FROM BREVARD COUNTY UTILITY SERVICES AS OUTLINED IN THE BREVARD COUNTY CRITERIA FOR WATER AND SANITARY SEWERAGE SYSTEMS.
3. UPON APPROVAL OF FINAL INSPECTION, AN ENGINEER'S CERTIFIED COST ESTIMATE WILL BE REQUIRED ALONG WITH A 2-YEAR MAINTENANCE BOND FOR ALL IMPROVEMENTS WITHIN THE COUNTY RIGHT-OF-WAY AS REQUIRED BY CHAPTER 86 OF THE BREVARD COUNTY CODE OF ORDINANCES. THE MAINTENANCE BOND SHALL BE 25% OF THE ENGINEER'S CERTIFIED COST ESTIMATE.
4. THE CONTRACTOR IS RESPONSIBLE FOR ALL DAMAGE TO THE COUNTY INFRASTRUCTURE DURING CONSTRUCTION. THIS INCLUDES, BUT IS NOT LIMITED TO, THE STRUCTURAL INTEGRITY OF THE ROADWAY ASPHALT, BASE, AND STABILIZED SUB-BASE, SIDEWALKS, STORMWATER DRAINAGE SYSTEM, DRAINAGE STRUCTURES, CURBS, GROUND COVER, WATER SYSTEMS, SANITARY SEWER SYSTEMS, AND RECLAIMED WATER SYSTEMS. ALL REPAIRS SHALL BE COMPLETED IN ACCORDANCE WITH FDOT AND BREVARD COUNTY STANDARDS. ALL REPAIRS SHALL BE COMPLETED PRIOR TO THE FINAL INSPECTION OF THE PROJECT. SIDEWALK PATCHING WILL NOT BE ACCEPTABLE.
5. A VISUAL OR MECHANICAL INTERIOR INSPECTION OF EXISTING CULVERTS WILL BE REQUIRED PRIOR TO THE FINAL INSPECTION.
6. ALL DISTURBED AREAS WITHIN THE COUNTY RIGHT-OF-WAY SHALL BE SODDED. SEED & MULCH IS NOT ACCEPTABLE. SOD SHALL MATCH EXISTING SOD TYPE. BAHIA SOD SHALL BE USED IN AREAS ADJACENT TO VACANT PROPERTY. DISTURBED AREAS OUTSIDE THE CONSTRUCTION LIMITS WILL BE SODDED AT THE CONTRACTOR'S EXPENSE.
7. THE CONTRACTOR SHALL BE RESPONSIBLE FOR THE PROTECTION OF ALL SURVEY MONUMENTATION. ANY SURVEY MONUMENTATION DISTURBED OR DESTROYED DURING CONSTRUCTION SHALL BE REPLACED BY A FLORIDA LICENSED SURVEYOR PRIOR TO ISSUANCE OF A CERTIFICATE OF COMPLETION FOR THE PROJECT.
8. REGARDLESS OF PRIVATE OR PUBLIC DEDICATION, THERE SHALL BE NO UTILITY CONNECTIONS OR METER BOXES WITHIN PROPOSED OR EXISTING SIDEWALKS OR DRIVEWAY AREAS.
9. ALL DIRECTIONAL BORES SHALL BE IN ACCORDANCE WITH FDOT STANDARD SPECIFICATIONS FOR ROAD AND BRIDGE CONSTRUCTION SECTION 555, DIRECTIONAL BORES AND THE FDOT UTILITIES ACCOMMODATION MANUAL.
10. ALL DIRECTIONAL BORES MUST EXTEND A MINIMUM OF EIGHT(8) FEET PAST THE EDGE OF PAVEMENT OF ANY ROADWAY OR COMMERCIAL DRIVEWAY. FOR RESIDENTIAL DRIVEWAYS AND SIDEWALKS, THE BORE MUST EXTEND THREE (3) FEET PAST THE EDGE ON EITHER SIDE.
11. THE CONTRACTOR SHALL CONTROL SOD GENERATED BY THIS PROJECT AT ALL TIMES, SHALL PROVIDE STREET SWEEPING AS REQUIRED, AND PREVENT SEDIMENT FROM ENTERING INTO THE EXISTING DRAINAGE SYSTEM AT ALL TIMES.
12. THE CONTRACTOR SHALL NOT EXCEED NOISE LEVELS AS SPECIFIED IN BREVARD COUNTY CODE OF ORDINANCES SECTION 62-2271.
13. ALL STRIPING AND PAVEMENT MARKINGS IN THE COUNTY RIGHT-OF-WAY SHALL BE THERMOPLASTIC AND SHALL NOT BE APPLIED UNTIL A MINIMUM OF 30 DAYS AFTER THE PLACEMENT OF THE FINAL ASPHALT SURFACE. IN THE INTERIM, STRIPING SHALL BE PAINT AND ANY REQUIRED RPM'S INSTALLED PER THE PLANS. DO NOT STRIPE ACROSS MANHOLE LIDS OR DRAINAGE GRATES.
14. REFLECTIVE PAVEMENT MARKINGS (RPM'S) SHALL BE INSTALLED IN ALL LOCATIONS AS REQUIRED BY FDOT DESIGN STANDARD,( LATEST EDITION)
15. ANY PAVEMENT MARKINGS AND RPM'S THAT ARE DESTROYED, DAMAGED, OR DIMINISHED BY CONSTRUCTION ACTIVITIES FOR UP TO 500 FEET IN EITHER DIRECTION BEYOND THE LIMITS OF CONSTRUCTION SHALL BE REPLACED OR REFURBISHED BY THE CONTRACTOR.
16. THE CONTRACTOR SHALL BE RESPONSIBLE FOR THE MAINTENANCE OF THE COUNTY RIGHT-OF-WAY FOR THE DURATION OF CONSTRUCTION. AT A MINIMUM, THE CONTRACTOR SHALL MOW THE RIGHT-OF-WAY ON AN AS NEEDED BASIS AND MAINTAIN THE DRAINAGE CONVEYANCE SYSTEM. ADDITIONAL MAINTENANCE MAY BE REQUIRED ON A CASE BY CASE BASIS.

TRAFFIC CONTROL

1. MOT PLAN REVIEW: A PROJECT-SPECIFIC MAINTENANCE OF TRAFFIC (MOT) PLAN OR ROADWAY CLOSURE MOT/DETOUR PLAN MUST BE SUBMITTED TO BREVARD COUNTY TRAFFIC OPERATIONS (321-633-2077) FOR APPROVAL A MINIMUM OF TWO (2) WEEKS PRIOR TO START OF CONSTRUCTION. THE MOT PLAN SHALL BE IN ACCORDANCE WITH MANUAL ON UNIFORM TRAFFIC CONTROL DEVICES (MUTCD) AND FDOT STANDARD INDEX 600 SERIES,( LATEST EDITIONS). PORTABLE CHANGEABLE MESSAGE SIGNS (PCMS OR VMS) MAY BE REQUIRED TO SUPPLEMENT THE STANDARD MOT SIGNAGE.
2. ROAD CLOSURES: THE CONTRACTOR SHALL NOTIFY BREVARD COUNTY TRAFFIC OPERATIONS (321-633-2077) A MINIMUM OF TWO (2) WEEKS IN ADVANCE OF THE PROPOSED START DATE OF CONSTRUCTION WITHIN THE RIGHT-OF-WAY, FOR EACH PHASE OF CONSTRUCTION, IF APPLICABLE. CONSTRUCTION SHALL NOT BEGIN UNTIL THE MOT PLAN IS APPROVED AND NOTIFICATIONS HAVE BEEN SENT TO AFFECTED AGENCIES. CERTAIN LOCATIONS MAY REQUIRE WORK IN THE RIGHT-OF-WAY TO BE PERFORMED AT NIGHT ONLY.

3. LANE CLOSURES: THE CONTRACTOR SHALL NOTIFY BREVARD COUNTY TRAFFIC OPERATIONS (321-633-2077) A MINIMUM OF ONE (1) WEEK IN ADVANCE OF THE PROPOSED START DATE OF CONSTRUCTION WITHIN THE RIGHT-OF-WAY. CONSTRUCTION SHALL NOT BEGIN UNTIL THE MOT PLAN IS APPROVED AND NOTIFICATIONS HAVE BEEN SENT TO AFFECTED AGENCIES. NO LANE CLOSURES WILL BE PERMITTED DURING PEAK HOUR TRAFFIC VOLUMES.
4. ALL TRAFFIC CONTROL DEVICES SHALL MEET THE REQUIREMENTS OF THE MUTCD FOR STREETS AND HIGHWAYS, FDOT STANDARDS (LATEST EDITIONS), AND BREVARD COUNTY LAND DEVELOPMENT EXHIBIT #26.

DRAINAGE - ROADWAYS

1. ALL DRAINAGE SYSTEM CONSTRUCTION SHALL CONFORM TO FDOT STANDARD SPECIFICATIONS AND FDOT DESIGN STANDARDS,( LATEST EDITIONS).
2. ALL RETICULINE STEEL GRATES SHALL BE HOT DIPPED GALVANIZED AND HAVE A TRAFFIC BEARING H-20 LOAD RATING.
3. ALL GRATES UTILIZED WITHIN THE COUNTY RIGHT-OF-WAY SHALL BE TRAFFIC BEARING H-20 LOADING.
4. ALL STORMWATER PIPING WITHIN THE ROAD RIGHT-OF-WAY, REGARDLESS OF PUBLIC OR PRIVATE, OR STORMWATER PIPING THAT CONVEYS STORMWATER UNDER THE ROADWAY BETWEEN STORMWATER TREATMENT PONDS, SHALL BE INSPECTED PER SECTIONS 430-4.8, 430-4.8.1, AND 430-4.8.2 OF THE FDOT STANDARD SPECIFICATIONS FOR ROAD AND BRIDGE CONSTRUCTION,(LATEST EDITION). A COPY OF THE PIPE VIDEO SHALL BE PROVIDED TO THE COUNTY AS PART OF THE SUBMITTAL OF THE CERTIFICATION OF COMPLETION REQUEST FOR FINAL INSPECTION. THE COUNTY SHALL BE NOTIFIED ONE WEEK PRIOR TO THE START OF THE PIPE VIDEO INSPECTION PROCESS.
5. ALL OPEN CUTS SHALL CONFORM TO LAND DEVELOPMENT EXHIBIT #25. FOR ALL OPEN CUTS, THE FLOWABLE FILL AND TEMPORARY ASPHALT SHALL BE INSTALLED WITHIN TWO (2) DAYS OF THE EXCAVATION (UNLESS OTHERWISE APPROVED IN WRITING BY BREVARD COUNTY PUBLIC WORKS ENGINEERING). PERMANENT ASPHALT INCLUDING MILLING AND RESURFACING, IF NEEDED, SHALL BE COMPLETED WITHIN THIRTY (30) DAYS OF EXCAVATION.
6. THE CONTRACTOR SHALL REMOVE THE SHOULDER OF THE ROADWAY TO A POINT WHERE THE BASE MATERIAL OF THE EXISTING ROADWAY MEETS THE MINIMUM THICKNESS OF THE PROPOSED ROADWAY/COMMERCIAL DRIVEWAY CONNECTION.

CONCRETE PAVING AND SIDEWALK

1. ALL DRIVEWAYS SHALL BE CONSTRUCTED PER FDOT INDEX 515 AND/OR BREVARD COUNTY STANDARD EXHIBITS UNLESS OTHERWISE NOTED.
2. ALL CONCRETE SHALL MEET FDOT DESIGN MIX AND SPECIFICATIONS. CURING METHOD SHALL BE IN ACCORDANCE WITH THE FDOT SPECIFICATIONS FOR ROAD AND BRIDGE CONSTRUCTION,(LATEST EDITION).
3. ALL SIDEWALKS WITHIN THE COUNTY RIGHT-OF-WAY OR WITHIN A PUBLIC SIDEWALK EASEMENT SHALL BE CONSTRUCTED OF 6-INCH THICK, 3000-PSI CONCRETE WITH FIBER MESH REINFORCEMENT. CONCRETE SIDEWALKS (OR PEDWAYS) AND CONCRETE DRIVEWAY APRONS SHALL BE CONSTRUCTED OVER SOILS COMPACTED TO 98% DENSITY, OF AASHTO T -180. SHOULD EXISTING SOILS BE FOUND UNSUITABLE FOR COMPACTION, ADDITIONAL COMPATIBLE MATERIALS SHALL BE BROUGHT TO THE SITE FOR USE AS SUBGRADE. ALTERNATE METHODS OF COMPACTION MAY BE REQUIRED TO AVOID DAMAGE TO SURROUNDING PROPERTIES.
4. CONSTRUCT SIDEWALK JOINTS PURSUANT TO FDOT INDEX 310 (LATEST EDITION). EXPANSION JOINTS SHALL BE EVERY 50 FEET, AND BETWEEN NEW AND OLD CONCRETE.
5. TWO BY FOUR FORM BOARDS SHALL NOT BE USED FOR SIDEWALK/DRIVEWAY CONSTRUCTION. FORM BOARDS SHALL MATCH PROPOSED CONCRETE THICKNESS. SLIP FORMS SHALL NOT BE USED FOR SIDEWALK CONSTRUCTION. FIXED FORMWORK SHALL BE REQUIRED PER FDOT INDEX 300.
6. THE CONTRACTOR SHALL PROVIDE A 3-FOOT CURB TRANSITION AT ALL CURB TERMINATIONS.
7. ALL SIDEWALK AND ACCESS RAMP CONSTRUCTION SHALL COMPLY WITH THE DEPARTMENT OF JUSTICE 2010 ADA STANDARDS FOR ACCESSIBLE DESIGN, FDOT DESIGN STANDARDS (LATEST EDITION), AND BREVARD COUNTY DEVELOPMENT REQUIREMENTS.

ASPHALT PAVING AND TESTING

THE FOLLOWING TESTING REQUIREMENTS APPLY TO:

- a. ALL PUBLIC AND PRIVATE SUBDIVISION PROJECTS PERMITTED THROUGH BREVARD COUNTY PLANNING AND DEVELOPMENT;
- b. ALL SITE PLAN PROJECTS PERMITTED THROUGH BREVARD COUNTY PLANNING AND DEVELOPMENT REQUIRING WORK IN THE COUNTY RIGHT-OF-WAY;
- c. ALL PROJECTS PERMITTED THROUGH BREVARD COUNTY PUBLIC WORKS FOR WORK WITHIN THE COUNTY RIGHT-OF-WAY.

SECTIONS WITHIN THE FDOT STANDARD SPECIFICATIONS LIMITING TESTING REQUIREMENTS BASED ON LOT SIZE, SUB-LOT SIZE, TONNAGE, MINIMUM THICKNESS, OR SPREAD RATE WILL NOT APPLY TO THE PROJECTS LISTED ABOVE. AT A MINIMUM, ONE SET OF TESTS WILL BE REQUIRED FOR ALL PAVING PROJECTS LARGER THAN 50 TONS TOTAL AND ADDITIONAL TESTING MAY BE REQUIRED ON A CASE BY CASE EVALUATION OF THE PROJECT. TESTING REQUIREMENTS AT THE ASPHALT PLANT WILL NOT APPLY.

FOR S-TYPE ASPHALT AS SPECIFIED IN THE 2000-2004 FDOT STANDARD SPECIFICATION:

1. THE CONTRACTOR SHALL PROVIDE A DESIGN MIX SIGNED AND SEALED BY A PROFESSIONAL ENGINEER LICENSED IN THE STATE OF FLORIDA AND APPROVED BY THE ENGINEER OF RECORD FOR THE PROJECT TO PUBLIC WORKS ENGINEERING FIVE BUSINESS DAYS PRIOR TO PAVING. THE MIX DESIGN SHALL MEET FDOT MINIMUM REQUIREMENTS AS OUTLINED IN SECTION 331-4 (2000). DESIGN MIXES BY FDOT CERTIFIED MIX DESIGNERS WILL NOT BE ACCEPTED.
2. THE CONTRACTOR SHALL PROVIDE EXTRACTION/GRADATION TESTS IN ACCORDANCE WITH SECTION 331-4.4.2 (2000).
3. THE CONTRACTOR SHALL PROVIDE MARSHALL STABILITY TESTING IN ACCORDANCE WITH SECTION 331-5.5.1 (2000).
4. PAVEMENT SURFACE SHALL MEET ALL REQUIREMENTS SPECIFIED IN SECTION 330-13 (2000).
5. THE CONTRACTOR SHALL PROVIDE SURFACE TOLERANCE TESTING FOR ROADWAYS WITH DESIGN SPEEDS OF 35 MPH OR GREATER IN ACCORDANCE WITH SECTION 330-13.3 (2000).
6. QUALITY CONTROL CORE BORINGS SHALL BE OBTAINED FOR THICKNESS PER SECTION 330-2.2 ROADWAY, (2004) AND DENSITY PER SECTION 330-11, TABLE 330-3 (2000).
7. ASPHALT TEST RESULTS FOR EACH CORE TAKEN ARE REVIEWED ON AN INDIVIDUAL BASIS FOR THICKNESS AND DENSITY. THICKNESS AND DENSITY AVERAGES WILL NOT BE ACCEPTED. NO UNDER TOLERANCE FOR THE THICKNESS OF EACH ASPHALT CORE WILL BE ALLOWED.

FOR SUPERPAVE (SP) ASPHALT AS SPECIFIED IN THE 2010 FDOT STANDARD SPECIFICATION:

1. THE CONTRACTOR SHALL PROVIDE AN FDOT APPROVED DESIGN MIX, APPROVED BY THE ENGINEER OF RECORD FOR THE PROJECT, TO PUBLIC WORKS ENGINEERING FIVE BUSINESS DAYS PRIOR TO PAVING. THE MIX DESIGN SHALL MEET FDOT MINIMUM REQUIREMENTS AS OUTLINED IN SECTION 334-2 & 334-3 (2010). DESIGN MIXES BY FDOT CERTIFIED MIX DESIGNERS THAT ARE NOT FDOT APPROVED WILL NOT BE ACCEPTED.
2. THE CONTRACTOR SHALL PROVIDE GRADATION AND BINDER CONTENT TESTING IN ACCORDANCE WITH SECTION 334-5. (2010) HOWEVER, THE SAMPLE(S) MAY BE TAKEN AT THE PROJECT LOCATION IN LIEU OF AT THE ASPHALT PLANT AS SPECIFIED. RESULTS MUST BE PROVIDED TO THE COUNTY WITHIN ONE WEEK AFTER THE COMPLETION OF PAVING.
3. THE CONTRACTOR SHALL PROVIDE QUALITY CONTROL, DENSITY, AND THICKNESS TESTING IN ACCORDANCE WITH SECTIONS 334-3, 334-4, 334-5, AND 334-5.2.3 (2010).
4. ASPHALT TESTING RESULTS FOR EACH CORE TAKEN ARE REVIEWED ON AN INDIVIDUAL BASIS FOR THICKNESS AND DENSITY. THICKNESS AND DENSITY AVERAGES, AS NOTED IN TABLE 334-5, NOTE 2, OF SECTION 334-5 (2010) WILL NOT BE ACCEPTED. NO UNDER TOLERANCE FOR THE THICKNESS OF EACH ASPHALT CORE WILL BE ALLOWED.
5. PAVEMENT SURFACE SHALL MEET ALL REQUIREMENTS SPECIFIED IN SECTION 330-12 (2010).
6. THE CONTRACTOR SHALL PROVIDE QUALITY CONTROL SURFACE TOLERANCE TESTING FOR ROADWAYS WITH DESIGN SPEEDS OF 35 MPH OR GREATER IN ACCORDANCE WITH 330-12 (2010).

FOR FRICTION COURSE FC-5 AS SPECIFIED IN THE 2010 FDOT STANDARD SPECIFICATION:

1. THE CONTRACTOR SHALL PROVIDE AN FDOT APPROVED DESIGN MIX, APPROVED BY THE ENGINEER OF RECORD FOR THE PROJECT, TO PUBLIC WORKS ENGINEERING FIVE BUSINESS DAYS PRIOR TO PAVING. THE MIX DESIGN SHALL MEET FDOT MINIMUM REQUIREMENTS AS OUTLINED IN SECTION 337-4 (2010). DESIGN MIXES BY FDOT CERTIFIED MIX DESIGNERS THAT ARE NOT FDOT APPROVED WILL NOT BE ACCEPTED.
2. THE CONTRACTOR SHALL PROVIDE GRADATION AND BINDER CONTENT TESTING IN ACCORDANCE WITH SECTION 337-5 & 337-6 (2010). THE SAMPLE(S) MAY BE TAKEN AT THE PROJECT LOCATION IN LIEU OF AT THE ASPHALT PLANT AS SPECIFIED. RESULTS MUST BE PROVIDED TO THE COUNTY WITHIN ONE WEEK AFTER THE COMPLETION OF PAVING.
3. PAVEMENT SURFACE SHALL MEET ALL REQUIREMENTS SPECIFIED IN SECTION 330-12 (2010).
4. QUALITY CONTROL CORE BORINGS SHALL BE OBTAINED FOR THICKNESS TESTING USING SECTION 334-5.2.3 (2010).
5. THE CONTRACTOR SHALL PROVIDE QUALITY CONTROL SURFACE TOLERANCE TESTING FOR ROADWAYS WITH DESIGN SPEEDS OF 35 MPH OR GREATER IN ACCORDANCE WITH SECTION 330-12 (2010).

FOR SUPERPAVE FRICTION COURSES FC-9.5 & FC-12.5 AS SPECIFIED IN THE 2010 FDOT STANDARD SPECIFICATIONS:

1. THE CONTRACTOR SHALL PROVIDE AN FDOT APPROVED DESIGN MIX, APPROVED BY THE ENGINEER OF RECORD FOR THE PROJECT, TO PUBLIC WORKS ENGINEERING FIVE BUSINESS DAYS PRIOR TO PAVING. THE MIX DESIGN SHALL MEET FDOT MINIMUM REQUIREMENTS AS OUTLINED IN SECTION 337-4 (2010). DESIGN MIXES BY FDOT CERTIFIED MIX DESIGNERS THAT ARE NOT FDOT APPROVED WILL NOT BE ACCEPTED.
2. THE CONTRACTOR SHALL PROVIDE GRADATION AND BINDER CONTENT TESTING IN ACCORDANCE WITH SECTION 337-5 & 337-6 (2010). THE SAMPLE(S) MAY BE TAKEN AT THE PROJECT LOCATION IN LIEU OF AT THE ASPHALT PLANT, AS SPECIFIED. RESULTS MUST BE PROVIDED TO THE COUNTY WITHIN ONE WEEK AFTER THE COMPLETION OF PAVING.
3. THE CONTRACTOR SHALL PROVIDE QUALITY CONTROL, DENSITY, AND THICKNESS TESTING IN ACCORDANCE WITH SECTIONS 337-1, 337-3, 337-4, 337-6, 337-8, AND 334-5.2.3 (2010).
4. ASPHALT TESTING RESULTS FOR EACH CORE TAKEN ARE REVIEWED ON AN INDIVIDUAL BASIS FOR THICKNESS AND DENSITY. THICKNESS AND DENSITY AVERAGES, AS NOTED IN TABLE 334-5, NOTE 2, OF SECTION 334-5 (2010) WILL NOT BE ACCEPTED. NO UNDER TOLERANCE FOR THE THICKNESS OF EACH ASPHALT CORE WILL BE ALLOWED.
5. PAVEMENT SURFACE SHALL MEET ALL REQUIREMENTS SPECIFIED IN SECTION 330-12 (2010).
6. THE CONTRACTOR SHALL PROVIDE QUALITY CONTROL SURFACE TOLERANCE TESTING FOR ROADWAYS WITH DESIGN SPEEDS OF 35 MPH OR GREATER IN ACCORDANCE WITH 330-12 (2010).

CONCRETE BOX CULVERT NOTES

1. ALL CONSTRUCTION SHALL COMPLY WITH FDOT DESIGN STANDARDS (LATEST EDITION), FDOT STANDARD SPECIFICATIONS FOR ROAD AND BRIDGE CONSTRUCTION (LATEST EDITION), AND BREVARD COUNTY STANDARDS.
2. PRIOR TO START OF CONSTRUCTION, THE SITE CONTRACTOR SHALL BE RESPONSIBLE FOR PROVIDING STRUCTURAL ENGINEERING DRAWINGS (SIGNED & SEALED BY A PROFESSIONAL ENGINEER LICENSED & REGISTERED IN THE STATE OF FLORIDA) FOR ALL COMPONENTS OF THE CONCRETE BOX CULVERTS, INCLUDING WINGWALLS, TOE SLAB & CUTOFF WALLS, AND HEADWALLS. THE DRAWINGS SHALL INCLUDE QUANTITIES TABULATIONS FOR CLASS IV CONCRETE (CUBIC YARDS), AND REINFORCING STEEL (POUNDS). THE DESIGN MUST BE BASED ON FDOT'S LOAD & RESISTANCE FACTOR DESIGN (LRFD) PROGRAM. SEPARATE DRAWINGS ARE REQUIRED FOR ALL WINGWALLS, TOE SLABS & CUTOFF WALLS, AND HEADWALLS, WHICH MUST BE CAST-IN-PLACE PER FDOT SPECIFICATIONS.
3. ALL BOX CULVERT MATERIALS THAT ARE TO BE INSTALLED UNDER ROADWAYS AND/OR DRIVEWAYS ARE TO BE DELIVERED TO SITE (AND PASS INITIAL INSPECTIONS) PRIOR TO START OF DEMOLITION OF EXISTING SYSTEM.
4. CONCRETE (PRECAST OR CAST-IN-PLACE) REQUIREMENTS: CLASS IV (5500 PSI).
5. REINFORCING STEEL REQUIREMENTS: ASTM A615 GRADE 60 DEFORMED BAR UNLESS OTHERWISE NOTED, WITH A MINIMUM CLEARANCE OF 3" (THREE INCHES), UNLESS OTHERWISE SHOWN. EQUAL AREA SUBSTITUTION OF WELDED WIRE (WWR) REINFORCEMENT IS PERMITTED.
6. REFER TO FDOT INDEX 292 FOR PRECAST CONCRETE BOX CULVERT SLAB & WALL THICKNESSES, REINFORCEMENT AREAS, GENERAL NOTES (SHEET 2 OF 14), AND WELDED WIRE REINFORCEMENT BENDING DIAGRAM (SHEET 14 OF 14).
7. REFER TO FDOT INDEX 289 FOR CONCRETE BOX CULVERT DETAILS RELATED TO LRFD.
8. REFER TO FDOT INDEX 291 FOR SUPPLEMENTAL DETAILS FOR PRECAST CONCRETE BOX CULVERTS.
9. IF REQUIRED, BY-PASS PUMPING AND/OR PIPING SHALL BE APPROVED BY BREVARD COUNTY PUBLIC WORKS PRIOR TO THE START OF CONSTRUCTION.

PROJECT NAME:DWG DESIGNED/DRAWN BY: JB CHECKED BY: RBS	DATE:	REVISION:	BY:
	1.	FOR DISTRIBUTION 10-10-12	
	2.		
	3.		

PREPARED BY:	PUBLIC WORKS DEPARTMENT ENGINEERING PROGRAM BREVARD COUNTY BOARD OF COUNTY COMMISSIONERS 2725 JUDGE FRAN JAMIESON WAY, RM. 204, BLDG. A, VIERA, FL 32940 Ph. (321) 637-5437, Fx. (321) 633-2083
--------------	---



DATE:  
OCTOBER 2012

APPROVED BY:  
RICHARD B. SZPYRKA, P.E.  
ENGINEERING PROGRAM MANAGER

BREVARD COUNTY PUBLIC WORKS ENGINEERING  
STANDARD DEVELOPMENT NOTES

SHEET  
1  
of  
1

JOHN A. PEKAR, P.E., LLC.  
CA#30197  
COLUMBIA COMMERCIAL PLAZA  
102 COLUMBIA DRIVE, SUITE 207  
CAPE CANAVERAL, FL, 32920  
(321) 288-1040

Revisions/Comments:



Cadd File Information

Cadd File:	220029 C-1
Scale:	AS NOTED

Drawing Information

Drawn by:	DPA
Checked by:	JAP
Approved by:	JAP
Date:	01-26-2023

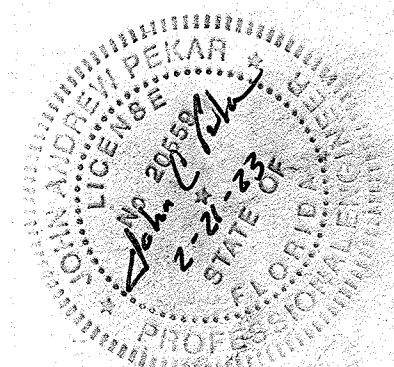
SPACE COAST  
DAILY PARK  
IMPROVEMENT PLANS  
GENERAL NOTES



John A. Pekar  
C.A. No. 30197  
P.E. No. 20559

Drawing Number

C-3

Drawing: 3 Of: 4



