

# LOCATION MAP

IR TIKI 2, LLC (SANDEEP PATEL, MANAGER)  
22SS00015

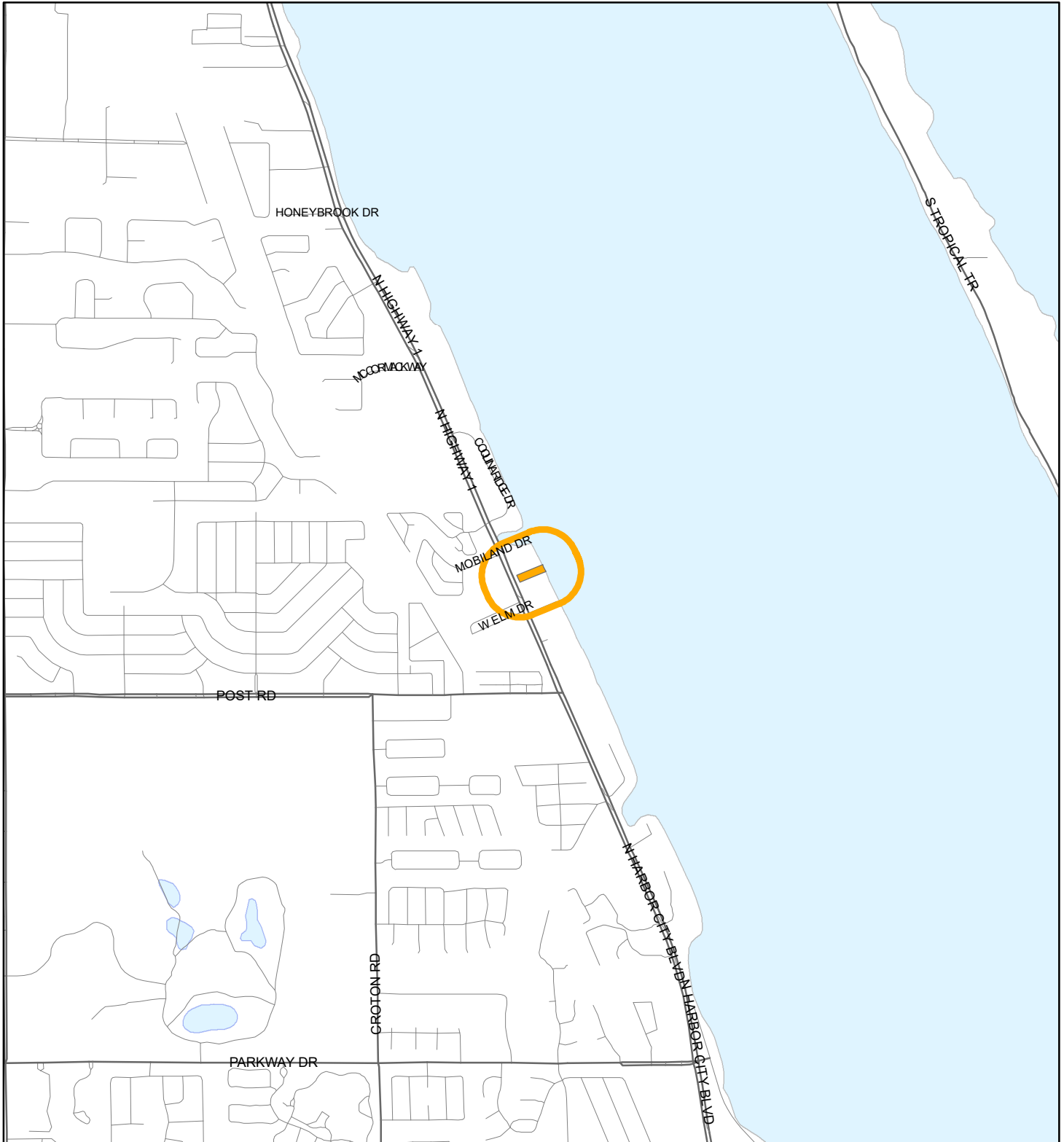

1:24,000 or 1 inch = 2,000 feet

Buffer Distance: 500 feet

This map was compiled from recorded documents and does not reflect an actual survey. The Brevard County Board of County Commissioners does not assume responsibility for errors or omissions hereon.

Produced by BoCC - GIS Date: 1/5/2023

Buffer  
Subject Property

# ZONING MAP

IR TIKI 2, LLC (SANDEEP PATEL, MANAGER)

22SS00015

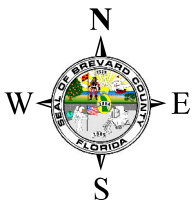
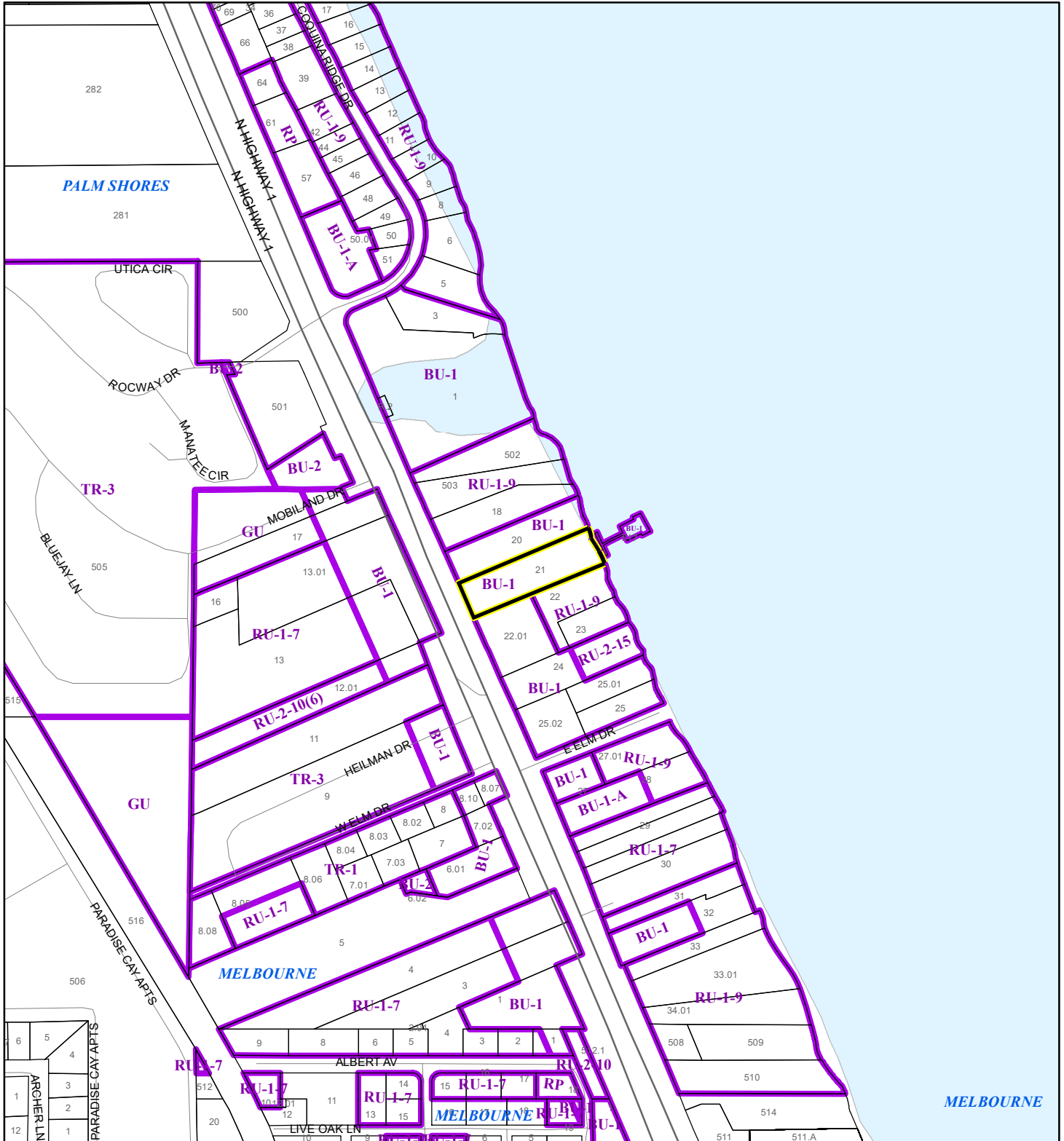

1:4,800 or 1 inch = 400 feet

This map was compiled from recorded documents and does not reflect an actual survey. The Brevard County Board of County Commissioners does not assume responsibility for errors or omissions hereon.

Produced by BoCC - GIS Date: 1/5/2023

Subject Property

Parcels

Zoning

# FUTURE LAND USE MAP

IR TIKI 2, LLC (SANDEEP PATEL, MANAGER)

22SS00015

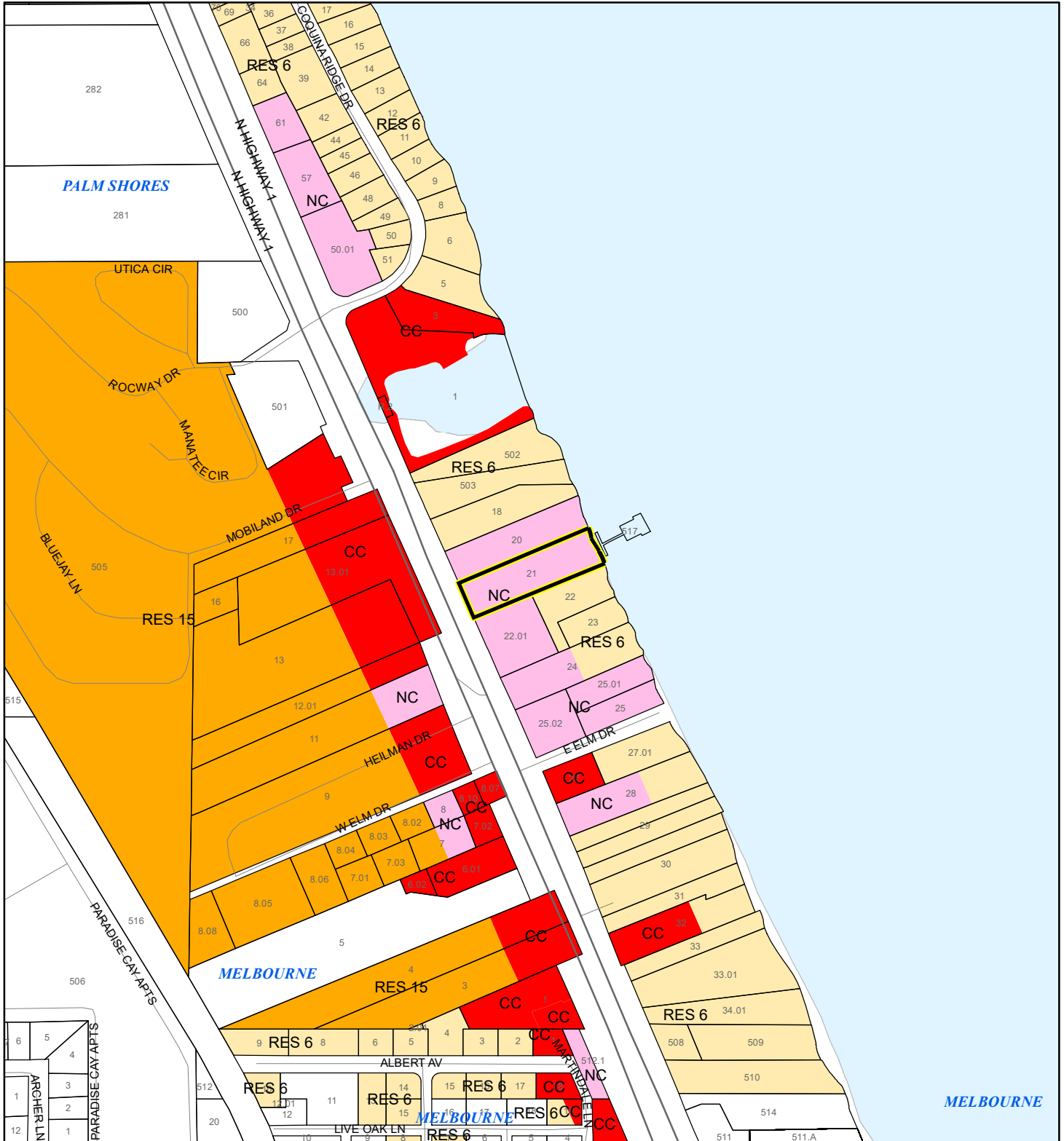

1:4,800 or 1 inch = 400 feet

Subject Property

Parcels

This map was compiled from recorded documents and does not reflect an actual survey. The Brevard County Board of County Commissioners does not assume responsibility for errors or omissions hereon.

Produced by BoCC - GIS Date: 1/4/2023



# PROPOSED FUTURE LAND USE MAP

IR TIKI 2, LLC (SANDEEP PATEL, MANAGER)

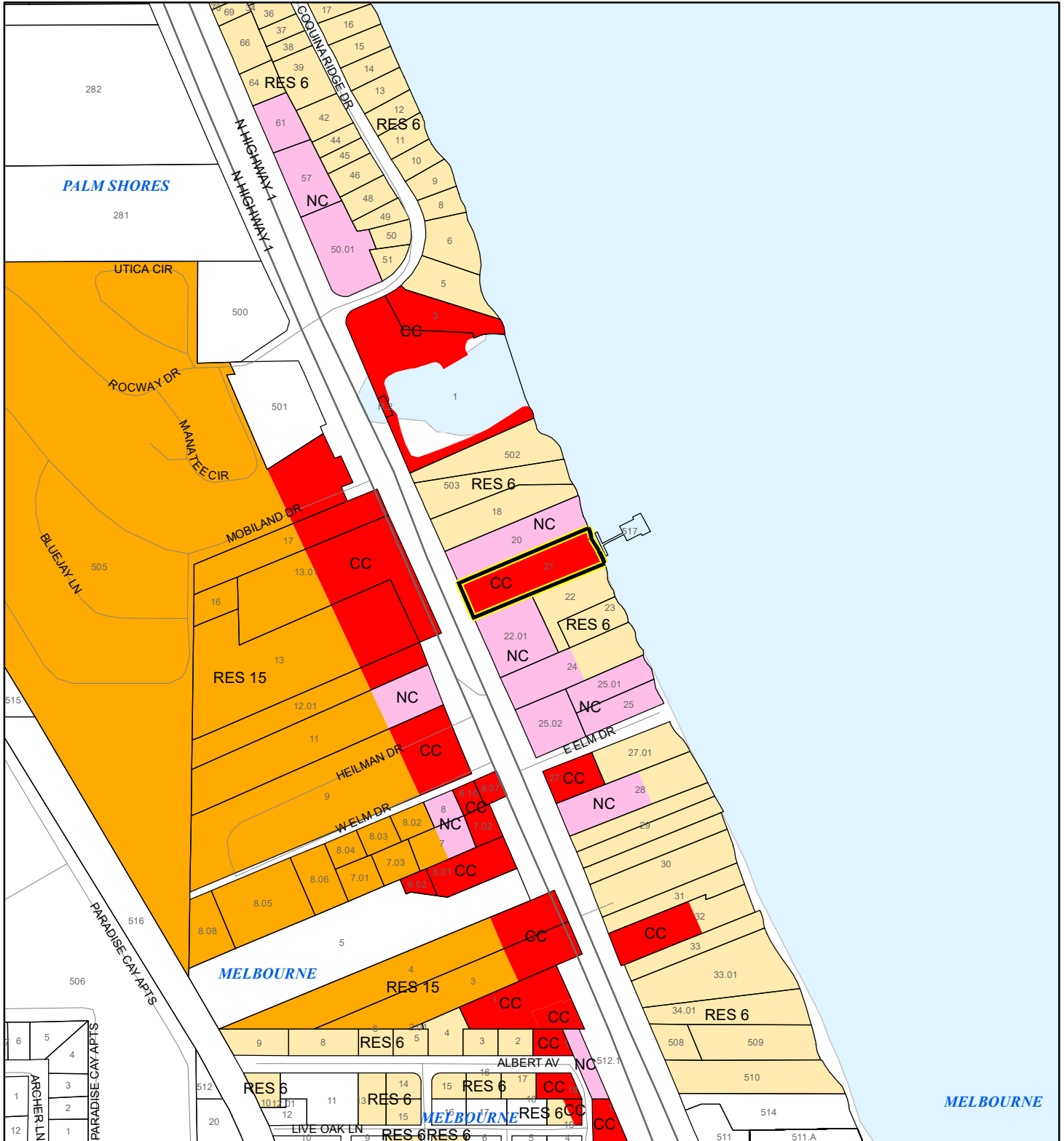
22SS00015



1:4,800 or 1 inch = 400 feet

 Subject Property  
 Parcels

This map was compiled from recorded documents and does not reflect an actual survey. The Brevard County Board of County Commissioners does not assume responsibility for errors or omissions hereon.

Produced by BoCC - GIS Date: 1/5/2023



# AERIAL MAP

IR TIKI 2, LLC (SANDEEP PATEL, MANAGER)

22SS00015

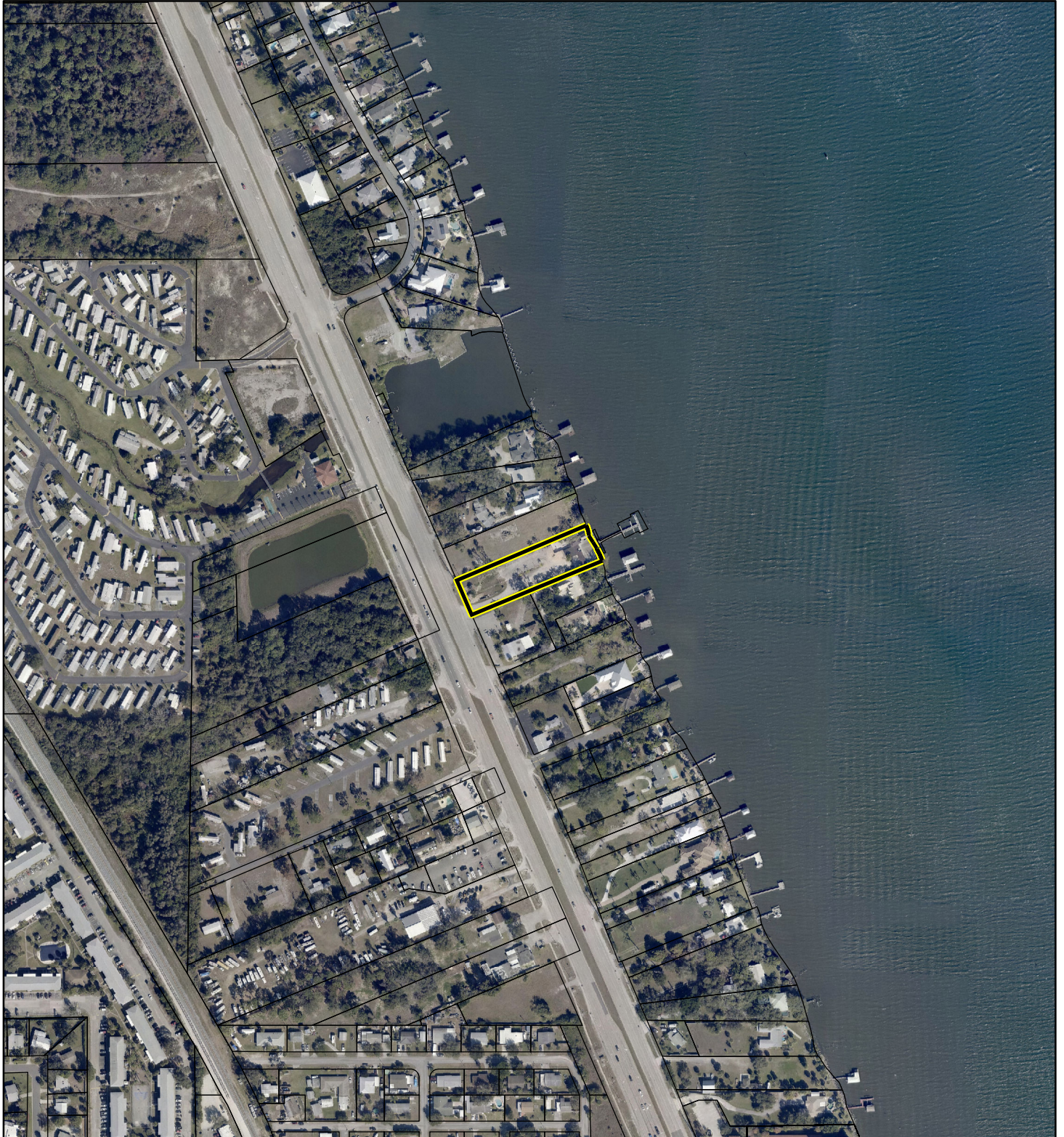

1:4,800 or 1 inch = 400 feet

PHOTO YEAR: 2022

This map was compiled from recorded documents and does not reflect an actual survey. The Brevard County Board of County Commissioners does not assume responsibility for errors or omissions hereon.

Produced by BoCC - GIS Date: 1/4/2023

 Subject Property

 Parcels



# NWI WETLANDS MAP

IR TIKI 2, LLC (SANDEEP PATEL, MANAGER)

22SS00015

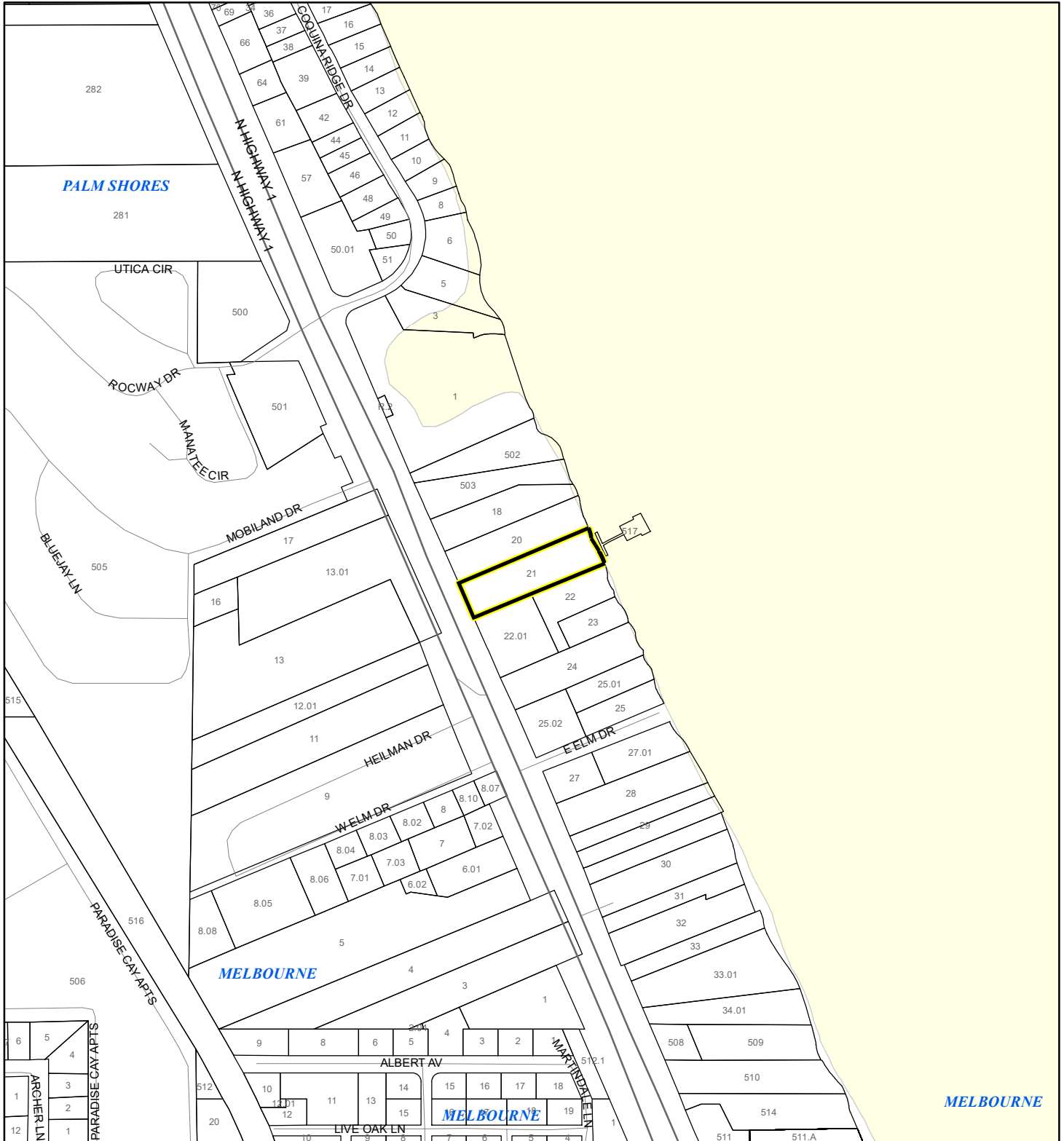









1:4,800 or 1 inch = 400 feet

This map was compiled from recorded documents and does not reflect an actual survey. The Brevard County Board of County Commissioners does not assume responsibility for errors or omissions hereon.

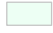
Produced by BoCC - GIS Date: 1/4/2023

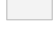
## National Wetlands Inventory (NWI)

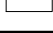
 Estuarine and Marine Deepwater	 Freshwater Pond
 Estuarine and Marine Wetland	 Lake
 Freshwater Emergent Wetland	 Other
 Freshwater Forested/Shrub Wetland	 Riverine
	 Subject Property
	 Parcels

# SJRWMD FLUCCS WETLANDS - 6000 Series MAP

IR TIKI 2, LLC (SANDEEP PATEL, MANAGER)

22SS00015

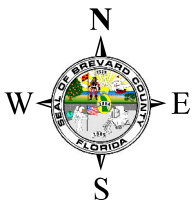

1:4,800 or 1 inch = 400 feet

This map was compiled from recorded documents and does not reflect an actual survey. The Brevard County Board of County Commissioners does not assume responsibility for errors or omissions hereon.

Produced by BoCC - GIS Date: 1/4/2023

## SJRWMD FLUCCS WETLANDS

- Wetland Hardwood Forests - Series 6100
- Wetland Coniferous Forest - Series 6200
- Wetland Forested Mixed - Series 6300
- Vegetated Non-Forested Wetlands - Series 6400
- Non-Vegetated Wetland - Series 6500

Subject Property

Parcels

# USDA SCSSS SOILS MAP

IR TIKI 2, LLC (SANDEEP PATEL, MANAGER)

22SS00015

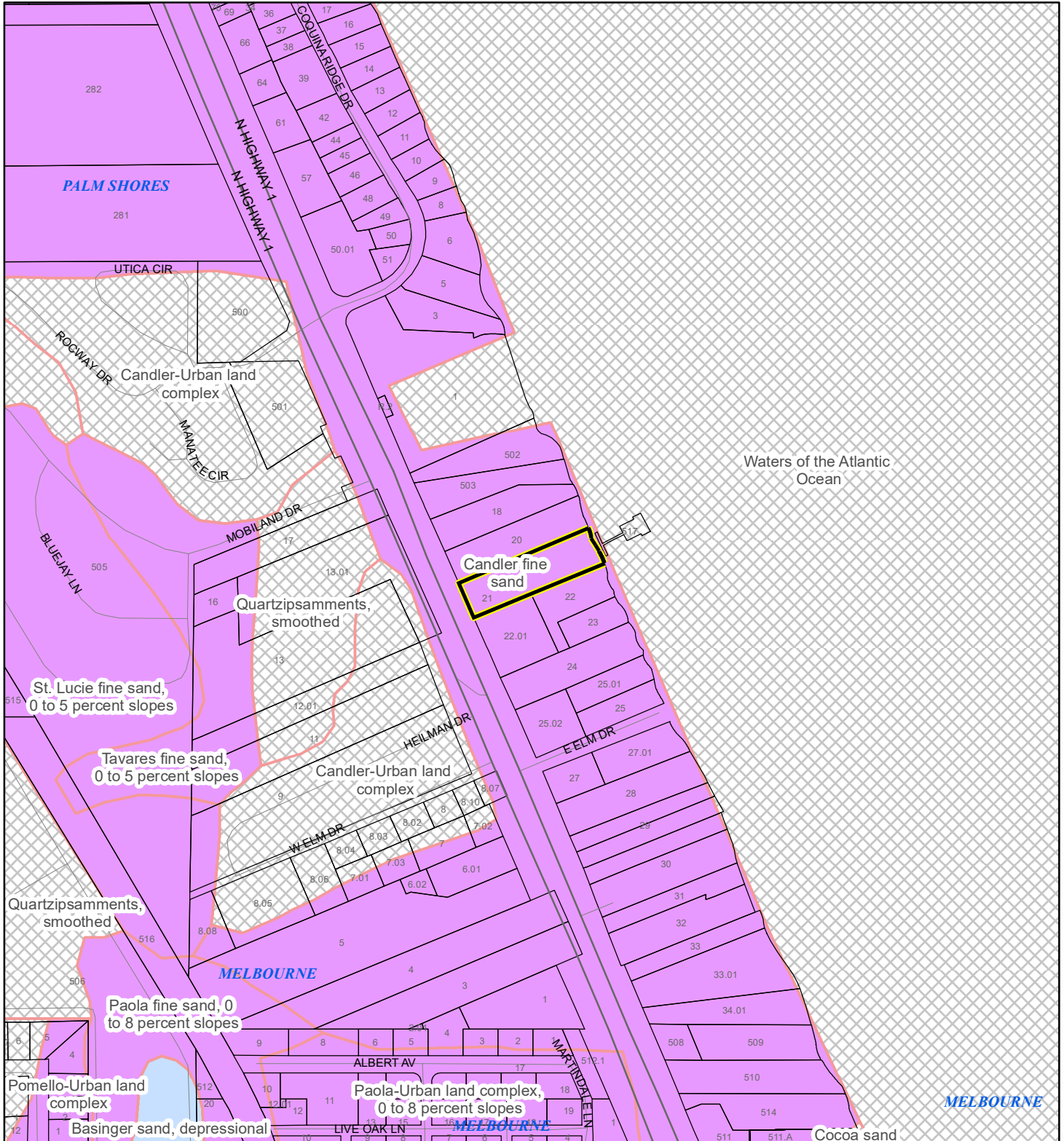

1:4,800 or 1 inch = 400 feet

This map was compiled from recorded documents and does not reflect an actual survey. The Brevard County Board of County Commissioners does not assume responsibility for errors or omissions hereon.

Produced by BoCC - GIS Date: 1/4/2023

## USDA SCSSS Soils

- Aquifer and Hydric
- Aquifer
- Hydric
- None

Subject Property

Parcels



 Subject Property       Parcels

# COASTAL HIGH HAZARD AREA MAP

IR TIKI 2, LLC (SANDEEP PATEL, MANAGER)

22SS00015

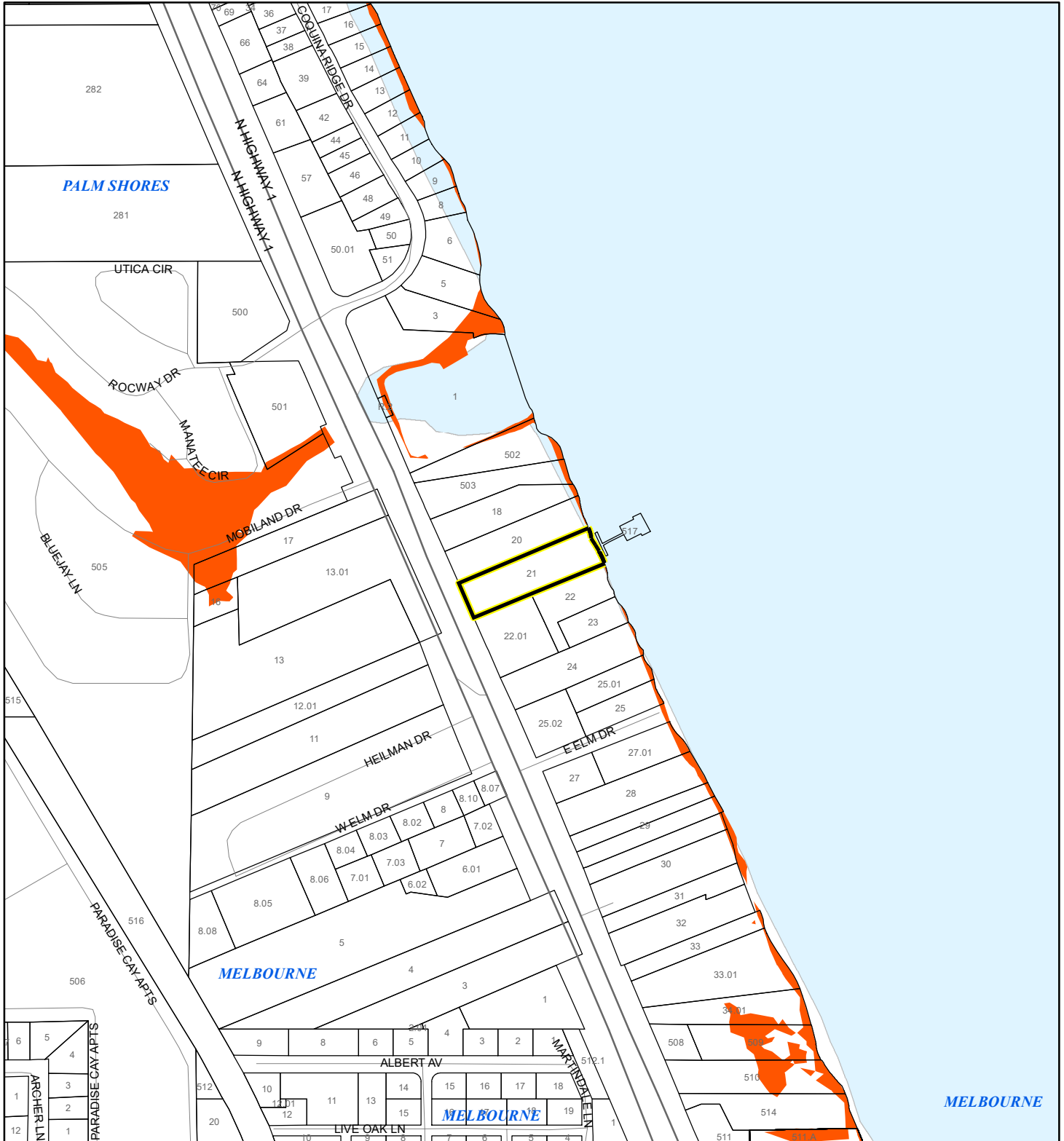

1:4,800 or 1 inch = 400 feet

This map was compiled from recorded documents and does not reflect an actual survey. The Brevard County Board of County Commissioners does not assume responsibility for errors or omissions hereon.

Produced by BoCC - GIS Date: 1/4/2023

Subject Property

Parcels

Coastal High Hazard Area

SurgeZoneCat1

# INDIAN RIVER LAGOON SEPTIC OVERLAY MAP

IR TIKI 2, LLC (SANDEEP PATEL, MANAGER)

22SS00015

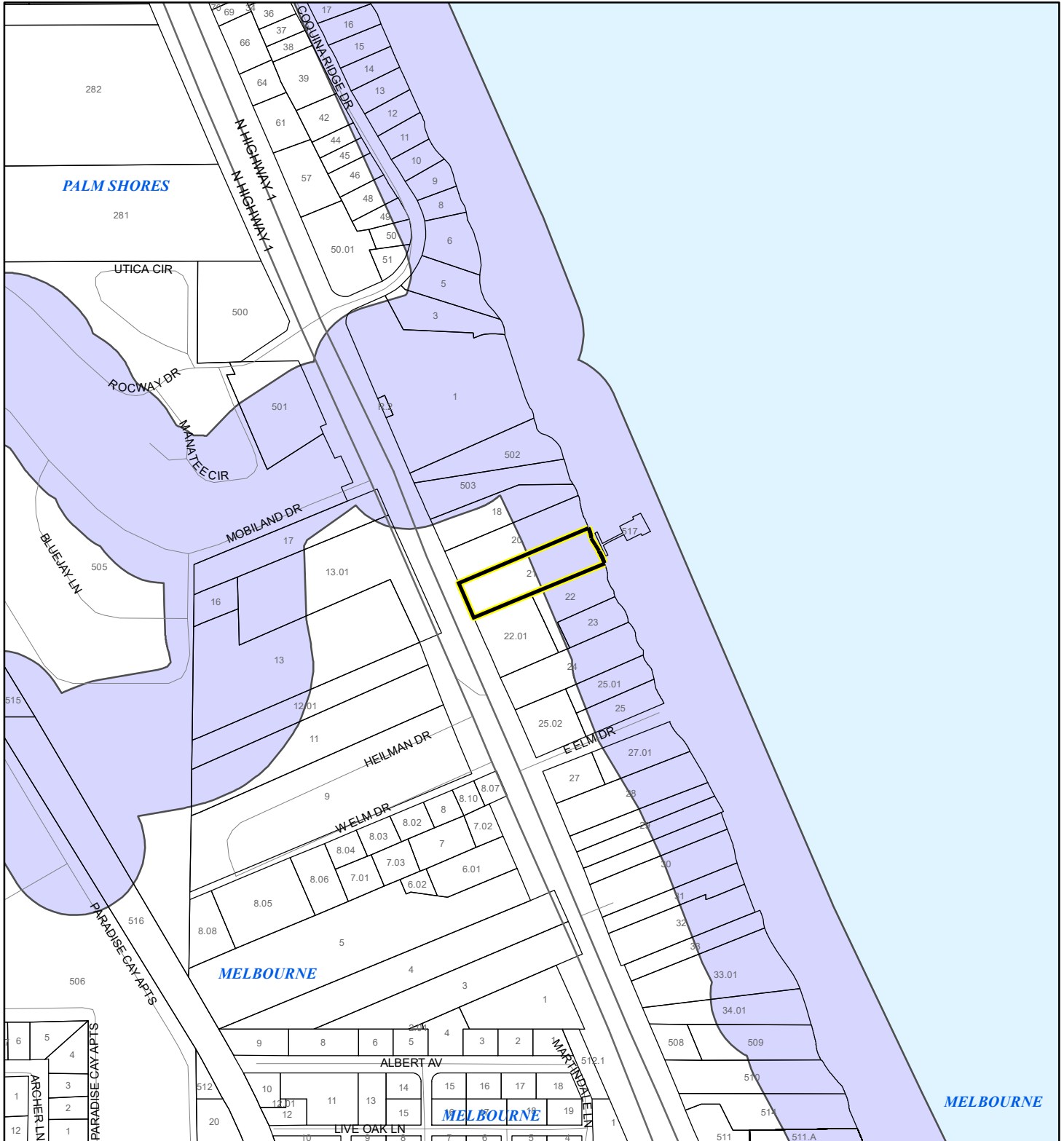

1:4,800 or 1 inch = 400 feet

This map was compiled from recorded documents and does not reflect an actual survey. The Brevard County Board of County Commissioners does not assume responsibility for errors or omissions hereon.

Produced by BoCC - GIS Date: 1/4/2023

Subject Property

Parcels

**Septic Overlay**

40 Meters

60 Meters

All Distances



# EAGLE NESTS MAP

IR TIKI 2, LLC (SANDEEP PATEL, MANAGER)

22SS00015

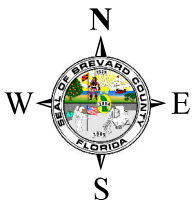
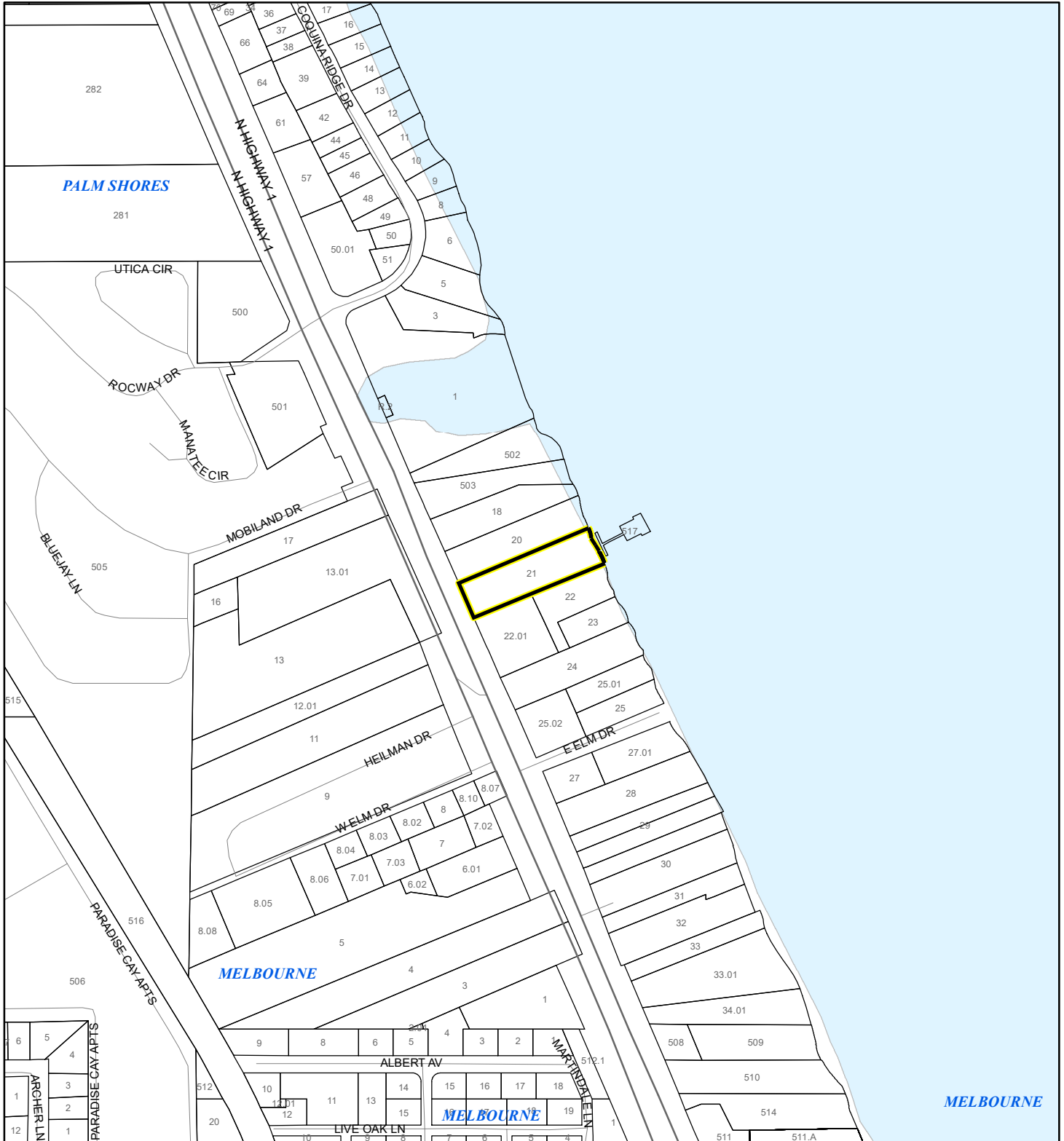

1:4,800 or 1 inch = 400 feet

This map was compiled from recorded documents and does not reflect an actual survey. The Brevard County Board of County Commissioners does not assume responsibility for errors or omissions hereon.

Produced by BoCC - GIS Date: 1/4/2023

 Subject Property

 Parcels



Eagle Nests  
FWS 2010

## SCRUB JAY OCCUPANCY MAP

IR TIKI 2, LLC (SANDEEP PATEL, MANAGER)

22SS00015

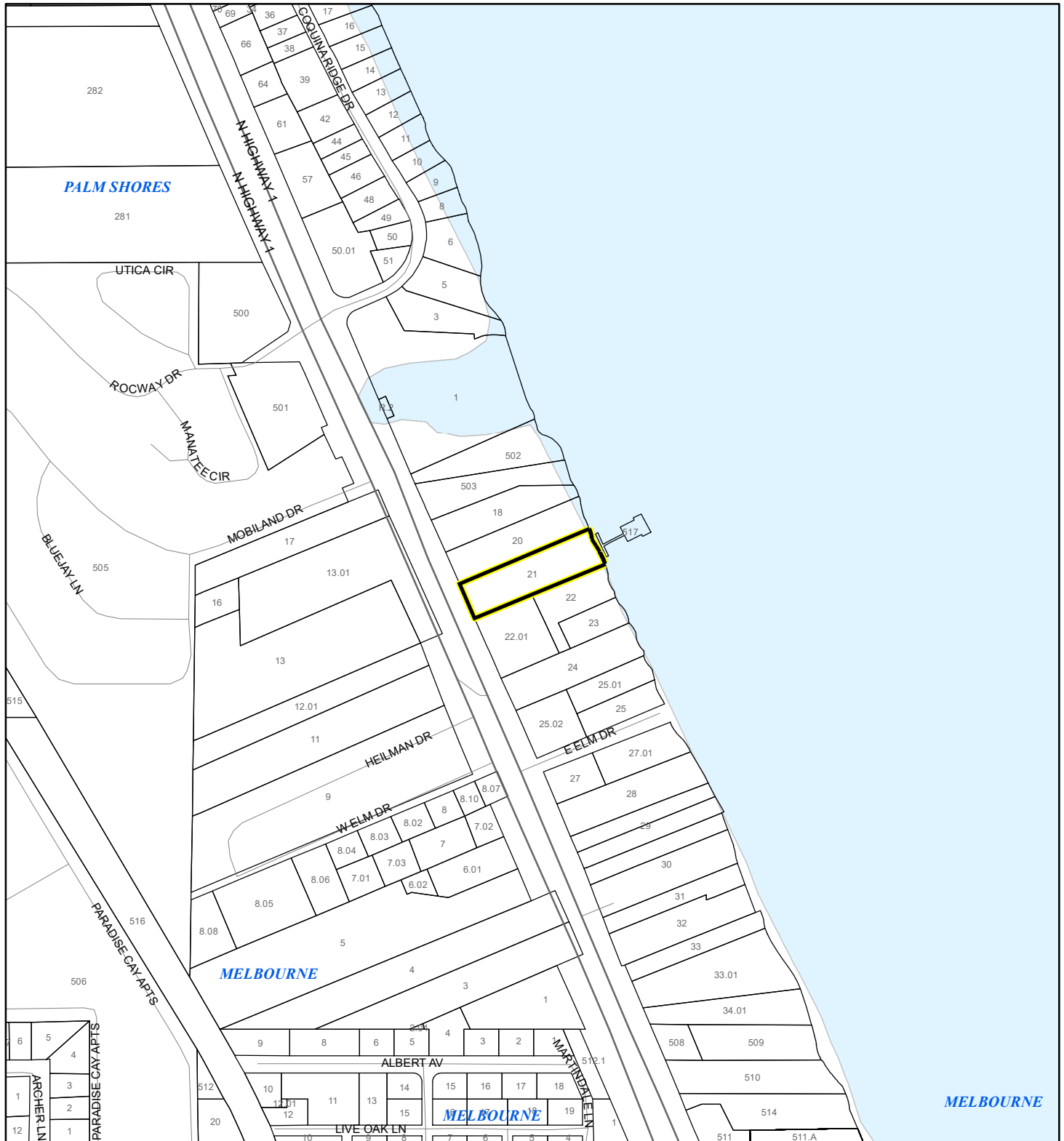

1:4,800      or 1 inch = 400 feet

This map was compiled from recorded documents and does not reflect an actual survey. The Brevard County Board of County Commissioners does not assume responsibility for errors or omissions hereon.

Produced by BoCC - GIS    Date: 1/4/2023

**Subject Property**

☐ Parcels

 Scrub Jay Occupancy

# SJRWMD FLUCCS UPLAND FORESTS - 4000 Series MAP

IR TIKI 2, LLC (SANDEEP PATEL, MANAGER)

22SS00015

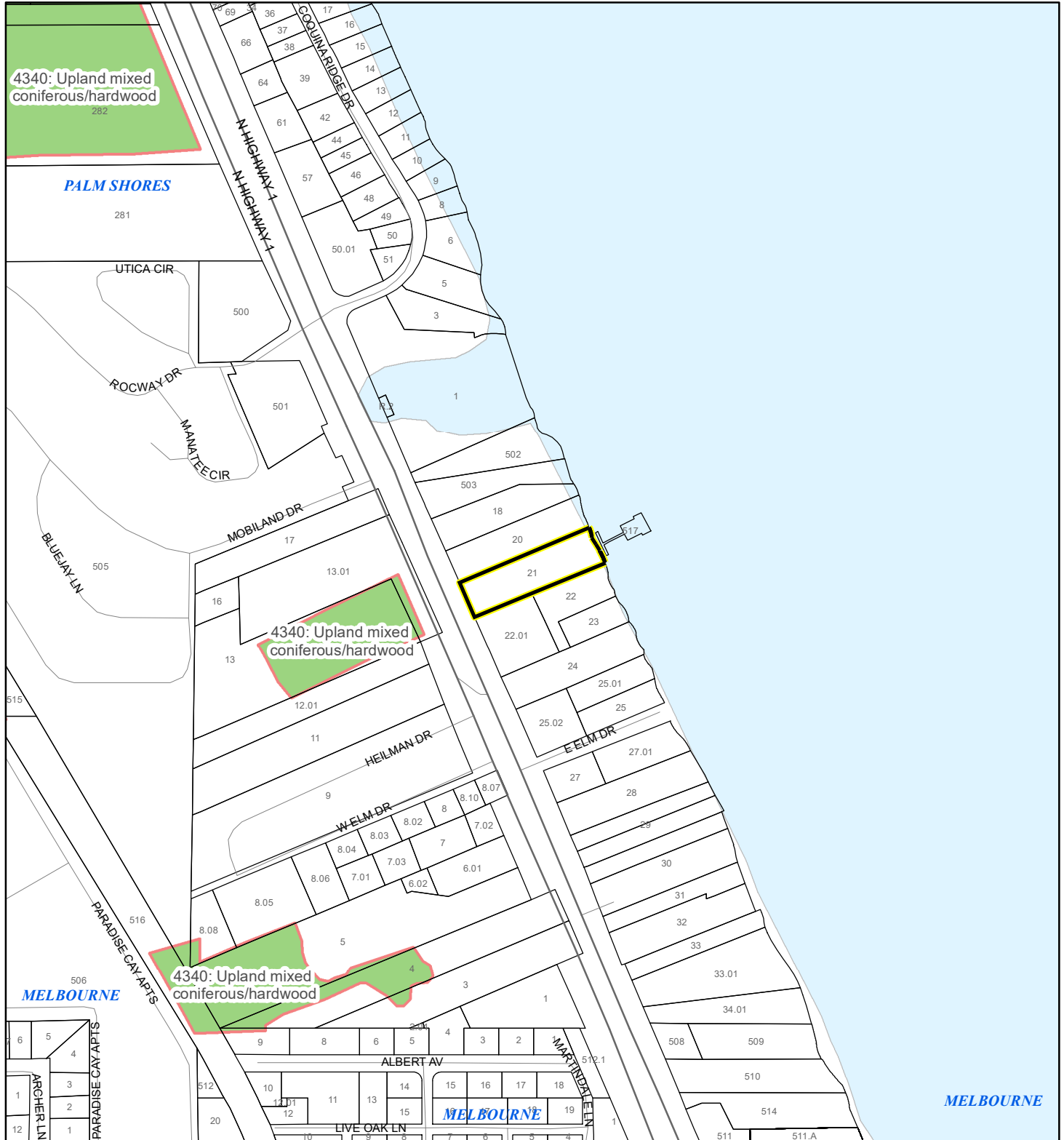

1:4,800 or 1 inch = 400 feet

This map was compiled from recorded documents and does not reflect an actual survey. The Brevard County Board of County Commissioners does not assume responsibility for errors or omissions hereon.

Produced by BoCC - GIS Date: 1/4/2023

## SJRWMD FLUCCS Upland Forests

- Upland Coniferous Forest - 4100 Series
- Upland Hardwood Forest - 4200 Series
- Upland Mixed Forest - 4300 Series
- Tree Plantations - 4400 Series

Subject Property  Parcels