

LOCATION MAP

CHAVEZ, DANIEL DEE

22V00020

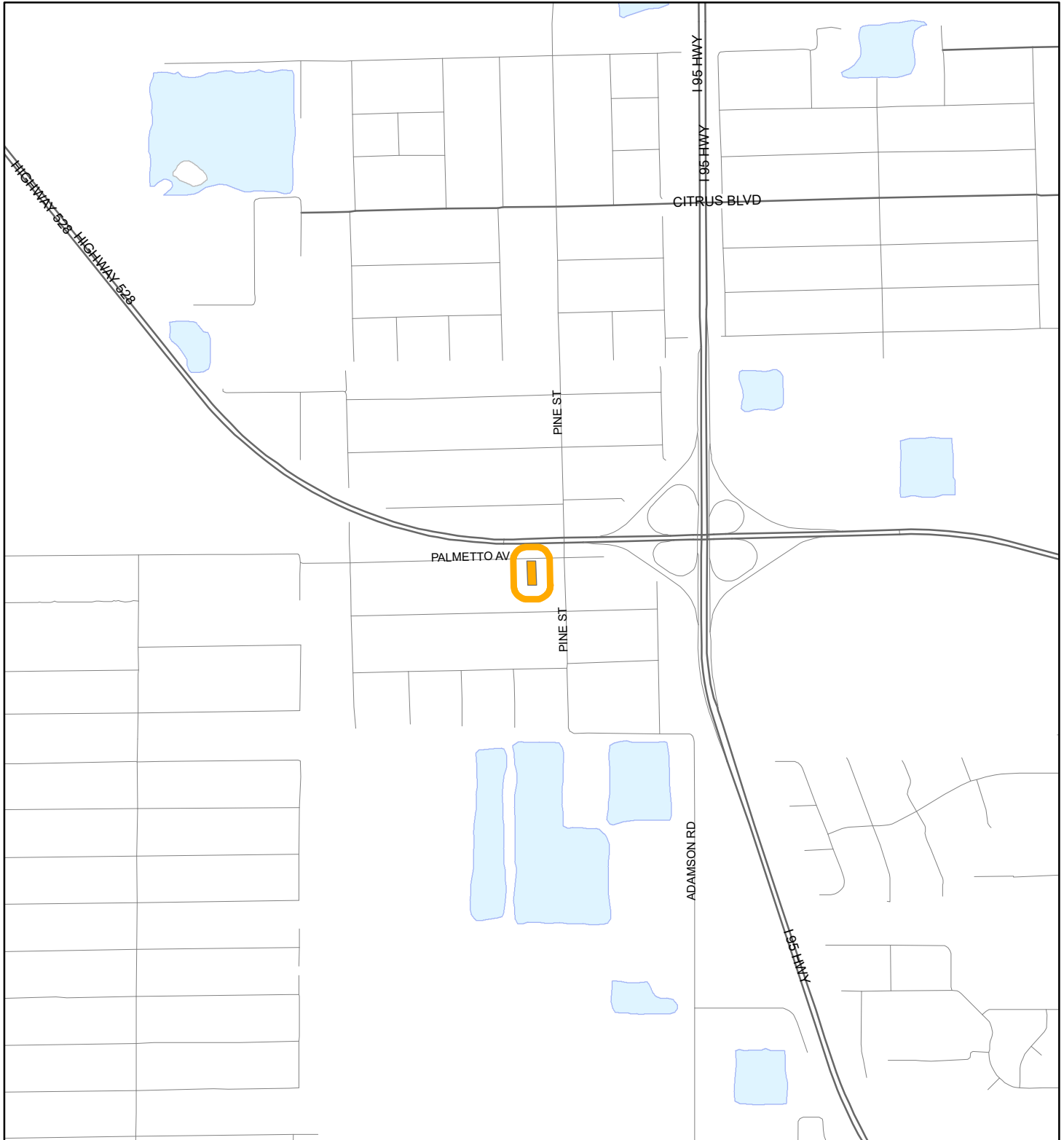



1:24,000 or 1 inch = 2,000 feet

Buffer Distance: 200 feet

This map was compiled from recorded documents and does not reflect an actual survey. The Brevard County Board of County Commissioners does not assume responsibility for errors or omissions hereon.

Produced by BoCC - GIS Date: 6/17/2022

 Buffer
 Subject Property

CHAVEZ, DANIEL DEE
22V00020

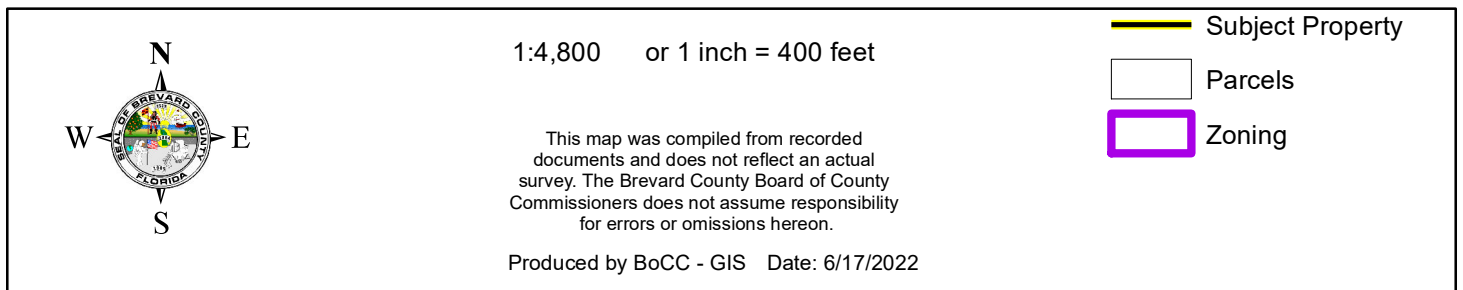

AERIAL MAP

CHAVEZ, DANIEL DEE

22V00020



1:600 or 1 inch = 50 feet

PHOTO YEAR: 2021

This map was compiled from recorded documents and does not reflect an actual survey. The Brevard County Board of County Commissioners does not assume responsibility for errors or omissions hereon.

Produced by BoCC - GIS Date: 6/17/2022

 Subject Property

 Parcels